

2x6" EXTERIOR WALLS
SECOND FLOOR PLAN
 SCALE: 1/4"=1'-0"

UNLESS NOTED OTHERWISE:
 9' CEILING HT.
 8'-0" DOOR HT.
 7'-0" HDR. HT.

SEE CONTRACTOR FOR FLOORING SELECTIONS.
 ALL ANGLES SHOWN ARE 45 DEGS (UNLESS OTHERWISE NOTED).

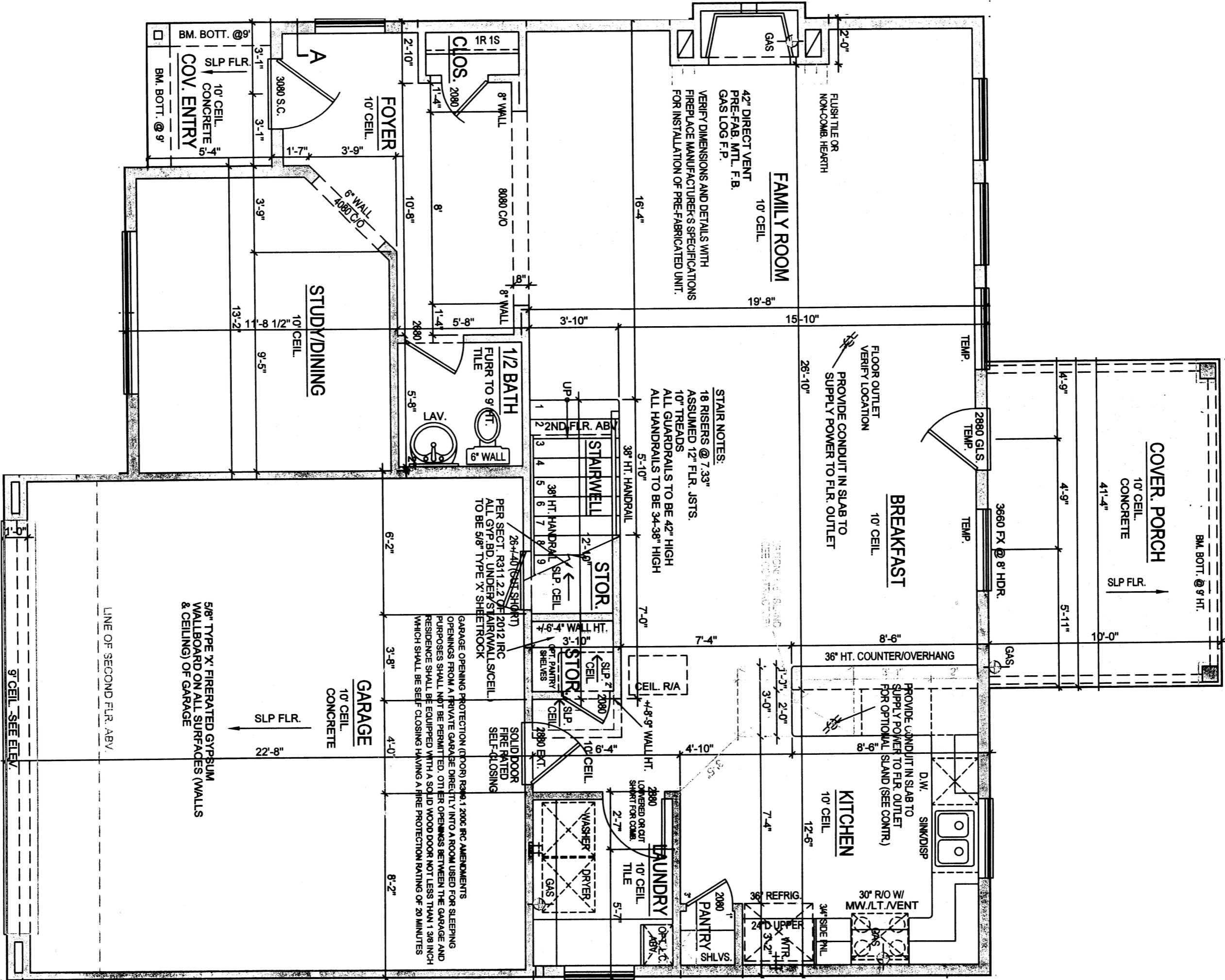

2x6" EXTERIOR WALLS
FIRST FLOOR PLAN
 SCALE: 1/4"=1'-0"

UNLESS NOTED OTHERWISE:
 10' CEILING HT.
 8'-0" DOOR HT.

TOTAL LIVING	2889
FIRST FLOOR	1113
SECOND FLOOR	1418
GARAGE	488
FRONT PORCH	33
REAR PORCH	140
TOTAL SLAB	1784

SEE ELECTRICAL PLAN SHEET E10 FOR DESIGNATED LOCATIONS OF REQUIRED SMOKE DETECTORS AND CARBON MONOXIDE ALARMS.

8313 S SMOKE DETECTORS (2012 IFC) INTERCONNECTED WITH BATTERY BACKUP FOR NEW CONSTRUCTION. AN APPROVED CARBON MONOXIDE ALARM SHALL BE INSTALLED OUTSIDE OF EACH SEPARATE SLEEPING AREA IN THE LIVING UNIT WITHIN WHICH THE FIRE DETECTING UNIT IS INSTALLED.

5019 BAYOU RIDGE DR.
 LOT 16, BLK 1 OF BAYOU RIDGE SUBDV.
 HOUSTON, HARRIS CO., TX 77092