

A. TREVINO GRANT
ABSTRACT NO. 20

LISA MARIE PALKM, ET AL
VOL. 985, PG. 5173
VOL. 1343, PG. 823

RONNIE M.
BOULINEAU
VOL. 1211, PG. 16

SCALE 1" = 400'

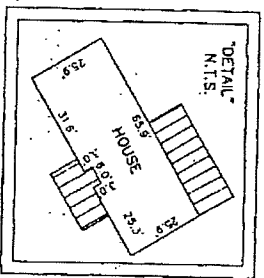
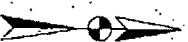

COUNTY ROAD NO 421
(R.O.W. NOT TO SCALE)

SURVEY PLAT OF 90.86 ACRES OF LAND OUT OF
THE A TREVINO GRANT, ABSTRACT NO. 20,
WILSON COUNTY, TEXAS AND BEING THE LAND
DESCRIBED IN A CONVEYANCE TO BRIAN STROUD
AND LORI STROUD IN A DEED OF RECORD IN
VOLUME 1059, PAGE 275 OF THE OFFICIAL
PUBLIC RECORDS OF WILSON COUNTY, TEXAS.

- LEGEND**
- RF - STEEL ROD FOUNDED
 - RS - 1/2" REBAR SET
 - M.H. - POLLIOK
 - CP - CEMENT CONCRETE
 - DDWASS' DIST' - DEED
 - 1 - BARBED WIRE FENCE
 - CO - POWER/UTILITY POLE
 - WATER WELL/WATER METER (AS NOTED)
 - SEPTIC TANK
 - CHURN LINK FENCE
 - WOOD PRIVACY FENCE

SURVEY NOTES

1. A METES AND BOUNDS DESCRIPTION ACCOMPANIES THIS PLAT.
2. THE BASIS OF THE BEARING SYSTEM IS MAGNETIC.
3. THIS PLAT WAS PREPARED FOR THE TRANSACTION BETWEEN BRIAN STROUD AND LORI STROUD AND DOES NOT REPRESENT A RELEASE OF LIABILITY OR A RELEASE OF ANY OTHER INTERESTS. IT IS NECESSARY TO COPY THIS SURVEY EXCEPT AS NECESSARY IN CONNECTION WITH THE ORIGINAL TRANSACTION. ANY COPIES MUST BE VALID WITH THE SURVEYOR'S ORIGINAL SIGNATURE AND SEAL.

ADDRESS: 2813 CH 421
STOCKDALE, TEXAS 78180

REFERENCE:
VOL. 1059, PG. 275 - DEED
VOL. 505, PG. 16 - WATER ESMNT (BLNK)
VOL. 505, PG. 57 - WATER ESMNT (BLNK)
VOL. 505, PG. 59 - WATER ESMNT (BLNK)



**POLLOK & SONS
SURVEYING, INC.**
FLORESVILLE, TEXAS
(830) 393-4770

STATE OF TEXAS
COUNTY OF WILSON

I HEREBY CERTIFY THAT THE ABOVE PLAT REPRESENTS
AN ACTUAL SURVEY MADE ON THE GROUND BY PEOPLE
WORKING UNDER MY DIRECT SUPERVISION

THIS 14TH DAY OF NOVEMBER, 2008, A.D.

LARRY J. POLLOK
© 2008 ALL RIGHTS RESERVED

R.P.L.S. NO. 5180
JOB NO. 08-0707

STATE OF TEXAS
COUNTY OF WILSON

FIELD NOTES FOR 90.86 ACRES OF LAND

BEING 90.86 acres of land out of the A. Trevino Grant, Abstract 20, Wilson County, Texas and being the land described in a conveyance to Brian Stroud and Lori Stroud in a Deed of record in Volume 1059, Page 275 of the Official Public Records of Wilson County, Texas and being more particularly described by metes and bounds as follows:

BEGINNING at a set 1/2 inch rebar with a "Pollok & Sons" cap at the intersection of the northerly right-of-way line of County Road No. 421 and the westerly right-of-way line of County Road No. 423 for the southeasterly corner of this tract;

THENCE South 59° 41' 13" West, with the County Road No. 421 northerly right-of-way line, distance of 1961.88 feet to a set 1/2 inch rebar with a "Pollok & Sons" cap for the southwesterly corner of this tract and southeasterly coreur of the Phyllis E. Coldeway, et al land described in Volume 1261, Page 70, Wilson County Official Public Records;

THENCE with the westerly line of this tract and easterly line of the Coldeway, et al land, generally along fence,
North 30° 20' 47" West, distance of 1111.66 feet to a set 1/2" rebar with "Pollok & Sons" cap;
North 30° 24' 05" West, distance of 119.29 feet to a set 1/2" rebar with "Pollok & Sons" cap;
North 30° 59' 27" West, distance of 741.52 feet to a set 1/2" rebar with "Pollok & Sons" cap;
North 31° 22' 43" West, distance of 442.06 feet to a found 1/2 inch steel pin for the northwesterly corner of this tract and a southwesterly corner of the Lisa Marie Palkin, et al land described in Volume 985, Page 577 and Volume 1343, Page 823, Wilson County Official Public Records;

THENCE with the common line of the Palkin, et al land and of this tract,
North 59° 47' 10" East, distance of 981.60 feet to a set 1/2" rebar with a "Pollok & Sons" cap;
South 32° 44' 10" East, distance of 442.00 feet to a set 1/2" rebar with a "Pollok & Sons" cap;
North 59° 47' 18" East, distance of 412.16 feet to a set 1/2" rebar with a "Pollok & Sons" cap for a northeasterly corner of this tract and northwesterly corner of the Ronnie M. Boulineau land described in Volume 1211, Page 16, Wilson County Official Public Records;

THENCE South 30° 10' 09" East, with the common line of the Boulineau land and of this tract, distance of 615.65 feet to a found 1/2 inch steel pin for a common corner;

THENCE North 59° 30' 21" East, continuing with last said common line, distance of 569.37 feet to a found 1/2 inch steel pin with a cap stamped #4020 for a common corner on the westerly right-of-way line of County Road No. 423;

THENCE with said County Road No. 423 right-of-way line,
South 30° 01' 47" East, distance of 244.86 feet to a set 1/2" rebar with "Pollok & Sons" cap;
South 30° 20' 47" East, distance of 1111.66 feet to the **POINT OF BEGINNING** containing 90.86 acres of land as shown on a plat that accompanies this description.

THE basis of the bearing system is NAD83.

POLLOK & SONS SURVEYING, INC.



Larry J. Pollok, R.P.L.S. No. 5186

November 14, 2006

ref: 06-0707

11150603

