

GF NO. 013276 CELEBRITY TITLE  
 ADDRESS: 12967 ELROD STREET  
 CONROE, TEXAS 77303  
 BORROWER: GERARDO S. MENDEZ AND  
 DOLORES MENDEZ

**LOTS 46 AND 47, BLOCK 2  
 TIMBER LINE ESTATES, SECTION 4**

ACCORDING TO THE MAP OR PLAT THEREOF RECORDED  
 IN CANINET Z, SHEET 91 OF THE MAP RECORDS  
 OF MONTGOMERY COUNTY, TEXAS

NOTE: SAM HOUSTON ELECTRIC COOPERATIVE EASEMENT  
 PER CF NO. 2003-112147

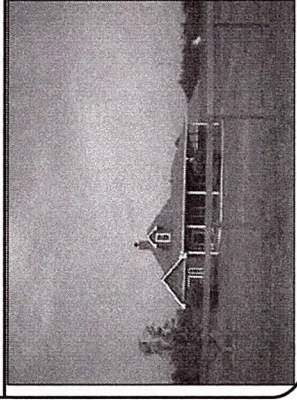

THIS PROPERTY DOES NOT LIE WITHIN THE  
 100 YEAR FLOOD PLAIN AS PER FIRM  
 PANEL NO. 48339C 0265 F  
 MAP REVISION: 12/19/96  
 ZONE X  
 BASED ONLY ON VISUAL EXAMINATION OF MAPS,  
 INACCURACIES OF FEMA MAPS PREVENT EXACT  
 DETERMINATION WITHOUT DETAILED FIELD STUDY.

A. SUBSURFACE INVESTIGATION  
 WAS BEYOND THE SCOPE OF THIS SURVEY

D.C.L.=DIRECTIONAL CONTROL LINE  
 RECORD BEARING: CABINET Z, SHEET 91 M.C.M.R.

I HEREBY CERTIFY THAT THIS SURVEY WAS MADE  
 ON THE GROUND, THAT THIS PLAT CORRECTLY  
 REPRESENTS THE FACTS FOUND AT THE  
 TIME OF SURVEY AND THAT THERE ARE NO  
 ENCROACHMENTS APPARENT ON THE GROUND,  
 EXCEPT AS SHOWN HEREON. THIS SURVEY IS  
 CERTIFIED FOR THIS TRANSACTION ONLY AND  
 ABSTRACTING PROVIDED IN THE ABOVE  
 REFERENCED TITLE COMMITMENT WAS RELIED  
 UPON IN PREPARATION OF THIS SURVEY.

TERRANCE MISH  
 PROFESSIONAL LAND SURVEYOR  
 NO. 4981  
 JOB NO. 11-03275  
 APRIL 20, 2011

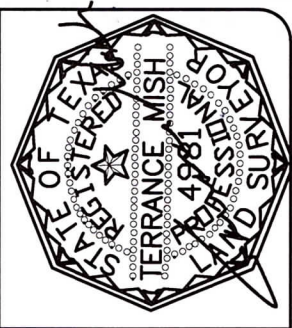

DRAWN BY: MM

SCALE: 1" = 80'

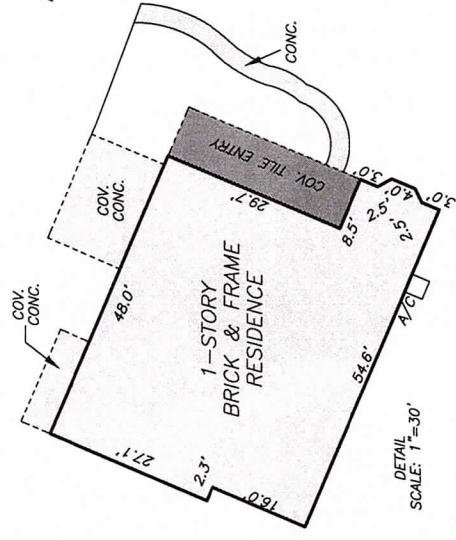
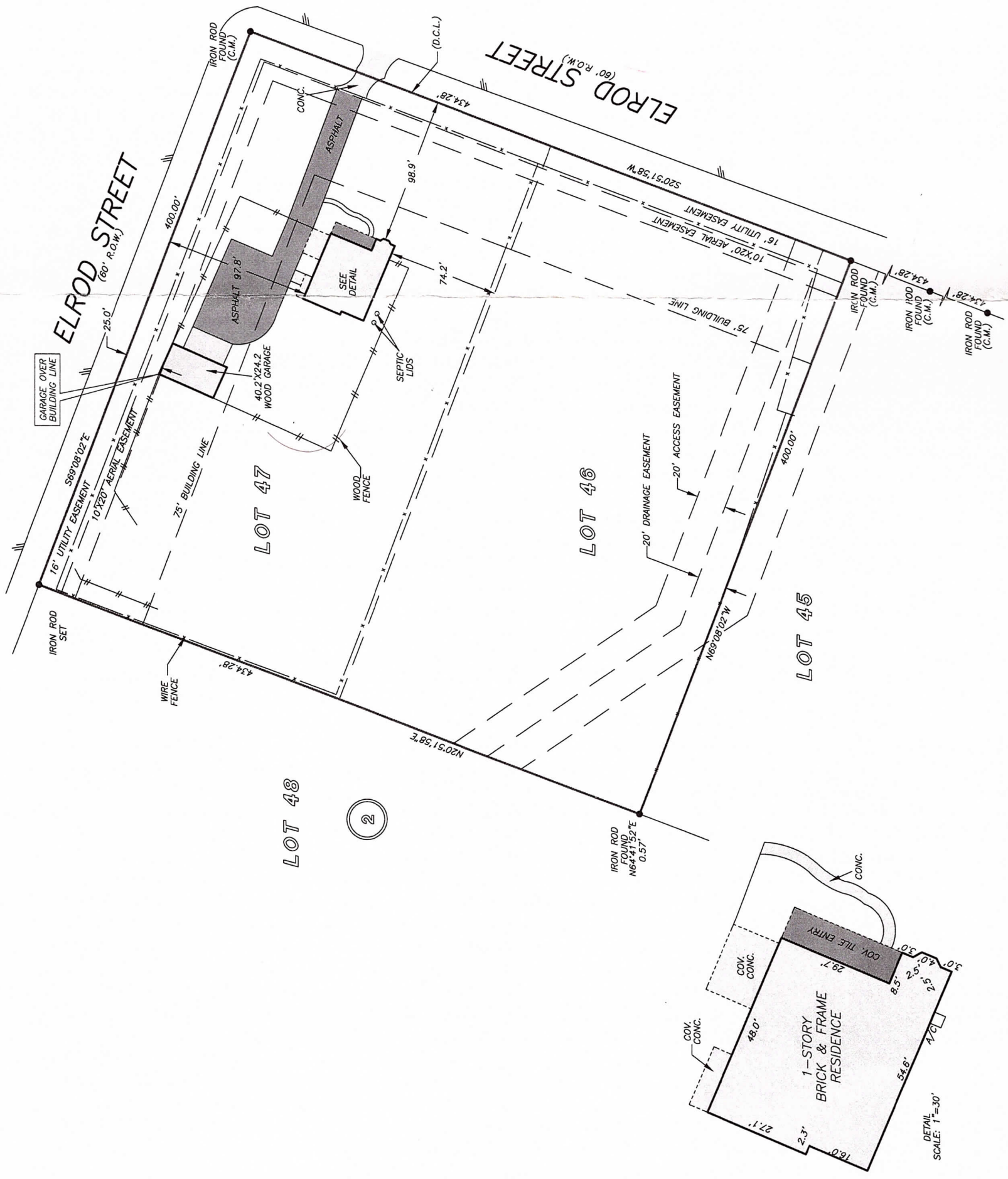

**PRECISION**  
 surveyors



CELEBRITY TITLE  
 KENNETH LESLIE  
 281-578-4035

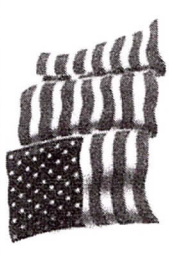

1-800-LANDSURVEY  
 www.precisionlandsurvey.com  
 281-496-1586 FAX 281-496-1867 210-829-4941  
 14925 MEMORIAL DRIVE SUITE B100 HOUSTON, TEXAS 77079 1777 NE LOOP 410 SUITE 600 SAN ANTONIO, TEXAS 78217