

(VOL. 1579, PG. 594, G.C.D.R.)

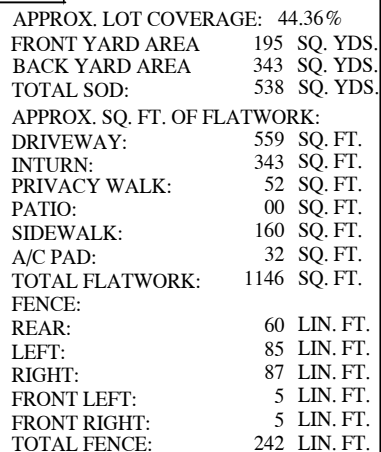

2321
TROCADERO LANE
(60' R.O.W.)

PLOT PLAN

SCALE: 1" = 20'

NOTES:

1. ALL BEARINGS SHOWN HEREON ARE BASED ON THE RECORDED PLAT.
2. SURVEYOR HAS NOT ABSTRACTED THE SUBJECT PROPERTY. ABSTRACTING BY TITLE COMPANY ONLY. ALL EASEMENTS, RESTRICTIONS AND OTHER MATTERS OF RECORD KNOWN TO SURVEYOR ARE SHOWN AND ARE BASED ON THE RECORDED PLAT AND/OR TITLE REPORT. ALLPOINTS LAND SURVEY, INC. IS NOT LIABLE FOR ANY DAMAGES DUE TO INFORMATION NOT PROVIDED TO SURVEYOR OR BUILDER PLACING ANY IMPROVEMENTS WITHIN A BUILDING LINE OR EASEMENT.
3. FLATWORK AND FENCING ARE FOR ILLUSTRATION PURPOSES ONLY. REFER TO MUNICIPALITY, HOA, POA, BUILDER GUIDELINES, DEED RESTRICTIONS OR LOCAL CODE FOR REQUIREMENTS. SPECIFIC INSTALLATION REQUIREMENTS TO BE VERIFIED BY BUILDER.

FOR: TAYLOR MORRISON HOMES
ADDRESS: 2321 TROCADERO LANE
ALLPOINTS JOB#: TM150842 BY: ARM
G.F.:
JOB:

LOT 14, BLOCK 2,
MAR BELLA, SECTION 15-A & B,
PLAT RECORD 2015075682, MAP RECORDS,
GALVESTON COUNTY, TEXAS

**taylor
morrison**

FLOOD ZONE:X

COMMUNITY PANEL:
4854880014D

EFFECTIVE DATE: 9/22/1999

LOMR:	DATE:
-------	-------

"THIS INFORMATION IS BASED ON GRAPHIC PLOTTING. WE DO NOT ASSUME RESPONSIBILITY FOR EXACT DETERMINATION"

ISSUE DATE: 2/6/2018

©2018, ALLPOINTS LAND SURVEY, INC.
All Rights Reserved