

ELECTRICAL LEGEND	
◇	Surface/Ceiling Mount
○	Recessed Eyeball Mount
○	Ground-up Landscape Flood
▽	Wall Mounted
◆	Recessed Canister
★	Recessed Flush
—	Single Fluorescent Strip
⋈	Double Flood (exterior)
◆	Keyless Light (pull chain)
□	Fluorescent Recessed Light
⊠	Exhaust Fan
⊠	Ceiling Heater
⊙	"J" Junction Box
□	Intercomm System
▽	Telephone Jack
⊠	Television Antenna / Cable Outlet
⊗	Network (CAT-5)
⊠	Speaker
⊠	Smoke Detector
⊠	Carbon Monoxide Detector
⊠	Duplex Outlet (110 volt)
⊠	Appliance Outlet (220 volt)
⊠ <sup>GF</sup>	Water Proof Outlet (GFI protected)
⊠	Ceiling Outlet (garage door opener)
⊠	Floor Outlet (pre-wire before pouring foundation)
⋈	Single Light Switch
⋈	Three Way Light Switch
⋈	Light Switch with Dimmer Control
✕	Ceiling Fan (provide proper ceiling brace)

ELECTRICAL PLAN  
SCALE 1/4" = 1'-0"

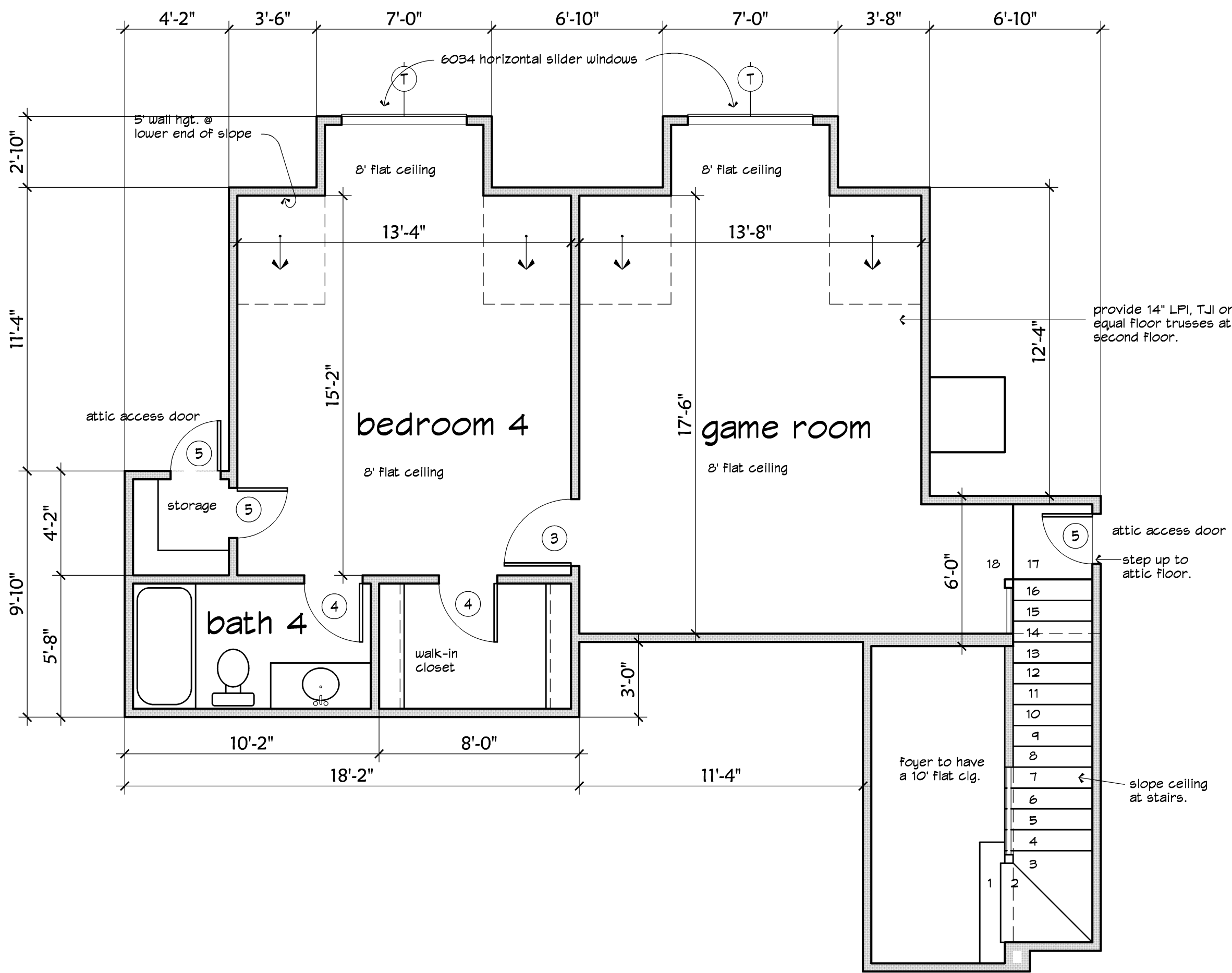

SECOND FLOOR PLAN  
SCALE 1/4" = 1'-0"

Home Plans are COPYRIGHTED! Korel Home Designs aka Karlovich Associates Inc. designed - and hold the copyrights to these House Plans. When purchasing sets of plans, either in electronic PDF form or on printed construction documents in return for payment of a one-time fee, we grant the buyer a limited license to use these Plans for the construction of ONE HOUSE. Just like books, movies, and songs, Federal Copyright Laws protect the Intellectual Property of Architects and Home Designers by giving copyright protection to home plans and designs. The possessor of these PDF files may have a reproduction company make the necessary copies to build this home only ONE TIME. To reuse these plans, Federal Law requires you to purchase an additional license. Thank You, Thank You Very Much, unless the LORD builds the house, The builders labor in vain.



KOREL HOME DESIGNS

P.O. Box 866986, Plano, Texas 75086-6986 - 1.800.400.9220

Cage Residence  
14702 Winding Hill Drive  
Magnolia, Texas

Design No.:  
T2884L  
Sheet:  
03