

SLOPE PATTERN = FLAT

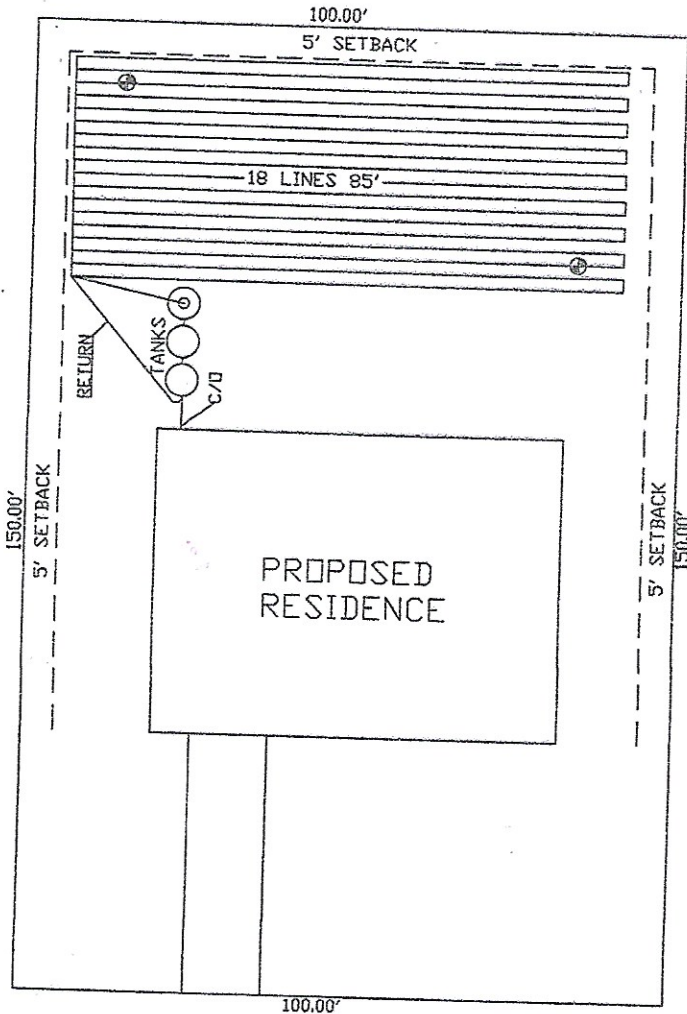

MONTGOMERY COUNTY INTERPOSES NO OBJECTIONS PROVIDED THE SYSTEM IS INSTALLED IN ACCORDANCE WITH THESE PLANS. ANY CHANGES TO EQUIPMENT SPECIFIED BY GRD WILL REQUIRE OFFICE APPROVAL PRIOR TO INSPECTION.

Permit # 20143 Initials MD Date 5-22-18

*Wes Hubert*  
 LICENSED PROFESSIONAL SANITARIAN

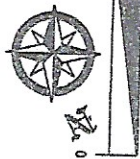

**CALCULATION SUMMARY:**  
 TOTAL NUMBER OF BEDROOMS: 4 ( UNDER 3,500 sq.ft. )  
 Q = 375 G.P.D.  
 APPLICATION RATE: 0.20 gal./sq.ft./DAY  
 TOTAL DRIP AREA REQUIRED = 1,875 sq.ft.  
 TOTAL DRIP AREA DESIGNED = 3,060 sq.ft.  
 INSTALL 1,530 LN. FT. OF DRIP TUBING 765 EMITTERS TOTAL  
 SET PUMP TO RUN 15 MINUTES 4 TIMES A DAY @ 5 GALLS. PER MINUTES  
 INSTALL A 0.5 h.p. PRO FLO SUBMERSIBLE PUMP ( OR EQUIV. )  
 DESIGN BASED ON FINDINGS BY SITE EVALUATOR

**EXISTING:**  
 TANKS = 500 GAL. PRETREATMENT TANK  
 500 G.P.D. AEROBIC TREATMENT UNIT  
 750 GAL. PUMP TANK W/HEADWORKS & FILTER  
 C/O = 2 WAY CLEAN-OUTS AT ALL STUB-OUTS FROM HOUSE  
 1 WAY CLEAN-OUTS EVERY 100' AND AT EVERY 90° TURN IN DIRECTION

⊕ = BORE HOLE SITE

NAME: BAITLEY RESIDENCE	SURVEY: M.D. LAWRENCE	Sterlingseptic57@gmail.com
ADDRESS: 10992 WOODS LANE	ABSTRACT: 310	DESIGNER: Wes Hubert
CITY, STATE, ZIP: TX, 77	LOT: 170	PHONE #: (936) 597-5558
SUBDIVISION: NORTH WOODS U/R	ACREAGE: .344	FAX #: (936) 597-8332
COUNTY: MONTGOMERY		DATE: 05-14-18
		SCALE: 1" = 30'