

Scale: 1" = 20.0'

Lot 38

Lot 39

S.10°08'34"W. 60.83'

Fnd. 1/2" w/cap

Cable Box

2 Cable Boxes

Fnd. 1/2" w/cap

7' U.E.
10' B/L

5' B/L

5' B/L

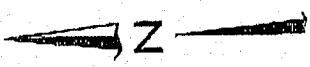

Lot 42

S.89°21'26"E. 148.85'

71.45'

20.8'

10.0'

29.10'

3427

Residence

55.2'

N.89°21'26"W. 138.81'

Lot 40

15.4'

13.15'

7.0'

14.3'

5.0'

5.0'

20.3'

20' Garage Setback

10' B/L & W.L.E

Fnd. 1/2" w/cap

N.00°38'34"E. 60.0'

Danbury Chase Trail
(50.0' R.O.W.)

- Note:
- B.L. - Building Line
 - San. S.E. - Sanitary Sewer easement
 - Stm. S.E. - Storm Sewer easement
 - U.E. - Utility easement
 - W.L.E. - Water line easement
 - R.O.W. - Right of Way
 - I.R. - Iron Rod
 - I.R. w/cap - Iron rod with plastic cap
 - Wood fence
 - Iron fence
 - Chain link fence
- Curves:
L = Length
R = Radius
Ch = Chord length

Per LOMR dated April 27, 2006 from FEMA, Case # 06-06 B011P, this subdivision appears to have been removed from a special flood hazard area, reference FIRM map #48157C0290-J effective January 3, 1997. Inherent inaccuracies of FEMA or flood control maps preclude a surveyor from certifying to the accuracy of potential flooding locations based on such maps. Surveyor is not liable for any flooding that may ever occur on this property.

- Bearings based on recorded plat
- Surveyor did not abstract property
- Property subject to all deed restrictions and restrictive covenants recorded or unrecorded including those stated in Schedule B Title Report
- Ⓢ indicates Controlling Monument

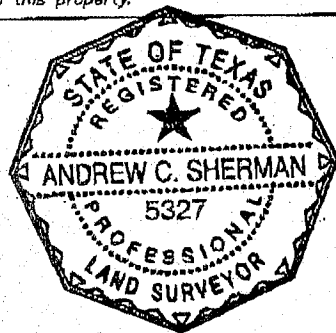

I hereby state that this survey was made on the ground under my supervision on April 18, 2007 and that this plat represents the circumstances at the time of the survey.

Andrew C. Sherman

4-19-07

Andrew C. Sherman, R.P.L.S. No. 5327

Date

LOT: 41	BLOCK: 5	SUBDIVISION: Cambridge Falls	SECTION: 1
RECORDATION: Plat #20050102 of the Plat Records			
ADDRESS: 3427 Danbury Chase Trail Fresno, Texas			COUNTY: Fort Bend
PURCHASER: Donald Barnease and Syzon Barnease		TITLE COMPANY: Priority Title	G.F. # 06303054
SSC SOUTHWEST SURVEYING CO. 11847 MEADOW TRAIL LANE MEADOWS PLACE, TEXAS 77477 (281) 588-3989 FAX (281) 584-3062			
			DRAWN BY: tgs DRAWING NO.: 04190713