

COPPERWOOD REGIONAL SHOPPING
CENTER SEC. 3, BLOCK 1
F.C. NO. 406104 H.C.M.R.

END. 5/8" I.R. S02°20'11"E 36.00' END. 5/8" I.R.

LOT 11
BLOCK 1

N87°39'49"E 148.81'

S87°39'49"W 149.00'

LOT 10

LOT 12

TWO STORY
BRICK & FRAME

Handwritten: 5/31/16
Rosen Duct 5-31-16

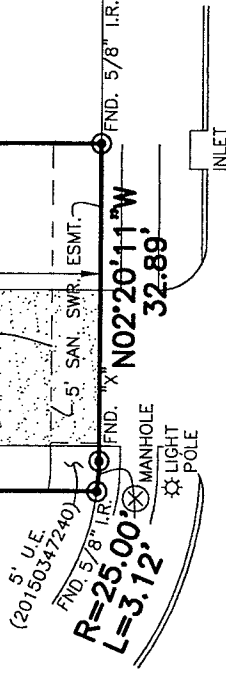

6714
FOUNTAIN MESA LANE
(50' R.O.W.)

NOTES:

1. ALL BEARINGS SHOWN HEREON ARE BASED ON THE RECORDED PLAT.
2. SUBJECT TO APPLICABLE RESTRICTIVE COVENANTS LISTED IN ITEM No.10--A, SCHEDULE "B" OF TITLE COMMITMENT ISSUED BY FIRST AMERICAN TITLE INSURANCE Co. UNDER G.F. No. 2132000-H078.
3. AGREEMENT FOR UNDERGROUND ELECTRIC SERVICE PER C.F. No. 20150246865.

© 2016, ALLPOINTS SERVICES, CORP., All Rights Reserved. This original work is protected under copyrights laws, Title 17 U.S. Code Sections 101 & 102. All violators will be prosecuted to the extent of the law. This survey is being provided solely for the use of the recipients and no license has been created, express or implied, to copy the survey except as is necessary in conjunction with the original transaction, which shall take place within ninety (90) days from the date adjacent to the signature line herein.

FLOOD MAP:

THIS PROPERTY LIES IN ZONE "X"
AS DEPICTED ON COMMUNITY PANEL
No. 48201 C 0610 L, DATED: 06-18-07
"THIS INFORMATION IS BASED ON GRAPHIC PLOTTING.
WE DO NOT ASSUME RESPONSIBILITY FOR EXACT
DETERMINATION"

PLAT OF SURVEY

SCALE: 1" = 20'

FOR: KB HOME

ADDRESS: 6714 FOUNTAIN
MESA LANE
ALLPOINTS JOB #: KB10892IDM
G.F.: 2132000-H078



ALLPOINTS
SERVICES CORP
PHONE: 713-468-7707
T.B.P.L.S. No. 10122600

LOT 11, BLOCK 1,
FOUNTAINS AT COPPERWOOD, REPLAT NO. 1,
FILM CODE NO. 674095, MAP RECORDS,
HARRIS COUNTY, TEXAS

I HEREBY CERTIFY THAT THIS PLAT REPRESENTS THE
RESULTS OF A SURVEY MADE ON THE GROUND, ON THE 21ST
DAY OF MAY, 2016.

Handwritten Signature: Steven P. Brister

