

Building Sketch

Borrower				
Property Address 2022 Spillers Ln				
City	Houston	County	State	TX Zip Code 77043
Lender/Client				

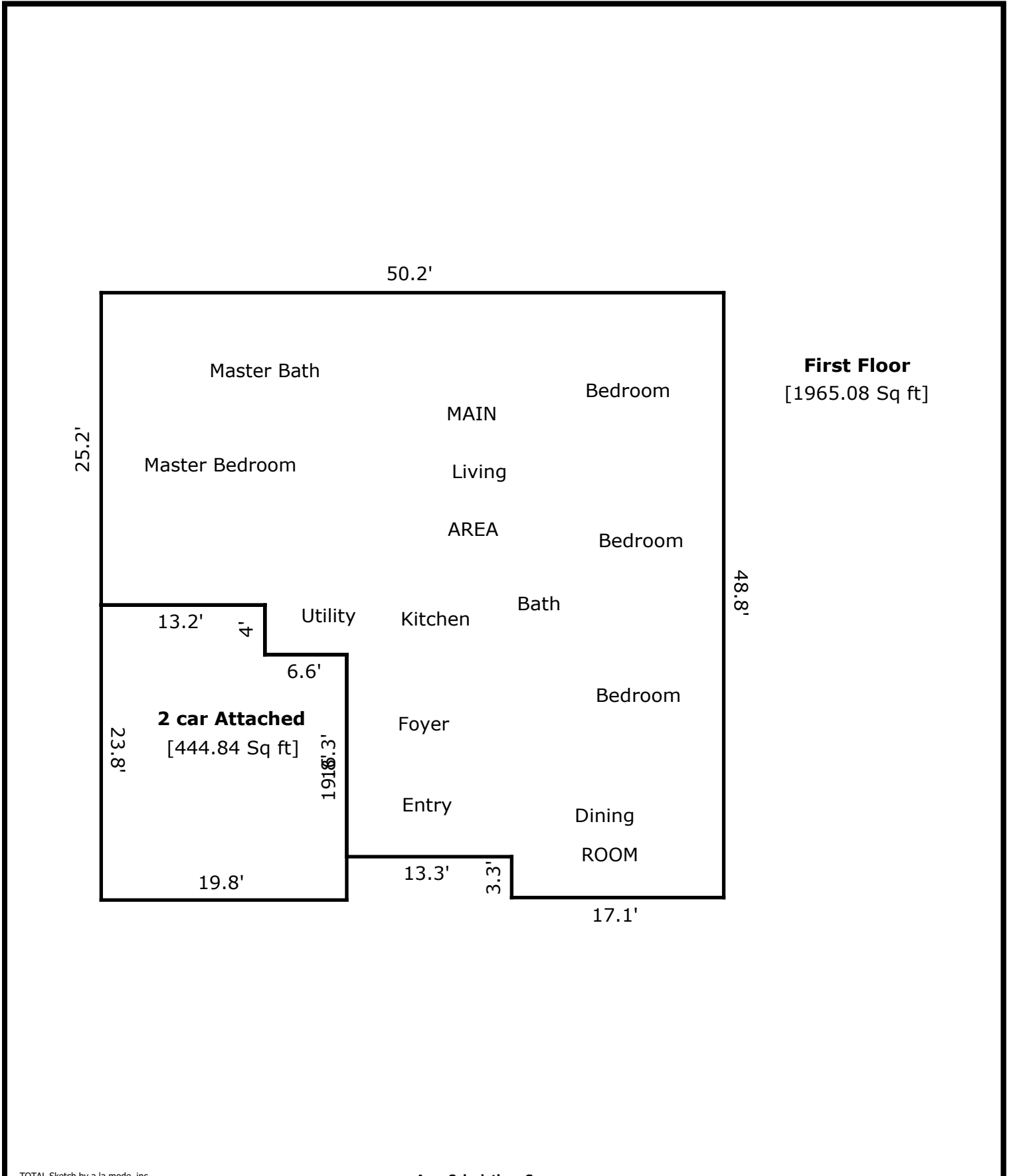

TOTAL Sketch by a la mode, inc.

Area Calculations Summary

Living Area	Area	Calculation Details
First Floor	1965.08 Sq ft	25.2 × 13.2 = 332.64 37 × 29.2 = 1080.46 19.6 × 17.1 = 335.16 13.3 × 16.3 = 216.82
Total Living Area (Rounded):	1965 Sq ft	
Non-living Area	Area	Calculation Details
2 car Attached	444.84 Sq ft	19.8 × 19.8 = 392.04 4 × 13.2 = 52.8