

"RESORT COUNTRY SECTION 1" SUBD.
 map in Vol. 3587
 6/3 7 R/PC
BOUNDARY SURVEY

TO ALL PARTIES INTERESTED IN TITLE TO THE PREMISES SURVEYED:

I CERTIFY THAT THIS IS A PLAT OF A SURVEY MADE ON THE GROUND OF A LOT CONTAINING 0.2971 AC. KNOWN AS 220 TEAL CIRCLE, LIVINGSTON T1351. THE PROPERTY OF DAVID REAVES (MARY JANE) SHOWING ACCURATELY ALL IMPROVEMENTS REQUIRED BY THE STATE OF TEXAS IN SPECIFICATION CATEGORY IA, CONDITION II, AS SURVEYED BY ME ON THE GROUND. **JUNE 15, 2015.** THE LEGAL DESCRIPTION BEING LOT 20, OF RESORT COUNTRY "SUBD. SECTION 1, FOLK COUNTY, TEXAS, CORRECT MAP OF WHICH IS RECORDED IN VOL. 6 PG. 37 OF THE POLK COUNTY PLAT-RECORDS. ALL CORNERS ARE MARKED AS SHOWN HEREON. THERE ARE NO FENCES, ENCROACHMENTS, OVERLAPPING OF IMPROVEMENTS, EASEMENTS, RIGHTS-OF-WAY, PAVING, BOUNDARY CONFLICTS, WATERWAYS, OR SHORTAGES IN AREA, EXCEPT AS SHOWN, AND SAID PROPERTY HAS ACCESS TO AND FROM A DEDICATED ROADWAY, EXCEPT AS SHOWN HEREON. LOT LIES IN A ZONE X DESIGNATION, AND IS NOT IN 100 YEAR FLOOD PLAIN, PER COMMUNITY - PANEL #48313C0450 C FLOOD INFORMATION RATE MAP DATED 9/3/10. FIELD REF: BS DRAWN BY: CM SCALE: 1" = 30 FT.

THE MCKINLEY COMPANY, INC.
 P.O. Box 4218
 Pasadena, Texas 77502
 Phone: (713) 473-3502

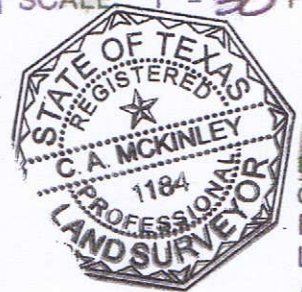

By: *C.A. McKinley* PRES.
 C.A. MCKINLEY LICENSE NO. 1184
 REGISTERED PROFESSIONAL STATE OF TEXAS
 LAND SURVEYOR

GF/PC-150276 (281-798-3674)