

TEXAS OFFICIAL WOOD DESTROYING INSECT REPORT

2913 Port Rose Ln
Inspected Address

League City
City

77573
Zip Code

SCOPE OF INSPECTION

- A. This inspection covers only the multi-family structure, primary dwelling or place of business. Sheds, detached garages, lean-tos, fences, guest houses or any other structure will not be included in this inspection report unless specifically noted in Section 5 of this report.
B. This inspection is limited to those parts of the structure(s) that are visible and accessible at the time of the inspection.
C. Due to the characteristics and behavior of various wood destroying insects, it may not always be possible to determine the presence of infestation without defacing or removing parts of the structure being inspected.
D. If visible evidence of active or previous infestation of listed wood destroying insects is reported, it should be assumed that some degree of damage is present.
E. If visible evidence is reported, it does not imply that damage should be repaired or replaced.
F. THIS IS NOT A STRUCTURAL DAMAGE REPORT OR A WARRANTY AS TO THE ABSENCE OF WOOD DESTROYING INSECTS.
G. If termite treatment (including pesticides, baits or other methods) has been recommended, the treating company must provide a diagram of the structure(s) inspected and proposed for treatment, label of pesticides to be used and complete details of warranty (if any).
H. There are a variety of termite control options offered by pest control companies.
I. There are some specific guidelines as to when it is appropriate for corrective treatment to be recommended.
J. If treatment is recommended based solely on the presence of conducive conditions, a preventive treatment or correction of conducive conditions may be recommended.

1A. Life after Bugs Name of Inspection Company
1B. TPCL #0691524 SPCS Business License Number
1C. P.O. Box 286 Address of Inspection Company
1D. Nick Jones Name of Inspector (Please Print)
1E. Certified Applicator Technician [] (check one) [X]

2. Case Number (VA/FHA/Other)
3. 05/02/2019 Inspection Date

4A. Anna Nocera Name of Person Purchasing Inspection
Seller [] Agent [] Buyer [X] Management Co. [] Other []
4B. Owner/Seller
4C. REPORT FORWARDED TO: Title Company or Mortgagee [] Purchaser of Service [] Seller [] Agent [X] Buyer [X]
(Under the Structural Pest Control regulations only the purchaser of the service is required to receive a copy)

The structure(s) listed below were inspected in accordance with the official inspection procedures adopted by the Texas Department of Agriculture Structural Pest Control Service. This report is made subject to the conditions listed under the Scope of Inspection. A diagram must be attached including all structures inspected.

5. List structure(s) inspected that may include residence, detached garages and other structures on the property. (Refer to Part A, Scope of Inspection)

6A. Were any areas of the property obstructed or inaccessible? Yes [X] No []
(Refer to Part B & C, Scope of Inspection) If "Yes" specify in 6B.

6B. The obstructed or inaccessible areas include but are not limited to the following:
Attic [] Insulated area of attic [] Plumbing Areas [] Planter box abutting structure []
Deck [] Sub Floors [] Slab Joints [] Crawl Space []
Soil Grade Too High [] Heavy Foliage [] Eaves [] Weepholes []
Other [] Specify: Furniture/Storage

7A. Conditions conducive to wood destroying insect infestation: Yes [X] No []
(Refer to Part J, Scope of Inspection) If "Yes" specify in 7B.

7B. Conducive Conditions include but are not limited to:
Debris under or around structure (K) [] Wood to Ground Contact (G) [] Formboards left in place (I) [] Excessive Moisture (J) []
Planter box abutting structure (O) [] Footing too low or soil line too high (L) [] Wood Rot (M) [] Heavy Foliage (N) [X]
Insufficient ventilation (T) [] Wood Pile in Contact with Structure (Q) [] Wooden Fence in Contact with the Structure (R) []
Other (C) [] Specify:

8. Inspection Reveals Visible Evidence in or on the structure:
8A. Subterranean Termites Active Infestation [] Previous Infestation [] Previous Treatment []
8B. Drywood Termites Active Infestation [] Previous Infestation [] Previous Treatment []

TEXAS OFFICIAL WOOD DESTROYING INSECT REPORT

The conditions conducive to insect infestation reported in 7A & 7B:

9. Will be or has been mechanically corrected by inspecting company:
If "Yes," specify corrections: _____

Yes [] No [X]

9A. Corrective treatment recommended for active infestation or evidence of previous infestation with no prior treatment as identified in Section 8. (Refer to Part G, H, and I, Scope of Inspection)

Yes [] No [X]

9B. A preventive treatment and/or correction of conducive conditions as identified in 7A & 7B is recommended as follows:
Specify reason: Trim trees

Yes [X] No []

Refer to Scope of Inspection Part J

10A. This company has treated or is treating the structure for the following wood destroying insects: N/A

If treating for subterranean termites, the treatment was: Partial [] Spot [] Bait [] Other []

N/A [X]

If treating for drywood termites or related insects, the treatment was: Full [] Limited [] N/A [X]

10B. N/A N/A N/A

Date of Treatment by Inspecting Company

Common Name of Insect

Name of Pesticide, Bait or Other Method

This company has a contract or warranty in effect for control of the following wood destroying insects:

Yes [X] No [] List Insects: N/A

If "Yes", copy(ies) of warranty and treatment diagram must be attached.

Diagram of Structure(s) Inspected

The inspector must draw a diagram including approximate perimeter measurements and indicate active or previous infestation and type of insect by using the following codes: E-Evidence of Infestation, A-Active; P-Previous; D-Drywood Termites; S-Subterranean Termites; F-Formosan Termites; C-Conducive Conditions; B-Wood Boring Beetles; H-Carpenter Ants; Other(s) - Specify _____

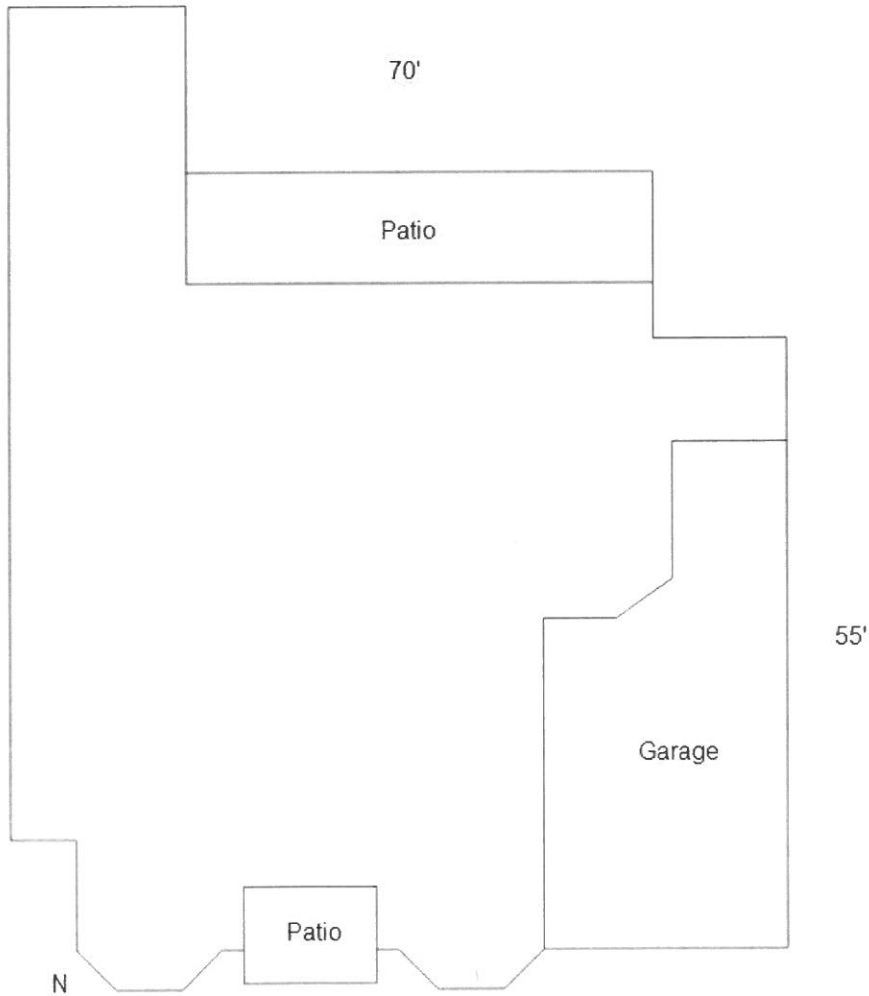

Additional Comments _____

Neither I nor the company for which I am acting have had, presently have, or contemplate having any interest in the property. I do further state that neither I nor the company for