

NOTES:  
 NO RECORDS SEARCH CONTRACTED. SURVEY PREPARED FROM TITLE COMPANY SPECIFICATIONS. CLIENT RELIES SOLELY ON TITLE COMPANY SPECIFICATIONS AS TO RECORD EASEMENTS, RESTRICTIONS, ROADWAYS, RIGHTS-OF-WAY, BUILDING LINES, ENCUMBRANCES, ETC.; CLIENT AND TITLE COMPANY HOLD TLTS, INC. HARMLESS FROM RESPONSIBILITY FOR SAME

- Restrictions as per recorded plat unless otherwise noted
- True ground distances shown
- Bearings assumed as platted
- File #2005080622, OCCGC
- 4' side building lines
- supercede 5' platted BL(s)
- Survey monuments reconciled w/previous surveys

LAND TITLE SURVEY OF A TRACT OF LAND being Lot 146, of EVIA PHASE ONE, a subdivision in Galveston County, Texas according to the map or plat thereof recorded in Volume 2004A, Page 186 in the Office of the County Clerk of Galveston County, Texas.

Subject property: 19 Evia Main  
 Galveston County, Texas  
 To John G. George, Carol S. George, Network Funding, L.P.  
 and Old Republic Title Company of Houston, File #13004781;  
 I hereby certify that this survey was made on the ground  
 under my direct supervision and that this plat correctly  
 represents the facts found at the time of the survey.

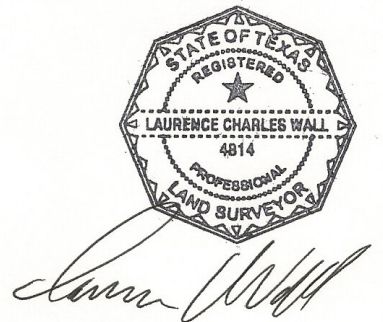

Laurence C. Wall  
 RPLS #4814  
 September 26, 2013

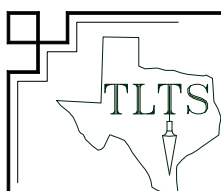

TLTS, Inc.  
 TEXAS LAND TITLE SURVEYORS  
 1801 Moody Avenue  
 Galveston, Texas 77550  
 (409) 765-8883