

CHAIN LINK FENCE  
 X  
 WOOD FENCE  
 ||

**NOTE:** Subject to the rights and restrictions of an easement rights reserved in restrictions recorded under Harris County Clerk's File No(s). X057353.

**NOTE:** Subject to the rights and restrictions of an unlocated access roadway reserved as set forth in instrument(s) filed in the office of the County Clerk's of Harris County, Texas under Clerk's File No. X220305 as amended by Z1900952 and and Z526490.

**NOTE:** An agreement with CenterPoint Energy Houston Electric, LLC and recorded under Harris County Clerk's File No(s). Y755513.

**NOTE:** An easement for encroachments created by construction settling and overhang of improvements, as set out in declaration of covenants, conditions and restrictions filed for record under Harris County Clerk's File No(s). Z057535.

**NOTE:** Agreement with H.L.&P. recorded under Clerk's File No. Y755513.

**NOTE:** Restrictive Covenants recorded under Clerk's File No. 597016, M.R.H.C. & under Clerk's File Nos. Z057535, Z155279, Z155281, Z167830, Z167836, 20060066622, 20060143148, 20060212020, 20070396704 & 20070683381.

**NOTE:** By graphic plotting only, the subject property does NOT appear to lie in the 100 year flood plain according to N.F.I.P. Map No. 480287 0510L 6-18-07 Zone X

**NOTE:** Bearings based on plat.

**NOTE:** All information shown on this survey relies on a commitment for Title Insurance as provided by the Title Company and GF Number referenced hereon, the surveyor did not research subject property.

**NOTE:** This Survey is certified for this transaction only, it is not transferrable to additional institutions or subsequent owners.

BUYER'S SIGNATURES			
X BUYER <b>Jose Roberto Perez and, Ismary Perez</b>		X Property Address <b>15922 Chart House Court</b>	
LOT <b>28</b>	BLOCK <b>2</b>	SUBDIVISION <b>LAKESHORE</b>	SECTION <b>1</b>
RECORDATION <b>Film Code No. 597016 M.R.H.C.</b>		COUNTY <b>Harris</b>	SURVEY <b>---</b>

**ELITE SURVEYING COMPANY, INC.**  
 P.O. BOX 1697\* PEARLAND, TX 77588  
 (281) 997-1585 Fax#(281) 485-6321

G.F.# **FTDAL14-FT0000007787**  
 DATE **4-8-08**  
 INVOICE # **01322**

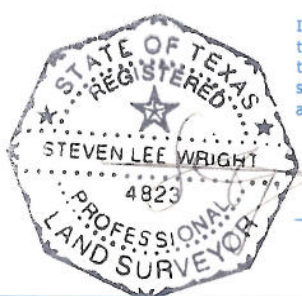

I do hereby certify that this survey was this day made on the ground of the property legally described hereon (or the attached sheet), and is correct, there are no encroachments unless shown, was done by me or under my supervision, and conforms to or exceeds to or exceeds the current standards as adopted by the Texas Board of Professional Land Surveying.

JOB # **4-72-08**

C.I.R.  
 SW MR  
 SM