



WES BUCHHORN, PE  
TIM BUCHHORN, PE

THIS DRAWING SET SHALL NOT BE USED FOR PERMITTING OR CONSTRUCTION UNLESS AN ENGINEERING SEAL FROM SOUTHEAST TEXAS ENGINEERING AND INSPECTIONS IS AFFIXED  
FIRM REGISTRATION #13882

NO.	ISSUE / REVISION	DATE
	ORIGINAL RELEASE	7-11-18

  
 SOUTHEAST TEXAS  
 ENGINEERING AND  
 INSPECTIONS, LLC  
 (OFFICE) 409-741-8741  
 (WES) 409-795-1415  
 (TIM) 409-795-1181  
  
 8017 HARBORSIDE DRIVE,  
 GALVESTON, TX 77554  
 SOUTHEASTTEXASENGINEERING.COM

ENGINEER STAMP AND SIGNATURE

7-11-18

**NEW RESIDENCE**  
 BUILDER: GERALD MERRIT  
 LOT 25, SEA ISLE SECTION 23  
 KENNEDY DRIVE  
 GALVESTON, TEXAS

TITLE  
ELEVATION VIEWS

DATE JULY 11, 2018	
SCALE $\frac{3}{32}'' = 1'-0''$	SHEET S3 OF 20

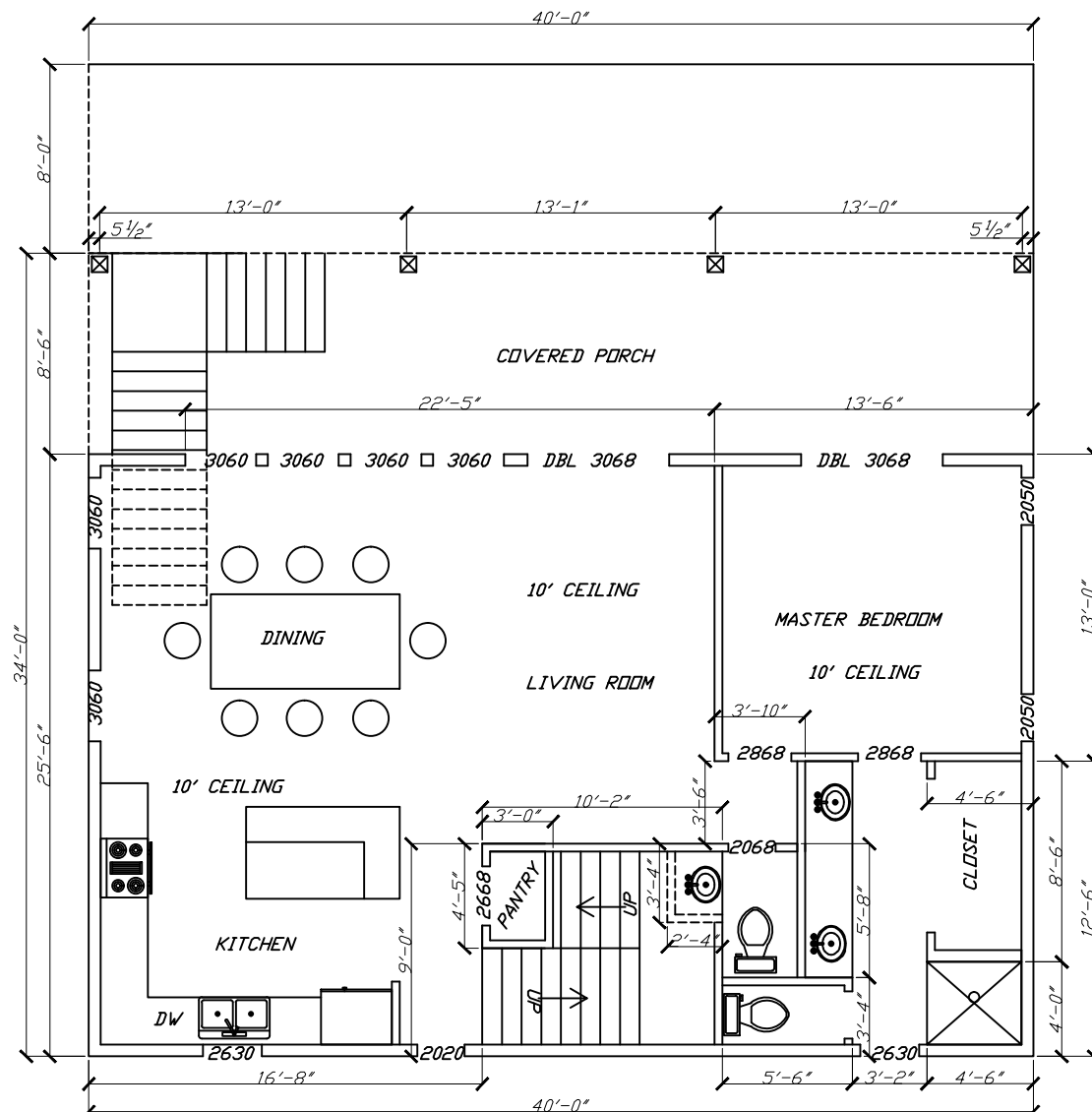

**1ST FLOOR LAYOUT**  
LIVING - 1020 FT<sup>2</sup>  
COVERED PORCH - 340 FT<sup>2</sup>

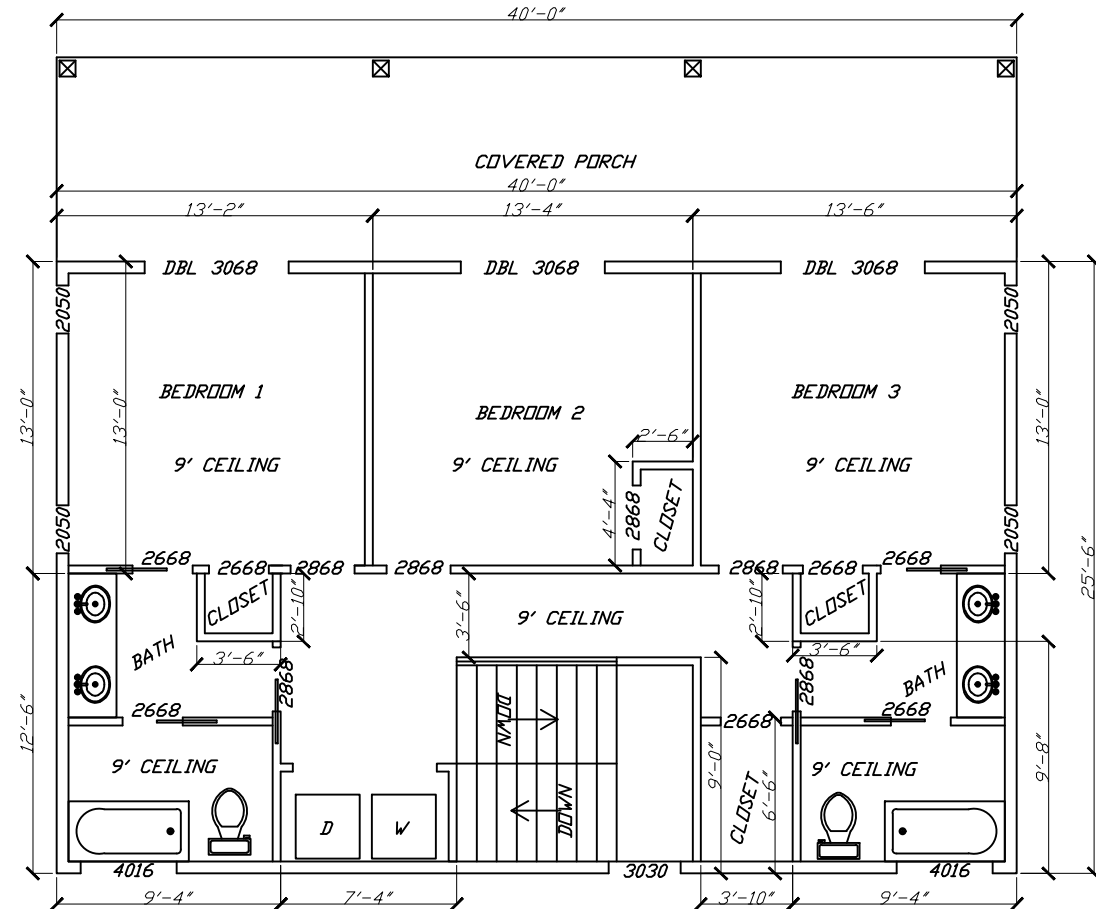



**2ND FLOOR LAYOUT**  
LIVING - 1020 FT<sup>2</sup>  
COVERED PORCH - 340 FT<sup>2</sup>

WES BUCHHORN, PE  
TIM BUCHHORN, PE

THIS DRAWING SET SHALL NOT BE USED FOR PERMITTING OR CONSTRUCTION UNLESS AN ENGINEERING SEAL FROM SOUTHEAST TEXAS ENGINEERING AND INSPECTIONS IS AFFIXED  
FIRM REGISTRATION #13882

NO.	ISSUE / REVISION	DATE
	ORIGINAL RELEASE	7-11-18

  
**SOUTHEAST TEXAS ENGINEERING AND INSPECTIONS, LLC**  
 (OFFICE) 409-741-8741  
 (WES) 409-795-1415  
 (TIM) 409-795-1181  
  
 8017 HARBORSIDE DRIVE,  
 GALVESTON, TX 77554  
 SOUTHEASTTEXASENGINEERING.COM

ENGINEER STAMP AND SIGNATURE

7-11-18

**NEW RESIDENCE**  
BUILDER: GERALD MERRIT  
LOT 25, SEA ISLE SECTION 23  
KENNEDY DRIVE  
GALVESTON, TEXAS

TITLE <b>FLOOR PLANS</b>	
DATE <b>JULY 11, 2018</b>	
SCALE $\frac{1}{8}"=1'-0"$	SHEET S3-1 OF 20