



TEXAS ASSOCIATION OF REALTORS®  
**INFORMATION ABOUT ON-SITE SEWER FACILITY**

USE OF THIS FORM BY PERSONS WHO ARE NOT MEMBERS OF THE TEXAS ASSOCIATION OF REALTORS® IS NOT AUTHORIZED.  
 ©Texas Association of REALTORS®, Inc., 2004

CONCERNING THE PROPERTY AT 13911 State Hwy 30  
College Station, Tx 77845-3747

**A. DESCRIPTION OF ON-SITE SEWER FACILITY ON PROPERTY:**

- (1) Type of Treatment System:  Septic Tank  Aerobic Treatment  Unknown
- (2) Type of Distribution System: Field Line  Unknown
- (3) Approximate Location of Drain Field or Distribution System: SEE ATTACHMENT  Unknown
- (4) Installer: HEATH  Unknown
- (5) Approximate Age: 24 YEARS  Unknown

**B. MAINTENANCE INFORMATION:**

- (1) Is Seller aware of any maintenance contract in effect for the on-site sewer facility?  Yes  No  
 If yes, name of maintenance contractor: \_\_\_\_\_  
 Phone: \_\_\_\_\_ contract expiration date: \_\_\_\_\_  
*Maintenance contracts must be in effect to operate aerobic treatment and certain non-standard on-site sewer facilities.)*
- (2) Approximate date any tanks were last pumped? \_\_\_\_\_
- (3) Is Seller aware of any defect or malfunction in the on-site sewer facility?  Yes  No  
 If yes, explain: \_\_\_\_\_
- (4) Does Seller have manufacturer or warranty information available for review?  Yes  No

**C. PLANNING MATERIALS, PERMITS, AND CONTRACTS:**

- (1) The following items concerning the on-site sewer facility are attached:  
 planning materials  permit for original installation  final inspection when OSSF was installed  
 maintenance contract  manufacturer information  warranty information \_\_\_\_\_
- (2) "Planning materials" are the supporting materials that describe the on-site sewer facility that are submitted to the permitting authority in order to obtain a permit to install the on-site sewer facility.
- (3) **It may be necessary for a buyer to have the permit to operate an on-site sewer facility transferred to the buyer.**

D. INFORMATION FROM GOVERNMENTAL AGENCIES: Pamphlets describing on-site sewer facilities are available from the Texas Agricultural Extension Service. Information in the following table was obtained from Texas Commission on Environmental Quality (TCEQ) on 10/24/2002. The table estimates daily wastewater usage rates. Actual water usage data or other methods for calculating may be used if accurate and acceptable to TCEQ.

<u>Facility</u>	<u>Usage (gal/day) without water-saving devices</u>	<u>Usage (gal/day) with water-saving devices</u>
Single family dwelling (1-2 bedrooms; less than 1,500 sf)	225	180
Single family dwelling (3 bedrooms; less than 2,500 sf)	300	240
Single family dwelling (4 bedrooms; less than 3,500 sf)	375	300
Single family dwelling (5 bedrooms; less than 4,500 sf)	450	360
Single family dwelling (6 bedrooms; less than 5,500 sf)	525	420
Mobile home, condo, or townhouse (1-2 bedroom)	225	180
Mobile home, condo, or townhouse (each add'l bedroom)	75	60

This document is not a substitute for any inspections or warranties. This document was completed to the best of Seller's knowledge and belief on the date signed. Seller and real estate agents are not experts about on-site sewer facilities. Buyer is encouraged to have the on-site sewer facility inspected by an inspector of Buyer's choice.



05/08/2019

Signature of Seller  
Charlie Hall

Date



05/08/2019

Signature of Seller  
Alice Hall

Date

Receipt acknowledged by:

Signature of Buyer

Date

Signature of Buyer

Date



# BRAZOS COUNTY HEALTH DEPARTMENT

201 NORTH TEXAS AVENUE • BRYAN, TEXAS 77803-5317  
409/361-4440 409/361-4450

## LICENSE TO OPERATE Private On-Site Sewerage Facility Brazos County, Texas

License Number: 95163 Installer: James Heath Bedrooms: 3

Name: Charlie Hall Date: September 18, 1995

Location Address: 13911 S.H. 30, College Station, Texas 77845

Mailing Address: 13911 S.H. 30, College Station, Texas 77845

Subdivision Name: N/A Lot    Block    Phase   

In accordance with a court order by the Brazos County Commissioners Court on August 26, 1975, a license is hereby granted to the above named licensee for a private sewerage facility being maintained on the above described property.

The private sewerage facility licensed is that described in an application dated August 23, 1995, and on the basis of a final construction inspection made on August 24, 1995, the system had been installed according to the current minimum State and County standards. However, the inspection revealed the following factors which could cause problems and may require future corrective actions:

---

This non-transferable license is for a term of five years and will expire on August 23, 2000. This license must be renewed for successive terms of five years upon application of the licensee for renewal and payment of the renewal fee, provided that the continued use of the facility is not in conflict with the County order. Should the system malfunction in the future, it will be the licensee's responsibility to bring the system in compliance with all current regulations.

This license does not extend to the materials, workmanship, or fabrication of the system, so as to expressly or impliedly grant the licensee or installer of the system any warranty by or rights against Brazos County and/or the Brazos County Health Department as to quality or durability of the system nor compliance with licensee's individual specification and requirements, but solely relates to the system meeting the requirements of the above-named regulatory body in effect as of this date.

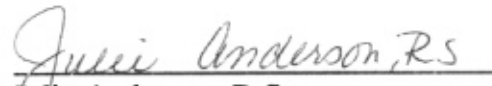
  
Julie Anderson, R.S.  
Environmental Health Specialist



CHARLES HALL

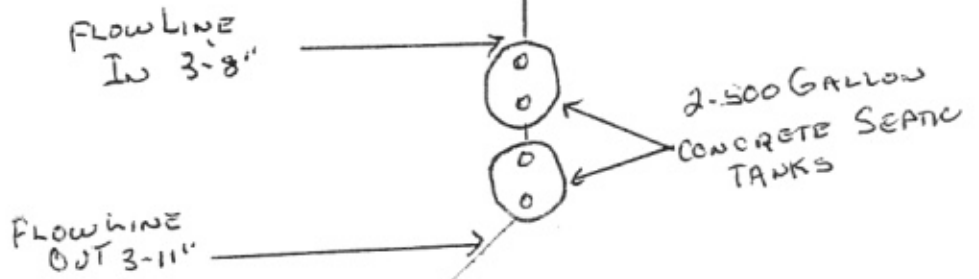
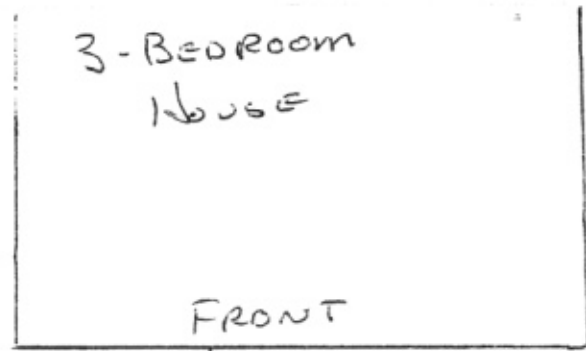

APPROX 140' SEPTIC  
4" PVC

580 Sq. Ft. SEPTIC SYSTEM  
IS 150' OR MORE FROM ANY  
WATER WELL 75' OR MORE  
FROM ANY POND OR STREAM  
10' OR MORE FROM ANY  
WATER LINE OR PROPERTY  
LINE GRADES TAKEN  
BY JAMES HEATH 8-26-95

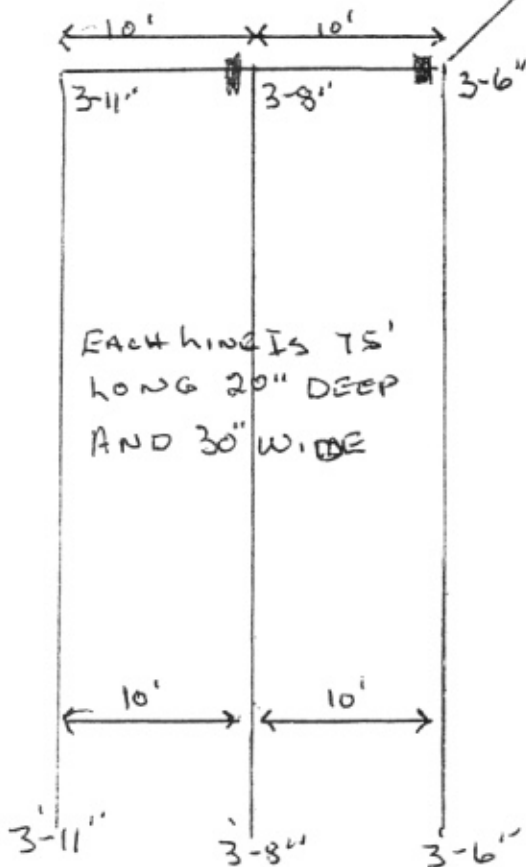

BRAZOS COUNTY HEALTH DEPT.  
201 NORTH TEXAS AVE.  
BRYAN, TEXAS 77803-5317

8-24-95  
Gita Anderson, RS