

NOTE: ROUNDED SHEETROCK CORNERS WHOLE HOUSE except at windows

NOTE:
 5 1/4" BASE BOARDS
 3 1/4" DOOR CASING
 (DOORS TO BE 6"± FROM CORNERS WHERE POSSIBLE TO ALLOW FOR WIDER CASING)

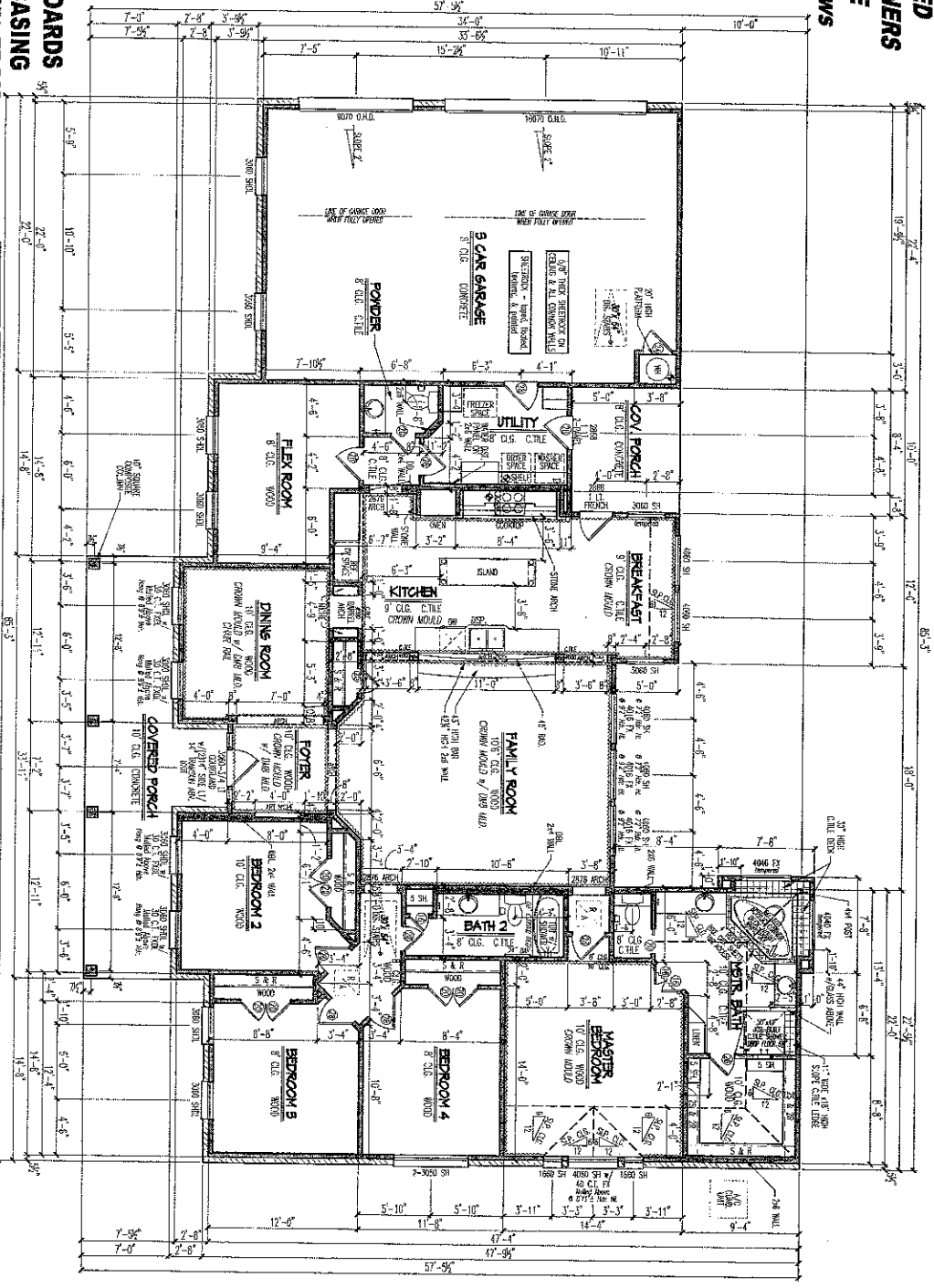

HVAC NOTE:
 SYSTEM TO BE INSTALLED IN ADJACENT CABINET

PLUMBING NOTE:
 COOKTOP GAS SHUT-OFF VALVE TO BE LOCATED IN ADJACENT CABINET

TOILET, RIMS TO BE BLENDED & MOUNTED @ 57" AFF.
TOILET PAPER HOLDERS TO BE BLENDED & MOUNTED @ 27" AFF.
NOSE RACK TO BE BLENDED & MOUNTED @ 27" AFF.
TOWEL RACK TO BE BLENDED & MOUNTED @ 57" AFF.
SHOWER RIMS TO BE BLENDED & MOUNTED @ 57" AFF. THE DESK.

FLOOR PLAN
 Scale: 1/8" = 1'-0"

MR. & MRS. Kevin Quick
JOB # 1122350
Grimes County



11-4/2/2012.dwg
 CP
 RW
 RW
 RW

MS 02-5 C
SAN JACINTO

The measurements, dimensions and other specifications shown on this document are guidelines for construction use only. The actual specifications of the finished structure may vary. This document may not be relied on as a representation of what the completed structure will look like.