

Lot 55

Lot 54

Lot 53

2" Metal Post @ Corner

2" Metal Post @ Corner

N73°17'00"E 58.00'

5' U.E.

5' x 20' A.E.

Lot 46

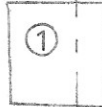

25' B.L. V-832, P-595

103.40'

103.40'

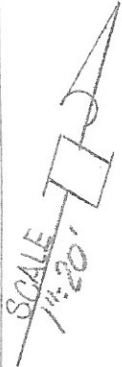

5' B.L. V-832, P-595

1 Story Frame

5' B.L. V-832, P-595

Lot 45

Lot 47

25' B.L. V-832, P-595

N16°43'00"W

S16°43'00"E

STATE HIGHWAY #87 (VARIABLE ROW)

Found 1/2" Iron Rod

S73°17'00"W 58.00'

Found 5/8" Iron Rod

(110) DOLPHIN AVENUE

Found 5/8" Iron Rod

① = 10' x 10' Frame Shed On Blocks

(50' ROW)

—||— = 6' Wood Fence

—X— = 4' Chain Link Fence



= Cov. Conc.



= Conc.

NOTE: Restrictive Covenants as recorded in V-832, P-595.

BUYER

Richard S. Moore and Phyllis H. Moore

PROPERTY ADDRESS

110 Dolphin Avenue

DESCRIBED PROPERTY

Lot 46, of LINDALE PARK, a subdivision in Galveston County, Texas, according to the map or plat thereof, recorded in Volume 254-A, Page 61, in the Office of the County Clerk of Galveston County, Texas.

① = 10' x 10' Frame Shed On Blocks

(50 ROW)

—||— = 6' Wood Fence

—X— = 4' Chain Link Fence

⊗ = Cov. Conc.

⊠ = Conc.

NOTE: Restrictive Covenants as recorded in V-832, P-595.

BUYER Richard S. Moore and Phyllis H. Moore	PROPERTY ADDRESS 110 Dolphin Avenue
---	--

DESCRIBED PROPERTY  
 Lot 46, of LINDALE PARK, a subdivision in Galveston County, Texas, according to the map or plat thereof, recorded in Volume 254-A, Page 61, in the Office of the County Clerk of Galveston County, Texas.



I do hereby certify that this survey was this day made on the ground of the property legally described hereon, (or on the attached sheet), is correct, and there are no encroachments except as shown, and was done by me or under my supervision, and conforms to or exceeds the current standards as adopted by the Texas Board of Professional Land Surveying.

*H.T. Weber*

SUBJECT PROPERTY DOES  LIE IN A F.I.A. DESIGNATED FLOOD ZONE AS PER FLOOD MAP NO:  
 485469 009 F 12-6-02 Zone AE

INVOICE #	34553	JOB #	9-34-06
G.F. #	06208475	DATE	9-6-06

NOTES  
 -ALL BEARINGS ARE PER PLAT, DEED, OR AS ASSUMED  
 -THIS SURVEY IS CERTIFIED FOR THIS TRANSACTION ONLY, IT IS NOT TRANSFERABLE TO ADDITIONAL INSTITUTIONS OR SUBSEQUENT OWNERS.  
 -SUBJECT TO ANY AND ALL RECORDED AND UNRECORDED EASEMENTS.  
 -FLOOD INFORMATION IS BASED ON GRAPHIC PLOTTING ONLY, DUE TO INHERENT INACCURACIES ON FEMA MAPS, WE CANNOT ASSUME RESPONSIBILITY FOR EXACT DETERMINATION.  
 -THERE ARE NO NATURAL DRAINAGE COURSES ON THIS PROPERTY.

OFFICE	ME	<b>SURVEY 1, INC.</b> P. O. BOX 2543 • ALVIN, TX 77512 (281) 393-1382 • Fax (281) 393-1383
DRAFTING	DP/	
FINAL CHECK		

# ELEVATION CERTIFICATE

OMB No. 1660-0008  
Expires February 28, 2009

Important: Read the instructions on pages 1-8.

## SECTION A - PROPERTY INFORMATION

A1. Building Owner's Name Moore Job # 9-34-06 slf		For Insurance Company Use:
A2. Building Street Address (including Apt., Unit, Suite, and/or Bldg. No.) or P.O. Route and Box No. 110 Dolphin Avenue		Policy Number
City Galveston State TX ZIP Code 77550		Company NAIC Number
A3. Property Description (Lot and Block Numbers, Tax Parcel Number, Legal Description, etc.) Lot 46 Lindale Park		
A4. Building Use (e.g., Residential, Non-Residential, Addition, Accessory, etc.) <u>Residential</u>		
A5. Latitude/Longitude: Lat. <u>29 deg 19 min 03 sec N</u> Long. <u>94 deg 46 min 12 sec W</u>		Horizontal Datum: <input checked="" type="checkbox"/> NAD 1927 <input type="checkbox"/> NAD 1983
A6. Attach at least 2 photographs of the building if the Certificate is being used to obtain flood insurance.		
A7. Building Diagram Number <u>1</u>		
A8. For a building with a crawl space or enclosure(s), provide		A9. For a building with an attached garage, provide:
a) Square footage of crawl space or enclosure(s) <u>N/A</u> sq ft		a) Square footage of attached garage <u>242</u> sq ft
b) No. of permanent flood openings in the crawl space or enclosure(s) walls within 1.0 foot above adjacent grade <u>N/A</u>		b) No. of permanent flood openings in the attached garage walls within 1.0 foot above adjacent grade <u>0</u>
c) Total net area of flood openings in A8.b <u>N/A</u> sq in		c) Total net area of flood openings in A9.b <u>N/A</u> sq in

## SECTION B - FLOOD INSURANCE RATE MAP (FIRM) INFORMATION

B1. NFIP Community Name & Community Number 485469 Galveston		B2. County Name Galveston		B3. State Texas	
B4. Map/Panel Number 485469 0009	B5. Suffix F	B6. FIRM Index Date 12-6-02	B7. FIRM Panel Effective/Revised Date 12-6-02	B8. Flood Zone(s) AE	B9. Base Flood Elevation(s) (Zone AO, use base flood depth) 11.0'
B10. Indicate the source of the Base Flood Elevation (BFE) data or base flood depth entered in Item B9. <input type="checkbox"/> FIS Profile <input checked="" type="checkbox"/> FIRM <input type="checkbox"/> Community Determined <input type="checkbox"/> Other (Describe) _____					
B11. Indicate elevation datum used for BFE in Item B9: <input checked="" type="checkbox"/> NGVD 1929 <input type="checkbox"/> NAVD 1988 <input type="checkbox"/> Other (Describe) _____					
B12. Is the building located in a Coastal Barrier Resources System (CBRS) area or Otherwise Protected Area (OPA)? <input type="checkbox"/> Yes <input checked="" type="checkbox"/> No Designation Date _____ <input type="checkbox"/> CBRS <input type="checkbox"/> OPA					

## SECTION C - BUILDING ELEVATION INFORMATION (SURVEY REQUIRED)

C1. Building elevations are based on:  Construction Drawings\*  Building Under Construction\*  Finished Construction  
\*A new Elevation Certificate will be required when construction of the building is complete.

C2. Elevations - Zones A1-A30, AE, AH, A (with BFE), VE, V1-V30, V (with BFE), AR, AR/A, AR/AE, AR/A1-A30, AR/AH, AR/AO. Complete Items C2.a-g below according to the building diagram specified in Item A7.  
Benchmark Utilized \_\_\_\_\_ Vertical Datum \_\_\_\_\_  
Conversion/Comments \_\_\_\_\_

Check the measurement used.

a) Top of bottom floor (including basement, crawl space, or enclosure floor),	<u>10.64</u>	<input checked="" type="checkbox"/> feet <input type="checkbox"/> meters (Puerto Rico only)
b) Top of the next higher floor	<u>N/A</u>	<input type="checkbox"/> feet <input type="checkbox"/> meters (Puerto Rico only)
c) Bottom of the lowest horizontal structural member (V Zones only)	<u>N/A</u>	<input type="checkbox"/> feet <input type="checkbox"/> meters (Puerto Rico only)
d) Attached garage (top of slab)	<u>10.01</u>	<input checked="" type="checkbox"/> feet <input type="checkbox"/> meters (Puerto Rico only)
e) Lowest elevation of machinery or equipment servicing the building (Describe type of equipment in Comments)	<u>10.88</u>	<input checked="" type="checkbox"/> feet <input type="checkbox"/> meters (Puerto Rico only)
f) Lowest adjacent (finished) grade (LAG)	<u>9.72</u>	<input checked="" type="checkbox"/> feet <input type="checkbox"/> meters (Puerto Rico only)
g) Highest adjacent (finished) grade (HAG)	<u>9.87</u>	<input checked="" type="checkbox"/> feet <input type="checkbox"/> meters (Puerto Rico only)

## SECTION D - SURVEYOR, ENGINEER, OR ARCHITECT CERTIFICATION

This certification is to be signed and sealed by a land surveyor, engineer, or architect authorized by law to certify elevation information. I certify that the information on this Certificate represents my best efforts to interpret the data available. I understand that any false statement may be punishable by fine or imprisonment under 18 U.S. Code, Section 1001.

Check here if comments are provided on back of form.

Certifier's Name H. T. Weber		License Number 4101	
Title R. P. L. S.	Company Name Survey 1, Inc.		
Address P. O. Box 2543	City Alvin	State TX	ZIP Code 77512
Signature <i>H. T. Weber</i>	Date 9/6/06	Telephone 281-393-1382	

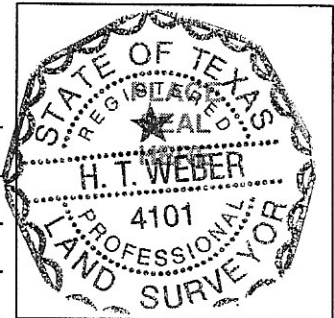

**IMPORTANT: In these spaces, copy the corresponding information from Section A.**

For Insurance Company Use:

Building Street Address (including Apt., Unit, Suite, and/or Bldg. No.) or P.O. Route and Box No.  
110 Dolphin Avenue

Policy Number

City Galveston State TX ZIP Code 77550

Company NAIC Number

**SECTION D - SURVEYOR, ENGINEER, OR ARCHITECT CERTIFICATION (CONTINUED)**

Copy both sides of this Elevation Certificate for (1) community official, (2) insurance agent/company, and (3) building owner.

Comments C2e is for A/C

Signature *H.T. Webb*

Date *9/6/09*

Check here if attachments

**SECTION E - BUILDING ELEVATION INFORMATION (SURVEY NOT REQUIRED) FOR ZONE AO AND ZONE A (WITHOUT BFE)**

For Zones AO and A (without BFE), complete Items E1-E5. If the Certificate is intended to support a LOMA or LOMR-F request, complete Sections A, B, and C. For Items E1-E4, use natural grade, if available. Check the measurement used. In Puerto Rico only, enter meters.

- E1. Provide elevation information for the following and check the appropriate boxes to show whether the elevation is above or below the highest adjacent grade (HAG) and the lowest adjacent grade (LAG).
  - a) Top of bottom floor (including basement, crawl space, or enclosure) is \_\_\_\_\_  feet  meters  above or  below the HAG.
  - b) Top of bottom floor (including basement, crawl space, or enclosure) is \_\_\_\_\_  feet  meters  above or  below the LAG.
- E2. For Building Diagrams 6-8 with permanent flood openings provided in Section A Items 8 and/or 9 (see page 8 of Instructions), the next higher floor (elevation C2.b in the diagrams) of the building is \_\_\_\_\_  feet  meters  above or  below the HAG.
- E3. Attached garage (top of slab) is \_\_\_\_\_  feet  meters  above or  below the HAG.
- E4. Top of platform of machinery and/or equipment servicing the building is \_\_\_\_\_  feet  meters  above or  below the HAG.
- E5. Zone AO only: If no flood depth number is available, is the top of the bottom floor elevated in accordance with the community's floodplain management ordinance?  Yes  No  Unknown. The local official must certify this information in Section G.

**SECTION F - PROPERTY OWNER (OR OWNER'S REPRESENTATIVE) CERTIFICATION**

The property owner or owner's authorized representative who completes Sections A, B, and E for Zone A (without a FEMA-issued or community-issued BFE) or Zone AO must sign here. *The statements in Sections A, B, and E are correct to the best of my knowledge.*

Property Owner's or Owner's Authorized Representative's Name

Address \_\_\_\_\_ City \_\_\_\_\_ State \_\_\_\_\_ ZIP Code \_\_\_\_\_

Signature \_\_\_\_\_ Date \_\_\_\_\_ Telephone \_\_\_\_\_

Comments

Check here if attachments

**SECTION G - COMMUNITY INFORMATION (OPTIONAL)**

The local official who is authorized by law or ordinance to administer the community's floodplain management ordinance can complete Sections A, B, C (or E), and G of this Elevation Certificate. Complete the applicable item(s) and sign below. Check the measurement used in Items G8. and G9.

- G1.  The information in Section C was taken from other documentation that has been signed and sealed by a licensed surveyor, engineer, or architect who is authorized by law to certify elevation information. (Indicate the source and date of the elevation data in the Comments area below.)
- G2.  A community official completed Section E for a building located in Zone A (without a FEMA-issued or community-issued BFE) or Zone AO.
- G3.  The following information (Items G4.-G9.) is provided for community floodplain management purposes.

G4. Permit Number	G5. Date Permit Issued	G6. Date Certificate Of Compliance/Occupancy Issued
-------------------	------------------------	---

- G7. This permit has been issued for:  New Construction  Substantial Improvement
- G8. Elevation of as-built lowest floor (including basement) of the building: \_\_\_\_\_  feet  meters (PR) Datum \_\_\_\_\_
- G9. BFE or (in Zone AO) depth of flooding at the building site: \_\_\_\_\_  feet  meters (PR) Datum \_\_\_\_\_

Local Official's Name \_\_\_\_\_ Title \_\_\_\_\_

Community Name \_\_\_\_\_ Telephone \_\_\_\_\_

Signature \_\_\_\_\_ Date \_\_\_\_\_

Comments

Check here if attachments

*W. S. P. Wilson* *W. S. P. Wilson*