

Butyqin Design v 1







Butryn Design v 2

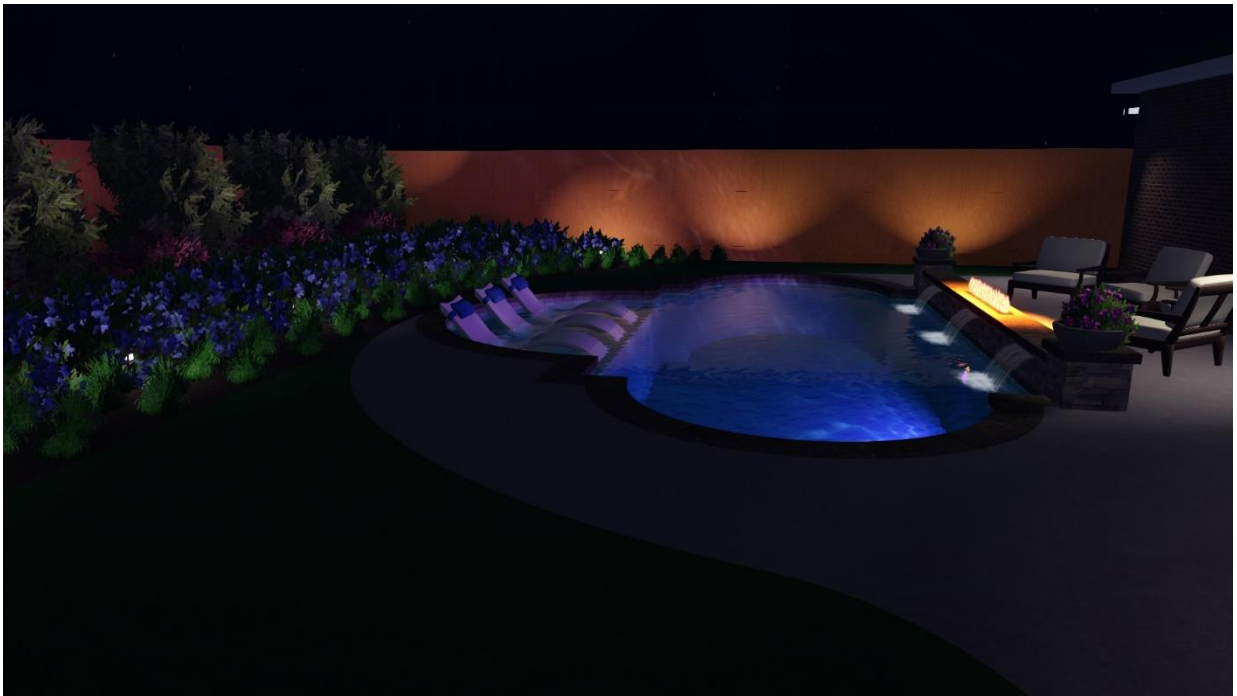



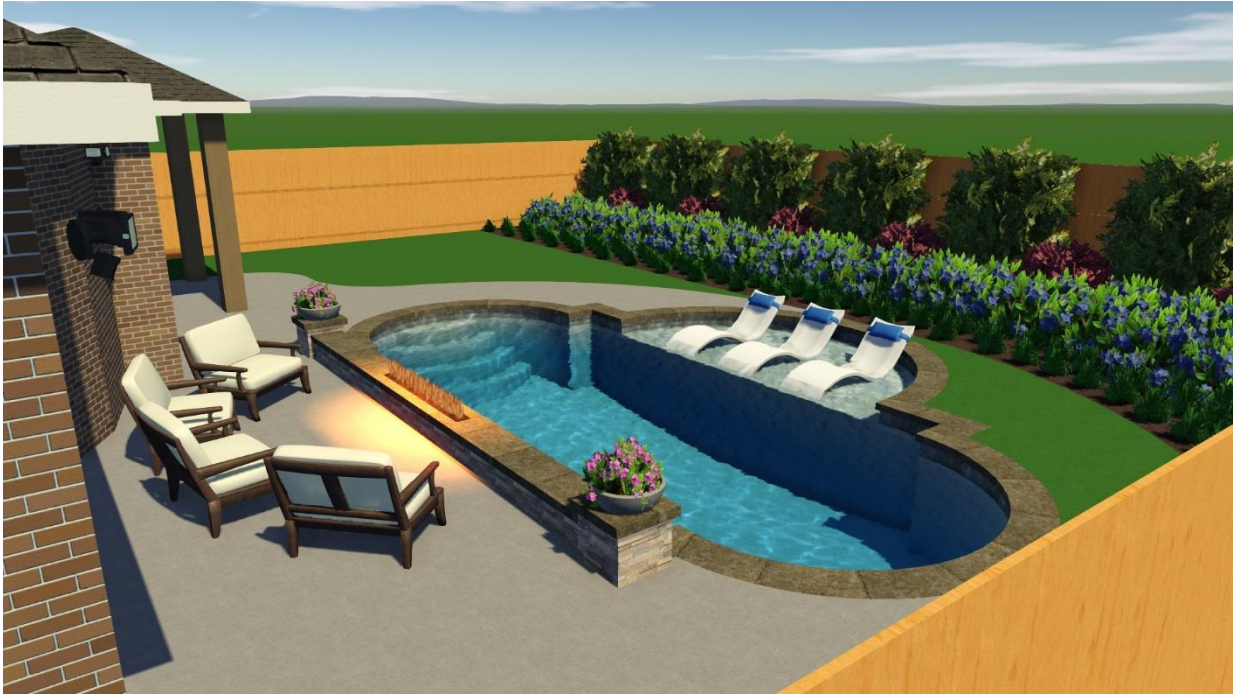

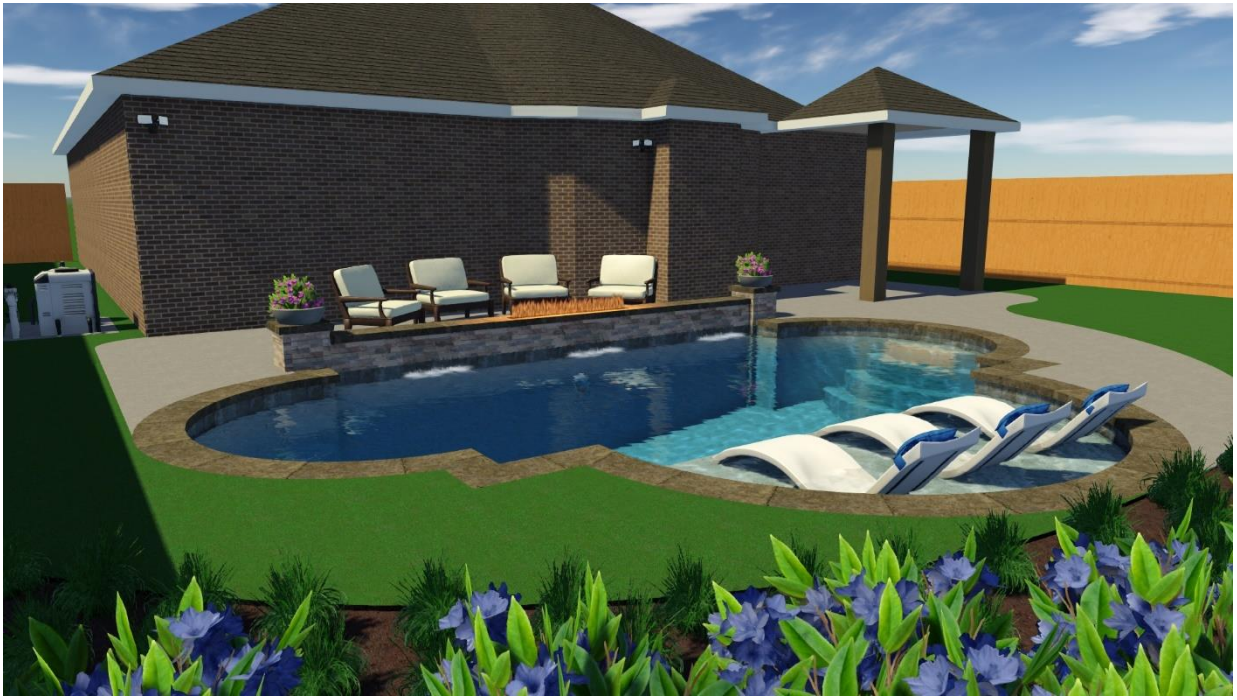

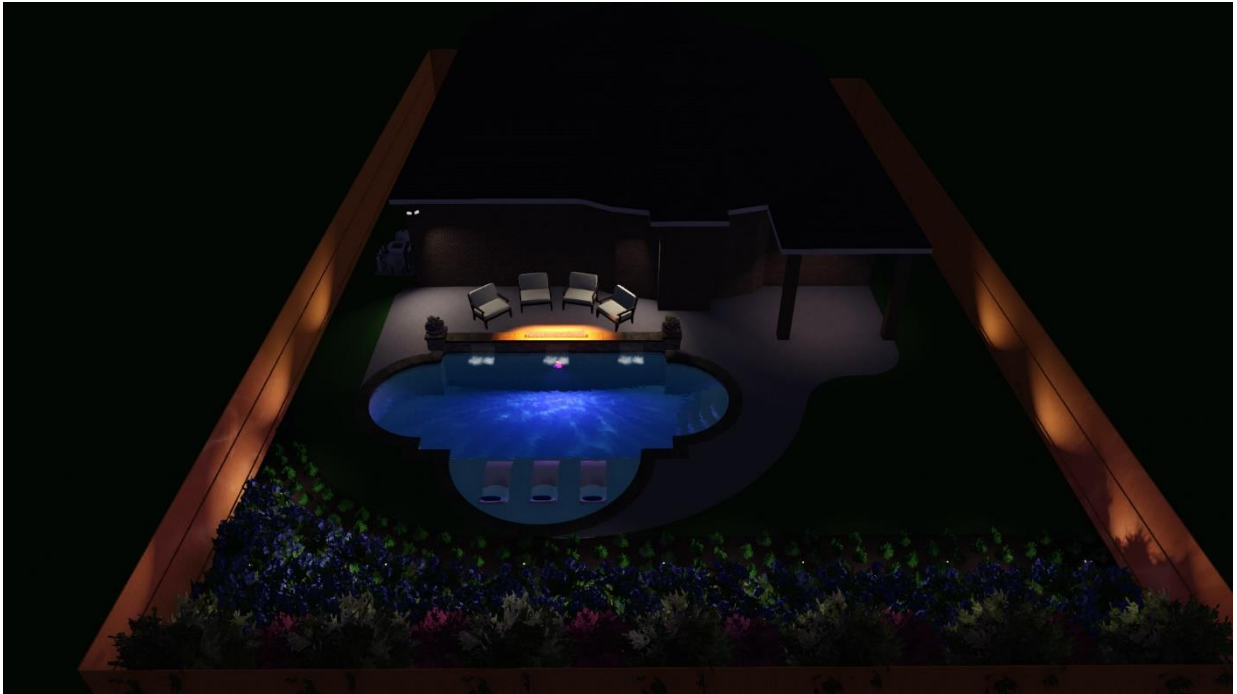

Burqin Design v 3

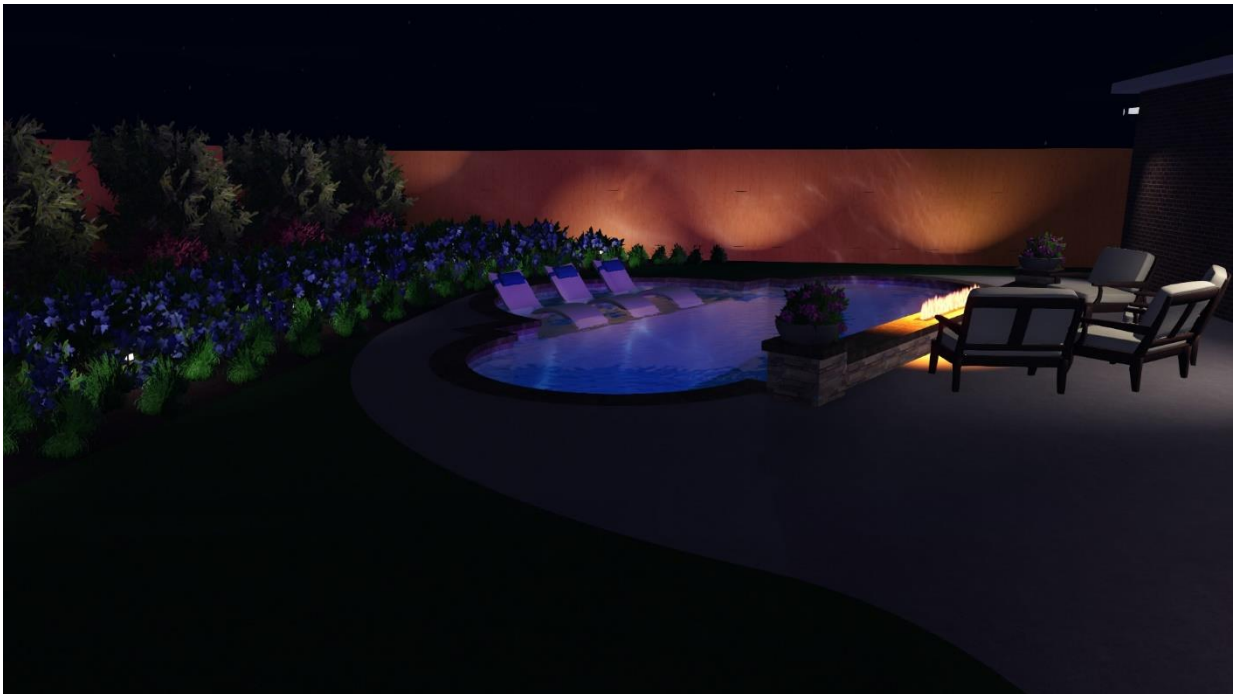

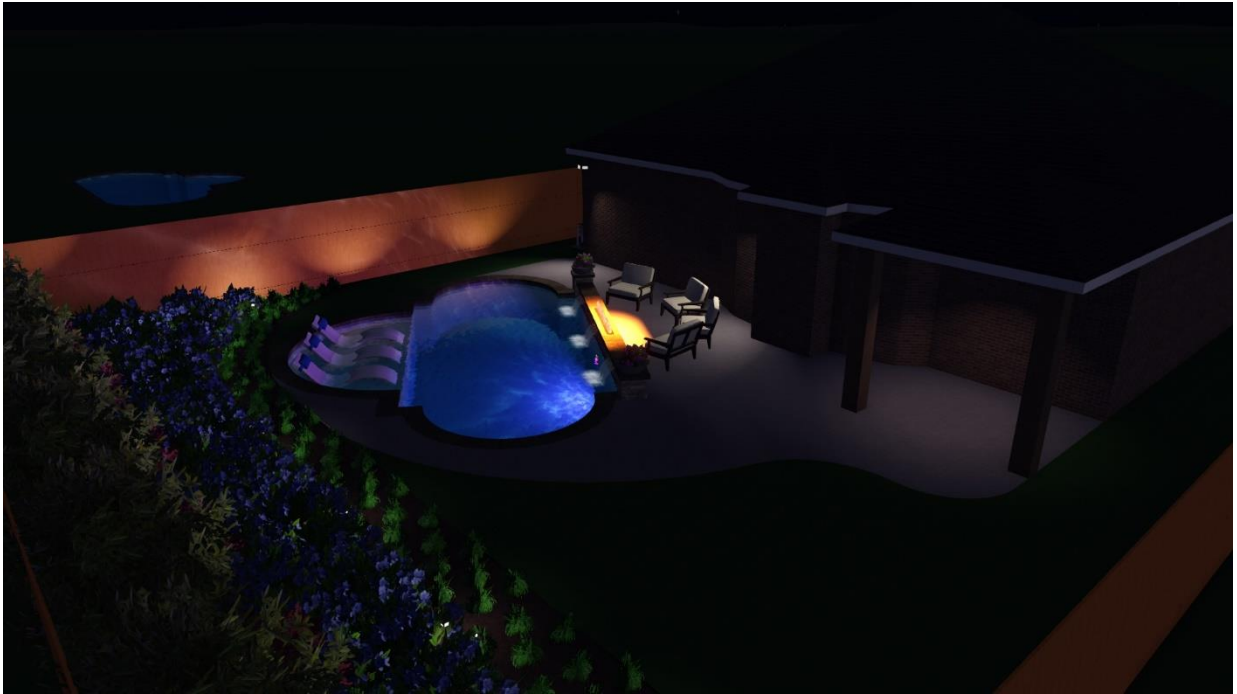





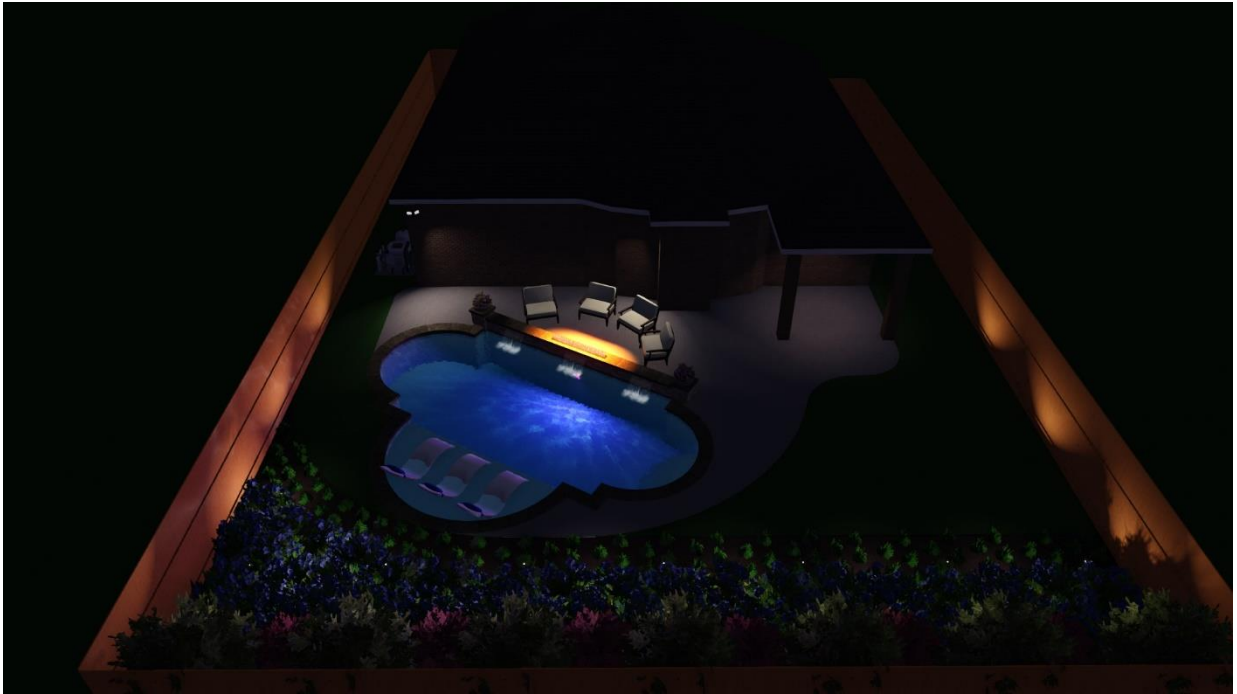

Zac Campbell (832) 797-5441

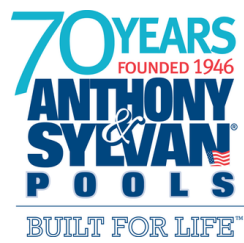



Date: Friday, March 10, 2017
Name: Chad & Lena Burgin
Address: 425 East Fork Drive Webster Texas/Harris 77598
Design Consultant: Zac Campbell
D.C. Email: ZCampbell@AnthonySylvan.com

Version 1

Below is a proposal for the Burgin family at 425 East Fork Drive Webster Texas/Harris 77598, prepared by Zac Campbell. This is a proposal only as an overview of your pool. For additional details and specifics, please review your contract with your Design Consultant.

Pool Specs:

Pool Perimeter Ft:	89
Pool Sq. Ft:	442
Max Width Ft:	20'0"
Max Length Ft:	31'11"
Shallow Depth Ft:	3.5
Deep End Depth Ft:	5.5
Approx. Gallons:	14,918

Coping:	Travertine
Facing:	Choose Ledger Stone/Split Facing Tier 1
Interior Finish:	White Mini Pebble
Deck Specs:	N/A

Equipment:

Sanitizer:	Fusion Chlorinator
Cleaner:	Vaccum Kit
Light(s):	Hayward Colorlogic LED
Automation:	Jandy PDA PS4
Water Feature(s):	(3) 2' Sheer Descents
Filter:	460 SF Cartridge Filter
Pump:	2.0 HP Variable Speed Jandy Pro Series Pump
Heat System:	N/A

NOTES:

This bid includes the following accessories: Manual Fill Line, Overflow Line, **5' Linear Fire Feature**, 12" Raised Wall with (2) 18" Columns, 8' Tanning Ledger. The price highlighted in green includes an additional cash discount.

Retail Total:	\$53,117
Discount:	(\$8,391)
Total Sales Price:	\$44,726
Offer Expires:	3/17/2017

If rock is encountered during excavation, there will be no additional cost (see contract for details).
 All permits, fees and inspections required by the city (if any) are included.
 Start-up and personalized pool school are included at the completion of the pool.
 Any landscaping work (grass, mulch, etc) is not included.

Anthony & Sylvan Lifetime Structural Warranty is included.

Anthony & Sylvan.® America's most trusted swimming pool builder since 1946.
AnthonySylvan.com





Date: Friday, March 10, 2017
Name: Chad & Lena Burgin
Address: 425 East Fork Drive Webster Texas/Harris 77598
Design Consultant: Zac Campbell
D.C. Email: ZCampbell@AnthonySylvan.com

Version 2

Below is a proposal for the Burgin family at 425 East Fork Drive Webster Texas/Harris 77598, prepared by Zac Campbell. This is a proposal only as an overview of your pool. For additional details and specifics, please review your contract with your Design Consultant.

Pool Specs:

Pool Perimeter Ft:	86
Pool Sq. Ft:	429
Max Width Ft:	20'6"
Max Length Ft:	30'0"
Shallow Depth Ft:	3.5
Deep End Depth Ft:	5.5
Approx. Gallons:	14,479

Coping:	Travertine
Facing:	Choose Ledger Stone/Split Facing Tier 1
Interior Finish:	White Mini Pebble
Deck Specs:	N/A

Equipment:

Sanitizer:	Fusion Chlorinator
Cleaner:	Vaccum Kit
Light(s):	Hayward Colorlogic LED
Automation:	Jandy PDA PS4
Water Feature(s):	(3) 2' Sheer Descents
Filter:	460 SF Cartridge Filter
Pump:	2.0 HP Variable Speed Jandy Pro Series Pump
Heat System:	N/A

NOTES:

This bid includes the following accessories: Manual Fill Line, Overflow Line, **5' Linear Fire Feature**, 12" Raised Wall with (2) 18" Columns, 8' Tanning Ledger. The price highlighted in green includes an additional cash discount.

Retail Total:	\$53,899
Discount:	(\$8,468)
Total Sales Price:	\$45,431
Offer Expires:	3/17/2017

If rock is encountered during excavation, there will be no additional cost (see contract for details).
 All permits, fees and inspections required by the city (if any) are included.
 Start-up and personalized pool school are included at the completion of the pool.
 Any landscaping work (grass, mulch, etc) is not included.

Anthony & Sylvan Lifetime Structural Warranty is included.

Anthony & Sylvan.® America's most trusted swimming pool builder since 1946.
AnthonySylvan.com



ANTHONY & SYLVAN'S LIMITED WARRANTIES, EX

WARRANTY ON POOL SHELL

For As Long As You Own Your Pool

We warrant that the pneumatically applied concrete shell will be free from leaks and that the pipes, skimmers and main drains encased in the concrete will hold water for as long as you own your pool. If a leak develops in the pool shell, we will repair the shell structure and repair or replace those portions of the affected pipes encased in the pool shell so that they will hold water. If this work requires repair of the tile, coping or interior finish, it will be done without charge.

WARRANTY ON PUMPS

For One (1), Two (2) or Three (3) Years

We warrant that the filter pumps and booster pumps will be free from defects in materials and workmanship for three (3) years from the date the pool's interior finish is applied. We warrant that the motor attached to the filter pumps and booster pumps will be free from defects in materials and workmanship for two (2) years from the date the pool's interior finish is applied. We warrant that the cleaner pumps will be free from defects in materials and workmanship for one (1) year from the date the pool's interior finish is applied.

WARRANTY ON FILTERS

For Three (3) Years

We warrant that the filter (including grids or cartridge elements) will be free from defects in materials and workmanship for three (3) years from the date the pool's interior finish is applied.

WARRANTY ON HEATERS

Gas Heaters – For Three (3) Years

We warrant that the internal parts of the gas heater will be free from defects in materials and workmanship for three (3) years from the date the pool's interior finish is applied.

WARRANTY ON POOL LIGHTS

For Three (3) Years

We warrant that the underwater LED pool lights will be free from defects in materials and workmanship for three (3) years from the date the pool's interior finish is applied.

Electric Heat Pumps – For Two (2) Years

We warrant that the internal parts of the electric heat pump will be free from defects in materials and workmanship for two (2) years from the date the pool's interior finish is applied.

WARRANTY ON INTERIOR FINISH, TILE AND COPING

For One (1) Year

We warrant that interior finish, tile and coping will be free from defects in materials and workmanship for one (1) year from the date the pool's interior finish is applied. Conditions resulting from water chemistry imbalance or local water conditions are not covered by this warranty.

WARRANTY ON OTHER CONSTRUCTION/PRODUCTS

For One (1) Year

We warrant that any retaining walls or masonry walls built by us, any pipes outside the pool shell, and any other products, parts, waterfalls, features and accessories that we constructed or installed that are not otherwise warranted will be free from defects in materials and workmanship for one (1) year from the date the pool's interior finish is applied.

TRANSFER OF SHELL WARRANTY

You, the original owner, may transfer the Warranty on Pool Shell once, but only during the first 5 years of ownership, and only if you apply to transfer the warranty prior to the sale or transfer of your property. Before the transfer is effective, we must inspect

and approve the pool and you must pay us the then current warranty transfer fee. No other warranties are transferable.

WARRANTY VALUE

The warranties in this Agreement have a total combined value equal to the Agreement price indicated on the front of this document. Our total responsibility and liability for any reason whether pursuant to our warranties or any legal theory, shall not ever exceed the price you paid to us under this Agreement.

WARRANTY WORK

If we perform any warranty work pursuant to this Agreement, all such work is warranted for the remainder of the original warranty period provided in this Agreement for that product/component.

CUSTOMER RESPONSIBILITIES

These warranties do not take effect until you have paid us the full Agreement price (including addenda) and signed any completion certificate required by your financing institution or local authorities. You are responsible for obtaining a final inspection. These warranties will immediately expire if you do not arrange for a final inspection of your property by the applicable government authority in a timely manner. To assure protection under these warranties, you must notify us of any warranty claim in writing within the applicable warranty period. Questions regarding warranty service may be directed to your Anthony & Sylvan office listed on the first page of the Agreement.

To keep your warranties in effect and receive the most benefit and enjoyment from your new pool, you must use and maintain your pool and its accessories according to this Agreement, the Pool Owner's Guide and the equipment manufacturers' instructions.

The warranties in column 1 of this page are our sole warranties with respect to our work and the pool, its equipment and accessories. **ALL OTHER WARRANTIES, EXPRESS OR IMPLIED, INCLUDING WARRANTIES OF MERCHANTABILITY AND FITNESS FOR A PARTICULAR PURPOSE, ARE EXCLUDED.**

IN ADDITION WE ARE NOT LIABLE FOR THE FOLLOWING ALL OF WHICH ARE EXCLUDED FROM YOUR WARRANTY:

- any change in color, hue, appearance, finish, or texture of the interior finish of the pool, coping, or deck due to the water chemistry of the pool or local water conditions. We are not responsible, unless otherwise agreed to, to maintain and balance the pool water.
- any claims, costs, injuries, damage or loss arising out of a tornado, hurricane, flood, earthquake, lightning, unusual high tides or water levels, wind, fire, war, terrorism, or act of God;
- any claims, costs, injuries, damage or loss arising out misuse, negligence, alteration or accident; improper drainage or winterization; soil compaction, settling or shifting; unauthorized installation, service or parts; or failure to operate and maintain the pool or any of its equipment in accordance with the instructions;
- replacement of water or chemicals required after warranty work or other repair;
- **INCIDENTAL OR CONSEQUENTIAL DAMAGES** of any kind, including damage caused by leakage; discoloration, staining or crazing of the interior finish due to the physical and chemical nature of the finish, local water conditions, improper use of chemicals or improper cleaning and maintenance;
- any erosion or damage caused by a salt chlorinator system. Chlorinated water generated by salt chlorinator systems contain a small amount of salt, which can prematurely erode masonry