

FLOOR 1	SHEET NO.	12 DATE 12	11 DATE 11	10 DATE 10	9 DATE 09	8 DATE 08	7 DATE 07	6 DATE 06	5 DATE 05	4 DATE 04	3 DATE 03	2 DATE 02	1 10-07-14	REV. DATE	REV. BY	 PARTNERS IN BUILDING	17361 VILLAGE GREEN DRIVE HOUSTON, TEXAS 77040 OFFICE (713) 937-1121 FAX (713) 937-1445	SOPER CUSTOM 28510 NAPA CROSSING LANE COMMOMS WATERWAY
		11 DATE 11	10 DATE 10	9 DATE 09	8 DATE 08	7 DATE 07	6 DATE 06	5 DATE 05	4 DATE 04	3 DATE 03	2 DATE 02	1 10-07-14	REV. DATE	REV. BY				

PROJECT NO. 1418
 7/15 PLAN NO. 1418

ORIGINALLY DRAWN BY: WOL 08-13-14

PATTERNS COINMAN APPLIANCES REQUIRING ACCESS SHALL BE PROVIDED WITH A FULL DOWN STAIRWAY WITH A CLEAR WIDTH OF NOT LESS THAN 36 INCHES. THE DOWN STAIRWAY SHALL HAVE A MINIMUM CLEAR CAPACITY OF NOT LESS THAN 300 LBS. AND SHALL BE UNOBSTRUCTED PASSAGEWAY LARGE ENOUGH TO ALLOW REMOVAL OF THE LARGEST APPLIANCE, BUT NOT LESS THAN 36 INCHES AND NOT MORE THAN 20 INCHES. THE DOWN STAIRWAY SHALL BE A STAIRCASE AND NOT A RAMP. THE PASSAGEWAY FROM THE OPENING TO THE APPLIANCE, THE PASSAGEWAY WITH CHAPTER 3 OF THE RISE AND NOT LESS THAN 36 INCHES, SHALL BE UNOBSTRUCTED PASSAGEWAY LARGE ENOUGH TO ALLOW REMOVAL OF THE LARGEST APPLIANCE. THE APPLIANCE WHEN ACCESS IS REQUIRED, THE CLEAR ACCESS OPENING DIMENSIONS SHALL BE A MINIMUM OF 20" BY 30". WHERE SUCH DIMENSIONS ARE LARGE ENOUGH TO ALLOW

- 1) EXHAUST GAS, LOCAL PROTECTION AS REQUIRED BY ELECTRICAL CODES
- 2) ALL ANALYST SHALL BE KEPT TO EXTERIOR
- 3) ALL FLOORING LAMBER SHALL BE NO. 2, S.P.F. OR BETTER
- 4) ALL DOORS AND WINDOWS MANUFACTURER'S SPECIFICATIONS
- 5) SAFETY GLASS SHALL BE PROVIDED IN ALL FRENCH DOORS, WINDOWS ADJACENT TILES AND SHOWER ENCLOSURES, WITH 24" OF EXTERIOR CODE PER R.C.I.
- 6) EXHAUST ACCESS PANELS PER FLOORING CODE
- 7) ALL EXTERIOR LIGHTS SHALL BE PROVIDED OUTSIDE DRAIN UNITS, PROVIDE SUB-FLOOR WALKWAY TO & AROUND EACH UNIT CONFORMING TO APPLICABLE CODES
- 8) ALL KITCHEN TILES & BATH TILES SHALL NOT BE VISIBLE FROM EXTERIOR
- 9) ALL INTERIOR WALLS SHALL BE FINISHED WITH 1/2" GYPSUM BOARD, INSULATION AND MECHANICAL AREAS IN KITCHEN, PROVIDE 3/4" PLASTER-2" GYPSUM BOARD AND 1/2" INS. MOST UNDER REFER TO PLANS FOR PER ENGINEERED LOCATIONS
- 10) ALL DOWN STAIR SPECS. 30" X 34" FLOOR ACCESS 300 LB. MAX.

FOR ATTIC DISPENSING STAIRS IN THE GARAGE CEILING THE EXPOSED PANEL SHALL BE AT LEAST 3/8" THICK FIBER REINFORCED-PLYWOOD-2 OR COVERED WITH A MINIMUM 16 GAUGE SHEET METAL. IN ADDITION TO THESE TWO METHODS THE FOLLOWING METHODS ARE ALSO ACCEPTABLE FOR PROTECTING THE ATTIC DISPENSING STAIRS AND OTHER ACCESS OPENINGS: 1) UNTREATED PLYWOOD-2 PROTECTED WITH 1/2" THICK TYPE GYPSUM BOARD, 2) UNTREATED PLYWOOD-2 PROTECTED WITH AN INNOUESCENT PAINT IN ALL CASES THE OPENING PROTECTION MATERIAL IS APPLIED TO THE GARAGE SIDE OF THE PLYWOOD-2.

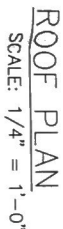

13416 P718, P700 NO.		ORIGINALLY DRAWN BY: WFO-08-19-14		 PARTNERS IN BUILDING		17361 VILLAGE GREEN DRIVE HOUSTON, TEXAS 77040 OFFICE (713) 937-1121 FAX (713) 937-1445	
REV.	DATE	REV.	BY	DATE	REV.	BY	DATE
1	15-07-14			NAME 01			
2	DATE 02			NAME 02			
3	DATE 03			NAME 03			
4	DATE 04			NAME 04			
5	DATE 05			NAME 05			
6	DATE 06			NAME 06			
7	DATE 07			NAME 07			
8	DATE 08			NAME 08			
9	DATE 09			NAME 09			
10	DATE 10			NAME 10			
11	DATE 11			NAME 11			
12	DATE 12			NAME 12			