

This property IS NOT located in the 100 year flood plain & is in insurance rate map zone C, as per map 485470/0195C dated 05-02-83.

SCALE: 1" = 60'

LEGEND

--//-- WOOD FENCE
--x-- BARBED WIRE FENCE

FESLER, SABRINA

G.C.D.R. NO. 2002055404

FOSTER, ERNEST L. & MARIA

FILM CODE NO. 003-12-1191

BENDER, ARTHUR C. & MELONDY D.

G.C.D.R. NO. 007-98-2201

NORTH 165.00'

FND 1/2" I.R.

CORNER FALLS IN FENCE LINE

BURGESS, PAUL M.

G.C.D.R. NO. 2002014946

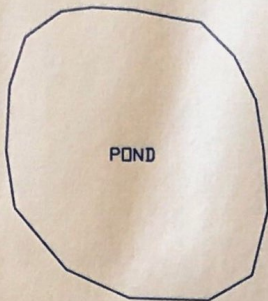

POND

WEBB, CONNIA P.

FILM CODE NO. 008-15-1941

76,725.00 sq.ft.
1.76 acres

WEST 465.00'

EAST 465.00'

9.9'x7.9' SHED ON GROUND

ONE STORY FRAME GARAGE

24.0' 24.1' 24.1' 24.0'

GRASS & GRAVEL DRIVE

66.4' MANUFACTURED HOME

6' X 6' CONC PAD FOR WELL

WEBB, CONNIA P.

G.C.D.R. NO. 07537

FND 5/8" I.R.

SOUTH 165.00'

FND 5/8" I.R.

AVENUE U
(50' R.O.W.)

I HEREBY CERTIFY THAT THE PLAT HEREON CORRECTLY REPRESENTS THE RESULTS OF AN ACTUAL SURVEY MADE ON THE GROUND UNDER MY DIRECTION AND THAT THERE ARE NO ENCROACHMENTS EXCEPT AS SHOWN.

NOTES:

1. BASIS FOR BEARINGS: ASSUMED AS PLATTED
2. DISTANCES SHOWN ARE GROUND DISTANCES
3. ALL ABSTRACTING DONE BY TITLE COMPANY
4. SURVEY BASED ON BEST OF EVIDENCE FOUND

* THE NORTH 165' OF THE SOUTH 660' OF THE WEST 465' OF THE EAST 475' OF OUTLOT 410, OF ALTA LOMA OUTLOTS, A SUBDIVISION IN GALVESTON COUNTY, TEXAS, ACCORDING TO THE MAP OR PLAT THEREOF, RECORDED IN VOL. 114, PG. 9 OF THE G.C.M.R., TRANSFERRED TO PLAT RECORD 10, MAP NO. 21 OF THE G.C.M.R., TEXAS

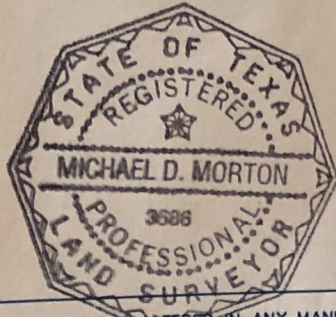

DATED 10-24-09

REGISTERED PROFESSIONAL LAND SURVEYOR IN THE STATE OF TEXAS

THIS CERTIFICATION IS REVOKED AND THIS SURVEY IS NULL AND VOID IF THIS DOCUMENT IS ALTERED IN ANY MANNER, USED OR RELIED UPON BY ANYONE OTHER THAN THE PARTIES ADDRESSED BELOW, OR DOES NOT BEAR AN ORIGINAL SIGNATURE AND SEAL OF THE SURVEYOR.

LOT(S)	BLOCK	SUBDIVISION	ALTA LOMA OUTLOTS		SECTION
			COUNTY	STATE	
RECORDATION	PLAT RECORD 10, MAP NO. 21 G.C.M.R.		GALVESTON	TEXAS	
ADDRESS	CITY	ZIP CODE	LENDER		
5810 AVENUE U	SANTA FE	77510	COMMUNITY HOME LOANS		
PURCHASER	TITLE COMPANY		G.F. NO.		
MARY FOWLER	FIDELITY NATIONAL TITLE		04-33000749		
FILED BY:	MS	10-20-09	JOB NO. 05-01-003-3		
DRAWN BY:	LR	10-20-09	REVISION:		
CHECKED BY:	MM	10-21-09			

ARROW SURVEYING

P.O. BOX 410 PEARLAND, TEXAS 77588
(281) 412-2294 FAX(281) 412-2314