

SCALE 1"=30'

FND 1/2" I.R.

RIVER BEND DRIVE (70' R.O.W.)

N. 00° 53' 09" E. 140.00'

FND 1/2" I.R.

16' UTILITY EASEMENT

50' BUILDING LINE

SEPTIC  
OOO

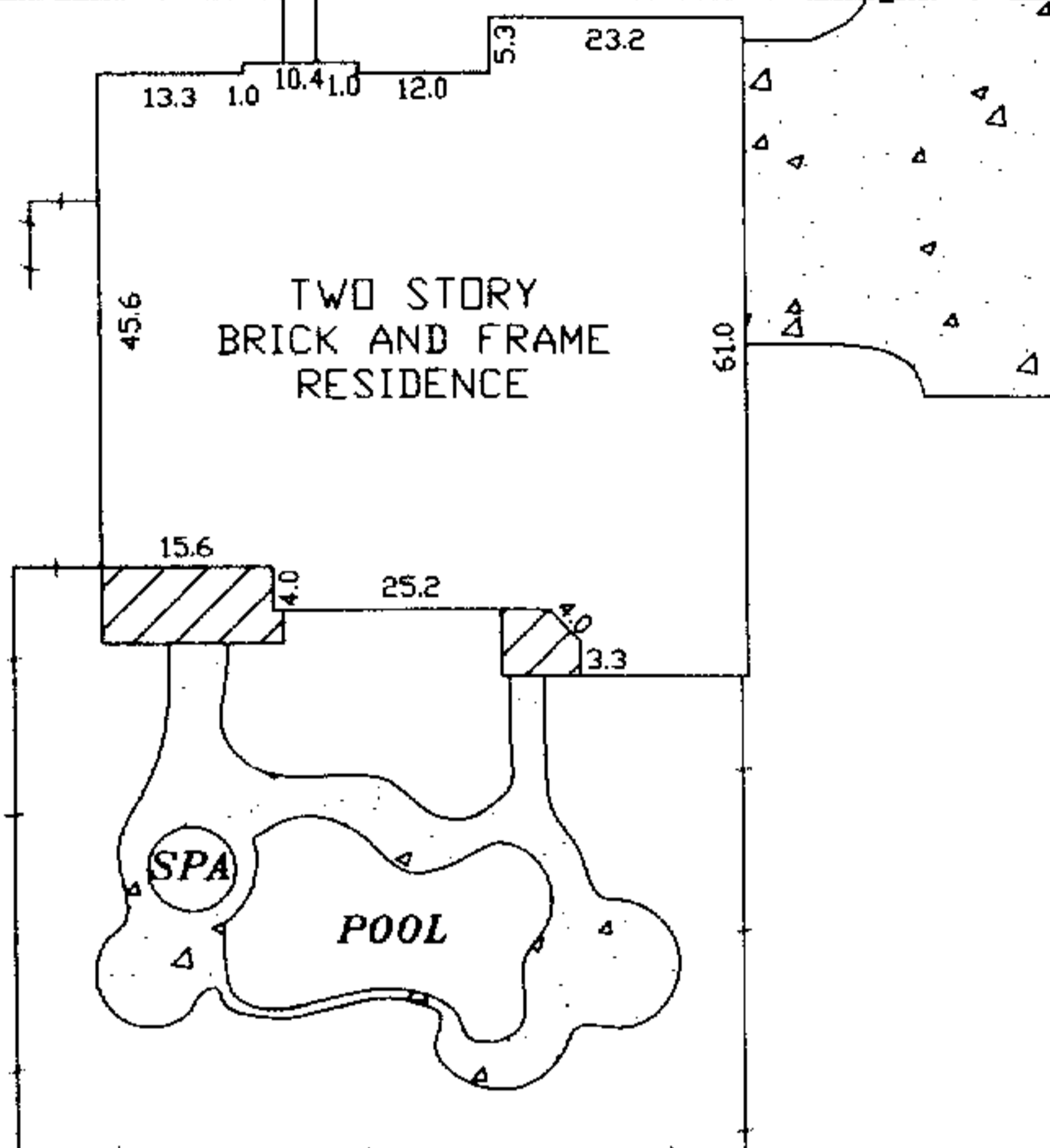

LOT 17

S. 89° 09' 51" E. 256.99'

LOT 19



N. 89° 09' 51" W. 258.65'

LOT 18

0.829 ACRE

50' DRAINAGE EASEMENT

FND 1/2" I.R.

S. 01° 04' 07" W. 35.36'

FND 1/2" I.R.

S. 00° 04' 53" W. 104.66'

FND 1/2" I.R.

183.62 ACRES  
VOL. 2091 PG. 1063 D.R.

NOTES:

1. RESTRICTIVE COVENANTS BY SLIDE No. 2310/B OF THE PLAT RECORDS OF FORT BEND COUNTY, TEXAS.
2. ELECTRICAL DISTRIBUTION AGREEMENT BY C.C.F. No. P051187.
3. CENTERPOINT ENERGY HOUSTON ELECTRIC LLC EASEMENT FOR DISTRIBUTION PROVIDED BY C.C.F. No. 2003007593.

LOT:	18	BLK:	1	SUBDIVISION:	RIVERSIDE RANCH, SEC. ONE	
COUNTY:	FORT BEND	STATE:	TEXAS	RECORDATION:	SLIDE No. 2310/B P.R.F.B.C.T.	JOB NO. 3418 R
PURCHASER:				MORTGAGE CO.		FIELD WORK
J.D. ADKINS, III AND ELIZABETH A. ADKINS						7-7-11 D.T
ADDRESS:				TITLE CO.		DRAFTING
3418 RIVER BEND DRIVE				GREAT AMERICAN TITLE		7-7-11 D.T
						FINAL CHECK
						7-7-11 S.R.

THE SURVEYOR HAS NOT ABSTRACTED SUBJECT PROPERTY. THIS SURVEY IS BASED ON TITLE COMMITMENT LISTED BELOW AND PLAT OF RECORD SHOWN.

GF. No. 1594488-GT75

**COPPERFIELD SURVEYING**  
12436 FM 1960 W.  
HOUSTON TEXAS, #128  
77065  
TEL 832-217-7003  
FAX 281-894-7176

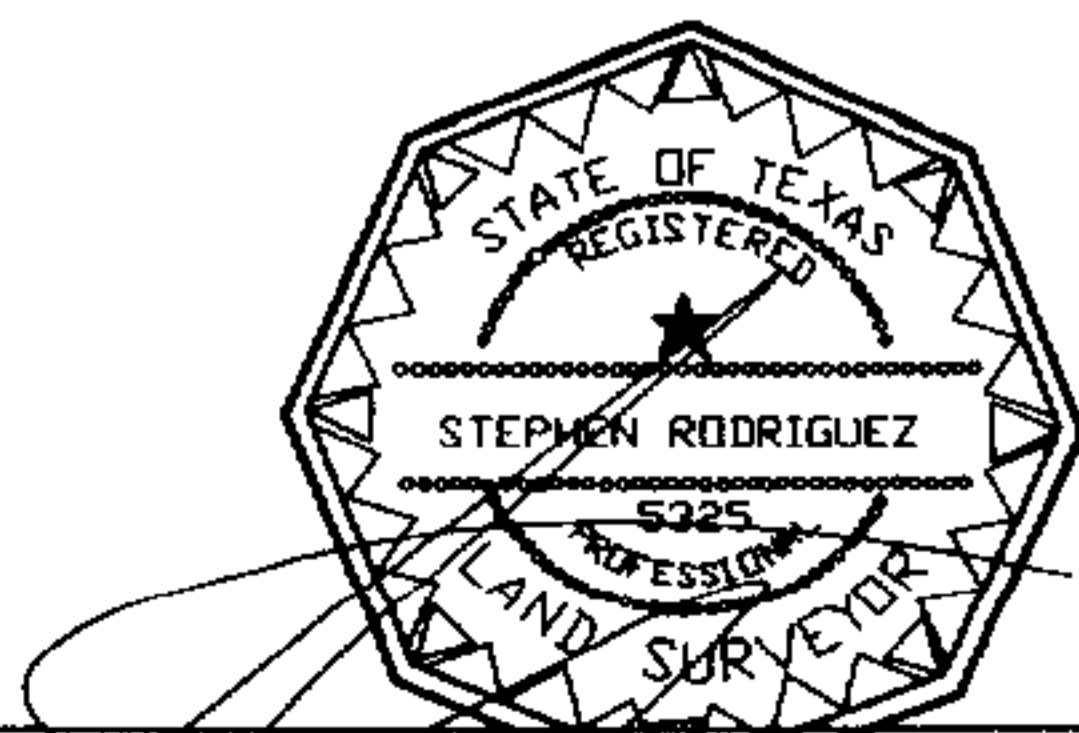

I DO HEREBY CERTIFY THAT THIS SURVEY WAS MADE ON THE GROUND UNDER MY SUPERVISION AND THAT IT CORRECTLY REPRESENTS THE FACTS FOUND AT THE TIME OF THE SURVEY. THERE ARE NO ENCROACHMENTS APPARENT EXCEPT AS SHOWN.

STEPHEN RODRIGUEZ R.P.L.S. No. 5325

SUBJECT PROPERTY IS NOT LOCATED IN A FEDERAL INSURANCE ADMINISTRATION DESIGNATED FLOOD HAZARD AREA ZONE 'X' AS PER MAP 480287  
PANEL 865 L DATED 6-18-07

7-7-11  
THE FLOOD INFORMATION IS FROM A F.E.M.A. MAP. WE ARE NOT RESPONSIBLE FOR ITS ACCURACY.