

*Bobbie L. Windle*  
 2806 GRAND FALLS DRIVE  
*Stephen M. Windle* (50' X 60')

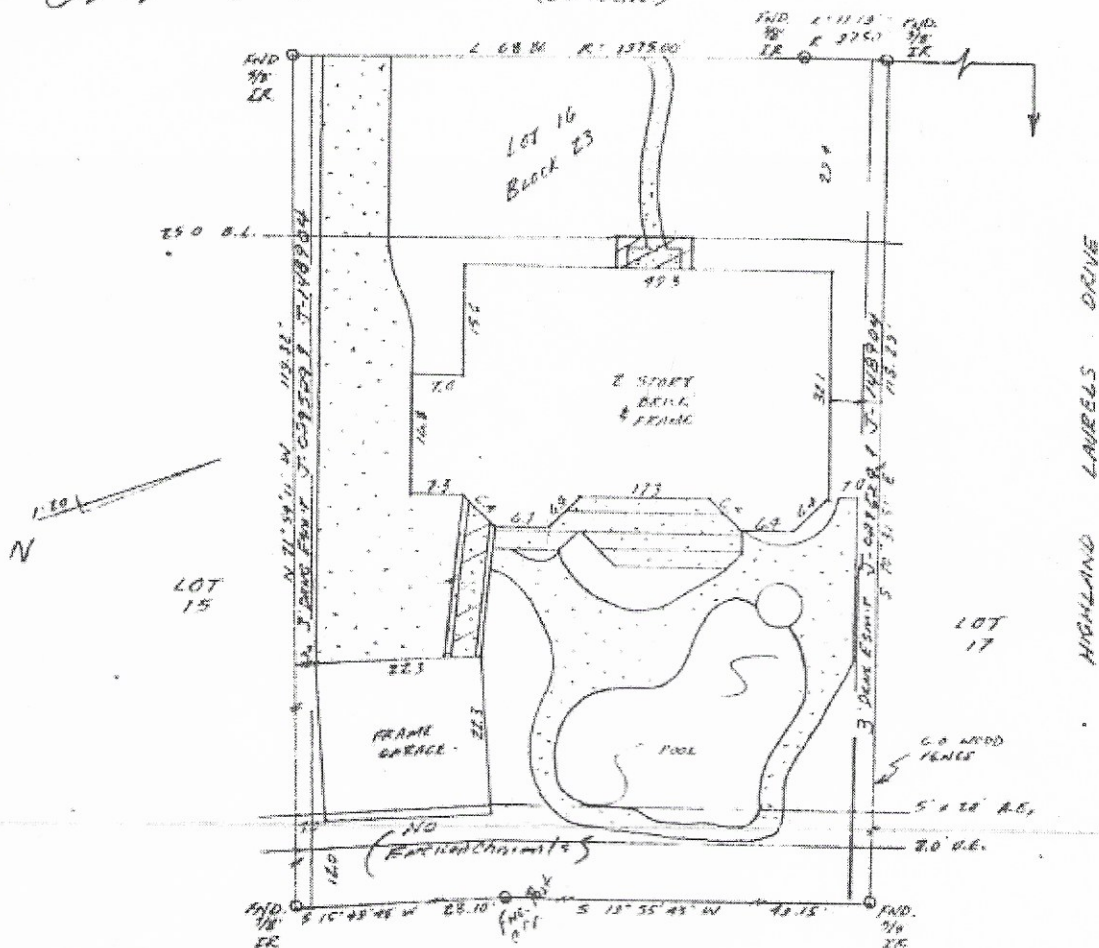

The above property lies within the area designated and zoned by the City of Houston as the "Jetero Airport Site" (Houston Intercontinental Airport) and is subject to the restrictions and regulations as set out in Volume 4184, Page 518, Volume 4897, Page 67 and Volume 5448, Page 421.

A 2 ft. wide easement for CATV from utility easement to point of service on residence structure as set out in Clerk's File No. G-803502.

Agreement for underground/overhead electrical service with H. L. & P. as set out in Clerk's File No. G848671.

**BUYER** Stephen M. Windle and wife,  
 Bobbie L. Windle 2806 Grand Falls Drive  
 Kingwood, Texas

**DESCRIBED PROPERTY**

Lot 16, Block 23, of SAND CREEK VILLAGE, Section 1, an Addition in Harris County, Texas, according to the map or plat thereof recorded in Volume 295, Page 13, of the Map Records of Harris County, Texas.

TEXAS  SURVEYORS, INC.

NO. 84-879 DM  
 DATE 11-20-91

AD. # 11-222-91

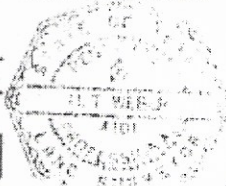

I do hereby certify that this survey was this day made on the ground of the property legally described herein, & is on an attached sheet, and is correct, and there are no encroachments unless shown.

Note: There are no natural drainage courses on this property, hence this property does not lie in a flood hazard area according to FEMA/FIA.

48201000656 9-28-90

ZONE X

	DATE	BY
FIELD WORK		
DRAFTING		
FINAL CHECK		

*Handwritten signature*