

Building Sketch

Client	Anrock Inc			
Property Address	10 Wintergrass Pl			
City	Spring	County	Montgomery	State TX Zip Code 77382
Lender	Quicken Loans, Inc			

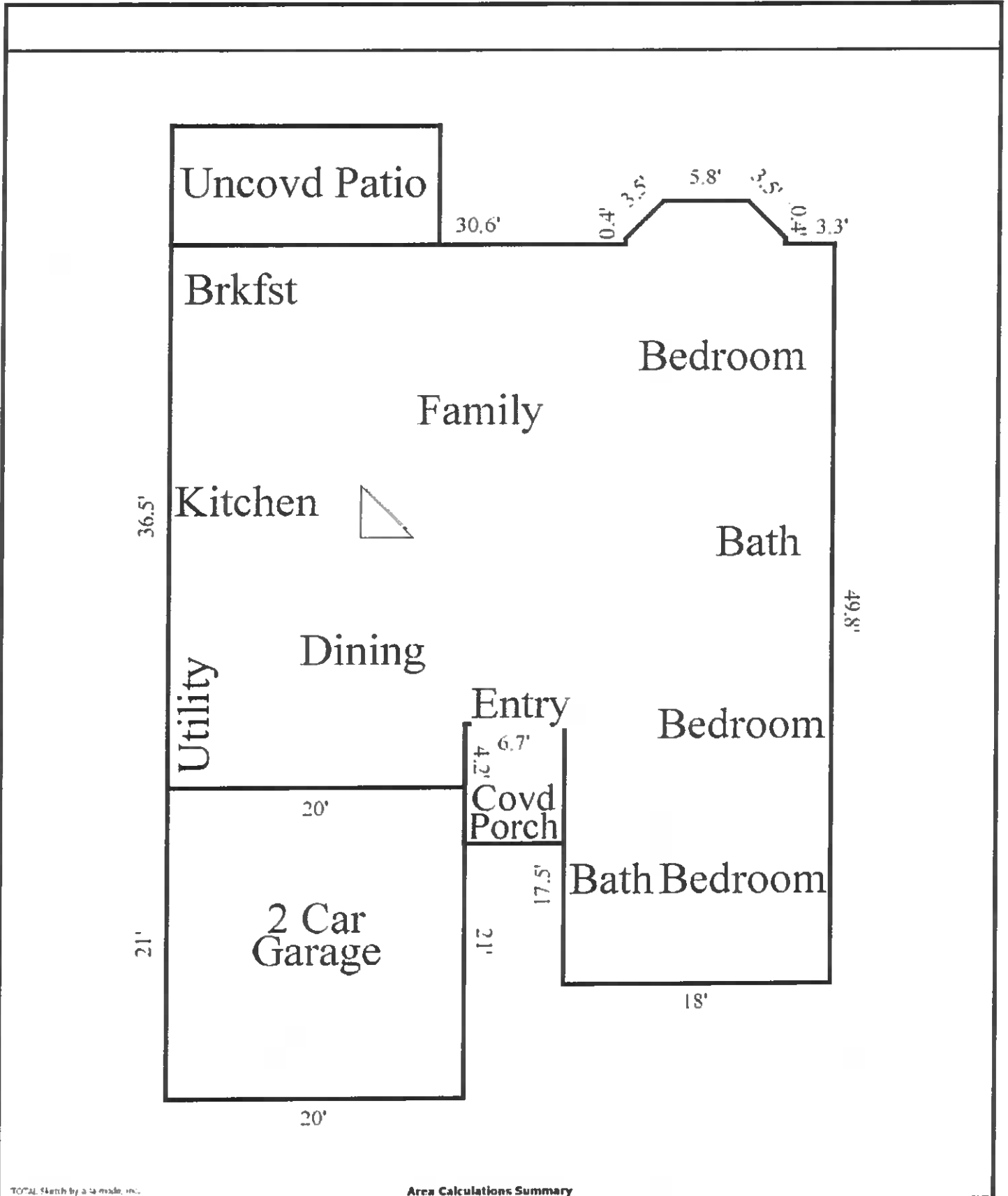

TOTAL Sketch by a la mode, inc.

Area Calculations Summary

Living Area	Area	Calculation Details	Area
First floor	1867.9 Sq ft	18 x 17.5 =	315
		36.5 x 20 =	730
		24.7 x 32.3 =	797.8
		10.8 x 0.4 =	4.3
		5.8 x 2.5 =	14.5
		0.5 x 2.5 x 2.5 =	3.1
		0.5 x 2.5 x 2.5 =	3.1
Total Living Area (Rounded):	1868 Sq ft		
Non-living Area			
2 Car Attached	420 Sq ft	20 x 21 =	420

License

You may wish to laminate the pocket identification card to preserve it.

DOUGLAS WADE PICKETT
3203 CHIPPERS CROSSING
MONTGOMERY, TX 77356

The person named on the reverse is licensed by the Texas Appraiser Licensing and Certification Board.

Inquiry as to the status of this license may be made to:

Texas Appraiser Licensing and Certification Board
P.O. Box 12188
Austin, Tx 78711-2188
www.talcb.texas.gov
(512) 936-3001
Fax:(512) 936-3899

Texas Appraiser Licensing and Certification Board
P.O. Box 12188 Austin, Texas 78711-2188

Certified Residential Real Estate Appraiser

Number: TX 1336813 R

Issued: 02/21/2017

Expires: 03/31/2019

Appraiser: DOUGLAS WADE PICKETT

Having provided satisfactory evidence of the qualifications required by the Texas Appraiser Licensing and Certification Act, Texas Occupations Code, Chapter 1103, is authorized to use this title, Certified Residential Real Estate Appraiser.

Douglas E. Oldmixon
Commissioner

Texas Appraiser Licensing and Certification Board

P.O. Box 12188 Austin, Texas 78711-2188

Certified Residential Real Estate Appraiser

Number: TX 1336813 R

Issued: 02/21/2017

Expires:

03/31/2019

Appraiser: DOUGLAS WADE PICKETT

Having provided satisfactory evidence of the qualifications required by the Texas Appraiser Licensing and Certification Act, Texas Occupations Code, Chapter 1103, is authorized to use this title, Certified Residential Real Estate Appraiser.

Douglas E. Oldmixon
Commissioner