

40' ROAD ACCESS EASEMENT
0.2255 ACRES (DEDICATED BY PLAT)

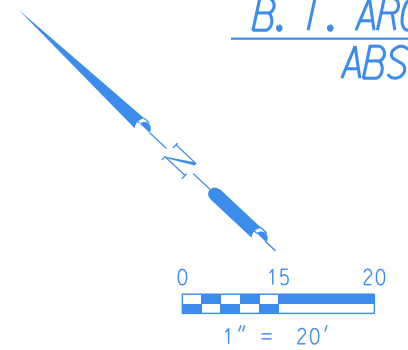

GRAVEL ROAD

FND. 5/8" I.R.

S 43°01'28" E 93.00'

FND. 1/2" I.R. SPINNER
BEARS N54°47'54"W, 0.73'

0.7342
N54°47'54"W

40' ROAD ACCESS ESMT.
94-040512 B.C.O.R.

GENE & NORMA SCHWALL
11-021537 B.C.O.R.
(CALLED 0.3133 ACRE)

SUBJECT
LOT 3
RICHARD BANTIGUE
ET UX
11-006974 B.C.O.R.

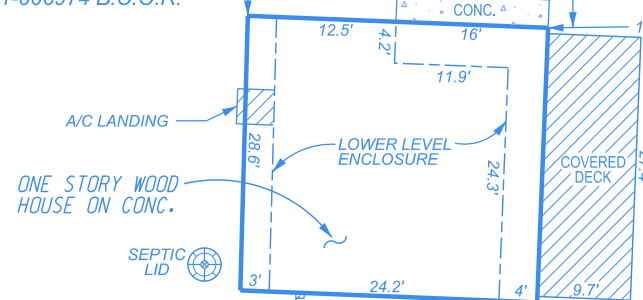

FND. 5/8" I.R.

LOT 4
RML DEVELOPMENT
14-027391 B.C.O.R.

SURVEY PLAT
OF

LOT 3

OF
BANTIGUE ESTATES
REPLAT OF
0.7621 ACRE BEING
PART OF TRACT 211

OF
BRAZOS COAST INVESTMENT
COMPANY SUBDIVISION NO. 1
RECORDED IN
COUNTY CLERK'S FILE
NO. 2011006974

OF THE
BRAZORIA COUNTY PLAT RECORDS
IN THE
B. T. ARCHER LEAGUE
ABSTRACT 9
OF
CITY OF SURFSIDE
BRAZORIA COUNTY, TEXAS
FOR

THOMAS A. & CHRISTINA M. SLEEPER

LOT 1

LOT 2

N 46°50'17" E 80.13'

S 46°40'58" W 80.00'

FND. 5/8" I.R.

N 43°06'24" W 93.24'

FND. 1/2" I.R.

FND. 5/8" I.R.

FND. 5/8" I.R.

TRACT 210
POINT LAFITTE SUBDIVISION
(UNRECORDED)

I, TERRY SINGLETARY, REGISTERED PROFESSIONAL LAND SURVEYOR
DO HEREBY CERTIFY THAT THE ABOVE PLAT IS A TRUE REPRESENTATION OF A
SURVEY MADE UNDER MY SUPERVISION, ON THE GROUND, AND THAT THERE ARE
NO EXCESSES NOR INTRUSIONS ON THIS PROPERTY, EXCEPT AS SHOWN.
DATE SURVEYED: MARCH 6, 2017

NOTES:

1. ALL COORDINATES AND BEARINGS ARE RELATIVE TO THE TEXAS STATE PLANE COORDINATE SYSTEM, SOUTH CENTRAL ZONE (NAD 27).
2. ALL DISTANCES ARE HORIZONTAL SURFACE LEVEL LENGTHS.
3. THIS PROPERTY IS LOCATED WITHIN THE LIMITS OF ZONE "VE" PER FEMA FLOOD INSURANCE RATE MAP NUMBER 48039C07851, DATED MAY 4, 1992.
4. THIS SURVEY RELIES ON A TITLE COMMITMENT FROM GREAT AMERICAN TITLE COMPANY, GF NO. 50270 ISSUED MARCH 16, 2017 FOR ALL ITEMS OF RECORD.

LEGEND

- FOUND IRON PIPE/ROD
- SET 5/8" IRON ROD
- POWER POLE
- OH— OVERHEAD WIRE
- WM WATER METER
- || WOODEN FENCE



Terry Singletary
TERRY SINGLETARY
REGISTERED PROFESSIONAL LAND SURVEYOR
TEXAS REGISTRATION NUMBER 4808

Doyle & Wachtstetter, Inc.
Surveying and Mapping GPS/GIS
131 COMMERCE STREET, CLUTE, TEXAS 77531
OFFICE: 979.265.3622 FAX: 979.265.9940

SURVEYED:	3-6-17	BOOK:	SURFSIDE VOL. 65	PROJ NO:	7531-17-01
DRAWN BY:	LOFTUS 3-7-17	CHECKED:	TRS 3-8-17	REVISED:	NONE