

GF NO. CTH-WD-CTT17678532DP CHICAGO TITLE  
 ADDRESS: 28225 HUFFMAN CLEVELAND ROAD  
 HUFFMAN, TEXAS 77336  
 BORROWER: KIMBERLY SIMECEK

# 1.4662 ACRES LOT 64 AMERILAND CORPORATION TRACT

AN UNRECORDED SUBDIVISION SITUATED IN THE  
 JAMES H. ISBELL SURVEY, A-474  
 HARRIS COUNTY, TEXAS  
 (SEE ATTACHED METES AND BOUNDS)



THIS PROPERTY DOES NOT LIE WITHIN THE 100 YEAR FLOOD PLAIN AS PER FIRM PANEL NO. 48201C 0340 L MAP REVISION: 06/18/07 ZONE X BASED ONLY ON VISUAL EXAMINATION OF MAPS. INACCURACIES OF FEMA MAPS PREVENT EXACT DETERMINATION WITHOUT DETAILED FIELD STUDY

A SUBSURFACE INVESTIGATION WAS BEYOND THE SCOPE OF THIS SURVEY

D.C.L. = DIRECTIONAL CONTROL LINE RECORD BEARING: CF NO. 20120590463 H.C.D.R.

DRAWN BY: MM/VG/MM

I HEREBY CERTIFY THAT THIS SURVEY WAS MADE ON THE GROUND, THAT THIS PLAT CORRECTLY REPRESENTS THE FACTS FOUND AT THE TIME OF SURVEY AND THAT THERE ARE NO ENCROACHMENTS APPARENT ON THE GROUND, EXCEPT AS SHOWN HEREON. THIS SURVEY IS CERTIFIED FOR THIS TRANSACTION ONLY AND ABSTRACTING PROVIDED IN THE ABOVE REFERENCED TITLE COMMITMENT WAS RELIED UPON IN PREPARATION OF THIS SURVEY.

JIMMY RAY JANECEK  
 PROFESSIONAL LAND SURVEYOR  
 NO. 5868  
 JOB NO. 17-05974  
 JUNE 01, 2017

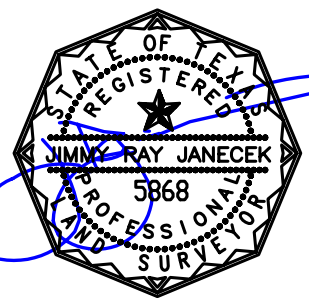

LAKE HOUSTON REALTY  
 MELANIE FOREMAN  
 281-324-4105

Chicago Title  
 A trusted business partner since 1887

DEBBIE POWERS  
 281-362-2008



**PRECISION**  
 surveyors

1-800-LANDSURVEY  
[www.precisionurveyors.com](http://www.precisionurveyors.com)

281-496-1586 FAX 281-496-1867 210-829-4941 FAX 210-829-1555  
 950 THREADNEEDLE STREET SUITE 150 HOUSTON, TEXAS 77079 1777 NE LOOP 410 SUITE 600 SAN ANTONIO, TEXAS 78217  
 FIRM NO. 10063700