

REV.	DATE	DESCRIPTION
08/30/18		FOR PERMIT & CONSTRUCTION
10/16/18		C.O.H. REVISION

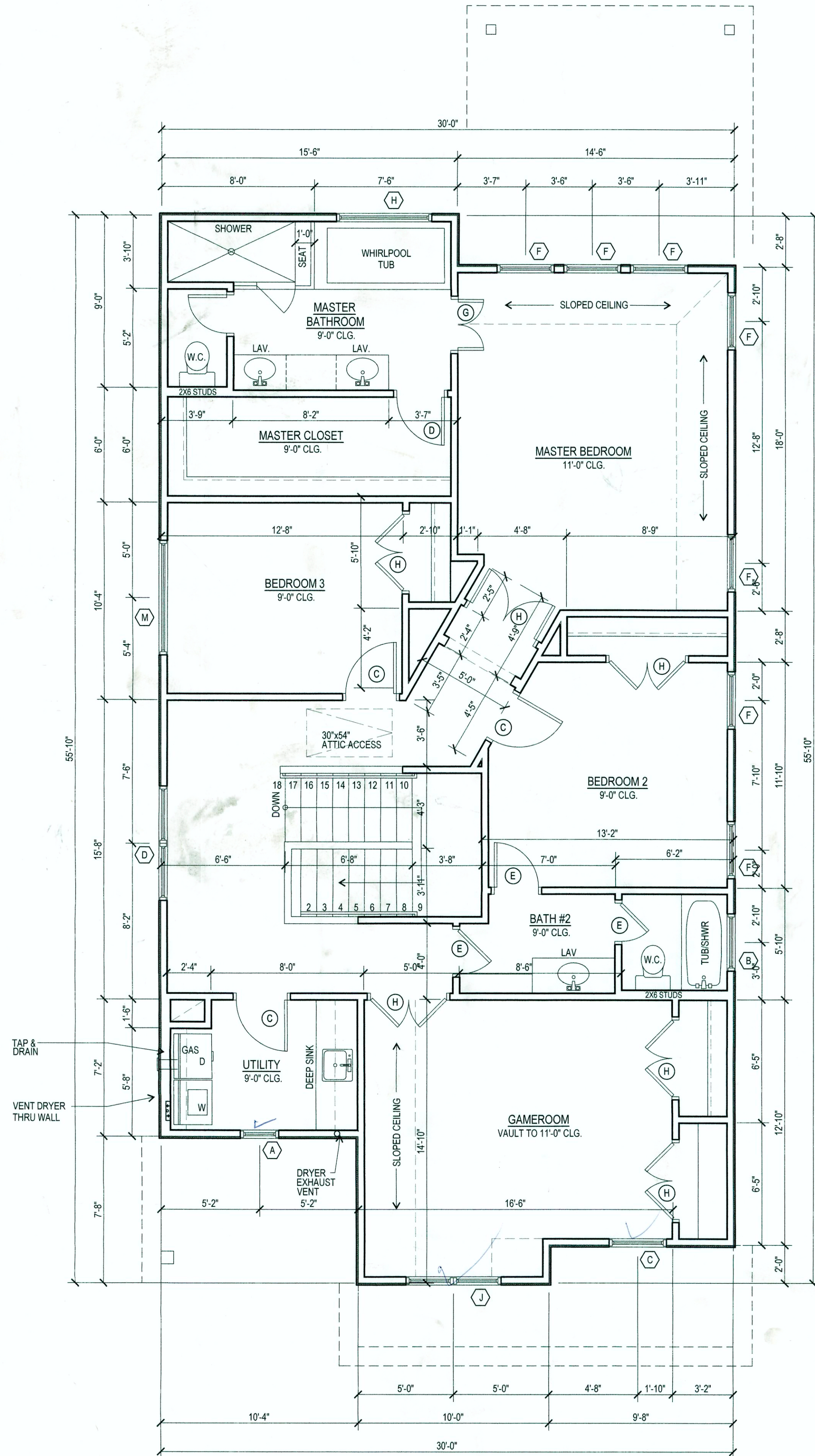

**2 SECOND FLOOR PLAN**  
1/4"=1'-0"  
NORTH

**GENERAL NOTES:**

- ALL DIMENSIONS ARE TO FACE OF STUDS.
- ALL EXTERIOR PARTITIONS TO BE 2X6 @16" O.C. AND ALL INTERIOR PARTITIONS TO BE 2X4 @16" O.C. WITH 1/2" THK GYP BD UNLESS NOTED OTHERWISE. PROVIDE 1/2" THK TYPE "X" GYP BD ON WALLS AND CEILING AT GARAGE. PROVIDE "WATER RESISTANT" GYP BD AT ALL WET WALLS INCLUDING KITCHEN AND BATHROOMS.
- ALL ROOMS TO HAVE PTD WALLS AND CEILINGS.
- LOCATE WATER HEATERS IN GARAGE STORAGE SET ON PLATFORM 24" ABOVE FINISH FLOOR WITH METAL PANS WITH DRAIN TO OUTSIDE.
- ALL INTERIOR DOORS TO BE 1 3/8" H.C. ON WOOD FRAME.
- ALL EXTERIOR DOORS TO BE 1 3/4" S.C. ON WOOD FRAME.
- ALL WINDOWS TO BE ALUMINUM CLAD. SIZE AND PATTERN INDICATED ON PLANS. TOP OF WINDOWS TO BE AS INDICATED ON WINDOW TYPES. SMOKE DETECTORS REQUIRE 110V CONNECTION TO HOUSE WIRING AND BATTERY BACKUP AND BE INTERCONNECTED.
- ALL BATH VENT FANS ARE TO TERMINATE AT EXTERIOR.
- BATHROOM:
  - COUNTERTOPS TO BE GRANITE W/ 4" SPLASH
  - CABINETS TO BE PRE-FAB, PREFINISHED IN SIZES AS INDICATED ON PLANS.
  - TUBS TO BE 6" CAST IRON WITH CERAMIC TILE WALLS TO 7'-0" A.F.F.
  - SHOWER TO HAVE TILE WALLS TO 7'-0" A.F.F. AND TILE FLOOR RECEPTOR WITH SAFETY GLASS ENCLOSURE AND DOOR
- KITCHEN:
  - COUNTERTOPS TO BE GRANITE W/ FULL TILE SPLASH
  - CABINETS TO BE PRE-FAB, PREFINISHED IN SIZES AS INDICATED ON PLANS.
- PROVIDE WOOD BLOCKING AT ALL BEDROOMS AND LIVING ROOM FOR FUTURE CEILING FAN INSTALLATION.
- ATTIC ACCESS STAIR TO BE 30"x54" AND HAVE A LOAD CAPACITY OF NOT LESS THAN 350 POUNDS

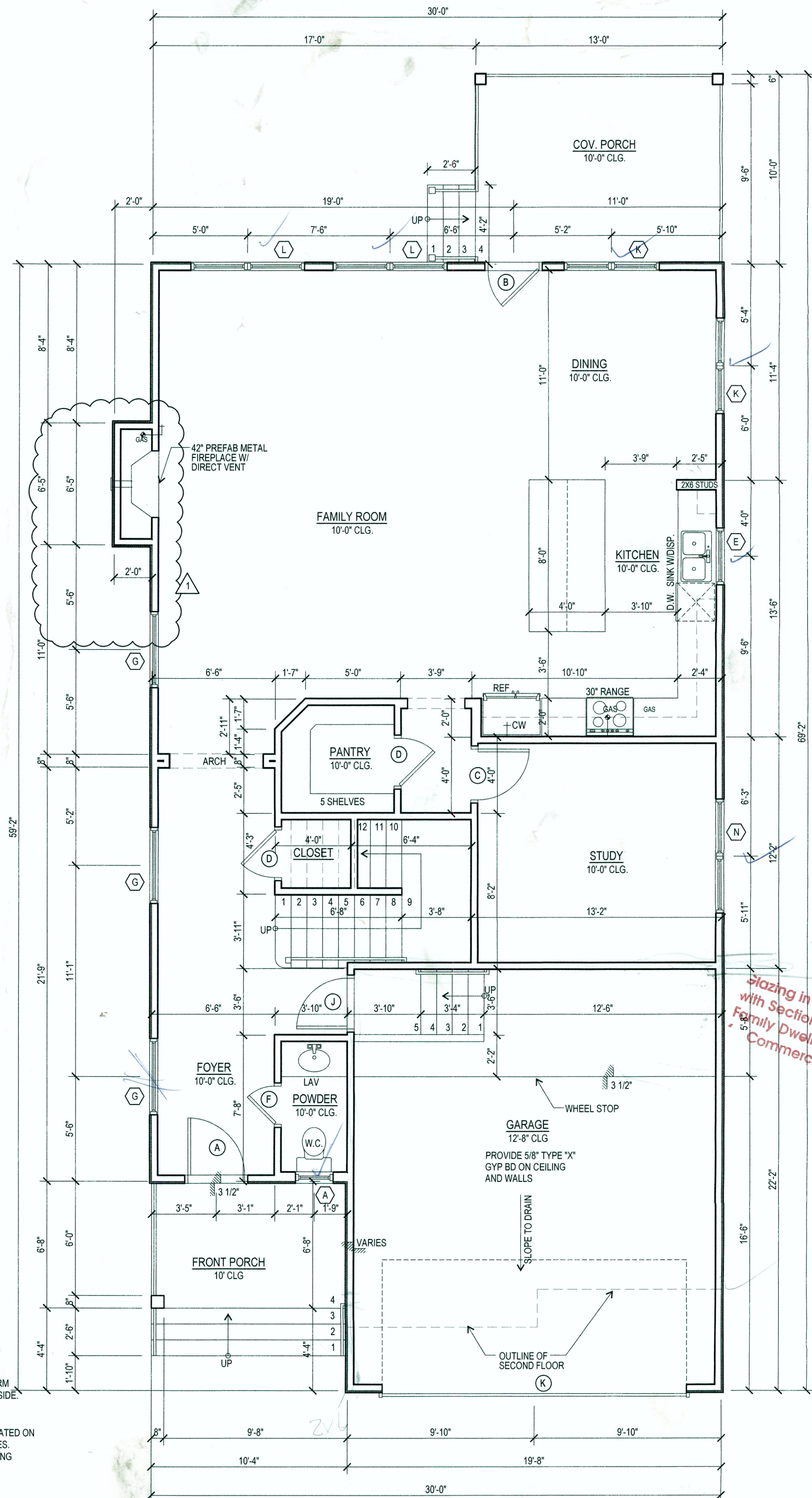

**1 FIRST FLOOR PLAN**  
1/4"=1'-0"  
NORTH

FIRST FLOOR CONDITIONED	1,244 S.F.	FIRST FLOOR UNCONDITIONED	1,244 S.F.
SECOND FLOOR CONDITIONED	1,538 S.F.	SECOND FLOOR UNCONDITIONED	1,538 S.F.
FRONT PORCH	69 S.F.		
GARAGE	433 S.F.		
COVERED PATIO	130 S.F.		
<b>TOTAL</b>	<b>3,414 S.F.</b>		

**APPROVED**  
FOR BUILDING PERMIT ONLY  
CITY OF HOUSTON  
CODE ENFORCEMENT DIVISION  
The owner is responsible for compliance with the Building Code. Such approved plans and specifications shall not be changed, modified or altered without authorizations from the building official, and all work shall be done in accordance with the approved plans.  
**NO. 35B**

22-C  
22  
placing in Hazardous Locations shall Comply with Section-R308 of I.R.C. for One and Two Family Dwellings OR Section-2406 of I.B.C. Commercial Construction.

**METRO LIVING**

9610 Long Point Rd. Suite 220  
Houston, Texas 77055  
281.685.9561 Phone  
832.767.6272 Fax  
jose@metrolivingstudio.com  
metrolivingstudio.com

© METRO LIVING L.L.C.  
2018. ALL RIGHTS RESERVED.

The designers of Metro Living LLC are not, and do not represent to be, licensed architects. The designation Professional Building Designer (PBD) does not confer or imply any legal status in the State of Texas as a "registered professional". In Texas the practice of Commercial and Residential Design by a designer who is not a licensed architect is limited and permitted by exemptions to the Architect statute Chapter 1051. The building design works depicted herein are the sole property of Metro Living LLC and may not be constructed or used without its express written permission. No permission to modify or reproduce any of these building design works, including without limitation the construction of any building, is expressed or should be implied from delivery of preliminary drawings or unsealed construction drawings. Permission to construct the building depicted in sealed construction drawings is expressly conditioned on the full and timely payment of all fees otherwise due Metro Living LLC and, in the absence of any written agreement to the contrary, is limited to a one-time use on the site indicated on these plans.

SHEET TITLE:  
FIRST FLOOR PLAN  
SECOND FLOOR PLAN

SHEET NO:  
**A2.00**