

LAND TITLE SURVEY
 FOR: KENNETH E. SIMMONS
 & D ALENE A. SIMMONS
 184 COYOTE RUN
 WILLIS, TEXAS 77318

BEING four tracts of land situated in the Jose Maria De La Garza Leagues, Abstract No. 15, Montgomery County, Texas, and Abstract No. 22, Walker County, Texas.

Tracts are all or portions of those 4,878 acre Tracts 1, 2 and 3 as described in deed to Michael Kevin McCarver recorded under County Clerk's File No. 2000-045780 of the Official Public Records of Montgomery County, Texas, and a 1,000 acre tract described in deed to Clata McCarver recorded under said Montgomery County Clerk's File No. 2003-065392, said four tracts shown hereon more particularly described by attached Metes and Bounds.

BEING a 4.39 acre tract of land situated in the Jose Maria De La Garza Leagues, Abstract No. 22, Walker County, Texas, and being that portion of the Simmons tracts as Surveyed 16 July 2014, within Walker County, Texas, said tract being more particularly described by attached Metes and Bounds.

NBL 99.46 & 15.074'

(TR 1)
 2000-045780
 Tax ID 58813

(TR 2)
 2000-045780
 Tax ID 58813

(TR 3)
 2000-045780
 Tax ID 58815

(30) COYOTE ROADWAY
 R/W Esmt.: 182/284 & 182/486 MCDR
 1062/01 MCDR 16,094 A
 586/459 MCDR

1062/01 MCDR 16,094 A
 586/459 MCDR

1062/01 MCDR 16,094 A
 586/459 MCDR

1062/01 MCDR 16,094 A
 586/459 MCDR

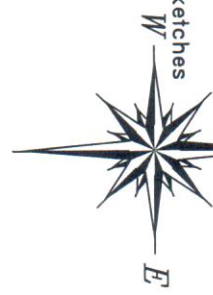

Line points along County Line
 Pinned at request of Walker
 County Planning & Development
 04 May 2015

A-22 (WALKER COUNTY) - 2 3/4 LEAGUES

4.39 AC

5.48 AC

5.48 AC

5.48 AC

5.48 AC

5.48 AC

5.48 AC

5.48 AC

A-15 (MONTGOMERY CO.) - 5 LEAGUES

JOSE MARIA DE LA GARZA

Headwaters of the San Jacinto
 01 February 1847
 11 Leagues (48,712 AC)

Michael C. Warren
 Registered Professional Land Surveyor No. 4935

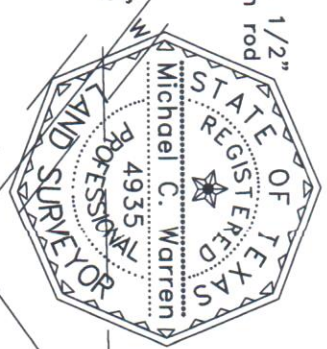

I hereby certify that this survey was made
 on the ground under my supervision and that this
 drawing correctly represents the facts found
 at the time of survey.
 Date of Survey: 24 July 2015

[Signature]

W'ly corner
 McCarter 1
 N 33°36'40" W
 304.62'

W'ly corner
 McCarter 2
 N 33°36'40" W
 304.62'

W'ly corner
 McCarter 1
 S 51°37'13" E
 218.91'

W'ly corner
 McCarter 2
 N 29°17'57" E
 213.30'

W'ly corner
 McCarter 3
 S 51°34'23" E
 184.95'

W'ly corner
 McCarter 1
 S 55°33'30" W
 129.86'

W'ly corner
 McCarter 2
 S 89°15'00" W
 491.05'

W'ly corner
 McCarter 1
 S 89°15'00" W
 329.98'

W'ly corner
 McCarter 2
 S 89°15'00" W
 329.98'

W'ly corner
 McCarter 3
 S 55°33'30" W
 129.86'

W'ly corner
 McCarter 1
 S 55°33'30" W
 129.86'

W'ly corner
 McCarter 2
 S 55°33'30" W
 129.86'

Parent Tract References:
 99.46 AC 562/581 MCDR
 15.022 AC 621/899 MCDR
 10.018 AC 1062/001 MCDR

Parent Tract References:
 99.46 AC 562/581 MCDR
 15.022 AC 621/899 MCDR
 10.018 AC 1062/001 MCDR

Parent Tract References:
 99.46 AC 562/581 MCDR
 15.022 AC 621/899 MCDR
 10.018 AC 1062/001 MCDR

Parent Tract References:
 99.46 AC 562/581 MCDR
 15.022 AC 621/899 MCDR
 10.018 AC 1062/001 MCDR

Parent Tract References:
 99.46 AC 562/581 MCDR
 15.022 AC 621/899 MCDR
 10.018 AC 1062/001 MCDR

Parent Tract References:
 99.46 AC 562/581 MCDR
 15.022 AC 621/899 MCDR
 10.018 AC 1062/001 MCDR

Parent Tract References:
 99.46 AC 562/581 MCDR
 15.022 AC 621/899 MCDR
 10.018 AC 1062/001 MCDR

P.O. BOX 1348
 (936) 856-8989
 PROJECT NO.: 420114893

P.O. BOX 1348
 (936) 856-8989
 PROJECT NO.: 420114893

P.O. BOX 1348
 (936) 856-8989
 PROJECT NO.: 420114893

P.O. BOX 1348
 (936) 856-8989
 PROJECT NO.: 420114893

P.O. BOX 1348
 (936) 856-8989
 PROJECT NO.: 420114893

P.O. BOX 1348
 (936) 856-8989
 PROJECT NO.: 420114893

P.O. BOX 1348
 (936) 856-8989
 PROJECT NO.: 420114893