

Building Sketch

Borrower/Client	WESLEY, SHANNON				
Property Address	25204 Forest Ledge Dr				
City	Porter	County	Montgomery	State	TX
Zip Code	77365				
Lender	Wells Fargo Bank, N.A. - 0034428				

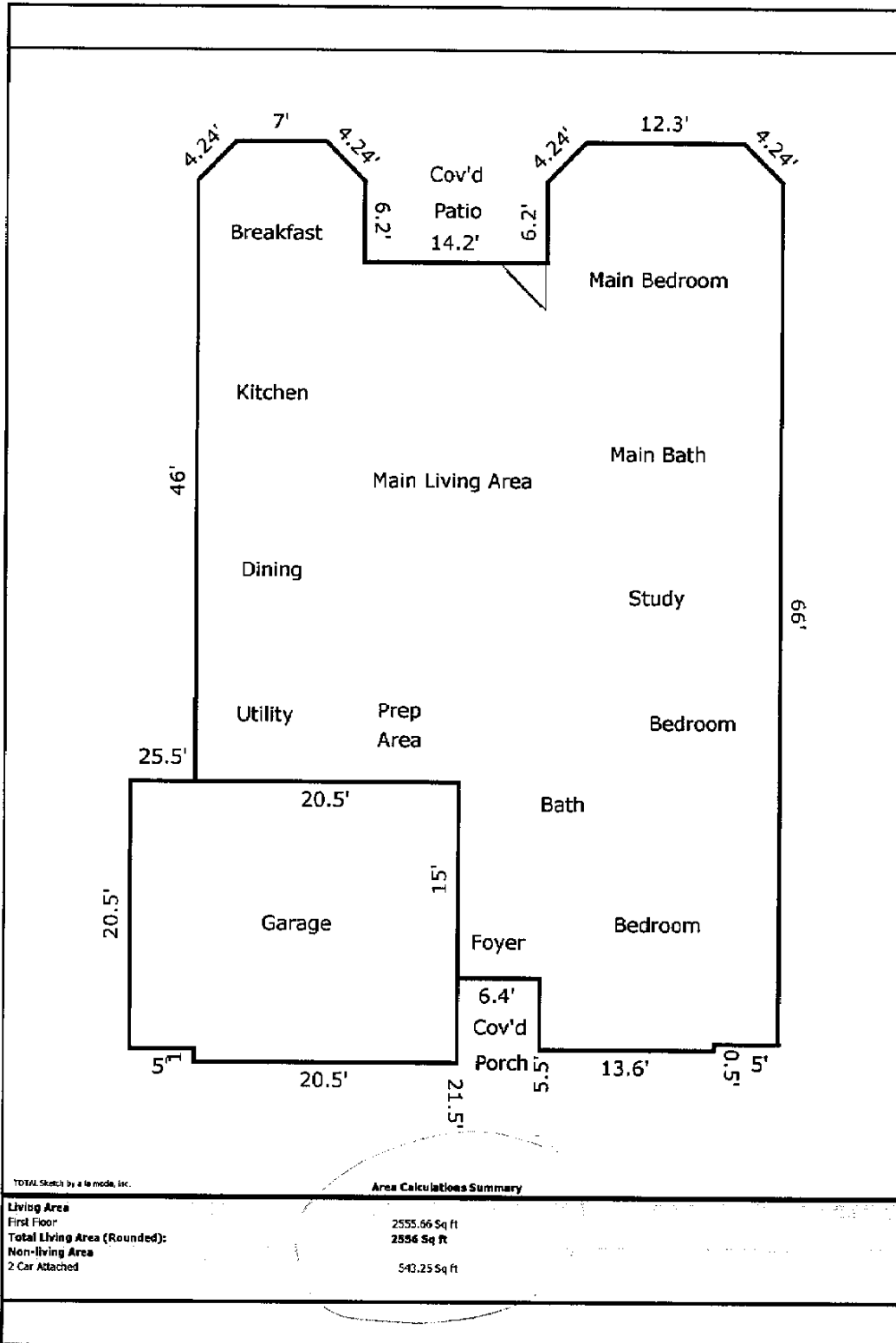

Area Calculations Summary	
Living Area	
First Floor	2555.66 Sq ft
Total Living Area (Rounded):	2556 Sq ft
Non-living Area	
2 Car Attached	543.25 Sq ft