

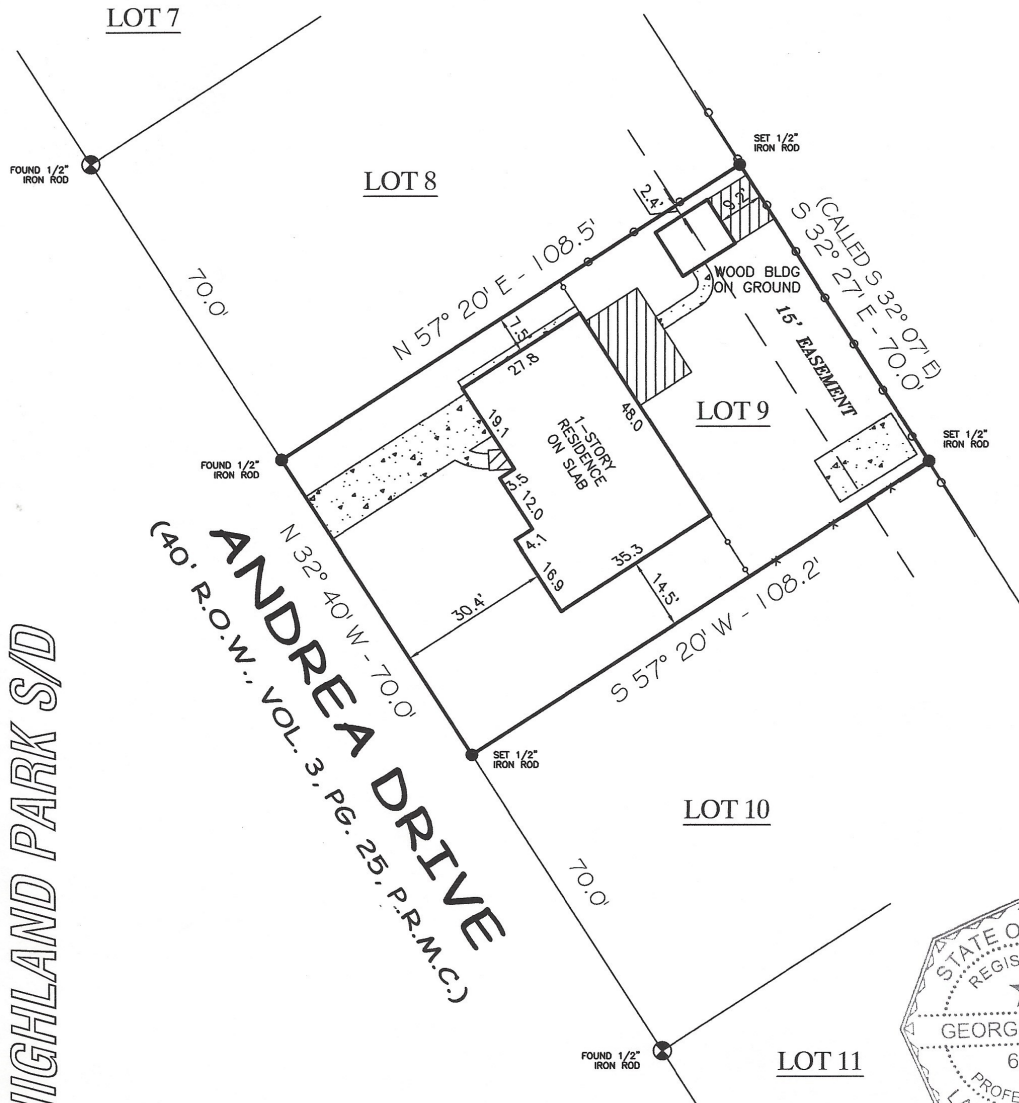

PIN POINT Surveying & Mapping, LLC

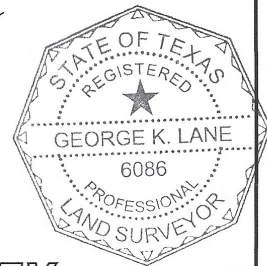

P.E. & H.W. GARRETT'S ANNEX



COMMUNITY NO: 485455 PANEL NO: 0005 SUFFIX: C ZONE: B BASE: N/A MAP REVISED: 6/5/85

I have consulted the HUD-FIA Flood Hazard Boundary Map in the above described property and it IS NOT in a designated flood hazard area. The plat hereon is a true, correct and accurate representation of the property as determined by survey. The lines and dimensions of said property being as indicated by the plat, the size, location and type of buildings and improvements are as shown, all improvements being within the boundaries of the property, set back and distances from property lines are as indicated. There are no encroachments, conflicts, or protrusions, except as shown.

NOTES:

PROPERTY SUBJECT TO RECORDED, RESTRICTIONS, REGULATIONS, & ORDINANCES (IF ANY), INCLUDING THOSE IN THE CITY OF: BAY CITY

ABSTRACT AND TITLE INFORMATION WAS PROVIDED BY: BAY CITY ABSTRACT
THIS SURVEY DOES NOT CONSTITUTE A TITLE SEARCH BY THE SURVEYOR. BEARINGS ARE BASED ON THE RECORDED MAP OR PLAT. G.F. NO. 201009426 DATED: 9/7/2010

ALL BUILDING LINES, EASEMENTS, BUILDING RESTRICTIONS (DEED RESTRICTIONS, ETC.) AND ZONING ORDINANCES, IF ANY, THAT MAY AFFECT SUBJECT PROPERTY SHOULD BE VERIFIED BY BUILDER BEFORE COMMENCING CONSTRUCTION.

PREPARED EXCLUSIVELY FOR: BAY CITY ABSTRACT
This is to certify that I have made an on the ground survey of the property located at:
1413 ANDREA DRIVE IN THE CITY OF BAY CITY, TEXAS.

Lot No. Nine (9) of P.E. and H.W. GARRETT'S ANNEX TO HIGHLAND PARK SUBDIVISION, out of the I. # GN RR Co. Survey No. 2, Block 4, Abstract No. 270, Matagorda County, Texas, an addition to the City of Bay City, according to the plat thereof recorded in Volume 3 at page 25 of the Plat Records of Matagorda County, Texas.

Borrower(s): JESUS GARCIA
TIFFANY GARCIA
Jesus Garcia
Tiffany Garcia

Drawn by: GLANE
Job No.: 2010-0433
Request: SIGRID
Book No: 10P011
Scale: 1" = 30'
Date: 10/5/2010

LEGEND	
	ASPHALT
	COVERED
	CONCRETE
	CHAIN-LINK
	WOOD FENCE
	IRON FENCE
	CONTROLLING MONUMENT
	CORNER
	U.E. UTILITY EASEMENT
	A.E. AERIAL EASEMENT
	B.L. BUILDING LINE
	R.O.W. RIGHT-OF-WAY
	I.R. IRON ROD
	I.P. IRON PIPE
	FND. FOUND

George K. Lane
George K. Lane, R.P.L.S.
REGISTERED PROFESSIONAL LAND SURVEYOR NO. 6086