

NOTES:  
 NO RECORDS SEARCH CONTRACTED.  
 SURVEY PREPARED FROM TITLE  
 COMPANY SPECIFICATIONS. CLIENT  
 RELIES SOLELY ON TITLE COMPANY  
 SPECIFICATIONS AS TO RECORD EASEMENTS,  
 RESTRICTIONS, ROADWAYS, RIGHTS-OF-WAY,  
 BUILDING LINES, ENCUMBRANCES, ETC.;  
 CLIENT AND TITLE COMPANY HOLD  
 TLTS, INC. HARMLESS FROM RESPONSIBILITY  
 FOR SAME

- Restrictions as per recorded plat unless otherwise noted
- True ground distances shown
- Bearings assumed as platted
- "Pointe San Luis Laguna & Playa Plan Review Application" :5' side building lines
- Survey monuments reconciled w/numerous previous surveys



LAND TITLE SURVEY OF A TRACT OF LAND being Lot 16, in Block 1, of LAGUNA SAN LUIS I SUBDIVISION, a subdivision in Galveston County, Texas, according to the map or plat thereof recorded in Volume 18, Page 150 of the Map Records of Galveston County, Texas.

Vacant property: Monterey Court  
 Galveston County, Texas  
 This survey is certified for this transaction only and may only be relied on by Richard Walker and South-Land Title Co., GF #WE1753550. This survey is only valid if print has original seal and signature of surveyor  
 I hereby certify that this survey was made on the ground under my direct supervision and that this plat correctly represents the facts found at the time of the survey.

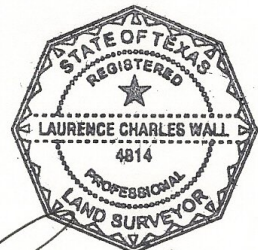

Laurence C. Wall  
 RPLS #4814  
 June 21, 2017

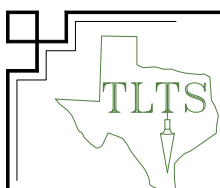

**TLTS, Inc.**  
 TEXAS LAND TITLE SURVEYORS  
 1801 Moody Avenue  
 Galveston, Texas 77550  
 (409) 765-8883