

# DESIGNER INFORMATION



|                   |                                    |
|-------------------|------------------------------------|
| <b>BUYER NAME</b> | <b>Showcase Home</b>               |
| <b>QUOTE</b>      | <b>Q-11427</b>                     |
| <b>Plan</b>       | <b>Garnet</b>                      |
| <b>ADDRESS</b>    | <b>28050 Drifters Bend</b>         |
| <b>COMMUNITY</b>  | <b>Harmony 65</b>                  |
| <b>DESIGNER</b>   | <b>Laura Tyler</b>                 |
| <b>PHONE</b>      | <b>281-664-7255</b>                |
| <b>EMAIL</b>      | <b>laurat@thedesigncenters.com</b> |
| <b>DATE</b>       | <b>10/16/2018</b>                  |
| <b>NOTES</b>      |                                    |

**Division: Texas Houston - Homebuilding**

**Community: Harmony 65**

**Lot Number: LOT 28 (010128)**

**quote number:Q-11427**

**Model: Garnet**

**Buyer:**

**Address: 28050 Drifters Bend Drive, Spring, TX, 77386**

**Swing: N/A**

| Product Code                        | Name  | Qty      | List Unit Price | Total Price |
|-------------------------------------|---|----------|-----------------|-------------|
| <b>(Order #: To Be Approved)</b>    |   |          |                 |             |
| <i>Category: Accessories</i>        |   |          |                 |             |
| GPOT0001                            | Gourmet 30" Pot and Pan Drawer<br><i>to be placed under cooktop</i> | 1.00     | \$520.00        | \$520.00    |
| <i>Category: Appliance Packages</i> |   |          |                 |             |
| GEAP0402                            | GE 30" SS 5Burner Cooktop w/BI Microwave/Oven Appliance Package     | 1.00     | \$800.00        | \$800.00    |
| <i>Category: Bath 2</i>             |   |          |                 |             |
| B2CB0004                            | Bath 2 Level 3  | 1.00     | \$140.00        | \$140.00    |
|                                     | <i>Espresso</i>   | <i>1</i> |                 |             |
|                                     | <i>Sonoma Maple</i>   | <i>1</i> |                 |             |
| <i>Category: Bath 3</i>             |   |          |                 |             |
| B3CB0004                            | Bath 3 Level 3  | 1.00     | \$284.00        | \$284.00    |
|                                     | <i>Espresso</i>   | <i>1</i> |                 |             |
|                                     | <i>Sonoma Maple</i>   | <i>1</i> |                 |             |
| <i>Category: Bath Hardware</i>      |   |          |                 |             |
| HDBH0002                            | Taymor Bath Hardware - select finish to match plumbing              | 1.00     | \$0.00          | \$0.00      |
|                                     | <i>Satin Nickel</i>   | <i>1</i> |                 |             |

**Category: Blinds**

|          |                                      |          |            |            |
|----------|--------------------------------------|----------|------------|------------|
| WNDW0001 | Window Treatment Pre-Bill            | 1.00     | \$1,767.00 | \$1,767.00 |
|          | <i>See VEO Report for Selections</i> | <i>1</i> |            |            |

---

**Category: Custom**

|          |  |      |          |          |
|----------|--|------|----------|----------|
| CUST1233 | Custom Cabinet Option  | 1.00 | \$268.00 | \$268.00 |
|          | <i>Use Pull 3502 SN for drawers Use knob 3503 SN for doors Kitchen and baths</i> |      |          |          |

---

**Category: Flooring**

|          |                                      |          |             |             |
|----------|--------------------------------------|----------|-------------|-------------|
| TILE0001 | Tile Pre-Bill                        | 1.00     | \$15,355.00 | \$15,355.00 |
|          | <i>See VEO Report for Selections</i> | <i>1</i> |             |             |

|          |                                      |          |            |            |
|----------|--------------------------------------|----------|------------|------------|
| CARP0001 | Carpet Pre-Bill                      | 1.00     | \$3,045.00 | \$3,045.00 |
|          | <i>See VEO Report for Selections</i> | <i>1</i> |            |            |

---

**Category: Front Doors**

|          |   |          |          |          |
|----------|---|----------|----------|----------|
| FDGB5001 | 8' - Single - Level 1 Hardwood Front Door | 1.00     | \$100.00 | \$100.00 |
|          | <i>2/3 Lite Courtlandt/Mahogany</i>       | <i>1</i> |          |          |
|          | <i>Stain-Jacobean (Mahogany)</i>          | <i>1</i> |          |          |

---

**Category: Interior Door Trim & Hardware**

|             |  |      |          |          |
|-------------|--|------|----------|----------|
| DRHW2316PK  | Upgrade to Bowery Satin Nickel Knobs   | 1.00 | \$470.00 | \$470.00 |
| DRHW2101EXT | Upgrade to Addison Satin Nickel Handleset - Can only be selected with Bowery, Broadway, Birmingham, Latitude or Northbrook interior hardware | 1.00 | \$210.00 | \$210.00 |

---

**Category: Kitchen Faucets**

|          |                                       |      |          |          |
|----------|---------------------------------------|------|----------|----------|
| FXKT0202 | Kitchen Faucet - Arbor - SS - 7594SRS | 1.00 | \$150.00 | \$150.00 |
|----------|---------------------------------------|------|----------|----------|

---

**Category: Kitchen Granite**

|          |                                      |          |            |            |
|----------|--------------------------------------|----------|------------|------------|
| CTOP0001 | Countertop Pre-Bill                  | 1.00     | \$9,125.00 | \$9,125.00 |
|          | <i>See VEO Report for Selections</i> | <i>1</i> |            |            |

---

**Category: LVL 1 Fix - Master Bath**

|          |                                   |      |          |          |
|----------|-----------------------------------|------|----------|----------|
| PFMB0102 | Master Bath - Brantford - 4" - BN | 1.00 | \$520.00 | \$520.00 |
|----------|-----------------------------------|------|----------|----------|

---

**Category: LVL 1 Fix - Sec. Bath**

|          |  |      |          |          |
|----------|--|------|----------|----------|
| PFBS0107 | Sec. Bath - 1 Sink - Brantford - 4" - BN<br><i>Bath 2</i>  | 1.00 | \$360.00 | \$360.00 |
| PFSD0107 | Sec. Bath - 2 Sinks - Brantford - 4" - BN<br><i>Bath 3</i> | 1.00 | \$475.00 | \$475.00 |

---

**Category: Light Fixture Packages - Lvl 1**

|          |                       |          |        |        |
|----------|-----------------------|----------|--------|--------|
| LTPK0101 | Light Pkg - Jolie     | 1.00     | \$0.00 | \$0.00 |
|          | <i>Brushed Nickel</i> | <i>1</i> |        |        |

---

**Category: Master Bath**

|          |   |          |          |          |
|----------|---|----------|----------|----------|
| MCAB0004 | Master Bath Level 3 (note high or low knee space) | 1.00     | \$262.00 | \$262.00 |
|          | <i>Espresso</i>                                   | <i>1</i> |          |          |
|          | <i>Sonoma Maple</i>                               | <i>1</i> |          |          |

---

**Category: Opt. Built-In Kitchen 30" Ctop**

|          |   |          |            |            |
|----------|---|----------|------------|------------|
| KCAB0103 | Opt. Built-in w/ 30" Cooktop w/ level 3 w/ island and casual dining | 1.00     | \$2,574.00 | \$2,574.00 |
|          | <i>Espresso</i>   | <i>1</i> |            |            |
|          | <i>Sonoma Maple</i>   | <i>1</i> |            |            |

---

**Category: Painting**

|          |  |          |        |        |
|----------|--|----------|--------|--------|
| PNTI0001 | Standard Interior Paint                  | 1.00     | \$0.00 | \$0.00 |
|          | <i>PPG - Scotch Mist PPG14 - 07</i>      | <i>1</i> |        |        |
|          | <i>same as wall</i>                      | <i>1</i> |        |        |
| PTAC0000 | Interior Trim Whole House Standard Color | 1.00     | \$0.00 | \$0.00 |
|          | <i>PPG - Delicate White PPG1001 - 1</i>  | <i>1</i> |        |        |
|          | <i>same as wall</i>                      | <i>1</i> |        |        |

---

**Category: Shower Enclosures**

|          |  |      |          |          |
|----------|--|------|----------|----------|
| SHBF0003 | Master Bath - Satine Shower Door Frame | 1.00 | \$350.00 | \$350.00 |
|----------|--|------|----------|----------|

---

**Category: Stair Hand Rail**

|          |                          |          |        |        |
|----------|--------------------------|----------|--------|--------|
| HASR0000 | Standard Hand Rail Stain | 1.00     | \$0.00 | \$0.00 |
|          | <i>Vettii</i>            | <i>1</i> |        |        |

---

**Category: Stair Spindles**

|          |   |          |          |          |
|----------|---|----------|----------|----------|
| STRO0006 | Balusters: Level 1 Metal (Includes choice of Level 1 metal pattern in satin black finish)<br><i>open rail 1</i>                         | 1.00     | \$390.00 | \$390.00 |
|          | <i>Black</i>  | <i>1</i> |          |          |
|          | <i>P-10K</i>  | <i>1</i> |          |          |
| STRO0003 | Oak First Step w/ Square Ends (includes 1" thick red oak tread with squared ends with an oak riser. This option does not change newels) | 1.00     | \$292.00 | \$292.00 |



---

**Category: Water Systems**

|          |                                 |      |        |        |
|----------|---------------------------------|------|--------|--------|
| WTRS0009 | Classic Satin Nickel/P-CSPSI-SN | 1.00 | \$0.00 | \$0.00 |
|----------|---------------------------------|------|--------|--------|

---

**(Order #: 1)****Category: Bathroom Options**

|          |  |      |        |        |
|----------|--|------|--------|--------|
| OWNB0222 | Opt Shower 2 with Mud-set Tile Floor @ Owner's Bath - Larger Pan | 1.00 | \$0.00 | \$0.00 |
|----------|--|------|--------|--------|

|          |   |      |        |        |
|----------|---|------|--------|--------|
| OWNB0120 | Opt. Shower / Mud-set @ Owner's Bath (Base plan's Owner Bath Configuration) | 1.00 | \$0.00 | \$0.00 |
|----------|---|------|--------|--------|

---

**Category: Brick**

|          |  |      |        |        |
|----------|--|------|--------|--------|
| BRCK1000 | Meridian Brick - Standard Brick Colors<br><i>Desert Pass Brick</i> | 1.00 | \$0.00 | \$0.00 |
|----------|--|------|--------|--------|

|  |             |          |  |  |
|--|-------------|----------|--|--|
|  | <i>Gray</i> | <i>1</i> |  |  |
|--|-------------|----------|--|--|

|  |                        |          |  |  |
|--|------------------------|----------|--|--|
|  | <i>M - Desert Pass</i> | <i>1</i> |  |  |
|--|------------------------|----------|--|--|

---

**Category: Brick Options**

|          |   |      |        |        |
|----------|---|------|--------|--------|
| VNBR0010 | Brick ilo Siding @ Sides - First Floor Only | 1.00 | \$0.00 | \$0.00 |
|----------|---|------|--------|--------|

|          |  |      |        |        |
|----------|--|------|--------|--------|
| VNBR0012 | Brick ilo Siding @ Sides - Second Floor Only | 1.00 | \$0.00 | \$0.00 |
|----------|--|------|--------|--------|

|          |  |      |        |        |
|----------|--|------|--------|--------|
| VNBR0020 | Brick ilo Siding @ Rear - First Floor Only | 1.00 | \$0.00 | \$0.00 |
|----------|--|------|--------|--------|

|          |   |      |        |        |
|----------|---|------|--------|--------|
| VNBR0022 | Brick ilo Siding @ Rear - Second Floor Only | 1.00 | \$0.00 | \$0.00 |
|----------|---|------|--------|--------|

---

**Category: Ceiling Fans**

|          |  |      |        |        |
|----------|--|------|--------|--------|
| CFAN0001 | Additional Standard Ceiling Fan - must add pre-wire for additional fan<br><i>tbd at dc</i> | 1.00 | \$0.00 | \$0.00 |
|----------|--|------|--------|--------|

|  |   |          |  |  |
|--|---|----------|--|--|
|  | <i>N17 Brushed Nickel w/ White Etched Glass</i> | <i>1</i> |  |  |
|--|---|----------|--|--|

---

**Category: Commodes**

|          |                                    |      |        |        |
|----------|------------------------------------|------|--------|--------|
| COMM0001 | Commode - Elongated in Master Bath | 1.00 | \$0.00 | \$0.00 |
|----------|------------------------------------|------|--------|--------|

---

**Category: Electrical**

|          |                 |      |        |        |
|----------|-----------------|------|--------|--------|
| ELOL0016 | Decora Switches | 1.00 | \$0.00 | \$0.00 |
|----------|-----------------|------|--------|--------|

|          |                            |      |        |        |
|----------|----------------------------|------|--------|--------|
| ELPN0001 | Electrical Panel in Garage | 1.00 | \$0.00 | \$0.00 |
|----------|----------------------------|------|--------|--------|

|          |                               |      |        |        |
|----------|-------------------------------|------|--------|--------|
| GDOR0001 | Garage Door Opener (per door) | 1.00 | \$0.00 | \$0.00 |
|----------|-------------------------------|------|--------|--------|

---

**Category: Exterior Options (Structural)**

|          |                                 |      |          |          |
|----------|---------------------------------|------|----------|----------|
| FDOP0001 | 8 Foot Single Front Door Option | 1.00 | \$850.00 | \$850.00 |
|----------|---------------------------------|------|----------|----------|

|          |   |      |             |             |
|----------|---|------|-------------|-------------|
| BALC0001 | Balcony - Must select with 2nd Floor Game Room Option.<br>Can't be selected with Bedroom 5 & Bath 4 Option<br><i>No back Neighbor</i> | 1.00 | \$12,875.00 | \$12,875.00 |
|----------|---|------|-------------|-------------|

---

**Category: Exterior Paint**

|          |   |      |        |        |
|----------|---|------|--------|--------|
| PNTE0000 | Exterior Paint Color Standard<br><i>Stoningham 15-25 : TRIM Wild Wilderness 1019-5 :Garage &amp; shutters</i> | 1.00 | \$0.00 | \$0.00 |
|----------|---|------|--------|--------|

---

**Category: General Room Options**

|          |  |      |        |        |
|----------|--|------|--------|--------|
| GAME0001 | Game Room  | 1.00 | \$0.00 | \$0.00 |
| WDTK0001 | Window Package Turnkey   | 1.00 | \$0.00 | \$0.00 |
| GRMT2000 | Gourmet Kitchen 2 - Cooktop with Vented Hood and 30"/36"<br>Built-In Wall Oven / Micro Tower - Must select and pay for<br>corresponding appliance and cabinet options (GEAP0203,<br>GEAP0204, GEAP0207, GEAP0209, GEAP0401, GEAP0402,<br>GEAP0406, GEAP0407) | 1.00 | \$0.00 | \$0.00 |

---

**Category: Interior Options (Structural)**

|          |                     |      |            |            |
|----------|---------------------|------|------------|------------|
| STRO0100 | Open Rail Option #1 | 1.00 | \$1,060.00 | \$1,060.00 |
|----------|---------------------|------|------------|------------|

---

**Category: Interior Trim**

|          |  |      |        |        |
|----------|--|------|--------|--------|
| CRWN1006 | Crown Mld - 1 pc - Study                           | 1.00 | \$0.00 | \$0.00 |
| CRWN1001 | Crown Mld - 1 pc - Dining Room                     | 1.00 | \$0.00 | \$0.00 |
| CRWN1003 | Crown Mld - 1 pc - Entry                           | 1.00 | \$0.00 | \$0.00 |
| TRIM0013 | Trim Upgrade to Level 3 - Interior Base and Casing | 1.00 | \$0.00 | \$0.00 |

---

**Category: Kitchen Sinks**

|          |  |      |        |        |
|----------|--|------|--------|--------|
| SINK0011 | Sink Upgrade - Provided by Wisenbaker (priced at the DC) | 1.00 | \$0.00 | \$0.00 |
|----------|--|------|--------|--------|

---

**Category: Multiple Mechanicals**

|          |                      |      |        |        |
|----------|----------------------|------|--------|--------|
| QUCK0001 | Quick Flash Products | 1.00 | \$0.00 | \$0.00 |
|----------|----------------------|------|--------|--------|

---

**Category: Special Custom**

|          |                        |      |        |        |
|----------|------------------------|------|--------|--------|
| CMAD0000 | Community Requirements | 1.00 | \$0.00 | \$0.00 |
|----------|------------------------|------|--------|--------|

---

**Category: Stone**

|          |  |      |            |            |
|----------|--|------|------------|------------|
| EFST0003 | Stone Level 3 (must select with stone front option)<br><i>Grandbury Chop stone</i> | 1.00 | \$1,247.00 | \$1,247.00 |
|          | <i>Grandbury Chop</i>  | 1    |            |            |
|          | <i>Khaki</i>   | 1    |            |            |

---

(Order #: Cancelled)

*Category: Appliance Packages*

|          |  |      |        |        |
|----------|--|------|--------|--------|
| GEAP0401 | GE 30" Stainless Cooktop w/BI Microwave/Oven Appliance Package | 1.00 | \$0.00 | \$0.00 |
|----------|--|------|--------|--------|

---

*Category: Interior Door Trim & Hardware*

|              |  |      |        |        |
|--------------|--|------|--------|--------|
| DRHW1101EXTG | Upgrade to Barcelona Satin Nickel Handleset - Can only be sold with Stratus and Torino interior hardware | 1.00 | \$0.00 | \$0.00 |
| DRHW1209PKCP | Upgrade to Stratus Satin Nickel Knobs  | 1.00 | \$0.00 | \$0.00 |

---

*Category: Kitchen Faucets*

|          |  |      |        |        |
|----------|--|------|--------|--------|
| FXKT0102 | Kitchen Faucet - Camersit - SS - 7545SRS | 1.00 | \$0.00 | \$0.00 |
|----------|--|------|--------|--------|

---

*Category: LVL 1 Fix - Master Bath*

|          |                                       |      |        |        |
|----------|---------------------------------------|------|--------|--------|
| PFMB0101 | Master Bath - Brantford - 4" - Chrome | 1.00 | \$0.00 | \$0.00 |
|----------|---------------------------------------|------|--------|--------|

---

*Category: Light Fixture Packages - Lvl 2*

|          |                      |          |        |        |
|----------|----------------------|----------|--------|--------|
| LTPK0201 | Light Pkg - Stafford | 1.00     | \$0.00 | \$0.00 |
|          | <i>Bronze</i>        | <i>1</i> |        |        |

---

*Category: Opt. Built-In Kitchen 30" Ctop*

|          |                                      |          |        |        |
|----------|--------------------------------------|----------|--------|--------|
| KCAB0100 | Opt. Built-in w/ 30" Cooktop w/ std. | 1.00     | \$0.00 | \$0.00 |
|          | <i>Cognac</i>                        | <i>1</i> |        |        |
|          | <i>Tahoe Maple</i>                   | <i>1</i> |        |        |

---

*Category: Stair Hand Rail*

|          |                          |          |        |        |
|----------|--------------------------|----------|--------|--------|
| HASR0000 | Standard Hand Rail Stain | 1.00     | \$0.00 | \$0.00 |
|          | <i>Dark Mahogany</i>     | <i>1</i> |        |        |

---

*Category: Vanity Granite Group 1*

|          |  |      |        |        |
|----------|--|------|--------|--------|
| GRVN1001 | Master Bath - Group 1 Granite Vanity Top (Priced through Wisenbaker) | 1.00 | \$0.00 | \$0.00 |
|----------|--|------|--------|--------|

---

|                             |                     |
|-----------------------------|---------------------|
| <b>Sub Total</b>            | <b>\$53,489.00</b>  |
| <b>Lot Premium</b>          | <b>\$20,000.00</b>  |
| <b>Base Price</b>           | <b>\$349,990.00</b> |
| <b>Option Total</b>         | <b>\$53,489.00</b>  |
| <b>Incentive Given</b>      | <b>\$0.00</b>       |
| <b>Total Purchase Price</b> | <b>\$423,479.00</b> |

---

This system-generated *Proposal* is provided to a prospective buyer and/or its Broker/Agent outside of and not made a part of the Purchase Agreement: (1) all information as of the date indicated remains subject to change at any time without notice or obligation; and (2) is for illustrative and informational purposes only for preliminary discussions for prospective buyer's convenience. No guarantee or representation is made or implied as to availability, manufacturer, style, size, color, number, pricing and other factors installed in the completed home and/or subject to applicable incentives (if any) affecting pricing, all of which Seller reserves the right to modify. Refer to the final executed Purchase Agreement and its attached Addenda (inclusive of any post-purchase amendments thereto) and the specific Community's Standard Features List for complete details. Equal Housing Builder.



|   |                                 |  |   |                               |
|---|---------------------------------|--|---|-------------------------------|
| <b>BUYER:</b><br>28050 Drifters Bend<br>spec home | <b>DESIGNER:</b><br>Laura Tyler | <b>SALES COUNSELOR:</b><br>Other/Unknown | <b>CATALOG DATE:</b><br>10/15/2018 5:02:27 PM | <b>JOB NUMBER:</b><br>Q#11427 |
|---|---------------------------------|--|---|-------------------------------|

|   |                     |                                 |                                |                        |                    |
|---|---------------------|---------------------------------|--------------------------------|------------------------|--------------------|
| <b>ADDRESS:</b><br>28050 Drifters<br>Bend | <b>LOT / BLOCK:</b> | <b>COMMUNITY:</b><br>Harmony 65 | <b>SERIES:</b><br>Series 7 (3) | <b>PLAN:</b><br>Garnet | <b>ELEV:</b><br>NA |
|---|---------------------|---------------------------------|--------------------------------|------------------------|--------------------|

**Countertops** **\$9,125.00**

**FABRICATED CTOPS** **\$9,125.00**



**Standard White Cultured marble**  
Area: Bath 2 and Bath 3  
Price: **\$0.00** (x) 1  
Extended Price: **\$0.00**

- Gourmet Kitchen w/Cooktop/. **\$2,925.00**
- Opt Master Shower 2 Pony Wall **\$150.00**
- Opt Master Shower 2 Seat ..... **\$375.00**

Omega Stone Level 3



Countertop Color:  
**2cm Fin Omega Stone - Soprano**  
Id: OOMS2CM/SP



Countertop Edge:  
**Square Edge - 1 1/2" - Stone (41)**  
Id: SES3

- Kitchen Island ..... **\$3,125.00**

Omega Stone Level 3



Countertop Color:  
**2cm Fin Omega Stone - Soprano**  
Id: OOMS2CM/SP



Countertop Edge:  
**Square Edge - 1 1/2" - Stone (41)**  
Id: SES3



Sink:  
 Mirado HA100 Hand Made - Stainless  
 Steel U/M Sink  
 Id: OHA100/1

• Owners Bath Vanity w/Opt Sh **\$2,550.00**

Omega Stone Level 3



Countertop Color:  
 2cm Fin Omega Stone - Soprano  
 Id: OOMS2CM/SP

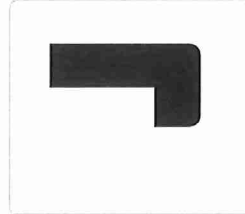

Countertop Edge:  
 Square Edge - 1 1/2" - Stone (41)  
 Id: SES3



Sink:  
 Mirado China Bowl 1519 - White  
 Id: OMRDOCHINA/1

**Flooring** **\$15,733.27**

**CARPET** **\$3,044.65**

- ACA w/Opt Upstairs Gameroo **\$4,045.56**
- Dining Credit ..... **(\$245.76)**
- Gameroom/Opt Flex Room Cr. **(\$301.12)**
- Gathering Credit ..... **(\$454.03)**

Carpet Level 7



Carpet Color:  
 East Roma- 765 Almond Shell  
 Id: 1TM13/765



Carpet Cushion:  
 Super Magic 1/2" 6lb Pad  
 Id: 15044/1

**TILE** **\$12,688.62**

- Bath 2 -A,B,C,D,D,F ..... **\$204.75**
- Bath 3 ..... **\$267.75**

- Dining ..... \$1,567.28
- Foyer -A,B,C,D,D,F ..... \$1,002.75
- Gameroom ..... \$2,054.59
- Gathering ..... \$4,236.75
- Laundry ..... \$278.25
- Opt Gourmet Kitchen 2 ..... \$1,648.50
- Owners Bath Shower Floor w/... \$115.50

↳  cut down to a 4x4

- Owners Bath w/Opt Shower 2 ... \$525.00
- Owners Entry ..... \$787.50

Floor Tile Level 6



Tile Color:  
Linden Point 12x24 - LP19 Bianco  
Id: 6LP124/LP19

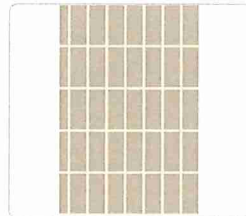

Pattern:  
Straight Lay Rectangle Front to Back  
Id: 737



Grout Color:  
TEC Power Grout - #909 Sterling  
Id: TTECPG/909

|                                       |                 |
|---------------------------------------|-----------------|
| <b>Stairs - 1. Options</b>            | <b>\$292.00</b> |
| A. (FIRST STEP) RED OAK TREAD & RISER | \$292.00        |



Red Oak Tread & Riser First Step  
Price: \$292.00 (X) 1  
Extended Price: \$292.00

|                              |                 |
|------------------------------|-----------------|
| <b>Stairs - 2. Balusters</b> | <b>\$390.00</b> |
| A. BALUSTERS LEVEL 1         | \$390.00        |



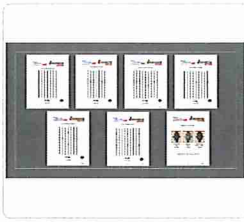

Base - Balusters Level 1

Price: **\$390.00** (x) 1

Extended Price: **\$390.00**

↳ *Style 10K Stain Black*

**Walls** **\$2,666.23**

**TILE** **\$2,666.23**

- Bath 2 Tub Splash ..... **\$346.50**
- Bath 3 Tub Splash ..... **\$346.50**
- Owners Bath Tub Deck ..... **\$319.20**

Wall Tile Level 6

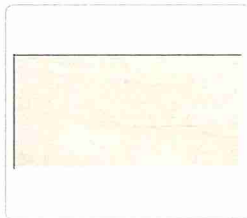

Tile Color:  
Linden Point 12x24 - LP19 Bianco  
Id: 6LP124/LP19

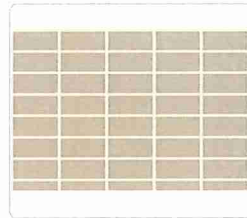

Pattern:  
Straight Lay Rectangle Horizontal  
Id: 740

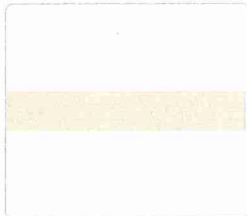

Grout Color:  
TEC Power Grout - #909 Sterling  
Id: TTECPG/909

- Opt Owners Bath Shower Stall **\$1,377.35**

Wall Tile Level 6

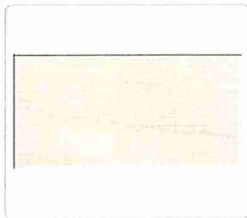

Tile Color:  
Linden Point 12x24 - LP19 Bianco  
Id: 6LP124/LP19



Pattern:  
S106  
Id: 735



Accent LinFt:  
Uptown Glass Hexagon Mosaic (12x12 Mesh) 1x1 - UP17 Alabaster  
Id: 6UPG/UP17

↳ *Accent Size: 4" Height*



Grout Color:  
TEC Power Grout - #909 Sterling  
Id: TTECPG/909



• Owners Bath Garden Tub Splash **\$159.08**

Wall Tile Level 6

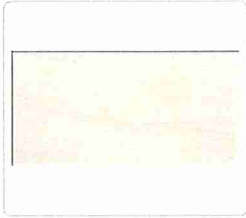

Tile Color:  
Linden Point 12x24 - LP19 Bianco  
Id: 6LP124/LP19



Pattern:  
MTS 94  
Id: 635



Grout Color:  
TEC Power Grout - #909 Sterling  
Id: TTECPG/909

• Owners Bath Tub Skirt **\$117.60**

Wall Tile Level 6

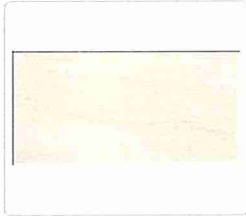

Tile Color:  
Linden Point 12x24 - LP19 Bianco  
Id: 6LP124/LP19



Pattern:  
S 67 Rectangular Staggered  
(Horizontal)  
Id: 715



Grout Color:  
TEC Power Grout - #909 Sterling  
Id: TTECPG/909

**Window Coverings \$1,766.68**

**BLINDS & SHUTTERS \$1,766.68**

- Front Elevation D **\$191.67**
- Master Bath **\$66.67**
- Opt Upstairs Gameroom w/Op... **\$341.67**
- Sides & Rear **\$1,166.67**

Capri

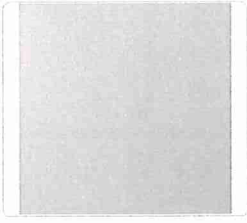

Blind Color:  
2" Capri-Designer White  
Id: BCapri02/DW



## Flooring

### TILE

- Bath 2 -A,B,C,D,D,F
- Bath 3
- Dining
- Foyer -A,B,C,D,D,F
- Gameroom
- Gathering
- Laundry
- Opt Gourmet Kitchen 2
- Owners Bath Shower Floor w/Opt Shower 2
- ↳  cut down to a 4x4
- Owners Bath w/Opt Shower 2
- Owners Entry

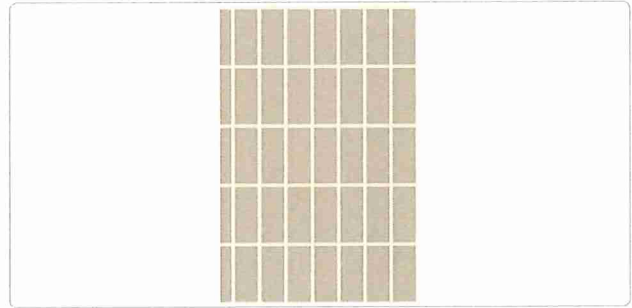
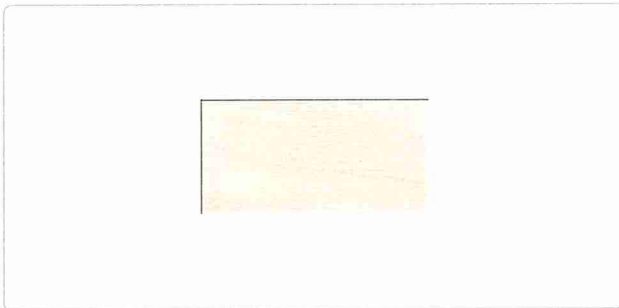

Tile Color: Linden Point 12x24 - LP19 Bianco  
Id: 6LP124/LP19

Pattern: Straight Lay Rectangle Front to Back

## Walls

### TILE

- Bath 2 Tub Splash
- Bath 3 Tub Splash
- Owners Bath Tub Deck

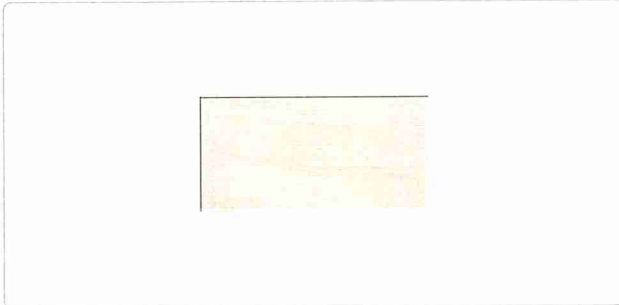

Tile Color: Linden Point 12x24 - LP19 Bianco  
Id: 6LP124/LP19

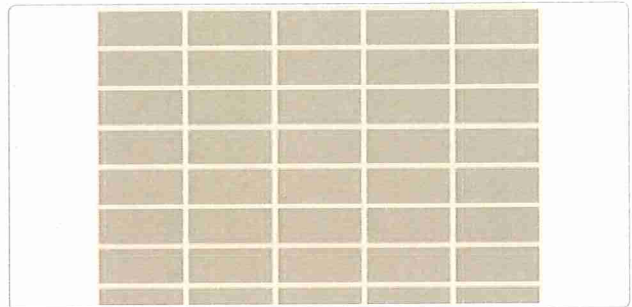

Pattern: Straight Lay Rectangle Horizontal

■ Opt Owners Bath Shower Stall 2 w/Seat

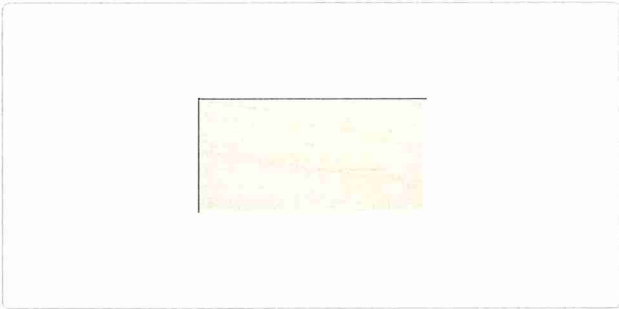

Tile Color: Linden Point 12x24 - LP19 Bianco  
Id: 6LP124/LP19

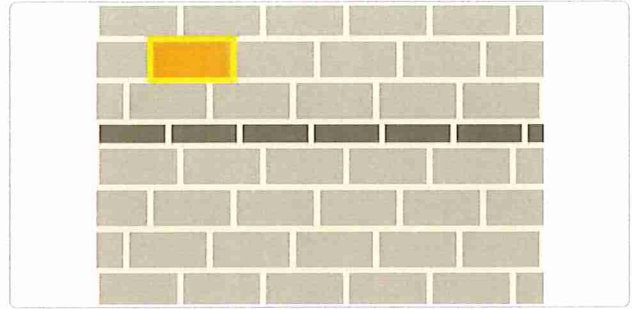

Pattern: S106

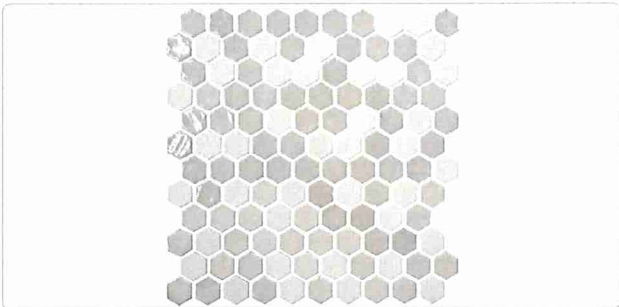

Accent LinFt: Uptown Glass Hexagon Mosaic (12x12 Mesh) 1x1 -  
UP17 Alabaster  
Id: 6UPG/UP17

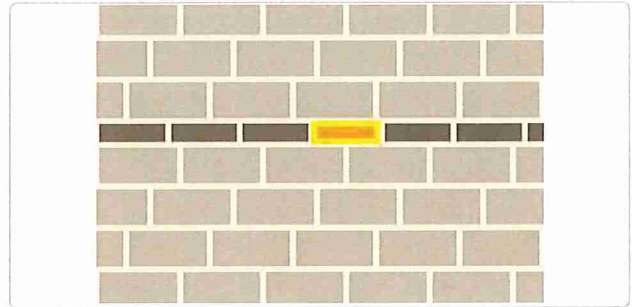

Pattern: S106

↳  Accent Size: 4" Height

• Owners Bath Garden Tub Splash

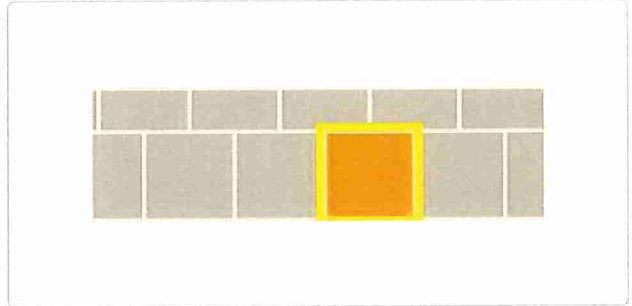
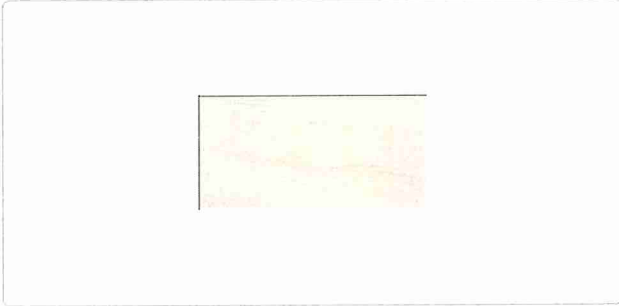

Tile Color: Linden Point 12x24 - LP19 Bianco  
Id: 6LP124/LP19

Pattern: MTS 94

• Owners Bath Tub Skirt



Tile Color: Linden Point 12x24 - LP19 Bianco  
Id: 6LP124/LP19



Pattern: S 67 Rectangular Staggered (Horizontal)



# Buyer Selections Summary

Taylor Morrison - Houston - 10/17/2018 12:12:54 PM

|                                  |             |                  |                       |             |
|----------------------------------|-------------|------------------|-----------------------|-------------|
| BUYER:                           | DESIGNER:   | SALES COUNSELOR: | CATALOG DATE:         | JOB NUMBER: |
| 28050 Drifters Bend<br>spec home | Laura Tyler | Other/Unknown    | 10/15/2018 5:02:27 PM | Q#11427     |

|                        |              |            |              |        |       |
|------------------------|--------------|------------|--------------|--------|-------|
| ADDRESS:               | LOT / BLOCK: | COMMUNITY: | SERIES:      | PLAN:  | ELEV: |
| 28050 Drifters<br>Bend |              | Harmony 65 | Series 7 (3) | Garnet | NA    |

## SELECTIONS SUMMARY

**TOTAL: \$29,973.18**

|                       |             |
|-----------------------|-------------|
| Countertops           | \$9,125.00  |
| Flooring              | \$15,733.27 |
| Stairs - 1. Options   | \$292.00    |
| Stairs - 2. Balusters | \$390.00    |
| Walls                 | \$2,666.23  |
| Window Coverings      | \$1,766.68  |



Printed Name: \_\_\_\_\_ Signature: \_\_\_\_\_ Date: \_\_\_\_\_

Printed Name: \_\_\_\_\_ Signature: \_\_\_\_\_ Date: \_\_\_\_\_

Q# 11427  
Matrix 3

Harmony 65  
28050 Drifters  
Bend

# Flooring Redline Report

TAYLOR MORRISON HOU

Plan: Garnet

Revision: 03/26/18 (08/31/17)

ELEV D -

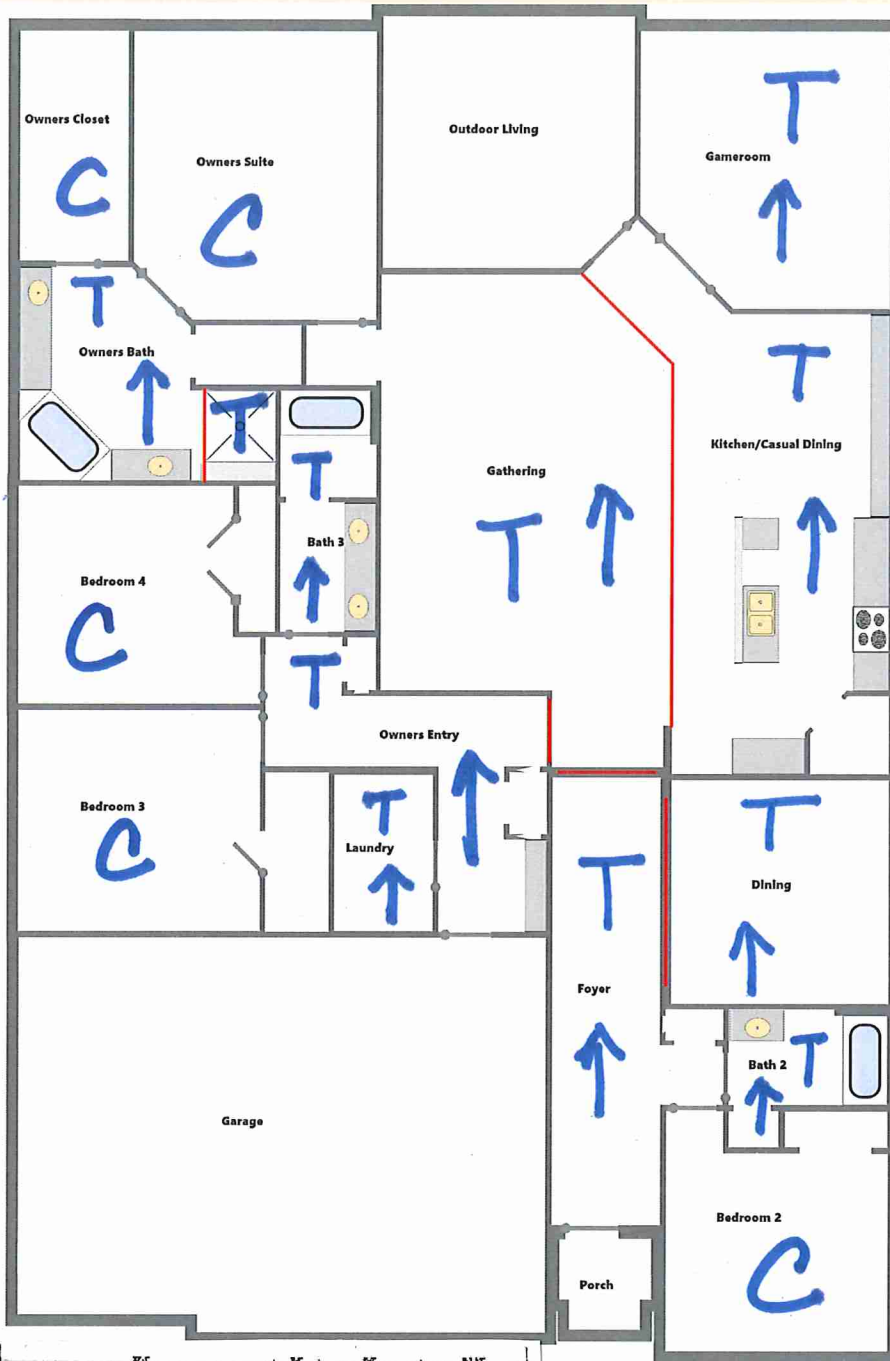

Opt Shower 2  
MUD SET

Gourmet Kd 2

T = TILE  
C = Carpet

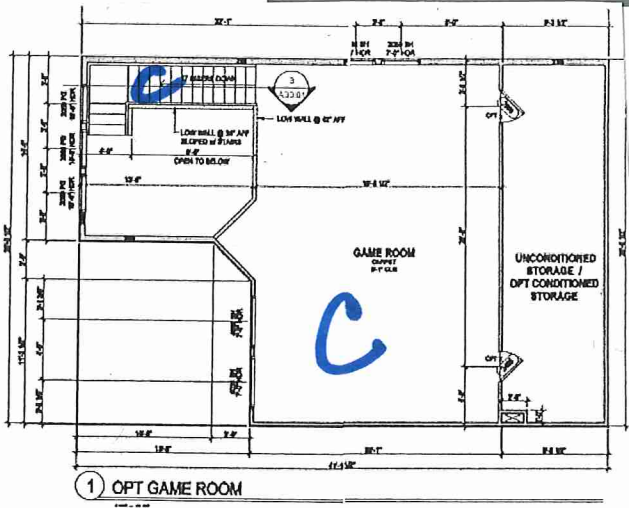

↑ 8' Front Door

← game room std

Date: \_\_\_\_\_

# WBS FAUCET HOLE DRILL SHEET

FAX: \_\_\_\_\_  
PHONE: \_\_\_\_\_  
ADDRESS: 28050 Drifters Bend  
BUILDER: Taylor Morrison



Builder Signature: \_\_\_\_\_

Put an "X" in each hole you DO NOT want.

Mirado HA100 Handmade

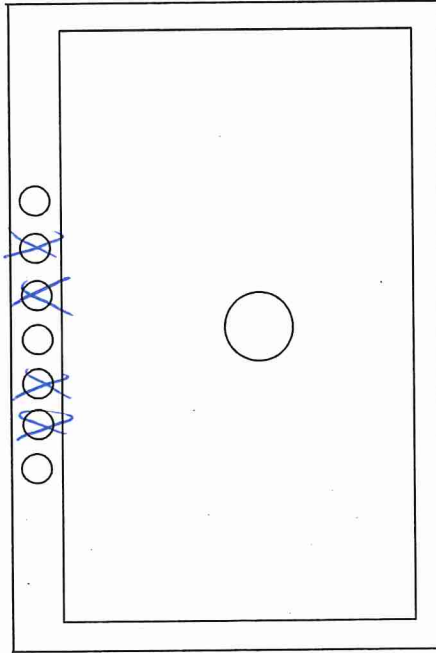

All Faucet Holes are drilled to 4" centers, unless otherwise specified.



FAX: \_\_\_\_\_  
PHONE: \_\_\_\_\_  
ADDRESS: 28050 Drifters Bend  
BUILDER: Taylor Morrison

Builder Signature: \_\_\_\_\_  
Put an "X" in each hole you DO NOT want.

Mirado 1519

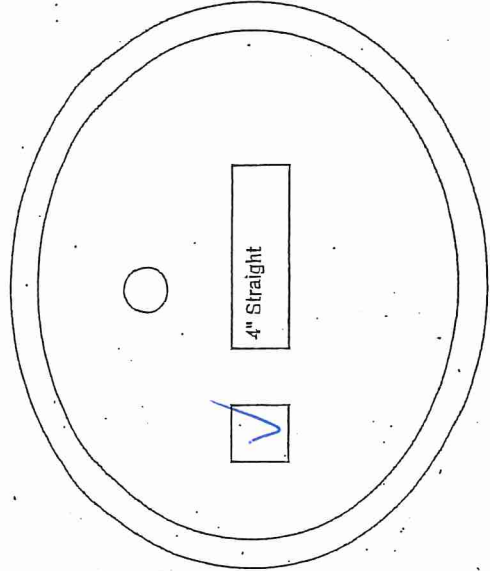
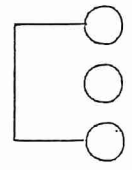

*Master Bath*

All Faucet Holes are drilled to 4" centers, unless otherwise specified.



**GE APPLIANCES**  
a Haier company

**GEAP-0402-0204**



**Model#: PGP7030SLSS**

GE Profile™ Series 30" Built-In Gas Cooktop

Approx Dimensions (HxDxW):  
5 1/2 in X 21 in X 30 in

- Fit Guarantee - Replacing a similar cooktop from GE or another brand? GE cooktops are guaranteed for an exact fit to make replacement easy.
- 30" cooktop with 5 burners - Enjoy ultimate cooktop flexibility and more cooking space with 5 sealed burners
- Heavy-cast, edge-to-edge grates - Durable cast iron offers lasting performance and allows easy movement of pans between burners



**Model#: JT5000SFSS**

GE® 30" Built-In Single Convection Wall Oven

Approx Dimensions (HxDxW):  
28 5/8 in X 26 3/4 in X 29 3/4 in

- Fit Guarantee - Replacing a similar wall oven from GE or another brand? GE wall ovens are guaranteed for an exact fit to make replacement easy.
- True European Convection - Achieve delicious results from a third heating element and fan combination
- Self-clean with Steam Clean option - Clean your oven the way you want
- Self-clean, heavy-duty oven racks - Conveniently clean your oven and racks together



**Model#: GDT635HSJSS**

GE® Hybrid Stainless Steel Interior Dishwasher with Hidden Controls

Approx Dimensions (HxDxW):  
34 in X 24 in X 23 3/4 in

- Bottle Jets - Clean hard-to-reach areas inside tall items with up to 4 dedicated jets integrated into the upper rack that shower water deep inside for the ultimate clean
- Piranha™ hard food disposer with removable filter - To ensure consistently clean items, this stainless steel blade rotates at 3,600 RPM to pulverize food particles and helps to prevent large particles from clogging the wash arms
- Wash zones - Wash a true half-load in either the upper or lower rack without sacrificing cycles and options available on a full wash



**Model#: PEB7227SLSS**

GE Profile™ Series 2.2 Cu. Ft. Built-In Sensor Microwave Oven

Approx Dimensions (HxDxW):  
14 in X 19 3/4 in X 24 1/8 in

- 2.2 cu. ft. capacity - 1100 watts (IEC-705 test procedure)
- Sensor cooking controls - Automatically adjusts time and power for delicious cooking results
- Weight and time defrost - Defrosting times and power levels are programmed by weight or manually for optimal results
- Extra-large 16" turntable - Rotates food throughout the cycle and accommodates large cookware



**Model#: JX7230SLSS**

GE® Optional 30" Built-In Trim Kit JX7230SLSS



**GE APPLIANCES**  
a Haier company

---

## GEAP-0402-0204



**Model#: PVX7300SJSS**

**GE Profile™ Series 30" Under The Cabinet Hood**

Approx Dimensions (HxDxW):  
5 1/2 in X 20 in X 29 7/8 in

- Easy installation - 10 minutes or less by one person
- Four-speed with boost, 390-CFM venting system - Removes smoke, grease, odors and moisture
- Glass touch controls - Set functions quickly and clean with little effort
- Dual LED lighting with nightlight - Choose bright light while cooking or low light at night - bulbs included



# PGP7030DL/SL

## GE Profile™ Series 30" Built-In Gas Cooktop

### DIMENSIONS AND INSTALLATION INFORMATION

**AGA REQUIREMENT:** All gas cooktop models require 7/16" free area below cooktop height to combustible material. Requires 18" minimum from countertop to adjacent overhead cabinets.

**NOTE:** If installing with a GE Profile™ Telescopic Downdraft System, consult both cooktop and downdraft installation instructions packed with product before installing. Cooktop gas/electric supply may need to be re-routed to install downdraft.

**ELECTRICAL RATING:** 120V, 60Hz, 5A

#### INSTALLATION WITH SINGLE WALL OVEN INFORMATION:

30" Gas Cooktops are approved for use over select GE 27" and 30" Wall Ovens and Warming Drawers. 30" and 36" Gas cooktops are approved for use over select 30" Wall Ovens and Warming Drawers. Refer to cooktop and wall oven/warming drawer installation instructions packed with product for current dimensional data.

**INSTALLATION INFORMATION:** Before installing, consult installation instructions, packed with product, for current dimensional data.

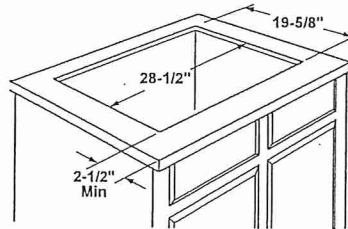
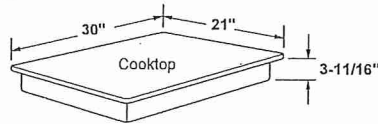

Gas Connection

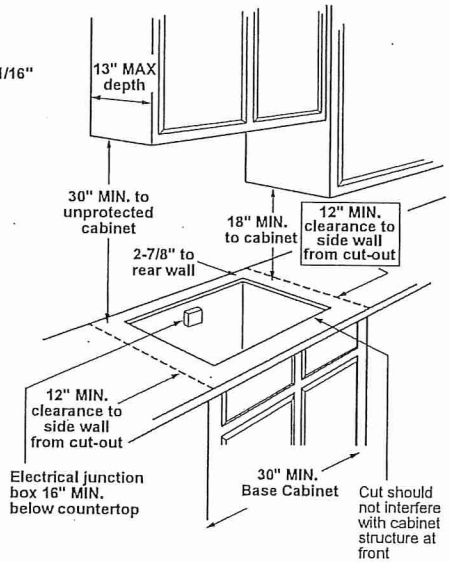
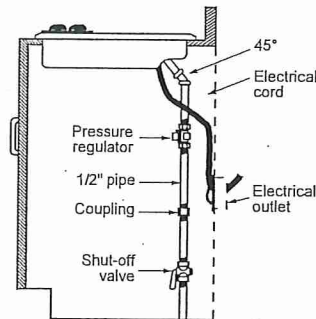

Dimension and installation information are shown in inches.  
\*Allow 5-3/4" depth at rear for electrical and gas connections



For answers to your Monogram, GE Café™ Series, GE Profile™ Series or GE Appliances product questions, visit our website at [geappliances.com](http://geappliances.com) or call GE Answer Center® Service, 800.626.2000.



Specification Revised 6/17

OPT BASE CABS  
ILLUSTRATED SEPARATELY

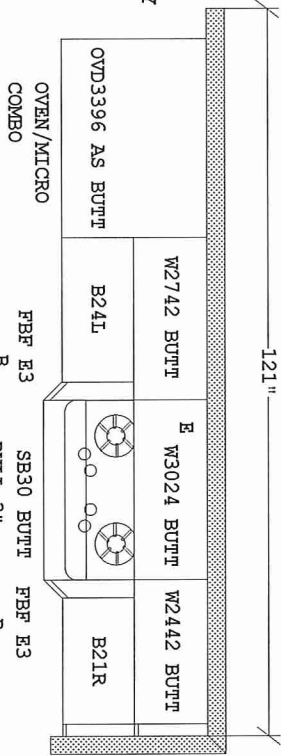

SELECT FEATURES:  
A-BUMP OUT  
B-ANGLED FLUTED FILLERS  
C-SB BENEATH COOKTOP  
D-REFRIG CAB 18" HIGH  
E-TALL CROWN (TCCM8)

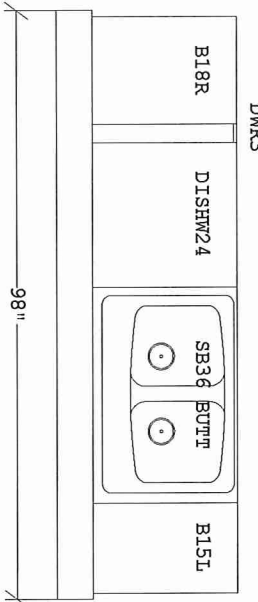

PANTRY

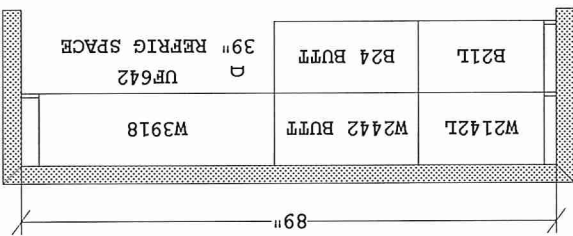

TAYLOR MORRISON  
HOUSTON  
SERIES 7 - PLAN GARNET  
G49107004 (8-31-17)  
42" KITCHEN - GOURMET #2  
SELECT FEATURES  
W/ 30" CKTOP W/ ISLAND  
AS / REV  
G - R

DOORSTYLE: \_\_\_\_\_

PARTS:

- 3-UF3
- 2-UF342
- 1-UF642 (HORIZ)
- 2-FBF E3
- 4-TCCM8 WD
- 4-HWC 1X2X96
- 6-UM8 BLD
- 3-BTK8 PRT
- 3-SHM8 BLD
- 1-UF6 (OVEN)
- 2-FL36 (OVEN)
- 1-FL24 (VOIDS)
- 1-COVER CAP TAN
- 1-DDF FASTENER (SB30)
- 28-KNOBS (FOL)

ISLAND

DOOR STYLE: \_\_\_\_\_

- PARTS:
- 1-DWR3
- 1-UM8 BLD
- 2-BTK8 PRT
- 2-SHM8 BLD
- 1-DDF FASTENER (SB36)
- 6-KNOBS (FOL)

This is an original design and must not be released or copied unless job order placed.

FSR: \_\_\_\_\_ DATE: \_\_\_\_\_

Page \_\_\_\_\_ of \_\_\_\_\_

TIMBERLAKE  
CABINETS

All dimensions, size designations given are subject to verification on job site and adjustment to fit job conditions.

Designer: PS

CABS # \_\_\_\_\_

Designed: 5/21/2018  
Printed: 5/21/2018

REV2



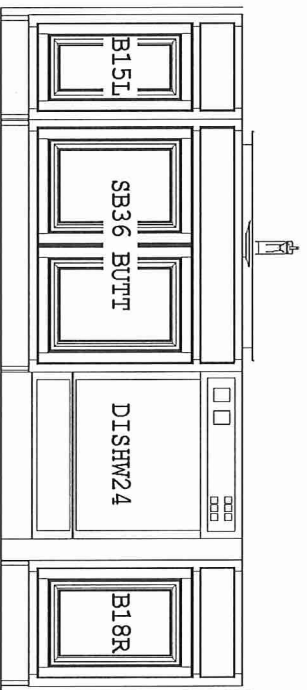
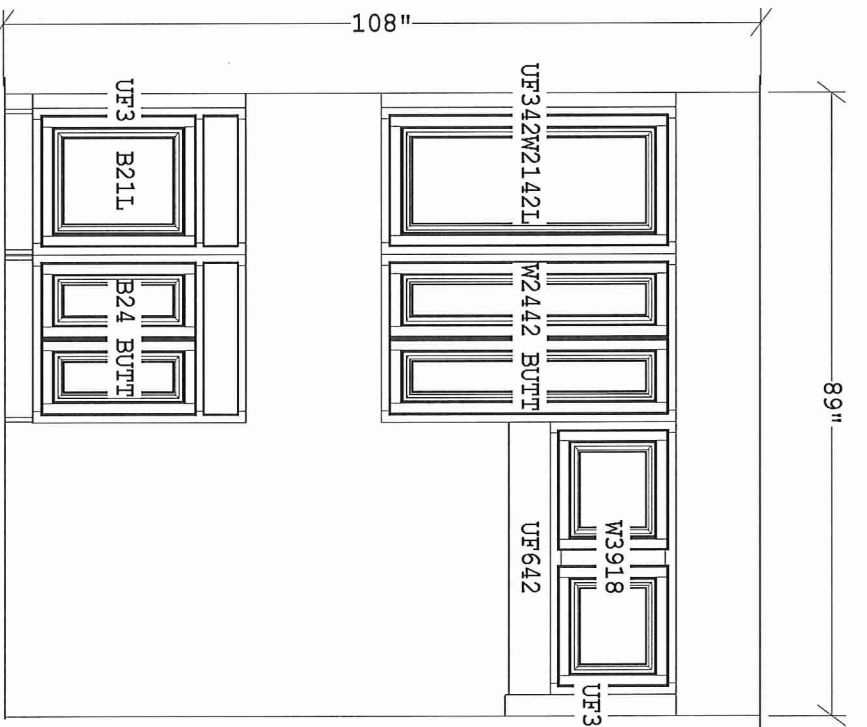
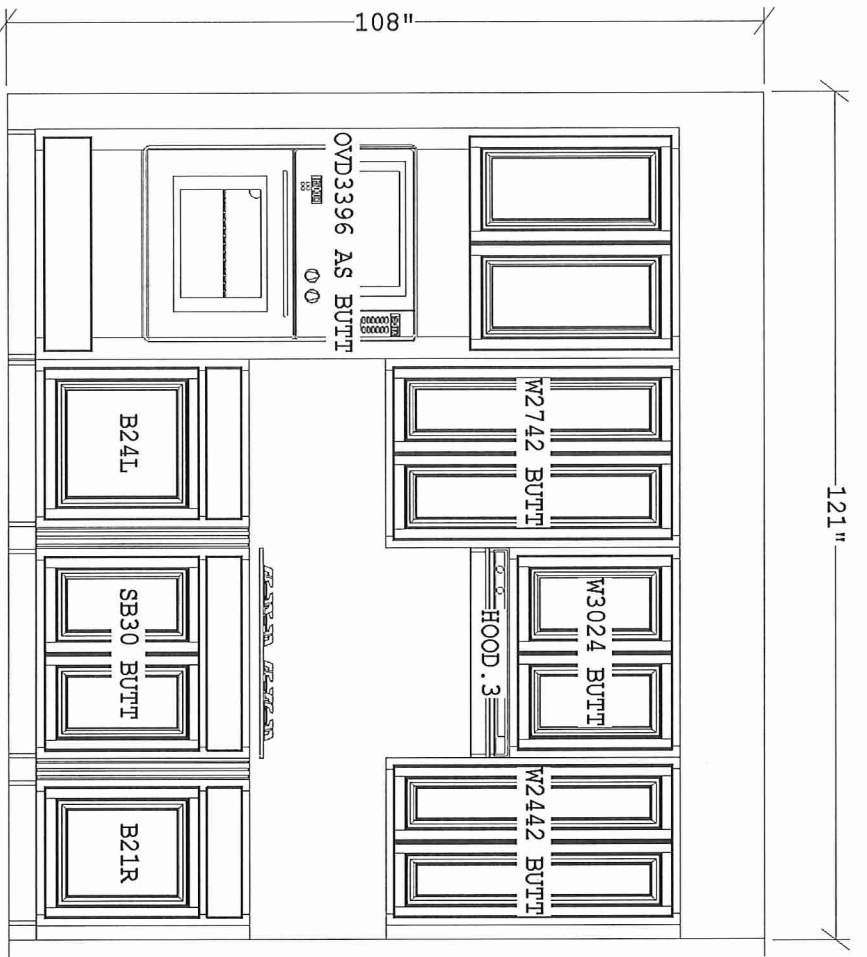

This is an original design and must not be released or copied unless job order placed.

FSR: \_\_\_\_\_ DATE: \_\_\_\_\_

Page \_\_\_\_\_ of \_\_\_\_\_

**TIMBERLAKE**  
CABINETS

All dimensions, size designations given are subject to verification on job site and adjustment to fit job conditions.

Designer: PS

CABS # \_\_\_\_\_

Designed: 5/21/2018  
Printed: 5/21/2018

**REV2**

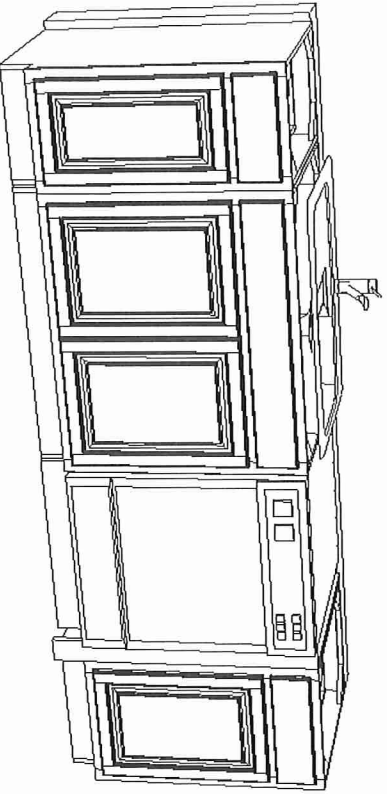
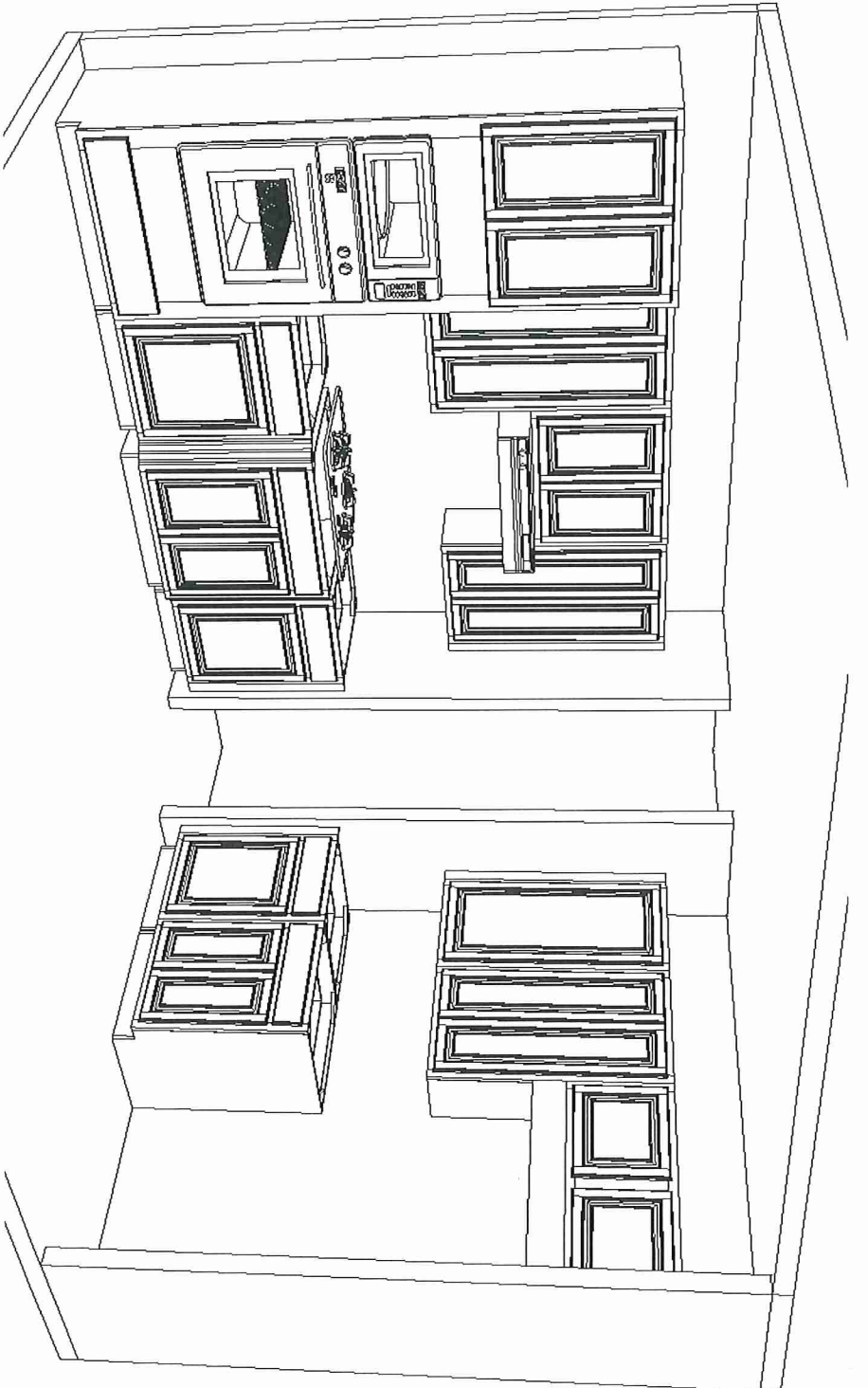

Note: This drawing is an artistic interpretation of the general appearance of the design. It is not meant to be an exact rendition.

Designer: PS Page \_\_\_\_ of \_\_\_\_

**TIMBERLAKE**  
CABINETRY

Designed: 5/21/2018  
Printed: 5/21/2018

**REV2**

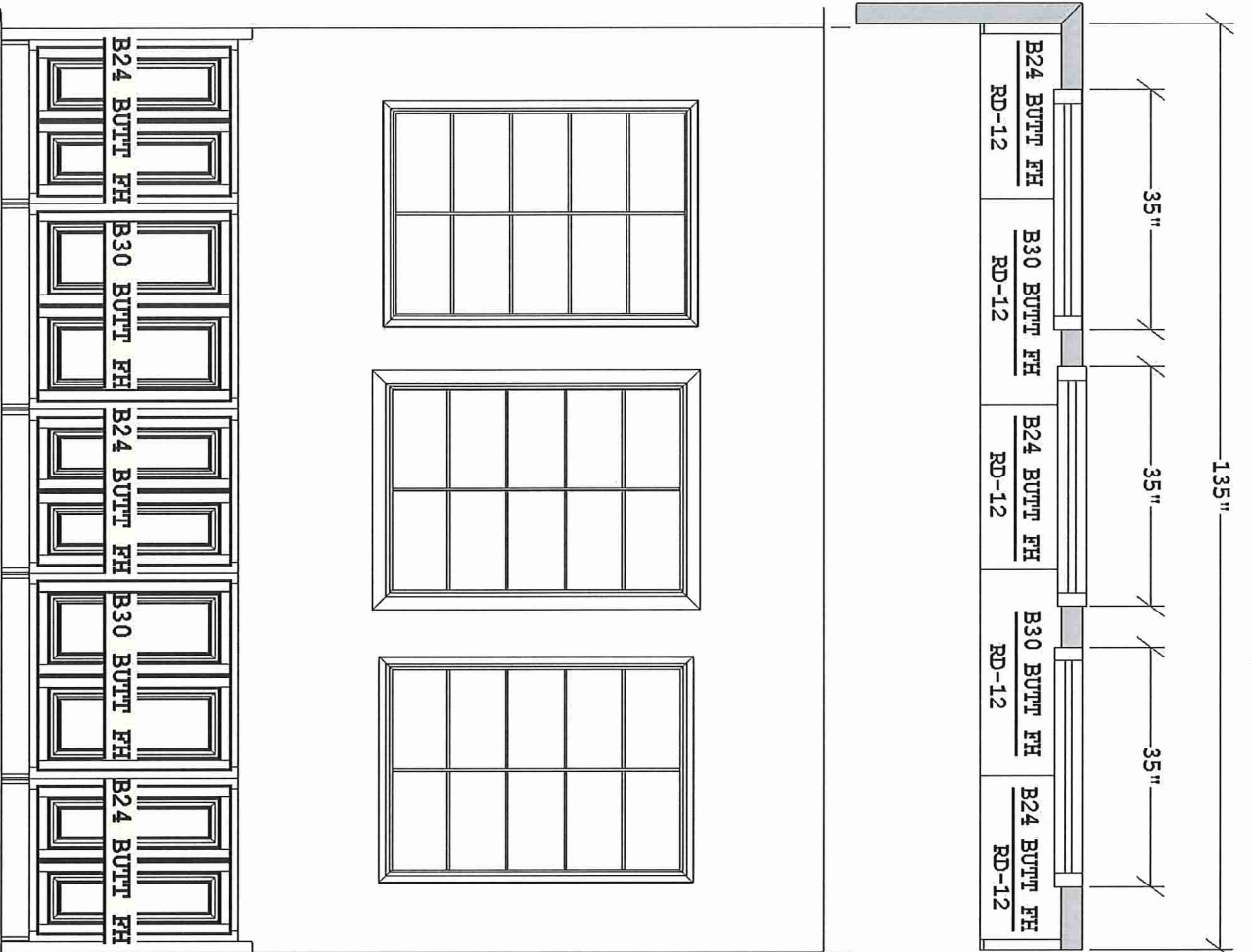

SET TO BASE  
CAB AT KITCHEN

COUNTERTOP  
BY OTHERS

TAYLOR MORRISON  
HOUSTON  
SERIES 7 - PLAN GARNET  
G49107004 (8-31-17)  
BUILT-IN AT CASUAL DINING  
AS / REV  
G - R  
DOORSTYLE \_\_\_\_\_  
2-UF3  
1-UM8 BLD  
2-BTK8 PRT  
2-SHM8 BLD  
10-KNOBS (FOL)

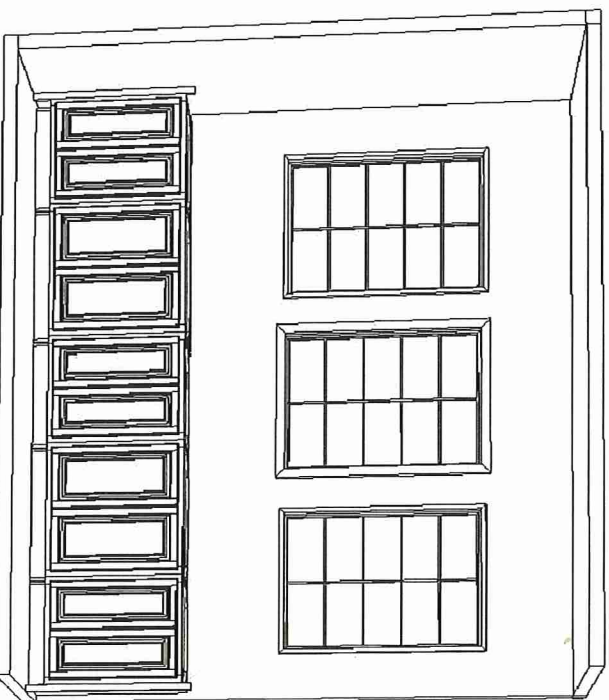

All dimensions size designations given are subject to verification on job site and adjustment to fit job conditions.

This is an original design and must not be released or copied unless applicable fee has been paid or job order placed.

Designed: 3/27/20  
Printed: 3/29/2018

**REV2**

TAYLOR MORRISON  
 HOUSTON  
 SERIES 7 - PLAN GARNET  
 G49107004 (8-31-17)  
 OWNER'S BATH  
 AS / REV  
 G - R

YES

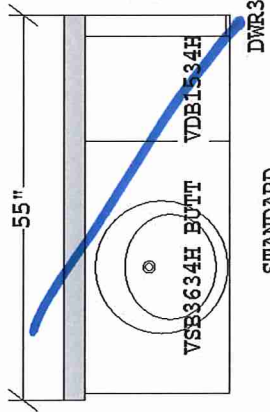

SET TO TUB  
 DWR3

STANDARD

\*\* IF GLAZE FINISH ADD)  
 (EXCEPT PAINTED MAPLE)  
 2-BEP42 WD

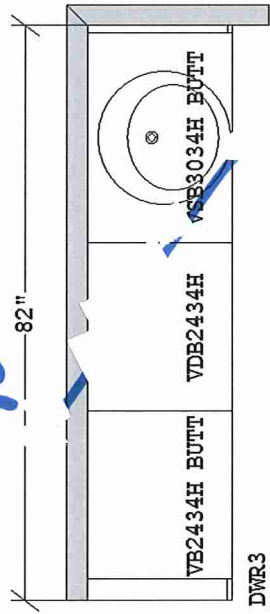

SET TO TUB  
 DWR3

STANDARD

OWNER'S BATH  
 DOORSTYLE: \_\_\_\_\_  
 PARTS:  
 2-DWR3  
 1-UF3  
 2-UM8 BLD  
 2-BTK8 PRT  
 3-SHM8 BLD  
 13-KNOBS (FOL)

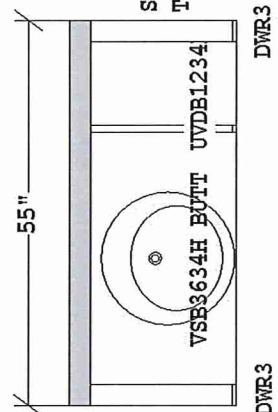

SET TO TUB  
 DWR3

OPT SHOWER 2 @  
 OWNER'S BATH

OPT SHOWER 2  
 @ OWNER'S BATH  
 DELETE:  
 1-VDB1534H  
 ADD  
 1-VDB1234H  
 1-UF3  
 1-DWR3

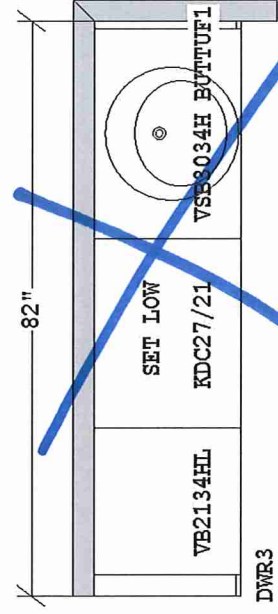

SET TO TUB  
 DWR3

KNEE SPACE OPTION

OPT KNEE SPACE  
 AT OWNER'S BATH  
 DELETE:  
 1-VSB2434H BUTT  
 1-VDB2434H  
 2-KNOBS (FOL)  
 ADD  
 1-VB2134HL  
 1-KDC27/21

All dimensions size designations given are subject to verification on job site and adjustment to fit job conditions.

This is an original design and must not be released or copied unless applicable fee has been paid or job order placed.

Designed: 2/23/20  
 Printed: 3/29/2018

REV2

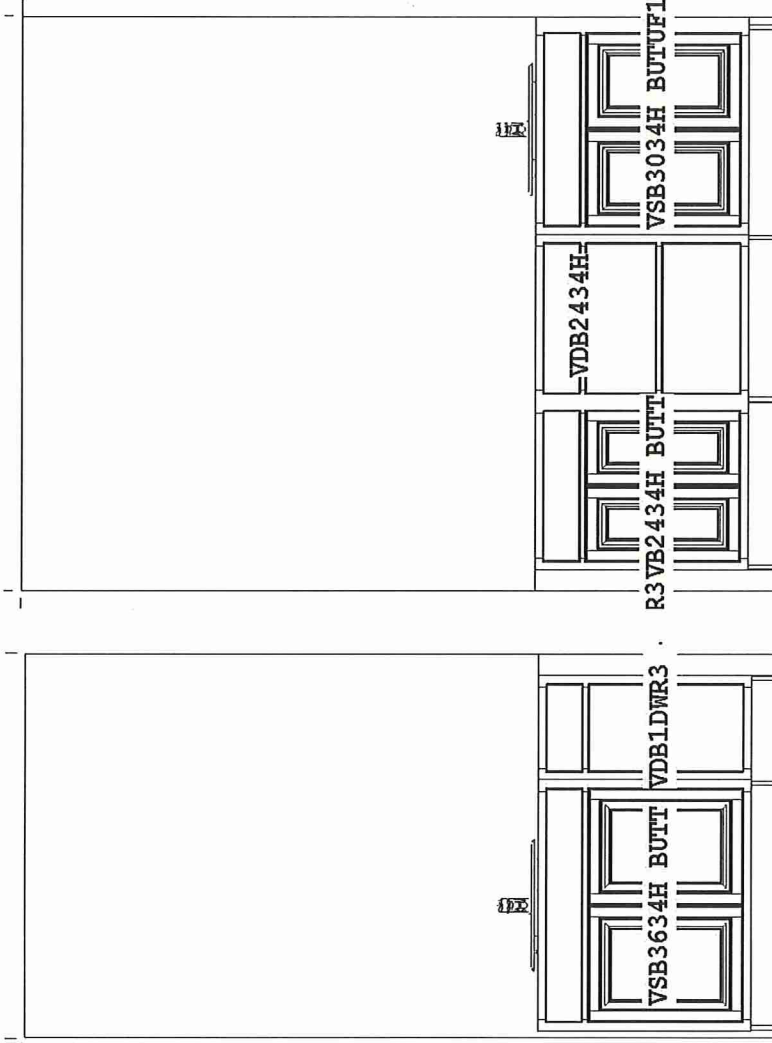

All dimensions size designations given are subject to verification on job site and adjustment to fit job conditions.

This is an original design and must not be released or copied unless applicable fee has been paid or job order placed.

Designed: 2/23/2018  
 Printed: 3/29/2018

**REV2**



TAYLOR MORRISON  
 HOUSTON  
 SERIES 7 - PLAN GARNET  
 G49107004 (8-31-17)  
 SECONDARY BATHS  
 AS / REV  
 G - R

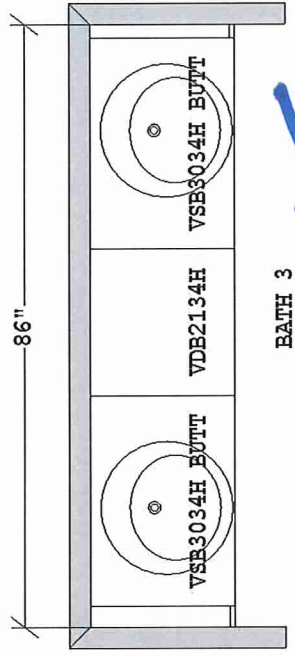

BATH 2  
 DOORSTYLE: \_\_\_\_\_  
 PARTS:  
 1-UM8 BLD  
 1-BTK8 PRT  
 1-SHM8 BLD  
 2-KNOBS (FOL)  
 1-UF3 (FOL)

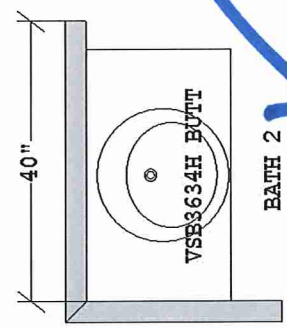

BATH 3  
 DOORSTYLE: \_\_\_\_\_  
 PARTS:  
 2-UF3  
 1-UM8 BLD  
 1-BTK8 PRT  
 1-SHM8 BLD  
 7-KNOBS (FOL)

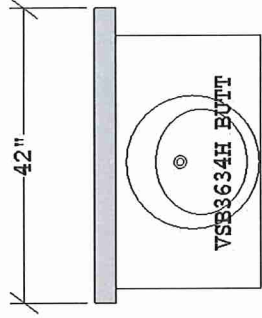

OPT BATH 4  
 DOORSTYLE: \_\_\_\_\_  
 PARTS:  
 1-UM8 BLD  
 1-BTK8 PRT  
 1-SHM8 BLD  
 5-KNOBS (FOL)  
 1-UF3 (FOL)

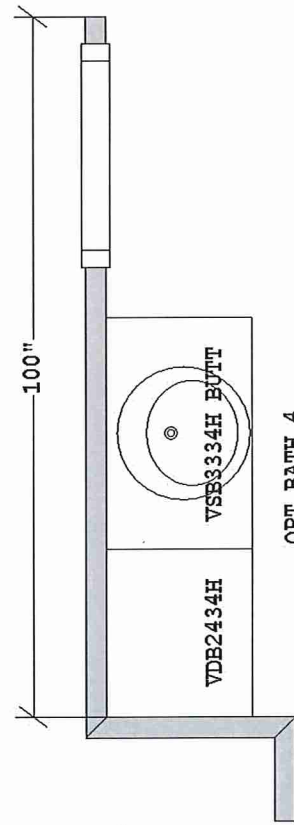

OPT BATH 5 / BATH 4  
 DOORSTYLE: -----  
 PARTS:  
 1-UM8 BLD  
 1-BTK8 PRT  
 1-SHM8 BLD  
 2-KNOBS (FOL)  
 1-UF3 (FOL)

OPT GAME / BED 5 / BATH 4

All dimensions size designations given are subject to verification on job site and adjustment to fit job conditions.

This is an original design and must not be released or copied unless applicable fee has been paid or job order placed.

Designed: 2/24/20  
 Printed: 3/29/2018

REV2

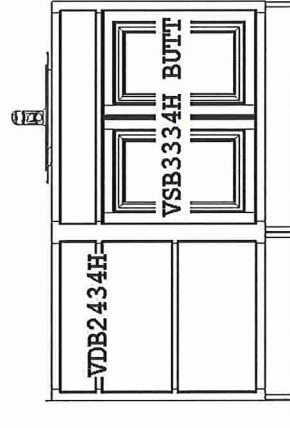
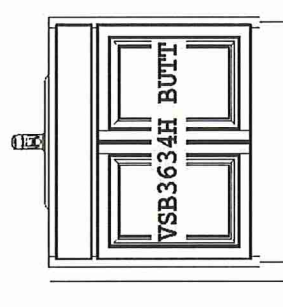
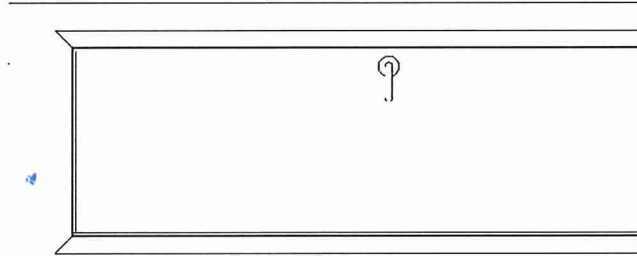
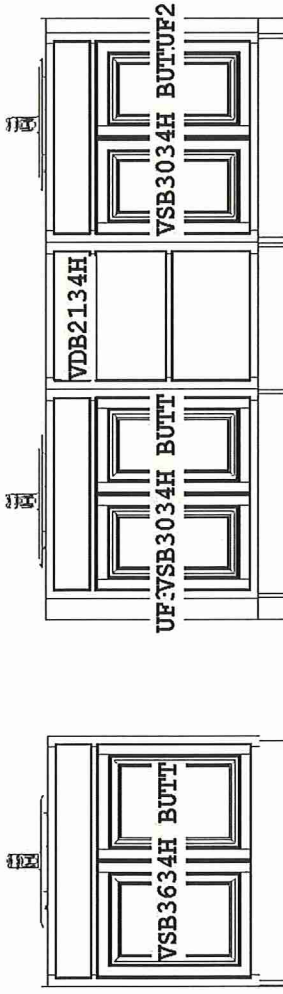

All dimensions size designations given are subject to verification on job site and adjustment to fit job conditions.

This is an original design and must not be released or copied unless applicable fee has been paid or job order placed.

Designed: 2/24/20  
Printed: 3/29/2018

**REV2**

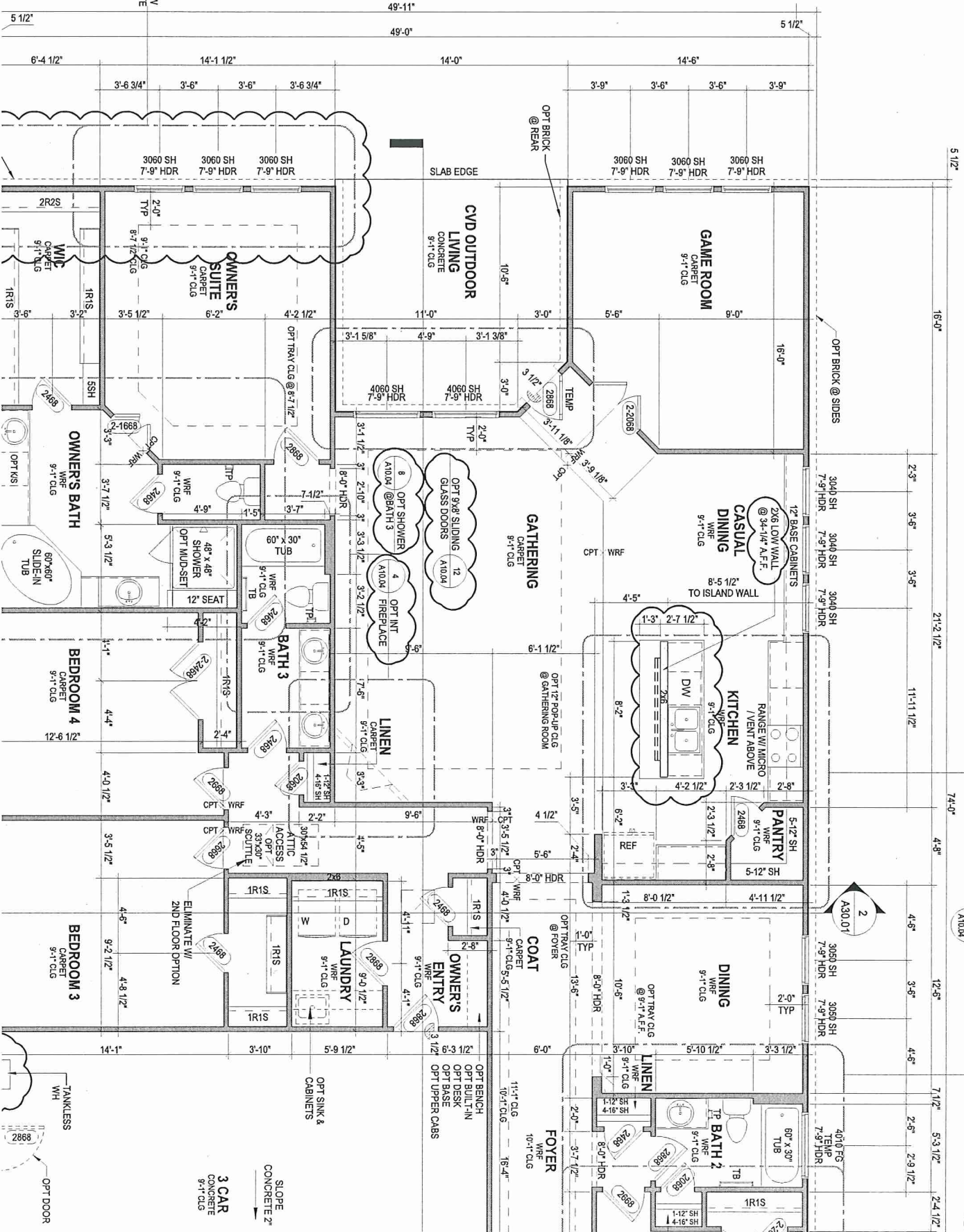

3 OPT BAY WINDOW  
@ OWNERS SUITE  
A1004

- 7 OPT GOURMET KITCHEN 3  
A1004
- 6 OPT GOURMET KITCHEN 2  
A1004
- 5 OPT GOURMET KITCHEN 1  
A1004

- 11 OPT SHOWER @ BATH 2  
A1004

3 CAR  
SLOPE  
CONCRETE  
9-1\"/>

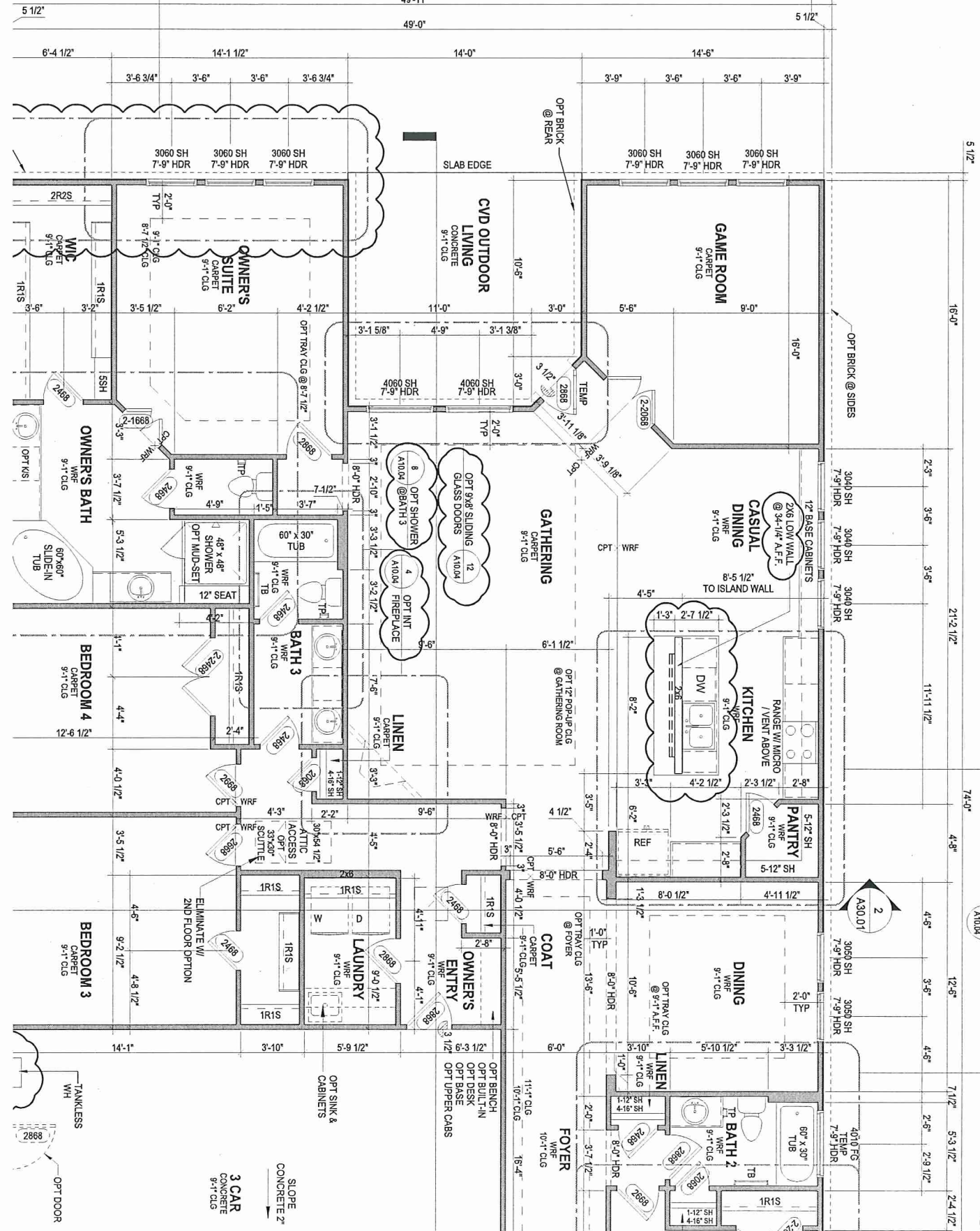

3 OPT BAY WINDOW  
@ OWNERS SUITE  
A1004

- 7 OPT GOURMET KITCHEN 3  
A1004
- 6 OPT GOURMET KITCHEN 2  
A1004
- 5 OPT GOURMET KITCHEN 1  
A1004

- 11 OPT SHOWER @ BATH 2  
A1004

3 CAR  
SLOPE  
CONCRETE  
9-1\"/>



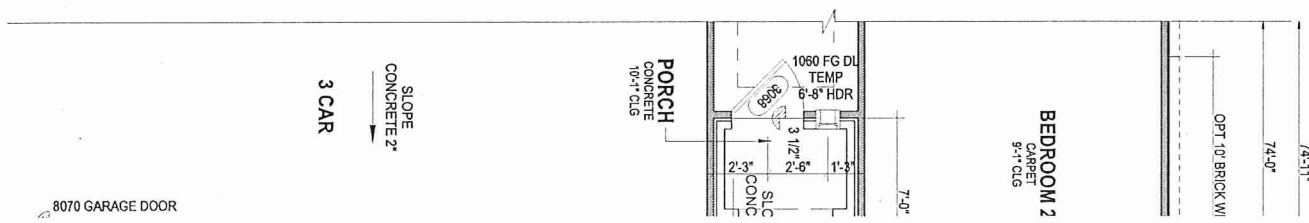
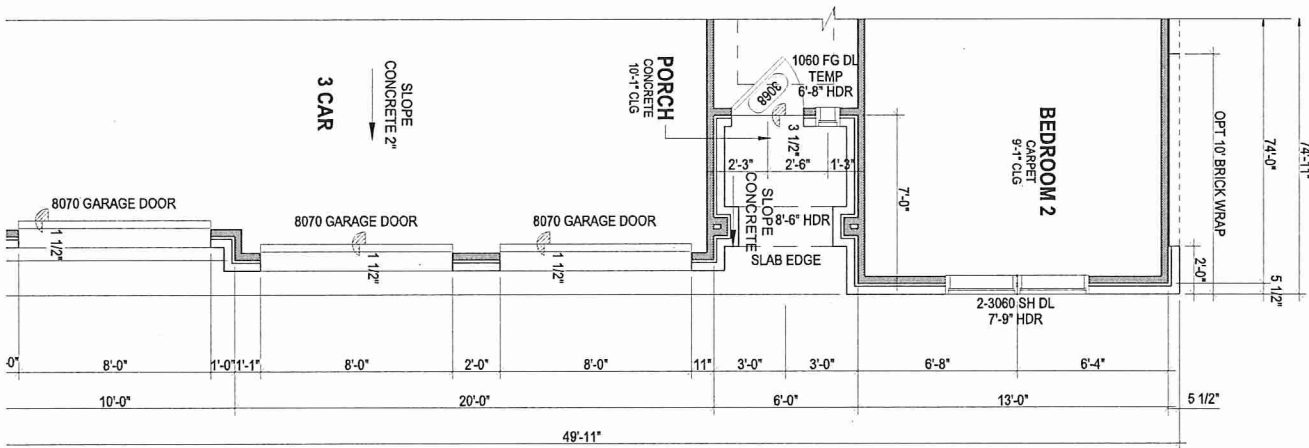

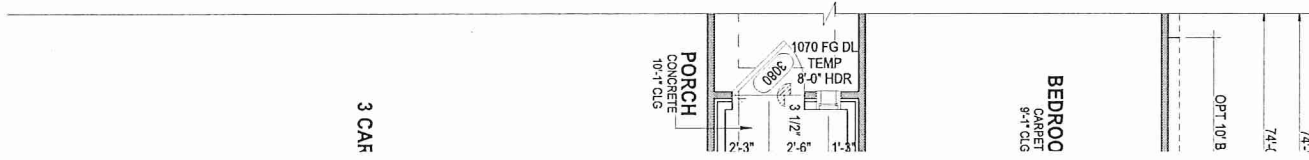
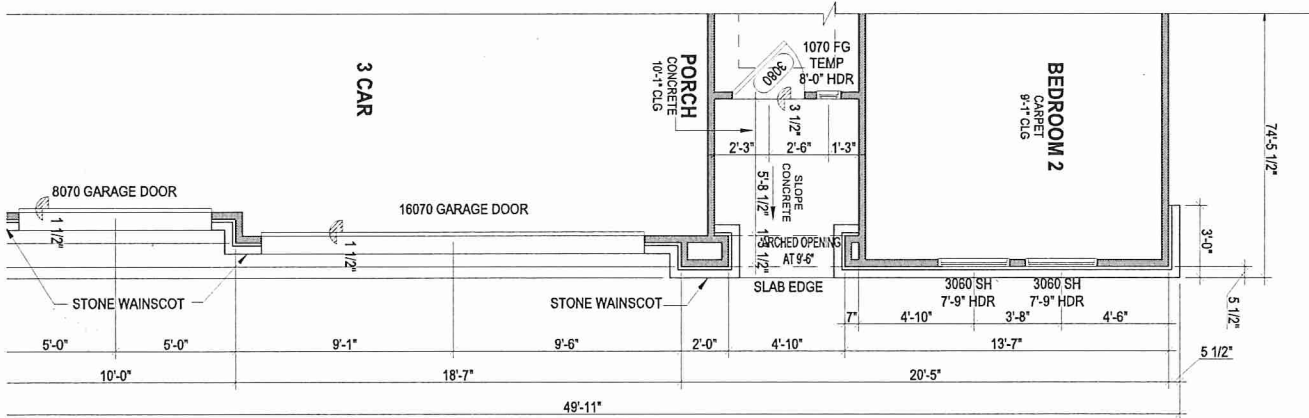
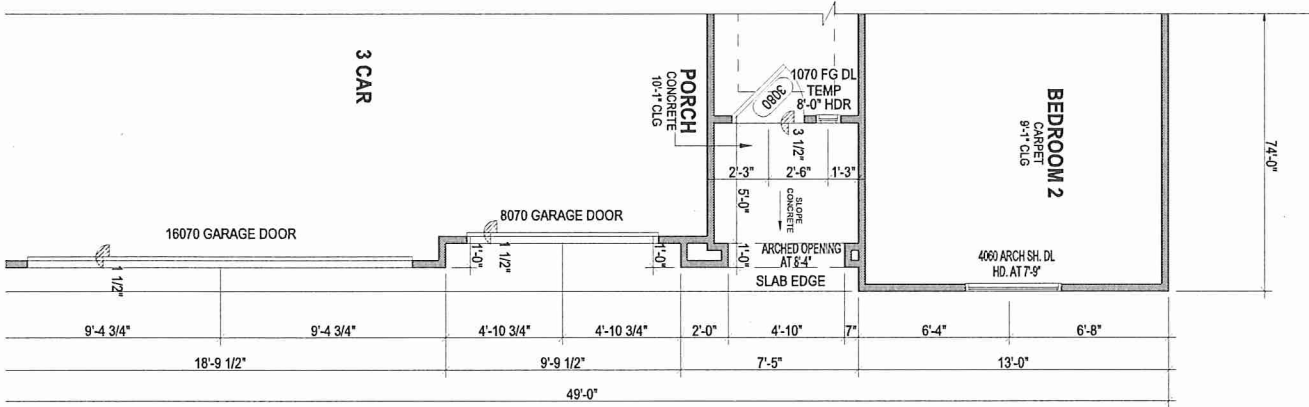



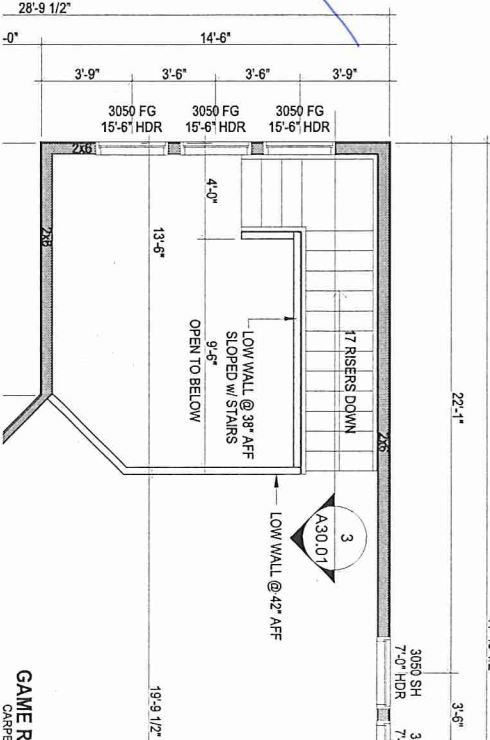
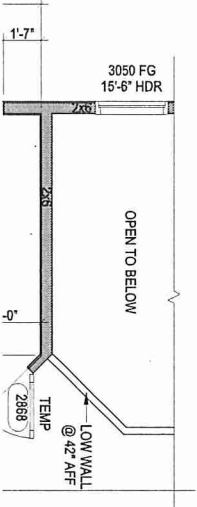

**5 OPT SHOWER @ BATH 4**  
1/8" = 1'-0"

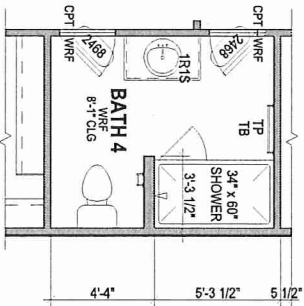

**4 OPT GAME ROOM / BED 5 / BATH 4**  
1/8" = 1'-0"

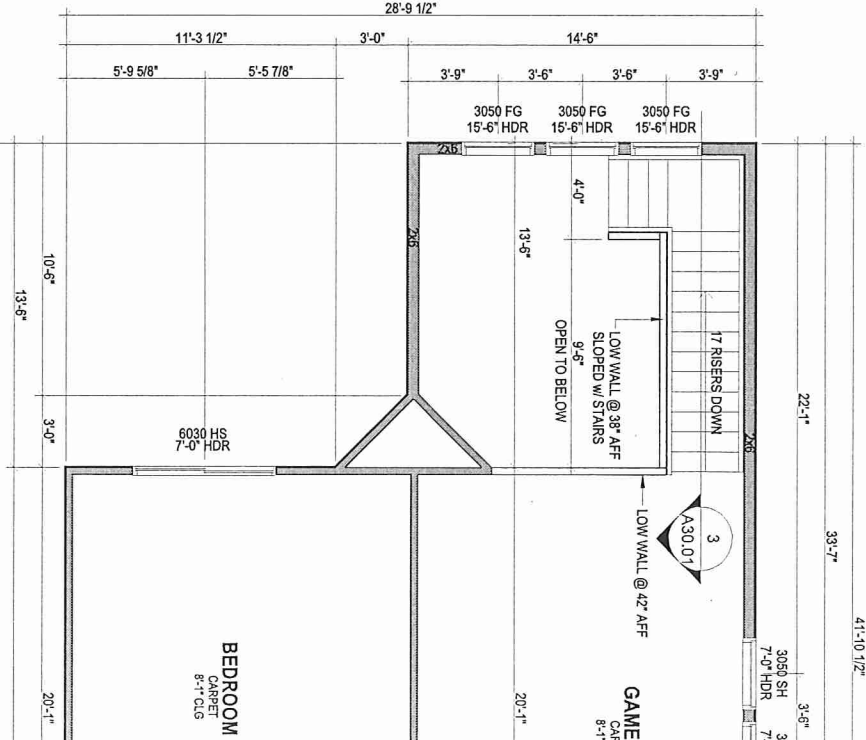

**6 OPT MAIN FLOOR STAIR**  
1/8" = 1'-0"

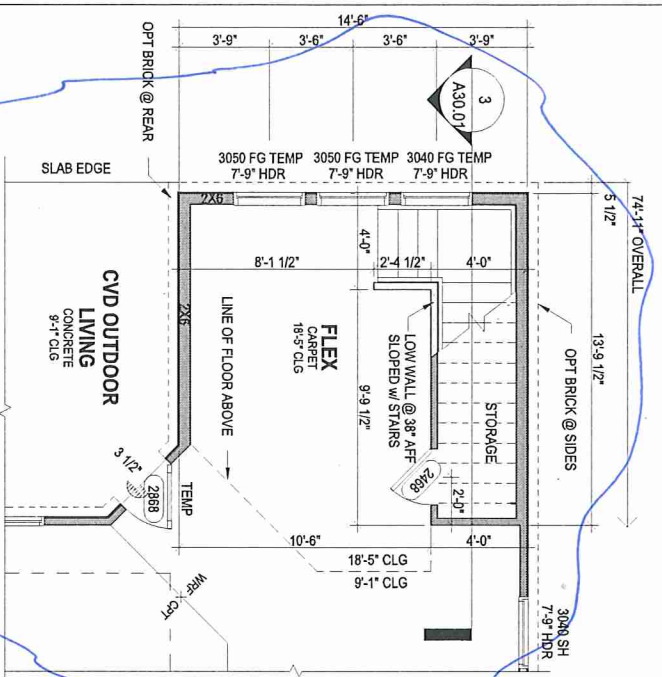

Plumbing and Hardware  
Choose option 1 or 2



- Option 1
- Brantford Chrome 4" Faucet
- With Brantford Chrome shower and tub fixtures (standard)
- Bath hardware chrome
- With chrome shower enclosure (standard)



- Option 2
- Brantford Brushed Nickel 4" Faucet
- With Brantford Brushed Nickel Shower and tub fixtures (upgrade)
- Bath hardware nickel
- With nickel shower enclosure (upgrade)

Towel Bar

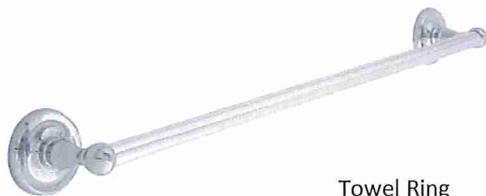

Towel Bar



Towel Ring



Towel Ring



Tissue Paper



Tissue Paper





Cabinet Door Style  
Choose option 1 or 2

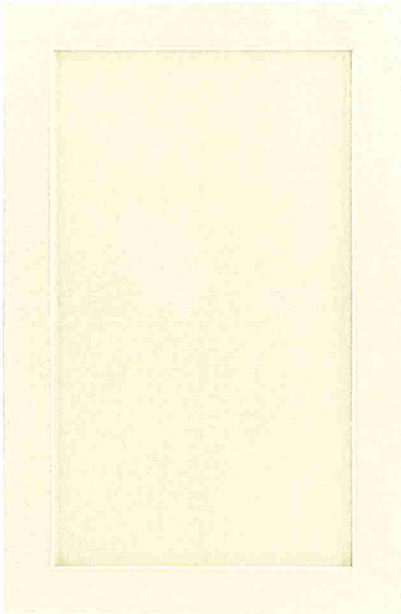

Option 1  
Timberlake Sonoma  
Painted Silk

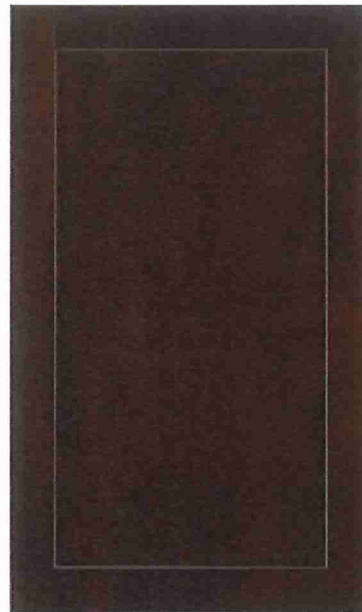

Option 2  
Timberlake Sonoma  
Espresso

Cabinet Accessory  
Only choose if the option should be added

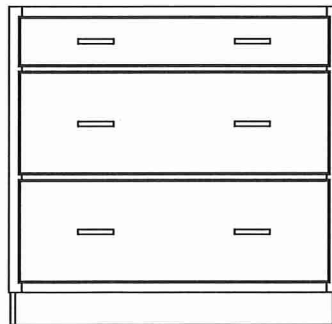

Pot and Pan Drawers – Below Cooktop

Front Entry Door  
Choose options 1-7  
CSM to choose stain, designer to choose glass

Stain  
Option 1  
Jacobean

Stain  
Option 2  
Ebony



Option 1 – Level 2  
Mahogany  
True Divided Lite  
6 Lite 1 Panel NRM



Option 2 - Level 2  
Mahogany  
Craftsman  
With Shelf



Option 3 - Level 2  
Mahogany  
2 Panel Arch – Speakeasy  
With Windsor Mask



Option 4 - Level 2  
Mahogany  
2/3 Lite – Ashton



Option 5 – Level 3  
Mahogany  
¾ Lite Whitney  
Wrought Iron



Option 6 - Level 3  
Mahogany  
Contemporary 5 Light  
With Shelf

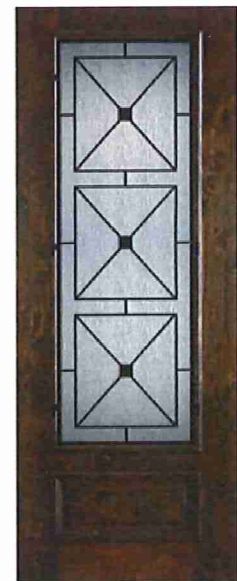

Option 7 - Level 3  
Knotty Alder  
Southampton ¾ Lite  
Wrought Iron



Front Door Handleset  
*Choose Option 1 or 2*



Option 1 – Chelsea  
Satin Nickel  
Standard

Option 2 – Tavaris  
Satin Nickel  
Upgrade

Interior Door Hardware  
*No choice needed*



Interior Hardware:  
Hancock  
Satin Nickel  
Standard

Interior Doors  
*No choice needed*

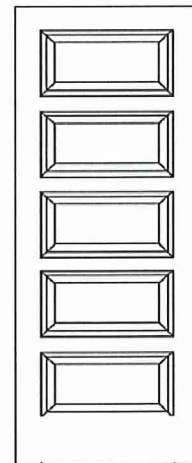

Rockport

Kitchen Appliance Package  
Choose option 1, 2 or 3



Model#: JGP3530SLSS  
GE® 30" Built-In Gas Cooktop



Model#: JT3000SFSS  
GE® 30" Built-In Single Wall Oven



Model#: GDF510PSJSS  
GE® Dishwasher with Front Controls



Model#: PEB7227SLSS  
GE Profile™ Series 2.2 Cu. Ft. Built-In Sensor Microwave Oven

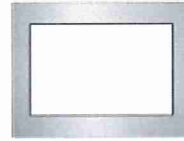

Model#: JX7230SLSS  
GE® Optional 30" Built-In Trim Kit JX7230SLSS



Model#: JVX3300SJSS  
GE® 30" Under The Cabinet Hood



Option 1  
GEAP – 0401 – 0203  
Stainless Steel – 30" 4 Burner Cooktop



Model#: PGP7030SLSS  
GE Profile™ Series 30" Built-In Gas Cooktop



Model#: JT5000SFSS  
GE® 30" Built-In Single Convection Wall Oven



Model#: GDT635HSJSS  
GE® Hybrid Stainless Steel Interior Dishwasher with Hidden Controls



Model#: PEB7227SLSS  
GE Profile™ Series 2.2 Cu. Ft. Built-In Sensor Microwave Oven



Model#: JX7230SLSS  
GE® Optional 30" Built-In Trim Kit JX7230SLSS



Model#: PVX7300SJSS  
GE Profile™ Series 30" Under The Cabinet Hood



Option 2  
GEAP – 0402 – 0204  
Stainless Steel – 30" 5 Burner Cooktop



Model#: PGP7036SLSS  
GE Profile™ Series 36" Built-In Gas Cooktop



Model#: PT7050SFSS  
GE Profile™ Series 30" Built-In Single Convection Wall Oven



Model#: PSB9120SFSS  
GE Profile™ Series 30 in. Single Wall Oven with Advantium® Technology



Model#: PDT825SSJSS  
GE Profile™ Stainless Steel Interior Dishwasher with Hidden Controls



Model#: PVX7360SJSS  
GE Profile™ Series 36" Under The Cabinet Hood



GEAP – 0400 – 0207  
Stainless Steel - 36" 5 Burner Cooktop

Stair Selections  
*No choice needed*

Newel Post: 3-1/4" red oak pyramid top box  
Newel and Handrail Stain: Vetti  
Species: Red Oak  
Caps & Risers: MDF Paint Grade

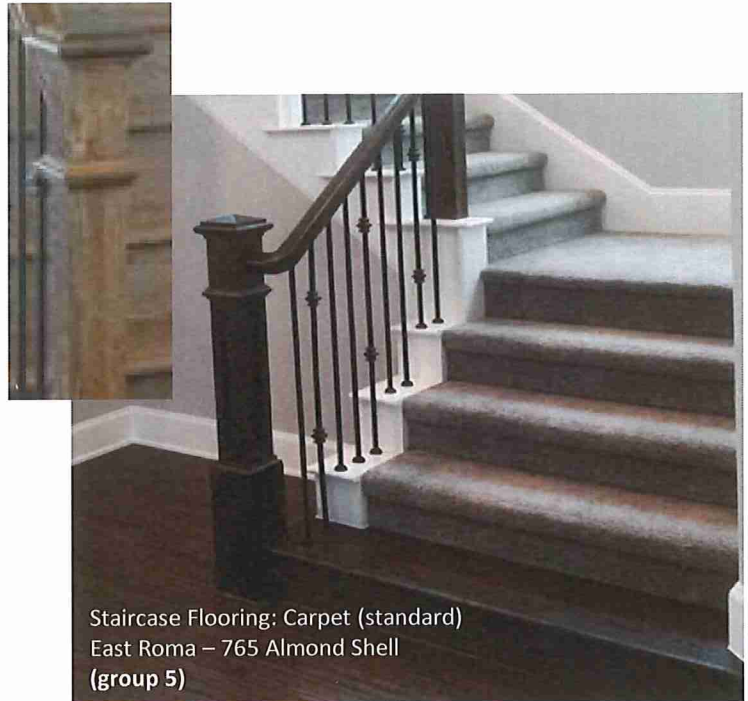

Staircase Flooring: Carpet (standard)  
East Roma – 765 Almond Shell  
(group 5)

Stair Selections  
*Choose option 1 or 2*

Option 1  
Carpet starter step (standard)

Option 2  
Oak starter step (upgrade)

Stair Selections  
*Choose baluster style option 1 or 2*



P-10A

Option 1  
Iron Balusters – P-10A (standard)  
Finish: Satin Black

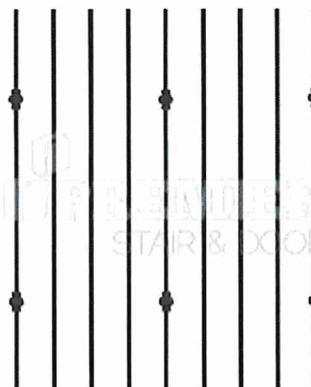

P-10K

Option 2  
Iron Balusters – P-10K (upgrade)  
Finish: Satin Black

Lighting Package for Whole House  
*No choice needed*

Stafford Collection  
Antique Pewter (Standard)



2558 AP  
2-Story Entry (As Per Plan)  
9-Light, 2-Tier, 100-W  
W. 33", Hgt. 32.25",  
Ovrll. 106.25"



2557 AP  
Dining (As Per Plan)  
5-Light, 100-W  
W. 26", Hgt. 23",  
Ovrll. 92.75"



9736 BK  
Coach Light (As Per Plan)  
1-Light, 100-W  
W. 8.25", H. 21.75", Ext. 8"

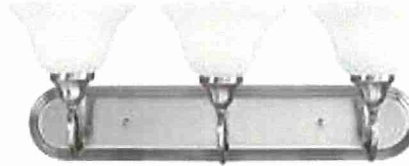

5558 AP  
Bath Vanity (Per Plan)  
2-Light, 3, 4, 100-W  
W. 24.25", Hgt. 9.25",  
Ovrll. 9.5"



LED Low-Profile Downlight  
Closets, Pantry, Hallway,  
Bedrooms, Entry, Dining, etc.  
(As Per Plan)  
15-W, 850Lm, 90 CRI, 3000K  
W. 7.5", H. 1.25"

Additional LED Disks  
*Choose only if option should be added*

- (4) LED disks to Family Room  
(1) Switch to LED disks at Family Room  
(upgrade)

Ceiling Fans  
*Choose additional rooms for pre-wires and/or fans*

Additional Ceiling Fan Selection  
(Standard in Family and Master)

- Other (List): \_\_\_\_\_  
 Other (List): \_\_\_\_\_  
 Other (List): \_\_\_\_\_



Ceiling Fan Speed Control

- Family  
 Other (List): \_\_\_\_\_  
 Other (List): \_\_\_\_\_



Paint Selections  
*No choice needed*

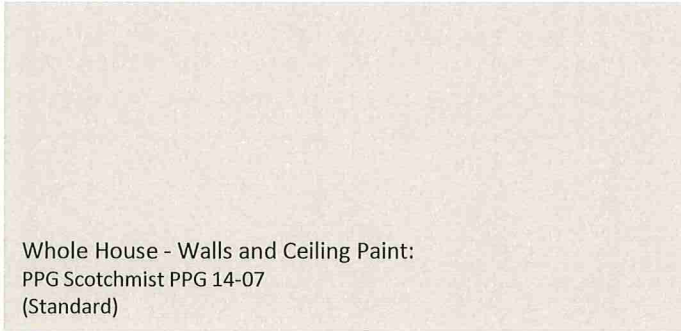

Whole House - Walls and Ceiling Paint:  
PPG Scotchmist PPG 14-07  
(Standard)

Whole House Trim:  
PPG Delicate White 1001-1  
(Standard)

Main Flooring  
*Choose option 1 or 2*



Wood Floor Option 1  
Engineered: Highland  
Collection  
(group 3)  
Stain: Birch

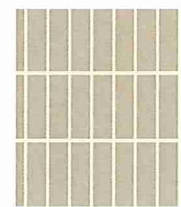
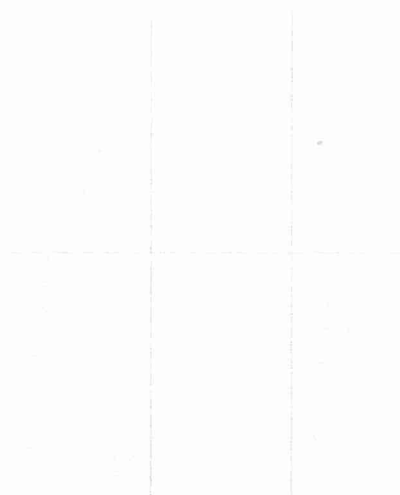

Pattern: Laid Straight  
(Standard)

Tile Floor Option 2  
Style: Linden Point (group 6)  
Color: Bianco  
Grout 909 Sterling  
Size: 12x24

Carpet Selections  
*No choice needed*



Whole House Carpet:  
East Roma – 765 Almond Shell  
(group 5)

Kitchen Countertops  
Choose option 1, 2 or 3



Option 1  
Granite  
Sesame Gold  
(group 4)



Option 2  
Granite  
Classical Paradiso  
(group 4)



Option 3  
Omegastone  
Cristallo  
(group 1)

*Soprano 3*

Kitchen Backsplash  
Choose option 1 or 2



Option 1  
Artigiano 3x6 Tremiti Sand  
(group 16) Grout 903 Birch  
upgrade

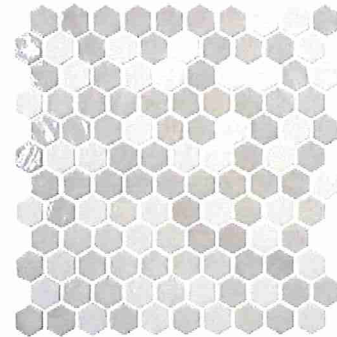

Option 2  
Uptown Glass Hexagon Mosaic  
1x1 - 12x12 mesh UP17 Alabaster  
(group 19) Grout #909 Sterling  
upgrade



Pattern: Horizontal Staggered

Plumbing  
Choose option 1 or 2



Option 1  
Camerist Spot Resist Finish  
(standard)

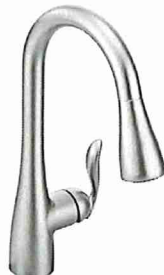

Option 2  
Arbor Spot Resist Finish  
(upgrade)

Sink  
No Choice needed



HA 100 Single Bowl  
Stainless Steel Finish  
Undermount

Countertops  
Choose Option 1 or 2



Option 1  
Granite  
Sesame Gold  
(group 4)



Option 2  
Granite  
Classical Paradiso  
(group 4)



Option 3  
Omegastone  
Cristallo  
(group 1)

Tile Flooring  
Choose layout options 1 or 2



Linden Point 12x24 – Bianco  
Shower Floor: Tile cut to 4" x 4"  
(group 6) Grout 909 Sterling  
upgrade

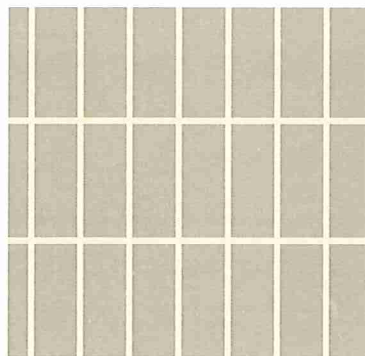

Tile Layout option 1  
Straight Lay  
(standard)

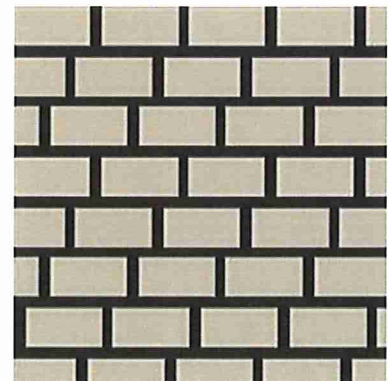

Tile Layout option 2  
Staggered 33% side to side  
(upgrade)



Master Shower Wall Tile  
*No choice needed*

Field Tile:  
Linden Point 12x24 – Bianco  
Tile can be cut to 4x4 for mudset  
(group 6) Grout 909 Sterling  
upgrade

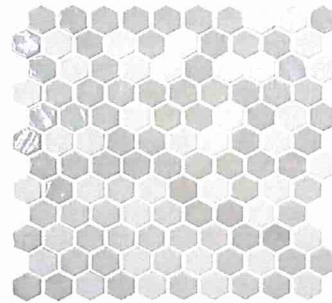

Optional Accent:  
Uptown Glass hexagon mosaic 1x1 –  
UP17 Alabaster  
(group 19)  
upgrade

Shower Walls  
*Choose option 1 or 2*

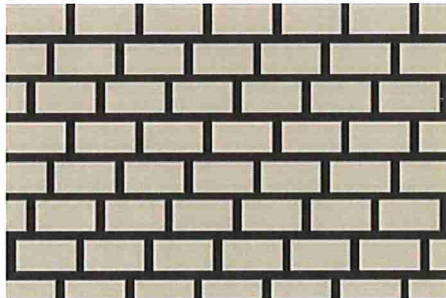

Option 1  
Horizontal Staggered  
(No Accent)

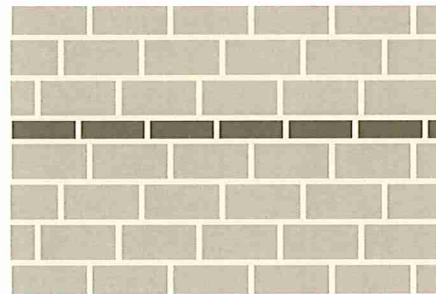

Option 2  
Horizontal Staggered  
(4" Accent)

Tub Splash and Tub Skirt (as per plan)  
*No Choice Needed*

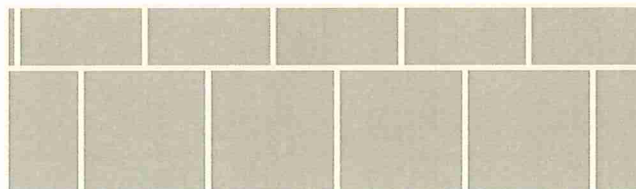

Master Tub without Accent

Secondary Bath Floor  
*No choice needed*



Field Tile  
Parkway 12x12 – Cream  
Tile cut to 4x4 for optional mudset  
In downstairs bathroom-per plan  
(group 4) Grout 909 Sterling

Secondary Bath Countertop  
*No choice needed*



White Cultured Marble (standard)

Shower Walls  
*No choice needed*

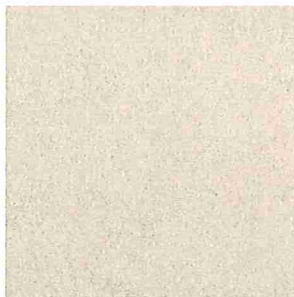

Field Tile  
Parkway 12x12 - Cream  
(group 4)  
U[grade



Optional Accent (for downstairs bathroom only):  
Midpark Rectangular Mosaic  
MP08 Sandbox (12x12 mesh)  
(group 18)  
upgrade

Secondary Tub and Shower Walls Pattern  
*Choose patterns for secondary bathrooms*

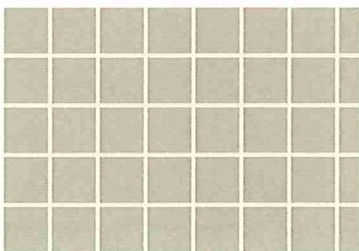

- All Baths
- Secondary Baths Upstairs Only



- Horizontal staggered 33%  
(4" Wide Accent)
- Secondary Bath Downstairs

Tile Flooring  
*Choose layout options 1 or 2*

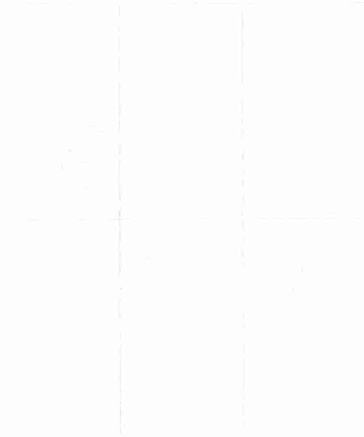

Style: Linden Point  
(group 6)  
Color: Bianco  
Grout 909 Sterling  
Size: 12x24

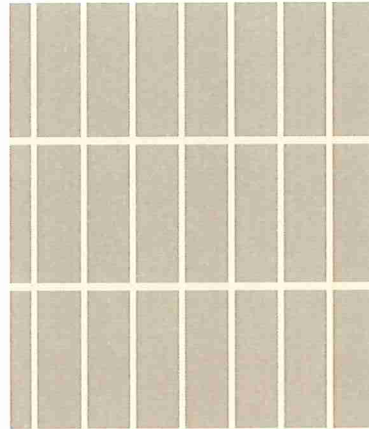

Tile Layout  
Flooring laid straight – Front to back

Utility Sink Option

*No choice needed – These are included with structural option  
Cabinet upgraded to match kitchen selections*



Camerist Spot Resist Finish  
(standard)



Fireplace  
*No Choice Needed*

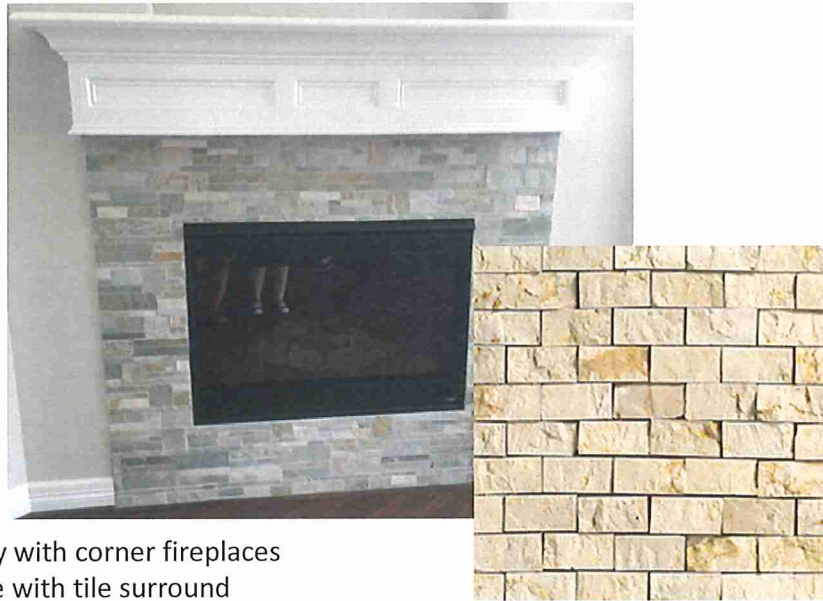

- Option 1 – Available only with corner fireplaces  
Standard Painted Mantle with tile surround  
Trav Split Face Mosaic 12x12 Mesh – Crema Marfil  
Level 19  
Upgrade



- Option 2  
Cast stone  
Manhattan – Smooth Finish



Division: Texas Houston - Homebuilding

Community: Harmony 65

Lot Number: LOT 28 (010128)

quote number:Q-11427

Model: Garnet

Buyer:

Address: 28050 Drifters Bend Drive, Spring, TX, 77386

Swing: N/A

| Product Code                        | Name  | Qty  | List Unit Price | Total Price |
|-------------------------------------|---|------|-----------------|-------------|
| <b>(Order #: 1)</b>                 |   |      |                 |             |
| <i>Category: Appliance Packages</i> |   |      |                 |             |
| GEAP0401                            | GE 30" Stainless Cooktop w/BI Microwave/Oven Appliance Package              | 1.00 | \$0.00          | \$0.00      |
| <i>Category: Bathroom Options</i>   |   |      |                 |             |
| OWNB0222                            | Opt Shower 2 with Mud-set Tile Floor @ Owner's Bath - Larger Pan            | 1.00 | \$0.00          | \$0.00      |
| OWNB0120                            | Opt. Shower / Mud-set @ Owner's Bath (Base plan's Owner Bath Configuration) | 1.00 | \$0.00          | \$0.00      |
| <i>Category: Brick</i>              |   |      |                 |             |
| BRCK1000                            | Meridian Brick - Standard Brick Colors<br><i>Desert Pass Brick</i>          | 1.00 | \$0.00          | \$0.00      |
|                                     | <i>Gray</i>   | 1    |                 |             |
|                                     | <i>M - Desert Pass</i>  | 1    |                 |             |
| <i>Category: Brick Options</i>      |   |      |                 |             |
| VNBR0010                            | Brick ilo Siding @ Sides - First Floor Only                                 | 1.00 | \$0.00          | \$0.00      |
| VNBR0012                            | Brick ilo Siding @ Sides - Second Floor Only                                | 1.00 | \$0.00          | \$0.00      |
| VNBR0020                            | Brick ilo Siding @ Rear - First Floor Only                                  | 1.00 | \$0.00          | \$0.00      |
| VNBR0022                            | Brick ilo Siding @ Rear - Second Floor Only                                 | 1.00 | \$0.00          | \$0.00      |

*Category: Ceiling Fans*

|          |  |          |        |        |
|----------|--|----------|--------|--------|
| CFAN0001 | Additional Standard Ceiling Fan - must add pre-wire for additional fan<br><i>ibd at dc</i> | 1.00     | \$0.00 | \$0.00 |
|          | <i>N17 Brushed Nickel w/ White Etched Glass</i>  | <i>1</i> |        |        |

*Category: Commodes*

|          |                                    |      |        |        |
|----------|------------------------------------|------|--------|--------|
| COMM0001 | Commode - Elongated in Master Bath | 1.00 | \$0.00 | \$0.00 |
|----------|------------------------------------|------|--------|--------|

*Category: Electrical*

|          |                               |      |        |        |
|----------|-------------------------------|------|--------|--------|
| ELOL0016 | Decora Switches               | 1.00 | \$0.00 | \$0.00 |
| ELPN0001 | Electrical Panel in Garage    | 1.00 | \$0.00 | \$0.00 |
| GDOR0001 | Garage Door Opener (per door) | 1.00 | \$0.00 | \$0.00 |

*Category: Exterior Options (Structural)*

|          |   |      |             |             |
|----------|---|------|-------------|-------------|
| FDOP0001 | 8 Foot Single Front Door Option   | 1.00 | \$850.00    | \$850.00    |
| BALC0001 | Balcony - Must select with 2nd Floor Game Room Option.<br>Can't be selected with Bedroom 5 & Bath 4 Option<br><i>No back Neighbor</i> | 1.00 | \$12,875.00 | \$12,875.00 |

*Category: Exterior Paint*

|          |   |      |        |        |
|----------|---|------|--------|--------|
| PNTE0000 | Exterior Paint Color Standard<br><i>Stoningham 15-25 : TRIM Wild Wilderness 1019-5 :Garage &amp; shutters</i> | 1.00 | \$0.00 | \$0.00 |
|----------|---|------|--------|--------|

*Category: General Room Options*

|          |  |      |        |        |
|----------|--|------|--------|--------|
| GAME0001 | Game Room  | 1.00 | \$0.00 | \$0.00 |
| WDTK0001 | Window Package Turnkey   | 1.00 | \$0.00 | \$0.00 |
| GRMT2000 | Gourmet Kitchen 2 - Cooktop with Vented Hood and 30"/36" Built-In Wall Oven / Micro Tower - Must select and pay for corresponding appliance and cabinet options (GEAP0203, GEAP0204, GEAP0207, GEAP0209, GEAP0401, GEAP0402, GEAP0406, GEAP0407) | 1.00 | \$0.00 | \$0.00 |

*Category: Interior Door Trim & Hardware*

|              |  |      |        |        |
|--------------|--|------|--------|--------|
| DRHW1101EXTG | Upgrade to Barcelona Satin Nickel Handleset - Can only be sold with Stratus and Torino interior hardware | 1.00 | \$0.00 | \$0.00 |
| DRHW1209PKG  | Upgrade to Stratus Satin Nickel Knobs  | 1.00 | \$0.00 | \$0.00 |

*Category: Interior Options (Structural)*

|          |                     |      |            |            |
|----------|---------------------|------|------------|------------|
| STRO0100 | Open Rail Option #1 | 1.00 | \$1,060.00 | \$1,060.00 |
|----------|---------------------|------|------------|------------|

*Category: Interior Trim*

|          |  |      |        |        |
|----------|--|------|--------|--------|
| CRWN1006 | Crown Mld - 1 pc - Study                           | 1.00 | \$0.00 | \$0.00 |
| CRWN1001 | Crown Mld - 1 pc - Dining Room                     | 1.00 | \$0.00 | \$0.00 |
| CRWN1003 | Crown Mld - 1 pc - Entry                           | 1.00 | \$0.00 | \$0.00 |
| TRIM0013 | Trim Upgrade to Level 3 - Interior Base and Casing | 1.00 | \$0.00 | \$0.00 |

**Category: Kitchen Faucets**

|          |  |      |        |        |
|----------|--|------|--------|--------|
| FXKT0102 | Kitchen Faucet - Camersit - SS - 7545SRS | 1.00 | \$0.00 | \$0.00 |
|----------|--|------|--------|--------|

**Category: Kitchen Sinks**

|          |  |      |        |        |
|----------|--|------|--------|--------|
| SINK0011 | Sink Upgrade - Provided by Wisenbaker (priced at the DC) | 1.00 | \$0.00 | \$0.00 |
|----------|--|------|--------|--------|

**Category: LVL 1 Fix - Master Bath**

|          |                                       |      |        |        |
|----------|---------------------------------------|------|--------|--------|
| PFMB0101 | Master Bath - Brantford - 4" - Chrome | 1.00 | \$0.00 | \$0.00 |
|----------|---------------------------------------|------|--------|--------|

**Category: Light Fixture Packages - Lvl 2**

|          |                      |      |        |        |
|----------|----------------------|------|--------|--------|
| LTPK0201 | Light Pkg - Stafford | 1.00 | \$0.00 | \$0.00 |
|          | Bronze               | 1    |        |        |

**Category: Multiple Mechanicals**

|          |                      |      |        |        |
|----------|----------------------|------|--------|--------|
| QUCK0001 | Quick Flash Products | 1.00 | \$0.00 | \$0.00 |
|----------|----------------------|------|--------|--------|

**Category: Opt. Built-In Kitchen 30" Ctop**

|          |                                      |      |        |        |
|----------|--------------------------------------|------|--------|--------|
| KCAB0100 | Opt. Built-in w/ 30" Cooktop w/ std. | 1.00 | \$0.00 | \$0.00 |
|          | Cognac                               | 1    |        |        |
|          | Tahoe Maple                          | 1    |        |        |

**Category: Special Custom**

|          |                        |      |        |        |
|----------|------------------------|------|--------|--------|
| CMAD0000 | Community Requirements | 1.00 | \$0.00 | \$0.00 |
|----------|------------------------|------|--------|--------|

**Category: Stair Hand Rail**

|          |                          |      |        |        |
|----------|--------------------------|------|--------|--------|
| HASR0000 | Standard Hand Rail Stain | 1.00 | \$0.00 | \$0.00 |
|          | Dark Mahogany            | 1    |        |        |

**Category: Stone**

|          |   |      |            |            |
|----------|---|------|------------|------------|
| EFST0003 | Stone Level 3 (must select with stone front option) | 1.00 | \$1,247.00 | \$1,247.00 |
|          | Grandbury Chop stone                                |      |            |            |
|          | Grandbury Chop                                      | 1    |            |            |
|          | Khaki   | 1    |            |            |



---

Category: ~~Vanity Granite Group~~

|          |  |      |        |        |
|----------|--|------|--------|--------|
| GRVN1001 | Master Bath - Group 1 Granite Vanity Top (Priced through Wisenbaker) | 1.00 | \$0.00 | \$0.00 |
|----------|--|------|--------|--------|

---

|                             |                     |
|-----------------------------|---------------------|
| <b>Sub Total</b>            | <b>\$16,032.00</b>  |
| <b>Lot Premium</b>          | <b>\$20,000.00</b>  |
| <b>Base Price</b>           | <b>\$349,990.00</b> |
| <b>Option Total</b>         | <b>\$16,032.00</b>  |
| <b>Incentive Given</b>      | <b>\$0.00</b>       |
| <b>Total Purchase Price</b> | <b>\$386,022.00</b> |

---

This system-generated *Proposal* is provided to a prospective buyer and/or its Broker/Agent outside of and not made a part of the Purchase Agreement: (1) all information as of the date indicated remains subject to change at any time without notice or obligation; and (2) is for illustrative and informational purposes only for preliminary discussions for prospective buyer's convenience. No guarantee or representation is made or implied as to availability, manufacturer, style, size, color, number, pricing and other factors installed in the completed home and/or subject to applicable incentives (if any) affecting pricing, all of which Seller reserves the right to modify. Refer to the final executed: Purchase Agreement and its attached Addenda (inclusive of any post-purchase amendments thereto) and the specific Community's Standard Features List for complete details. Equal Housing Builder.

# TaylorMorrison.

## Showcase Home Request Form

|  |                     |
|--|---------------------|
| Community Name:                        | Harmony 65          |
| Community Sales Manager:               | Rosa Leon           |
| Target Consumer:                       | Teen Builder        |
| Current # of Started Showcase Homes:   |                     |
| Current # of Unstarted Showcase Homes: |                     |
| Home Site Number:                      | lot 28              |
| Address:                               | 28050 Drifters Bend |
| Floor Plan:                            | Garnet              |
| Elevation:                             | D                   |
| Exterior Color Request:                |                     |
| Garage Swing                           | right swing         |
| # of Plan Sales in Last 12 Months:     | 0                   |
| % of Plan Sales in Last 12 Months:     |                     |
| Proposed Plan Square Footage           | 3292                |
| Base Price:                            | \$349,990           |
| Lot Premium:                           | \$20,000            |
| Structural Option / FRO Target:        | \$14,785            |
| DC Option Target:                      | \$30,000            |
| Target Gross Sales Price:              | \$414,775           |
| Current BP +CC Incentive: (Ex. -5000)  | (\$35,000)          |
| Estimated Net Sales Price:             | \$379,775           |

|                              |
|------------------------------|
| <b>Proposed Price per SF</b> |
| \$115.36                     |

|   |       |
|---|-------|
| <b>Options as % of Base Sales Price</b> |       |
| Structural:                             | 4.2%  |
| DC:                                     | 8.6%  |
| Total:                                  | 12.8% |

| Structural Options        | Price |
|---------------------------|-------|
| balcony- no back neighbor | 12875 |
| 8 foot front door         | 850   |
| open rail 1               | 1060  |
|                           |       |
|                           |       |
|                           |       |
|                           |       |
|                           |       |

| CSM Design Center Requests | Price |
|----------------------------|-------|
|                            |       |
|                            |       |
|                            |       |
|                            |       |
|                            |       |
|                            |       |
|                            |       |
|                            |       |

**Proposed Marketing Strategy (please be specific):**

we want to showcase our new plans in the 50s, we also have lots of new competition in the area.

**\*\* Upon completion, please submit form to Area Sales Manager for approval \*\***

\_\_\_\_\_  
VPSM / ASM Approval (Date)







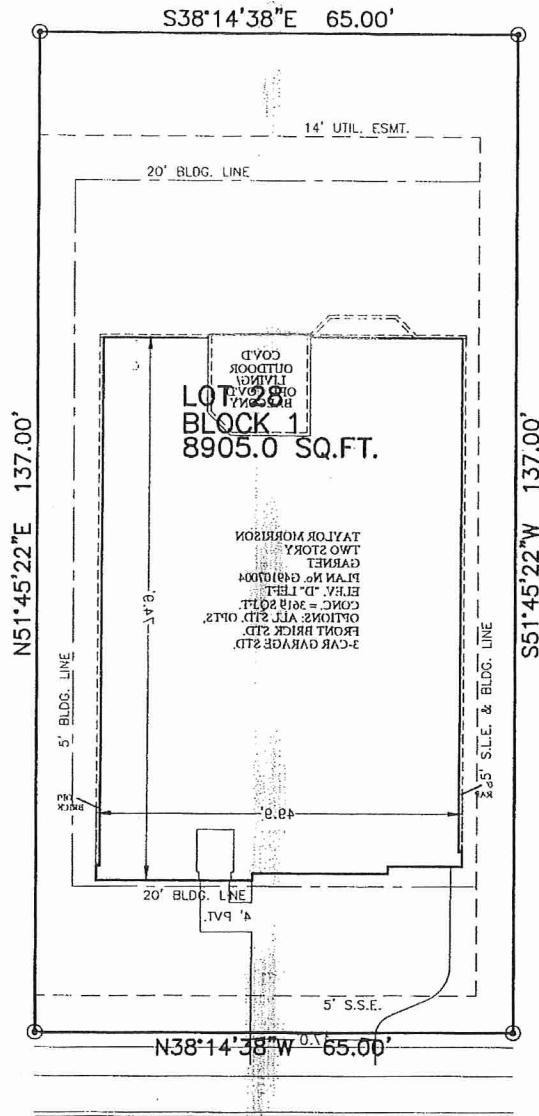
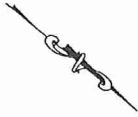

DRIFTERS BEND DRIVE  
 (50' P.A.E./P.U.E.)  
 28' CONCRETE PAVEMENT

NOTES:  
 1. BEARINGS SHOWN HEREON ARE BASED ON THE RECORDED PLAT.  
 THIS LOT DRAWING WAS PREPARED WITHOUT REFERENCE TO A TITLE REPORT. THERE MAY BE UNRECORDED EASEMENTS, BUILDING LINES & OTHER MATTERS NOT SHOWN HEREON. SURVEYOR AND ALLPOINTS SERVICES CORP. IS NOT LIABLE FOR ANY DAMAGES THAT MAY INCUR IN ANY EVENT THE BUILDER BUILDS ANY IMPROVEMENTS OTHER THAN 5' OR WITHIN AN EASEMENT.

LOT DRAWING  
 SCALE: 1 = 20'

© 2015, ALLPOINTS SERVICES CORP., ALL RIGHTS RESERVED

TAYLOR MORRISON  
 HOMES  
 PROJECT:  
 DRIFTERS BEND DRIVE  
 PROJECT JOB #: TM SS

LOT 28, BLOCK 1,  
 ALLEGRO AT HARMONY, SECTION 1,  
 CAB. "Z" SHOTS. 3307-3311 MAP RECORDS,  
 MONTGOMERY COUNTY, TEXAS



ALLPOINTS  
 SERVICES CORP  
 PHONE: 713-468-7707  
 FAX: 713-827-1861

ISSUE DATE: 3/30/2015

| ARC  | LEN.   | RAD.   | CHRD. BRG.  |
|------|--------|--------|-------------|
| 'A1' | 38.00' | 50.00' | N09°03'47"E |

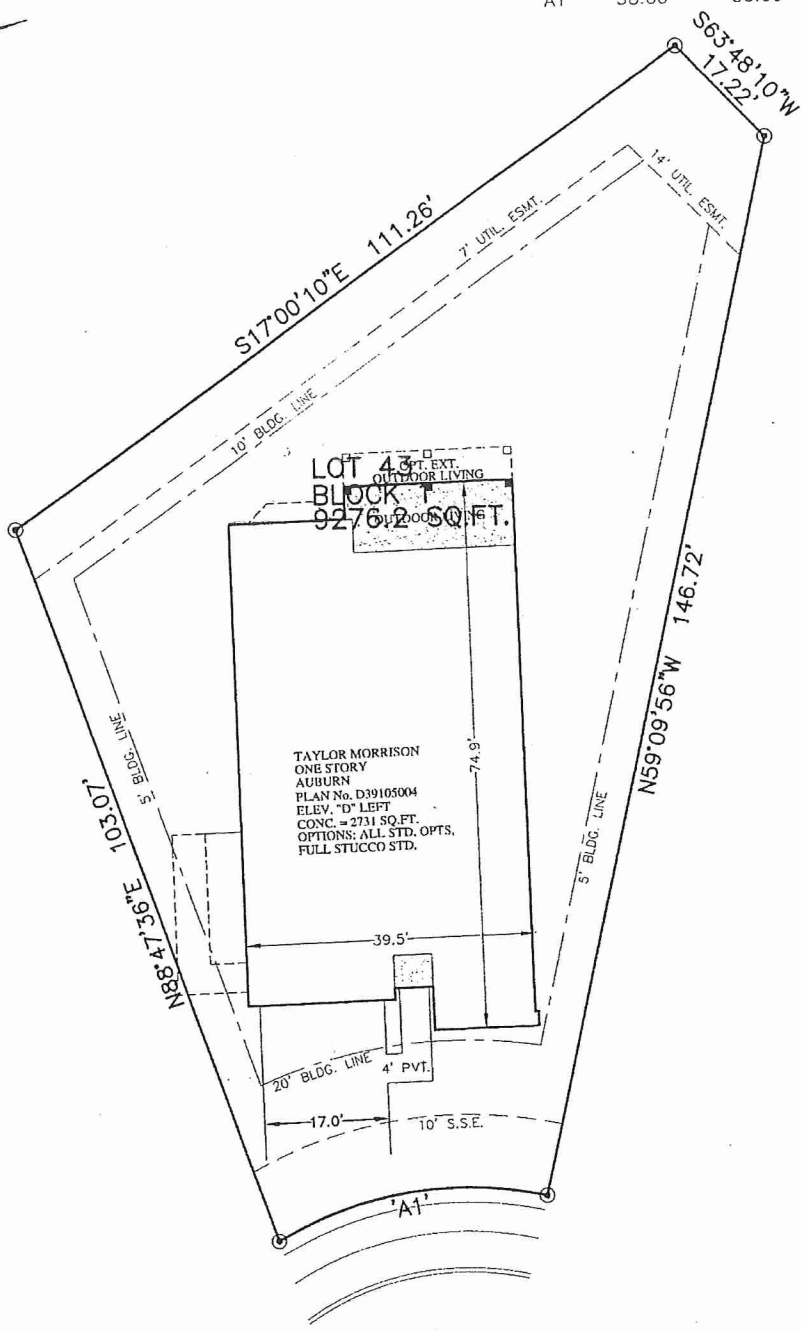

**HENDRIX PARK DRIVE**  
 (50' R.O.W.)  
 28' CONCRETE PAVEMENT  
**LOT DRAWING**  
 SCALE: 1 = 20'

ES:  
 ALL BEARINGS SHOWN HEREON ARE BASED ON THE RECORDED PLAT.  
 THIS LOT DRAWING WAS PREPARED WITHOUT BENEFIT OF A TITLE REPORT. THERE MAY BE EASEMENTS, BUILDING LINES & OTHER MATTERS IF RECORD NOT SHOWN HEREON. SURVEYOR OR ALLPOINTS SERVICES CORP. IS NOT LIABLE FOR ANY DAMAGES THAT MAY INCUR IN ANY EVENT THE BUILDER BUILDS ANY IMPROVEMENTS CLOSER THAN 5' OR WITHIN AN EASEMENT.

015, ALLPOINTS SERVICES CORP., ALL RIGHTS RESERVED

FOR: TAYLOR MORRISON HOMES  
 ADDRESS: HENDRIX PARK DRIVE  
 ALLPOINTS JOB #: TM

LOT 43, BLOCK 1,  
 ALLEGRO AT HARMONY, SECTION 2,  
 CAB. "Z" SHTS. 3360-3364, MAP RECORDS,  
 MONTGOMERY COUNTY, TEXAS

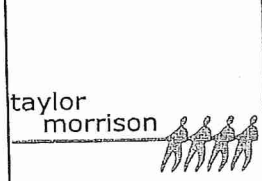

ISSUE DATE: 3/30/2015

# Harmony 65's FEATURE SHEET

## CHATEAU SERIES/SERIES 7

### Inspired Kitchens

---

- Built-in stainless appliances with 30" gas cooktop, single oven, dishwasher, microwave and vent hood
- 42" Maple cabinets w/ adjustable shelves and bump out at cooktop
- Butler's Pantry (per plan)
- Electrical outlets on backsplash installed horizontally
- Granite countertops in kitchen level 1
- Ceramic tile in kitchen/breakfast level 1
- Ceramic tile on kitchen backsplash diagonal level 1
- Stainless undermount sink 50/50 split, 9 inches deep
- Moen stainless Camerist pull out faucet w/ spray
- Kichler LED lighting in kitchen/breakfast
- DuPure filtered drinking water system at kitchen sink w/matching spigot

### Inspired Master Suites

---

- Granite vanity countertops in master level 1
- Ceramic tile flooring level 1
- Maple cabinets w/ raised vanities and knee space (per plan)
- Elongated commode in master toilet room
- Separate shower with chrome shower frame and ceramic tile recessed mud set floor level 1
- Moen Brantford chrome faucets
- Garden tub with cultured marble skirt and tile surround level 1
- Climate controlled spacious walk in closets with durable shelving, natural clothing rods

### Inspired Interiors

---

- Ceramic tile in all baths and utility level 1
- Crown molding in entry, entry coffer ceiling, dining and study (per plan)
- 4 ¼ base boards downstairs and upstairs and 3 ½" casing down and up
- Rockport interior 5 vertical panel doors 6'8"
- Square sheetrock corners and openings
- Coffered ceilings and art niches (per plan)
- Décor light switches
- Dramatic staircase with metal spindles, stained red oak handrail and pyramid top box
- newel posts, MDF paint grade cap and risers (per plan)
- PPG paint, 2 interior choices with white enamel trim
- Secondary bedrooms and gameroom pre-wired for ceiling fan
- Ceiling fans in family and master suite - 3 speed 52"
- Kichler brushed nickel or bronze lighting package "Stafford"
- Secondary baths cultured marble vanity
- Moen Brantford Chrome faucets in all baths
- Round commodes in secondary baths
- Square pedestal sink, elongated commode at powder room
- Secondary bath cabinets maple standard height
- Schlage Stratus satin nickel interior door hardware

### Inspired Exteriors

---

- Meridian Brick featuring Boral or Forterra Brick on 4 sides of 1<sup>st</sup> floor (plan)
- Covered patio w/LED lighting and pre-wire for ceiling fan (per plan)
- Fiberglass leaded glass entry door 6'8" w/ Schlage Barcelona satin nickel handleset
- Rear door 6'8" 1 lite
- 6 foot privacy fence with gate
- Landscaping packages to include professionally installed trees and shrubbery in the front yard
- Sod in the front and back yard
- Programmable Sprinkler System front and back yard
- Garage doors per plan with door openers and remotes
- Custom cast stone address plaque
- PPG exterior paint with two tone color
- Aluminum gutters on front of home



### Inspired Construction

---

- Professionally engineered post-tension cable and concrete foundation
- 30 year mildew resistant shingles
- Engineered I-Joist for 2<sup>nd</sup> floors with ¾" structure wood subfloor
- Fresh air blending system provides proper exchange of outside and inside air to improve air quality
- Screwed and glued sub flooring
- Radiant barrier roof decking

### Inspired Energy

---

- High Efficiency 15 Seer air condition system with new environmentally friendly R-410 refrigerant
- Electrical panel at garage
- Energy Star Honeywell programmable thermostat
- Rinnai tankless water heater with endless hot water supply, designed per plan
- Energy saving Low E double pane windows with energy efficient tinted glass
- Ridge vents with vented soffit

### Inspired Technology

---

- Smoke detector with battery back up in all bedrooms
- Prewire for security contacts at all accessible operable openings
- Prewire for recessed security contacts at all operable doors
- Prewire for security camera 2 locations
- Installation of 1 LCD security keypad at garage entry door, prewire to master bedroom
- Interior siren and battery backup
- Surround sound prewire at one location including wiring for 5 speakers and 1 subwoofer
- CAT 5 advanced wiring for phones
- RG6 quad shield coaxial cable for cable TV
- Motion detector prewire at family room (no trim out)
- Land Tejas premium wiring package

### Inspired Service

---

- Two 3 hour consultations and one 2 hour final consultation with Design Center within 21 days from Purchase Agreement date
- Preconstruction meeting with buyer
- Pre-drywall meeting with buyer
- New home demonstration

All included features are subjected to modification without notice including changes, additions, and deletions. Some included features may not be available on all floor plans or in all communities. Some included features are only available on specific plans and/or in specific communities. See a Sales Associate for a list of other included features for a specific community or plan. The availability and pricing of these features is subject to change without prior notice. Seller also reserves the right to make any modifications, changes, or omissions to the home as long as they do not substantially adversely affect the home or if they are required by code changes with any governmental authority, and to substitute materials, equipment, cabinets, fixtures, appliances, and or flooring coverings with items similar or of greater quality, utility, value and or color. Materials such as brick, wood, wood grain, carpeting, paint, cabinets, granite, cultured marble, tile, laminate, and the like are subject to shading and gradation and may vary from sample, models or colors charts. Seller will not be liable for such variation.

Buyer Acknowledgement: \_\_\_\_\_

Date: \_\_\_\_\_

Buyer Acknowledgement: \_\_\_\_\_

Date: \_\_\_\_\_

06/19/2018