

REPAIR TICKET # 34479

Foreman Barry

Scheduled Date 7/27/2015

Scheduled Day Monday

Scheduled Time pm

Company

Customer (First) Billy

Customer (Last) Ashby

Address 3530 Pecan Point

City Sugar Land

Zip Code 77478 Key Map

Subdivision Creekshire

Phone #

Mobile # 979-574-1794

Special Instructions Install Date 11/23/11

Maintenance Agreement

Discount

CALL TAYLOR 832-746-8962 - 30 MINTUES AHEAD

Pre-Approved Amount

\$0.00

TROUBLE REPORTED

SERVICE PERFORMED

leak in valve box

Test valves manually
valve bank in back yard
replace by hand on valve

1 - RG cylindrical
2 - water proof connectors

2nd to right - leaky from O ring
Tighten bleed screws
check all valves for leaks

Tech	Date	Time Arrived	Time Left	Total OTJ	Rate	Total Amount
BP	7/27/15	1:30	2:00	.5		

Customer Signature

Taylor Ashby

Follow-up Needed

Yes

No

Notes

Miscellaneous / Equipment Charges

Total Material

35.00

Total Labor

99.50

Tax

2.88

Grand Total

137.38

Appt Scheduled By

brw 7/24 12:20

JT Printed By

brw *brw*

*** 90-DAY WARRANTY ***

T/M	Quoted	Warranty	COD	Check	Credit Card	On Account	New Customer	Existing Custom
<input checked="" type="checkbox"/>	<input type="checkbox"/>	<input type="checkbox"/>	<input checked="" type="checkbox"/>	<input type="checkbox"/>	<input type="checkbox"/>	<input type="checkbox"/>	<input type="checkbox"/>	<input checked="" type="checkbox"/>

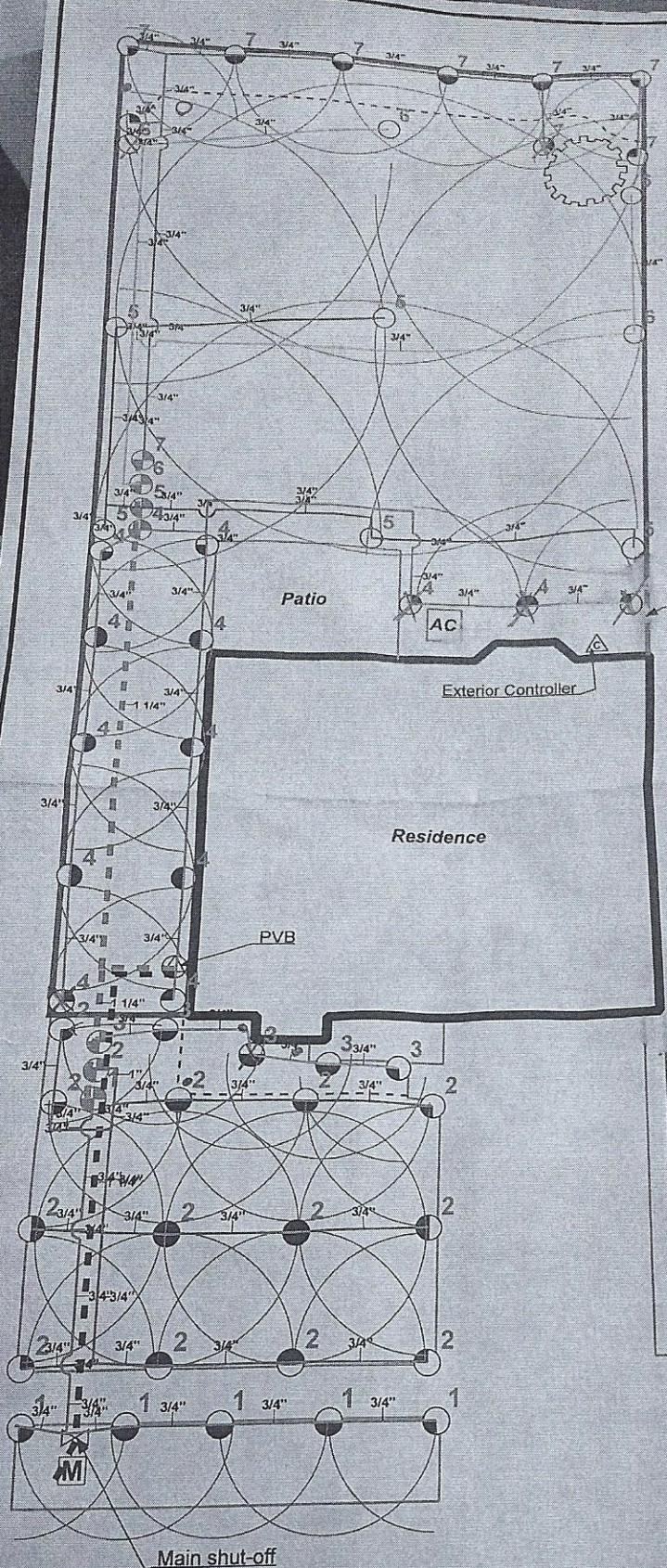

Irrigation

Qty	Symbol	Description	Part Number	Pressure	Flow	Radius
Sprinklers						
1	○	Hunter PG170 - PCL104	20	48 psi	2 gpm	25 ft
2	●	Rain Bird 1804	1804	30 psi	2.5 gpm	10 ft
17	○	Rain Bird 1812	1812	30 psi	0.75 gpm	10 ft
15	○	Rain Bird 1834	1834	30 psi	0.35 gpm	10 ft
8	○	Rain Bird 1804	1804	30 psi	0.52 gpm	18 ft
2	○	Rain Bird BC - 1804	1804	30 psi	0.26 gpm	18 ft
Water Source						
1	M	3/8 inch meter				
Backflow Devices						
1	□	1 foot 765 - 1"		1765 - 1"		
Control Valves						
7	□	Rain Bird 100-DV		100-DV		
Irrigation Accessories						
1	□	Hunter MINI-CLIK		MINI-CLIK		
1	□	Hunter PC-900		PC-900		
1	□	Nelson 9501-100IN		9501-100IN		
Lateral Line Pipe						
634.66 ft	□	Schedule 40 3/4"				
1.99 ft	□	Schedule 40 1"				
Mainline Pipe						
44.76 ft	□	Schedule 40 1 1/4"				
60.95 ft	□	Class 200 1 1/4"				

Sprinkler Zone Data

Zone #	Total Area	Total Flow	Precip Rate
1	235.79 Sq/Ft	2.08 gpm	0.85 in/hr
2	676.51 Sq/Ft	9.72 gpm	1.38 in/hr
3	219.69 Sq/Ft	1.82 gpm	0.8 in/hr
4	662.87 Sq/Ft	7.87 gpm	1.14 in/hr
5	2192.25 Sq/Ft	10 gpm	0.44 in/hr
6	1624.77 Sq/Ft	8 gpm	0.47 in/hr
7	498.67 Sq/Ft	5.11 gpm	0.99 in/hr

Drip Zone Data

Design Pressure = 40 PSI



Ed Vitale
11/10/11



City of Sugar Land
Reviewed for Code Compliance

NOV 11 2011
Donald R. Friggel
Approved by: _____

SHEET	1 of 1
SCALE	1" = 10'
CHECKED BY:	EV
DRAWN BY:	LH
JOB NUMBER:	12345
DATE:	11/9/11
REVISIONS:	NOTE

PROJECT:
Coombs Residence
3530 Pecan Point Dr.
Sugar Land, TX

SHEET DESCRIPTION:
Irrigation Design

Waterwise Irrigation, Inc.
832-467-4193

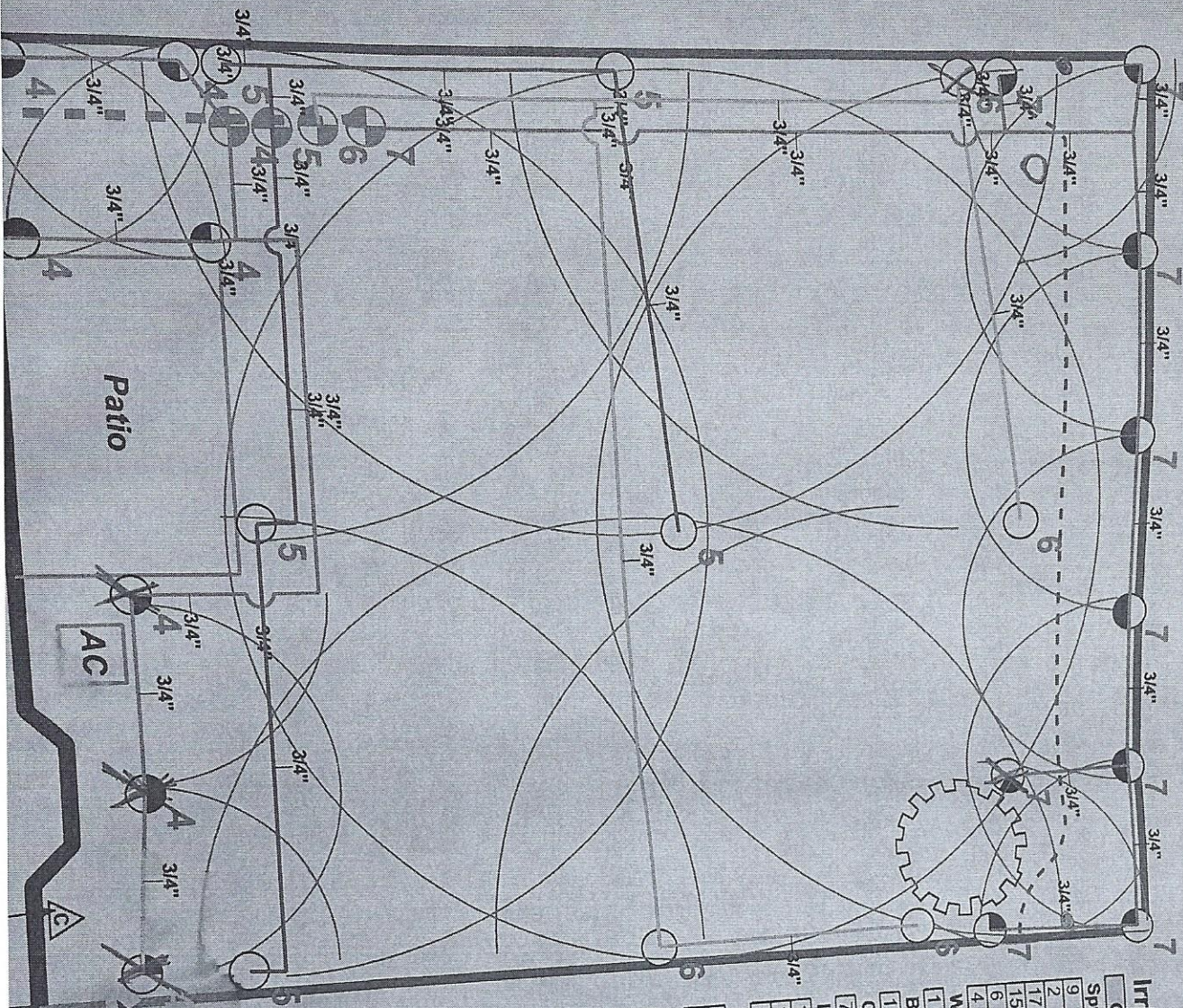

Irrigation

Qty	Symbol	Description	Part Number	Pressure	Flow	Radius
9	○	Hunter PGJ-2.0 - PGJ-04	2.0	40 psi	2 gpm	25 ft
2	●	Rain Bird 10F - 1804	10F	30 psi	1.58 gpm	10 ft
17	●	Rain Bird 10H - 1812	10H	30 psi	0.79 gpm	10 ft
15	●	Rain Bird 10Q - 1804	10Q	30 psi	0.39 gpm	10 ft
6	●	Rain Bird 8H - 1804	8H	30 psi	0.52 gpm	8 ft
4	●	Rain Bird 8Q - 1804	8Q	30 psi	0.26 gpm	8 ft
1	⊞	Water Source	5/8 inch meter			
1	⊞	Backflow Devices	Febco 765 - 1"	765 - 1"		
7	⊞	Control Valves	Rain Bird 100-DV	100-DV		
1	⊞	Irrigation Accessories	Hunter MINI-CLIK	MINI-CLIK		
1	⊞		Hunter PC-900	PC-900		
1	⊞		Nelson 9501-100IN	9501-100IN		
1	⊞	Lateral Line Pipe	Schedule 40 3/4"			
1	⊞		Schedule 40 1"			
1	⊞	Mainline Pipe	Schedule 40 1 1/4"			
1	⊞		Class 200 1 1/4"			

Sprinkler Zone Data

Zone #	Total Area	Total Flow	Precip Rate
1	235.79 Sq/Ft	2.08 gpm	0.85 in/hr
2	676.51 Sq/Ft	9.72 gpm	1.38 in/hr
3	219.69 Sq/Ft	1.82 gpm	0.8 in/hr
4	662.87 Sq/Ft	7.87 gpm	1.14 in/hr
5	2192.25 Sq/Ft	10 gpm	0.44 in/hr
6	1624.77 Sq/Ft	8 gpm	0.47 in/hr
7	498.67 Sq/Ft	5.11 gpm	0.99 in/hr

Drip Zone Data

Rain sensor
 Design Pressure = 40 PSI

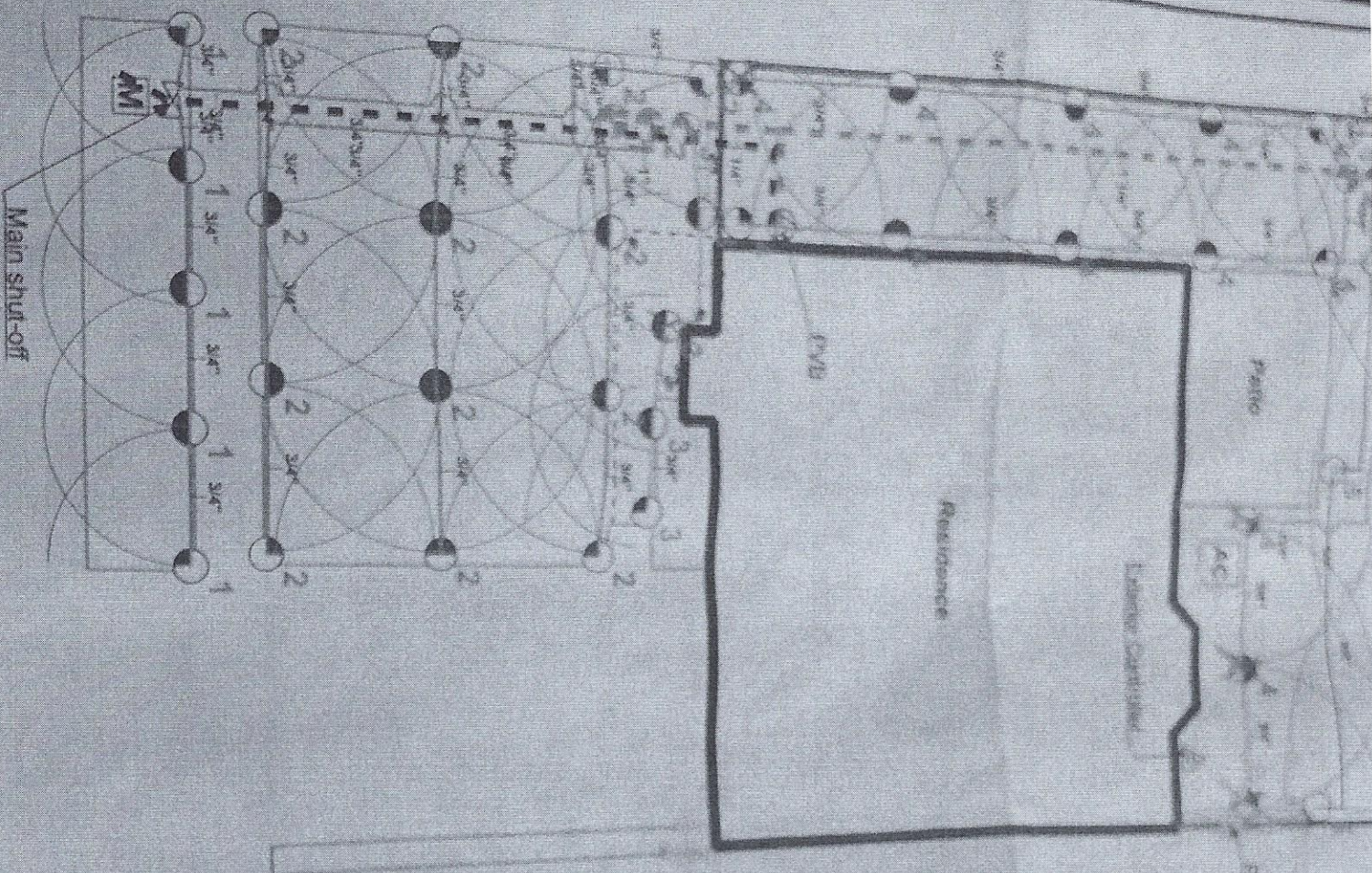

Line	Size	Material	Notes
1	12"	Cast Iron	Water Main
2	8"	Cast Iron	Water Main
3	6"	Cast Iron	Water Main
4	4"	Cast Iron	Water Main
5	3"	Cast Iron	Water Main
6	2"	Cast Iron	Water Main
7	1 1/2"	Cast Iron	Water Main
8	1"	Cast Iron	Water Main
9	3/4"	Cast Iron	Water Main
10	1/2"	Cast Iron	Water Main

Flow Direction: _____
 Design Pressure - 100 PSI

W. J. [Signature]
 11/10/10



City of Sugar Land
 Reviewed for Code Compliance

NOV 11 2011
 Approved by: *[Signature]*