

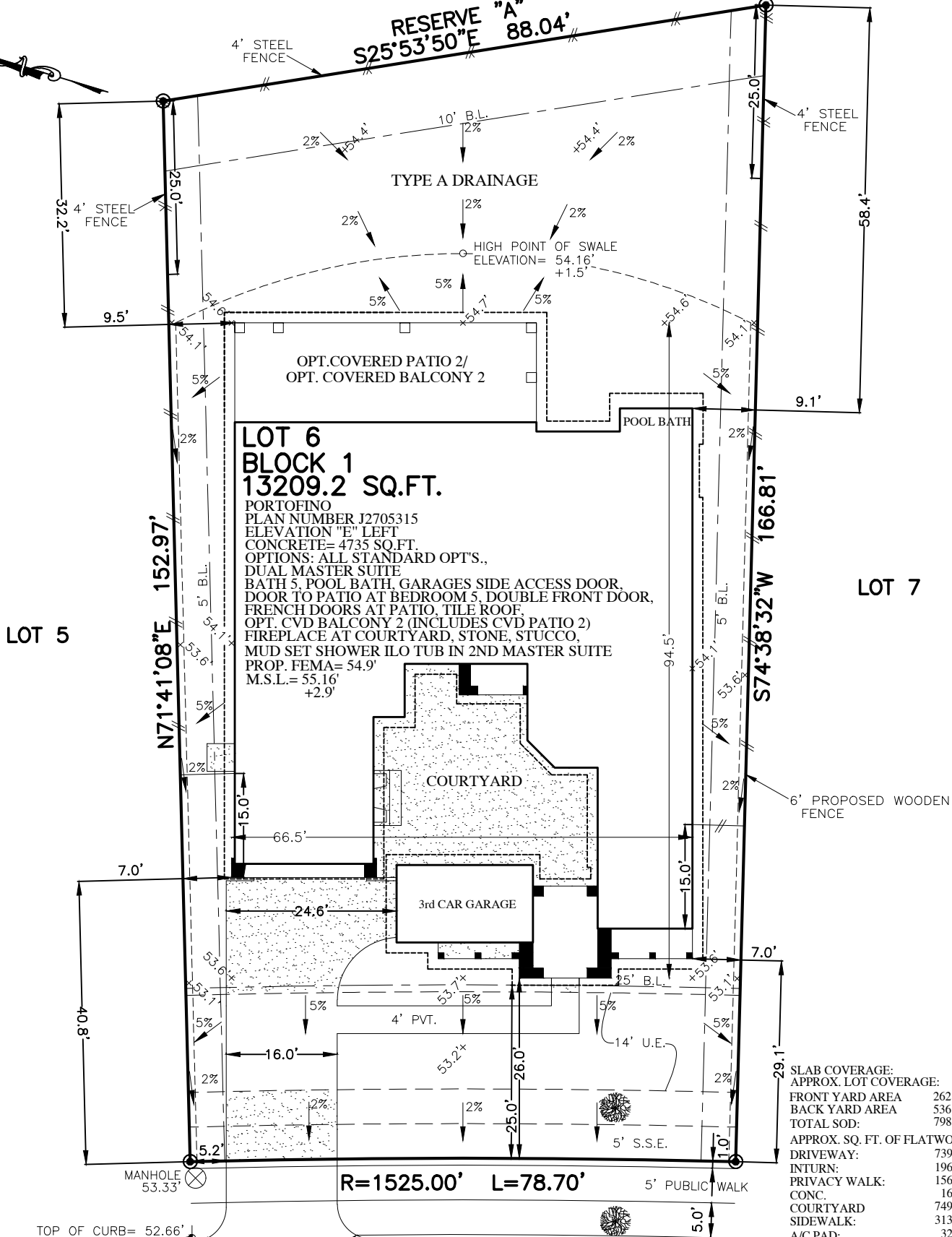

FLATWORK	B.L. BUILDING LINE	U.E. UTILITY EASEMENT	A.E. AERIAL EASEMENT	⊗ LIGHT POLE
PROPERTY LINE	G.B.L. GARAGE BUILDING LINE	W.L.E. WATER LINE EASEMENT	D.E. DRAINAGE EASEMENT	⊠ ELECTRIC BOX
BUILDING LINE	(B.G.) BUILDER GUIDELINES	S.S.E. SANITARY SEWER EASEMENT	E.E. ELECTRIC EASEMENT	⊖ FIBER OPTIC
EASEMENT	F.F. FINISHED FLOOR	STM.S.E. STORM SEWER EASEMENT	○ WATER VALVE	⊕ TELEPHONE PEDESTAL
WOODEN FENCE	EXT. EXTENDED	P.A.E. PRIVATE ACCESS EASEMENT	○ FIRE HYDRANT	⊠ PAD MOUNTED TRANSFORMER
WROUGHT IRON FENCE	R.O.W. RIGHT-OF-WAY	P.U.E. PRIVATE UTILITY EASEMENT	● MONUMENT	⊗ MANHOLE
CHAIN LINK FENCE	T.O.F. TOP OF FORM	PVT. PRIVATE	● IRON ROD	⊗ MANHOLE & INLET
OVERHEAD ELECTRIC	ELEV. ELEVATION	FND. FOUND	● IRON PIPE	○ INLET



13327
ARBOR VILLA LANE (PVT.)
(50' P.A.E./P.U.E.)
PLOT PLAN
 SCALE: 1 = 20'

SLAB COVERAGE:	35.85%
APPROX. LOT COVERAGE:	48.66%
FRONT YARD AREA	262 SQ. YDS.
BACK YARD AREA	536 SQ. YDS.
TOTAL SOD:	798 SQ. YDS.
APPROX. SQ. FT. OF FLATWORK:	
DRIVEWAY:	739 SQ. FT.
INTURN:	196 SQ. FT.
PRIVACY WALK:	156 SQ. FT.
CONC.	16 SQ. FT.
COURTYARD	749 SQ. FT.
SIDEWALK:	313 SQ. FT.
A/C PAD:	32 SQ. FT.
TOTAL FLATWORK:	2201 SQ. FT.
FENCE:	
REAR:	88 LIN. FT.
LEFT:	97 LIN. FT.
RIGHT:	118 LIN. FT.
FRONT LEFT:	8 LIN. FT.
FRONT RIGHT:	8 LIN. FT.
TOTAL FENCE:	319 LIN. FT.

-COMMUNITY APPROVED TREE. PLACEMENT FOR VISUAL REPRESENTATION ONLY. PLACEMENT MAY VARY.

ALL FENCES 6' TALL. ALL FLATWORK IS CONCRETE. THIS PLOT PLAN ADHERES TO THE CITY OF HOUSTON GUIDELINES FOR RESIDENTIAL FOUNDATION ELEVATION FOR SANITARY AND STORM DRAINAGE(DWG. No. 12-01-R).

NOTES:
 1. ALL BEARINGS SHOWN HEREON ARE BASED ON THE RECORDED PLAT.
 2. SURVEYOR HAS NOT ABSTRACTED THE SUBJECT PROPERTY. ABSTRACTING BY TITLE COMPANY ONLY. ALL EASEMENTS, RESTRICTIONS AND OTHER MATTERS OF RECORD KNOWN TO SURVEYOR ARE SHOWN AND ARE BASED ON THE RECORDED PLAT AND/OR TITLE REPORT. ALLPOINTS LAND SURVEY, INC. IS NOT LIABLE FOR ANY DAMAGES DUE TO INFORMATION NOT PROVIDED TO SURVEYOR OR BUILDER PLACING ANY IMPROVEMENTS WITHIN A BUILDING LINE OR EASEMENT.
 3. FLATWORK AND FENCING ARE FOR ILLUSTRATION PURPOSES ONLY. REFER TO MUNICIPALITY, HOA, POA, BUILDER GUIDELINES, DEED RESTRICTIONS OR LOCAL CODE FOR REQUIREMENTS. SPECIFIC INSTALLATION REQUIREMENTS TO BE VERIFIED BY BUILDER.
 4. DRAINAGE TYPE DETERMINED WITHOUT BENEFIT OF DRAINAGE PLANS.

FOR: TAYLOR MORRISON HOMES
ADDRESS: 13327 ARBOR VILLA LANE
ALLPOINTS JOB#: TM168262 BY: ARM
G.F.: YF
JOB: AW

LOT 6, BLOCK 1,
STILLWATER ON LAKE HOUSTON, SECTION 3,
FILM CODE NO. 675804, MAP RECORDS,
HARRIS COUNTY, TEXAS



FLOOD ZONE: X/X SHADED
COMMUNITY PANEL: 48201C0510L
EFFECTIVE DATE: 6/18/2007
LOMR: 16-06-4440A DATE: 11/8/2016
<small>"THIS INFORMATION IS BASED ON GRAPHIC PLOTTING. WE DO NOT ASSUME RESPONSIBILITY FOR EXACT DETERMINATION"</small>

ISSUE DATE: 1/21/2019
 ISSUE DATE: 11/27/2018
 ISSUE DATE: 10/26/2018

©2019, ALLPOINTS LAND SURVEY, INC.
 All Rights Reserved.