

FIRM REGISTRATION NO. 10156700

P.O. BOX 3344, LAKE JACKSON, TEXAS. 77566 (979) 299-3373

# Surveying & Mapping, LLC

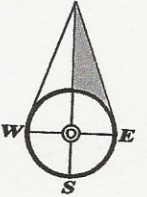

LOT 19

FOUND 5/8" IRON ROD

75.00'

LOT 20

N 83° 03' 18" E - 125.00'

FOUND 5/8" IRON ROD

**TURBERRY DRIVE**  
(60' R.O.W., VOL. 14, PG. 65, P.R.B.C.)

FOUND 5/8" IRON ROD

N 06° 56' 42" W - 75.00'  
[REFERENCE BEARING]

10' U.E.

25' B.L.

**BLOCK 31**  
**LOT 21**

5' B.L.  
S 06° 56' 42" E - 75.00'

50' TEXAS EASTMAN PIPELINE EASEMENT

1-STORY  
BRICK & FRAME  
RESIDENCE ON SLAB

FOUND 5/8" IRON ROD

S 83° 03' 18" W - 125.00'

FOUND 5/8" IRON ROD

LOT 22

FOUND 5/8" IRON ROD PC

54.99'

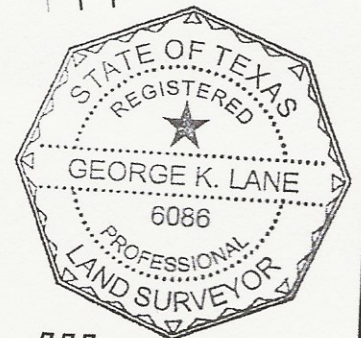

LOT 21, BLOCK 31

## COLUMBIA LAKES S/D, SEC. III

COMMUNITY NO: 485458 PANEL NO: 0395 SUFFIX: H ZONE: \*X BASE: N/A MAP REVISED: 06/05/89

I have consulted the HUD-FIA Flood Hazard Boundary Map in the above described property and it IS NOT in a designated flood hazard area. The plat hereon is a true, correct and accurate representation of the property as determined by survey. The lines and dimensions of said property being as indicated by the plat; the size, location and type of buildings and improvements are as shown, all improvements being within the boundaries of the property and being shown.

NOTES:

- 1) BUILDING SET-BACK LINES AND EASEMENTS PER PLAT AND VOL. 1128, PG. 911 D.R.B.C.
- 2) REFERENCE BEARING BASED ON THE WEST LINE OF LOTS 19 THRU 22, BEING N 06° 56' 42" W.
- 3) \*SHADED ZONE X PER LOMR CASE NO. 12-06-1432P EFFECTIVE DATE 08-29-2013