



NOTICE OF INFORMATION FROM OTHER SOURCES

USE OF THIS FORM BY PERSONS WHO ARE NOT MEMBERS OF THE TEXAS ASSOCIATION OF REALTORS®, INC. IS NOT AUTHORIZED.
©Texas Association of REALTORS®, Inc. 2008

To: BUYER of 38 Cheshire Bend Dr. Sugar Land TX 77479

From: Keller Williams Realty SW (Broker)

Property Address: 38 Cheshire Bend Dr, Sugar Land, TX 77479-2856

Date: March 3, 2020

(1) Broker obtained the attached information, identified as **Professional Measure Verification.**
Note this does not include the 'secret' (15x6) Sound-proof Recording (PodCast) Room and extra built out storage space on 3rd floor.
from **Homeowner**

(2) Broker has relied on the attached information and does not know and has no reason to know that the information is false or inaccurate except: _____

(3) **Broker does not warrant or guarantee the accuracy of the attached information. Do not rely on the attached information without verifying its accuracy.**

Keller Williams Realty SW

Broker

By: 
Marta Mohan

Receipt of this notice is acknowledged by:

Signature _____ Date _____
BUYER of 38 Cheshire Bend Dr. Sugar Land TX 77479

Signature _____ Date _____

Building Sketch (Page - 1)

Borrower					
Property Address 38 Cheshire Bend Dr					
City Sugar Land		County Fort Bend		State TX Zip Code 77479-2856	
Lender/Client					

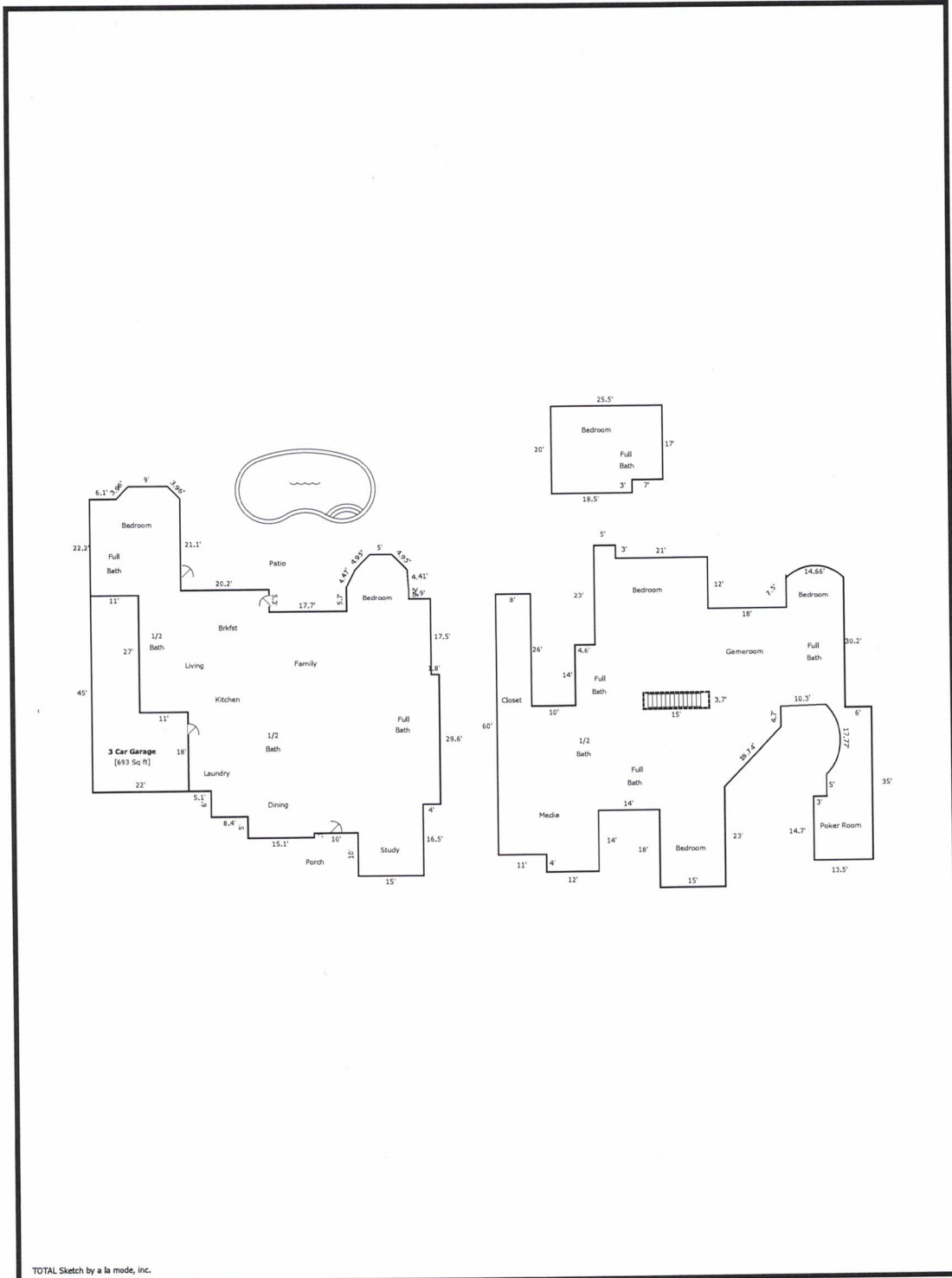

TOTAL Sketch by a la mode, inc.

Building Sketch (Page - 2)

Borrower				
Property Address 38 Cheshire Bend Dr				
City	Sugar Land	County	Fort Bend	State TX Zip Code 77479-2856
Lender/Client				

TOTAL Sketch by a la mode, inc.

Area Calculations Summary

Living Area	Area	Calculation Details
First Floor	4022.82 Sq ft	0.5 x 2.8 x 2.8 = 3.92 0.5 x 2.8 x 2.8 = 3.92 9 x 2.8 = 25.2 22.2 x 11 = 244.2 49.2 x 9.7 = 477.24 28.1 x 1.3 = 36.53 46.1 x 5.1 = 235.11 52.1 x 8.4 = 437.64 57.1 x 5.4 = 308.34 51.8 x 9.7 = 502.46 50.8 x 8 = 406.4 0.5 x 2 x 4 = 4 56.5 x 2 = 113 0.5 x 3.5 x 3.5 = 6.12 70.5 x 3.5 = 246.75 74 x 5 = 370 0.5 x 3.5 x 3.5 = 6.12 70.5 x 3.5 = 246.75 0.5 x 4.4 x 0.3 = 0.66 66.1 x 0.3 = 19.83 63.6 x 2.7 = 171.72 47.1 x 2.2 = 103.62 29.6 x 1.8 = 53.28
Second Floor	4317.48 Sq ft	60 x 8 = 480 34 x 3 = 102 38 x 7 = 266 52 x 4.6 = 239.2 75 x 0.4 = 30 61 x 4.6 = 280.6 58 x 9.4 = 545.2 76 x 11.6 = 881.6 64 x 3.4 = 217.6 0.5 x 13.5 x 13 = 87.75 27.5 x 13 = 357.5 0.5 x 0.05 x 1.6 = 0.04 22.75 x 1.6 = 36.41 0.5 x 0.25 x 8.7 = 1.1 29.5 x 8.7 = 256.65 14.7 x 3 = 44.1 65.2 x 4.5 = 293.4 35 x 6 = 210 Negative Arc = 36.49 Arc = 24.83
Open to Below	-55.5 Sq ft	15 x 3.7 = 55.5
Third Floor	489 Sq ft	20 x 18.5 = 370 7 x 17 = 119
Total Living Area (Rounded):	8774 Sq ft	
Non-living Area		
3 Car Garage	693 Sq ft	22 x 18 = 396 11 x 27 = 297