

22858 Banff Brook Way

② Floor Level for Pool/Spa/Lighting

Jan 2012

@ Floor Level for Pool/Spa/Lighting
↓
DAT

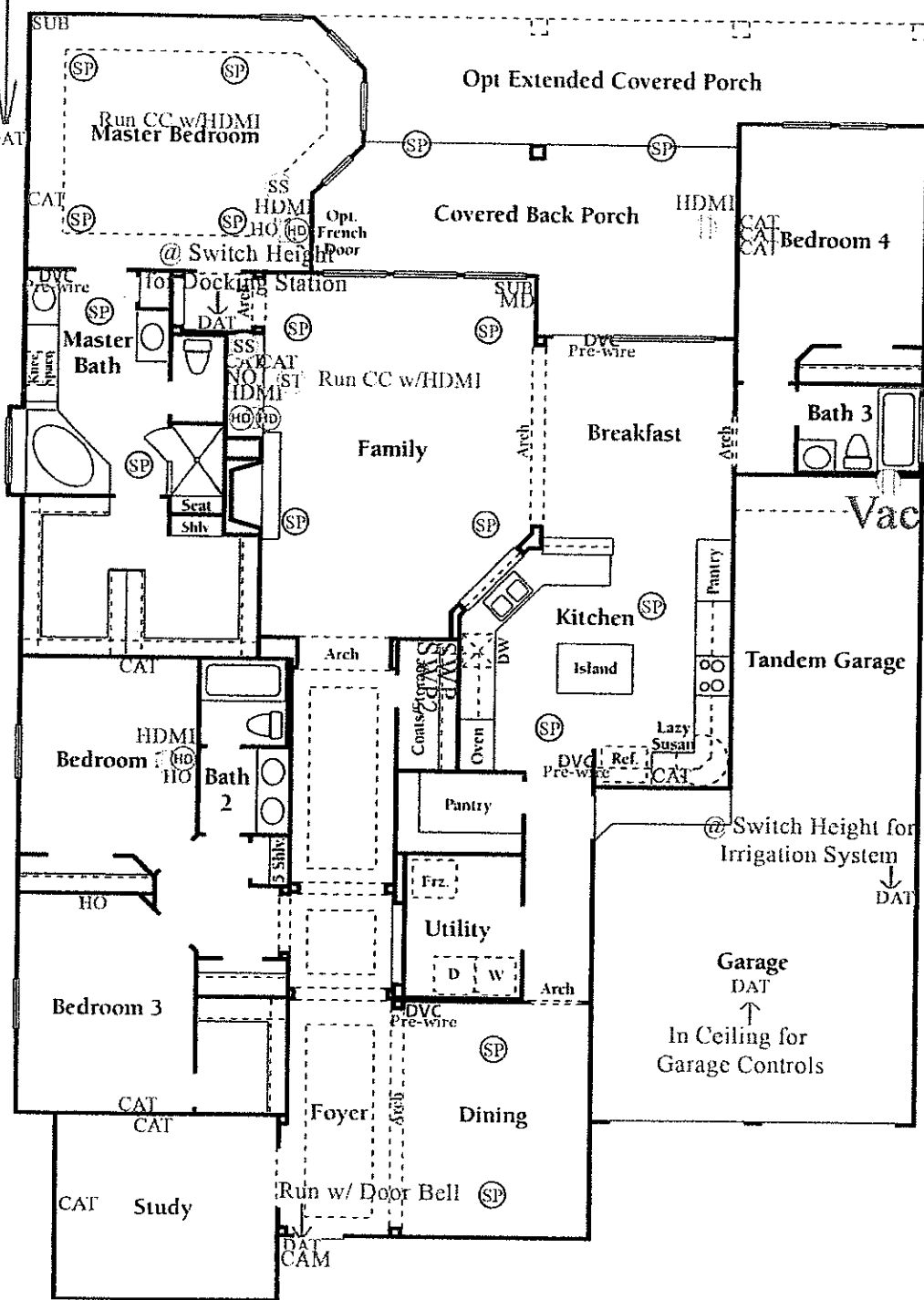

- TV - TV Location (1 RG6)
- CAT - Phone or DATA (1 CAT5e)
- ENT - Home Entertainment (1 CAT5e/ 2 RG6)
- HO - Home Outlet (2 CAT5e/1 RG6)
- UNV - Universal Outlet (2 CAT5e/2 RG6)
- NO - Network Outlet (3 CAT5e/ 1 RG6)
- SP - Speaker Prewire
- ⊙ - In-Ceiling Speaker
- ⊙ - In-Wall Speaker
- ⊙ - Atmos Speaker Prewire
- SUB - Subwoofer (1 RG6)
- ⊙ - Surround Sound Prewire Homerun
- DVC - Digital Volume Control **Prewire Only**
- ⊙ - Stereo Speaker Prewire Homerun (Must note if it is to be used for Non)
- HDMI - HDMI Bundle (2 HDMI/2 CAT5e Trimmed)(Conduit)
- ⊙ - HDMI Bundle Homerun Location
- PROJ - Projector Bundle (2 HDMI/ 2 CAT5e Trimmed)(Conduit)
- SWP - Structured Wiring Panel
- ⊙ - Projector Bundle Homerun
- ⊙ - Electrical Outlet (140 Volt)
- CAM - Camera Location
- NVR - Camera NVR Homerun
- C - Conduit (installed next to electrical)
- ⊙ - Conduit Homerun
- ⊙ - 5 Runs of Cat5e Bundled
- ⊙ - 5 Runs of Cat5e Homerun
- MD - Motion Detector
- KP - Keypad
- GB - Glass Break Detector
- LZ - Lighting Zone (1 Light switch)
- AP - Home Automation Panel Prewire
- WAP - Wireless Access Point Prewire (1 CAT5e)
- VAC - Central Vac Master Location
- INT - Intercom Station Prewire
- ⊙ - Intercom Master Unit
- ES - Rock Speaker
- IR - IR Control
- OH - Overhead Garage Switch
- HH - Hammer Height

- *Run single cat5 to all thermostat locations
- *2 Cat5 from SWP2 to attic
- *1 Conduit from SWP2 to attic
- * All (DAT*) marking run to SWP2

-All DAT and CAT to be CAT6
 -Duet Audio for Patio/Master Bath/Kitchen/Dining
 -Add-a-Surround to Family Room
 -Check for Hanging TV's