

DESIGNER INFORMATION



BUYER NAME	SHOWCASE HOME
QUOTE	28602
Plan	Chambray
ADDRESS	10342 Aldrin Dr.
COMMUNITY	Meridiana 50
DESIGNER	Laura Tyler
PHONE	281-664-7255
EMAIL	laurat@thedesigncenters.com
DATE	7/9/19
NOTES	

Division: Texas Houston - Homebuilding

Community: Meridiana 50

Lot Number: Lot 2 (690102)

Quote Number: Q-28602

Model: Chambray (Elevation: D)

Buyer:

Address: 10342 Aldrin Drive, Iowa Colony, TX, 77583

Swing: Right

Generated Date: 07/09/2019

Product Code	Name	Qty	List Unit Price	Total Price
(Order #: To Be Approved)				
<i>Category: Appliance Packages</i>				
GEAP0301	GE 30" Stainless Cooktop w/ Oven below/Micro above Appliance Package	1.00	\$800.00	\$800.00
<i>Category: Bath 2</i>				
B2CB0002	Bath 2 Level 1	1.00	\$23.00	\$23.00
	<i>Style - Tahoe Cherry</i>	<i>1</i>		
	<i>Finish - Slate</i>			
<i>Category: Bath 3</i>				
B3CB0002	Bath 3 Level 1	1.00	\$52.00	\$52.00
	<i>Style - Tahoe Cherry</i>	<i>1</i>		
	<i>Finish - Slate</i>			
<i>Category: Bath Hardware</i>				
HDBH0002	Taymor Bath Hardware - select finish to match plumbing	1.00	\$0.00	\$0.00
	<i>Finish - Chrome</i>	<i>1</i>		
<i>Category: Blinds</i>				
WNDW0001	Window Treatment Pre-Bill	1.00	\$1,135.00	\$1,135.00

Notes - See VEO Report for Selections

I

Category: Flooring

CARP0001	Carpet Pre-Bill	1.00	\$1,158.00	\$1,158.00
	Notes - See VEO Report for Selections	I		
TILE0001	Tile Pre-Bill	1.00	\$12,395.00	\$12,395.00
	Notes - See VEO Report for Selections	I		

Category: Kitchen Faucets

FXKT0202	Kitchen Faucet - Arbor - SS - 7594SRS	1.00	\$150.00	\$150.00
----------	---------------------------------------	------	----------	----------

Category: Kitchen Granite

CTOP0001	Countertop Pre-Bill	1.00	\$4,317.00	\$4,317.00
	Notes - See VEO Report for Selections	I		

Category: Master Bath

MCAB0002	Master Bath Level 1 (note high or low knee space) high knee space	1.00	\$87.00	\$87.00
	Style - Tahoe Cherry	I		
	Finish - Slate			

Category: Opt Gourmet Kitchen

KCAB1001	Gourmet Kitchen #1 w/30" cooktop level 1 w/island	1.00	\$830.00	\$830.00
	Style - Tahoe Cherry	I		
	Finish - Slate			

Category: Shower Enclosures

SHBF0001	Master Bath - Chrome Shower Door Frame	1.00	\$0.00	\$0.00
----------	--	------	--------	--------

Category: Water Systems

WTRS0001	Single Stage/P-DWS-PB1	1.00	\$0.00	\$0.00
WTRS0009	Classic Satin Nickel/P-CSPSI-SN	1.00	\$0.00	\$0.00

(Order #: 1)

Category: Bathroom Options

OWNB0110	Opt Slide-in Tub with Tile Mud-set Shower Floor @ Owner's Bath	1.00	\$2,925.00	\$2,925.00
----------	---	------	------------	------------

Category: Bedroom Options

OWNS0012	Opt. Extended Owner's Suite	1.00	\$5,995.00	\$5,995.00
----------	-----------------------------	------	------------	------------

Category: Color Scheme

CLSS0005	Stucco Exterior Color Scheme #5 - Trim & Garage-SW 7022 Alpaca, Stucco-SW 9166 Drift of Mist, Shutters-SW 9164 Illusive Green	1.00	\$0.00	\$0.00
----------	---	------	--------	--------

Category: Custom

ENGY0001	Energy Seal (Phase 2)	1.00	\$0.00	\$0.00
----------	-----------------------	------	--------	--------

Category: Door Options (Structural)

TRIM0015	8' Interior Doors Upgrade Including Back Door & only on 1st floor - Level 3 Specs (MUST SELECT WITH UPGRADE TO LEVEL 3 TRIM - TRIM0013)	1.00	\$2,150.00	\$2,150.00
----------	---	------	------------	------------

Category: Electrical

GDOR0001	Garage Door Opener (per door)	1.00	\$395.00	\$395.00
----------	-------------------------------	------	----------	----------

Category: Exterior Options (Structural)

FDOP0001	8 Foot Single Front Door Option	1.00	\$850.00	\$850.00
----------	---------------------------------	------	----------	----------

Category: Front Doors

FRDW3620	**REQUIRES STRUCTURAL OPTION FDOP0001** 8' SQ. TOP 3/4 LITE (6 LITE) 36" WIDE	1.00	\$230.00	\$230.00
	MATERIAL - FINISH - MAHOGANY - WINTER WHITE	1		
	GLASS - DESIGN STYLE - CLEAR BEVELED			

Category: Garage Door

GDHW0002	Garage Door Decorative Hardware	1.00	\$65.00	\$65.00
----------	---------------------------------	------	---------	---------

Category: General Room Options

WDTK0001	Window Package Turnkey	1.00	\$0.00	\$0.00
GRMT1000	Gourmet Kitchen 1 - Cooktop with Vented Microwave with Oven Below- Must select and pay for corresponding appliance and cabinet options (GEAP0301, GEAP0302)	1.00	\$200.00	\$200.00
OWNE0010	Opt Bench at Owner's Entry - B&B / Hooks	1.00	\$2,175.00	\$2,175.00

Category: Interior Door Trim & Hardware

DRHW1209PKGG	Upgrade to Stratus Satin Nickel Knobs	1.00	\$0.00	\$0.00
--------------	---------------------------------------	------	--------	--------

Category: Interior Options (Structural)

TRAY5000	Opt Tray Ceiling @ Foyer	1.00	\$550.00	\$550.00
RSRC0001	Rounded Sheetrock Corners	1.00	\$570.00	\$570.00
TRAY7000	Opt 12" Pop-up Ceiling @ Gathering Room	1.00	\$1,295.00	\$1,295.00

Category: Interior Paint

PNTH0010	Paint - Base -Whole House Interior Walls & Ceiling	1.00	\$0.00	\$0.00
	Color - SW 7646 - First Star	1		
	Ceiling Color - Same as wall color			

Category: LVL 1 Fix - Master Bath

PFMB0101	Master Bath - Brantford - 4" - Chrome	1.00	\$0.00	\$0.00
----------	---------------------------------------	------	--------	--------

Category: LVL 1 Fix - Sec. Bath

PFSB0106	Sec. Bath - 1 Sink - Brantford - 4" - Chrome	2.00	\$0.00	\$0.00
----------	--	------	--------	--------

Category: Light Fixture Packages - Lvl 1

LTPK0101	Light Pkg - Jolie	1.00	\$0.00	\$0.00
	Finish - Brushed Nickel	1		

Category: Multiple Mechanicals

QUCK0001	Quick Flash Products	1.00	\$0.00	\$0.00
----------	----------------------	------	--------	--------

Category: Plumbing Accessories - Ground

PGAS0001	Gas Stub Out	1.00	\$375.00	\$375.00
----------	--------------	------	----------	----------

Category: Special Custom

PRST0001	Pre-Start Tasks	1.00	\$0.00	\$0.00
CMAD0000	Community Requirements	1.00	\$0.00	\$0.00

Category: Stone

EFST0004	Stone Level 4 (must select with stone front option)	1.00	\$1,183.00	\$1,183.00
	Color - Eastern Buff	1		
	Mortar - Khaki			

Category: Stucco Options

VNSC0010	Stucco ilo Siding @ Sides - First Floor Only	1.00	\$0.00	\$0.00
VNSC0020	Stucco ilo Siding @ Rear - First Floor Only	1.00	\$0.00	\$0.00

Category: Trim Color

PNTT0010	Paint - Base - Trim - Whole House	1.00	\$0.00	\$0.00
	Color - SW 7006 - Extra White	1		

Category: Windstorm Requirements

WTDI0110	Windstorm Requirements - TDI - 110 MPH	1.00	\$0.00	\$0.00
----------	--	------	--------	--------

(Order #: Cancelled)**Category: Kitchen Sinks**

SINK0007	Sink - 8" - SS - 50/50 Top Mount	1.00	\$0.00	\$0.00
----------	----------------------------------	------	--------	--------

Category: LVL 1 Fix - Powder Bath

PFPB0101	Powder Bath - Brantford - 4" - Chrome	1.00	\$0.00	\$0.00
----------	---------------------------------------	------	--------	--------

Category: Landscape

IRIG0000	Irrigation Sprinkler System - Includes Front and Back Yard	1.00	\$3,300.00	\$3,300.00
SODB0001	Backyard Sod	1.00	\$1,095.00	\$1,095.00

Sub Total	\$39,905.00
Lot Premium	\$1,500.00
Base Price	\$278,990.00
Option Total	\$39,905.00
Incentive Given	\$0.00
Total Purchase Price	\$320,395.00

This system-generated *Proposal* is provided to a prospective buyer and/or its Broker/Agent outside of and not made a part of the Purchase Agreement: (1) all information as of the date indicated remains subject to change at any time without notice or obligation; and (2) is for illustrative and informational purposes only for preliminary discussions for prospective buyer's convenience. No guarantee or representation is made or implied as to availability, manufacturer, style, size, color, number, pricing and other factors installed in the completed home and/or subject to applicable incentives (if any) affecting pricing, all of which Seller reserves the right to modify. Refer to the final executed: Purchase Agreement and its attached Addenda (inclusive of any post-purchase amendments thereto) and the specific Community's Standard Features List for complete details. Equal Housing Builder.



BUYER: 10342 Aldrin Dr spec	DESIGNER: Laura Tyler	SALES COUNSELOR: Other/Unknown	CATALOG DATE: 7/9/2019 12:15:28 PM	JOB NUMBER: Q#28602	
ADDRESS: 10342 Aldrin Dr	LOT / BLOCK:	COMMUNITY: Meridiana 50	SERIES: Series 5 (2)	PLAN: Chambray	ELEV: NA

Countertops

FABRICATED CTOPS



Master Bath, Bath 2,3 standard White Cultured Marble ctop

Area: Master Bath, Baths 2, and 3

Price: **\$0.00** (x) 1

Extended Price: **\$0.00**

- Opt Gourmet Kitchen 1 w/Cooktop/Island

Omega Stone Level 1



Countertop Color:
2cm Fin Omega Stone-Zebrino
Id: OOMS2CM/BO



Countertop Edge:
Bevel Edge - 1 1/2" - Stone (44)
Id: BES3



Sink:
Mirado 209 - Stainless Steel U/M Sink
Id: OPION802-9/1

Area Subtotal(s)

Opt Gourmet Kitchen 1 w/Cooktop/Island: **\$4,316.66**

FABRICATED CTOPSSUBTOTAL: **\$4,316.66**

Countertops Total: \$4,316.66

Flooring

CARPET

- All Carpeted Areas -A,B,C,D
- Dining/Opt Study Credit
- Ext Foyer Credit
- Gathering Credit

Opt Owners Suite Extension

Carpet Level 2



Carpet Color:
Challenger - 936 Silver Splendor
 Id: 1BP43B/936



Carpet Cushion:
Aspen 1/2" Deluxe Pad
 Id: 1423/1

Area Subtotal(s)

All Carpeted Areas -A,B,C,D: **\$1,608.22**
 Dining/Opt Study Credit: **(\$149.15)**
 Ext Foyer Credit: **(\$84.48)**
 Gathering Credit: **(\$292.02)**
 Opt Owners Suite Extension: **\$75.10**

CARPET SUBTOTAL: **\$1,157.67**

TILE

- Bath 2
- Dining
- Ext Foyer
- Foyer -A,B,C
- Gathering
- Hall off Bdrms
- Laundry
- Master Hall

Opt Gourmet Kitchen 1/Casual Dining • Owners Bath w/Opt Slide-In Tub • Owners Entry

Floor Tile Level 4



Tile Color:
Titus Hills 12x24 - TH01 Calcatta
 Id: 6TTH/TH01

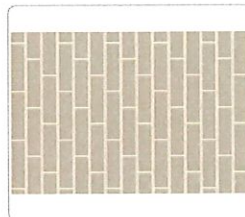

Pattern:
Rectangular Vertical Staggered (Front to Back)
 Id: 722

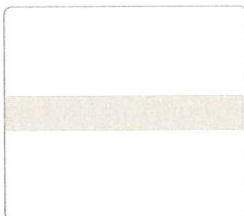

Grout Color:
TEC Power Grout - #949 Silverado
 Id: TTECPG/949

Area Subtotal(s)

Bath 2:	\$160.00
Dining:	\$1,498.31
Ext Foyer:	\$838.76
Foyer -A,B,C:	\$740.00
Gathering:	\$3,537.97
Hall off Bdrms:	\$363.02
Laundry:	\$340.01
Master Hall:	\$160.16
Opt Gourmet Kitchen 1/Casual Dining:	\$1,510.01
Owners Bath w/Opt Slide-In Tub:	\$485.00
Owners Entry:	\$300.00

• Bath 3

Floor Tile Level 4



Tile Color:
Avondale 12x12 - AD03 Castle Rock
Id: 6AV12/AD03

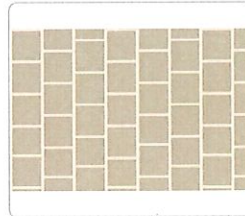

Pattern:
FL 43 Square Staggered Vertical (Front
to Back)
Id: 746

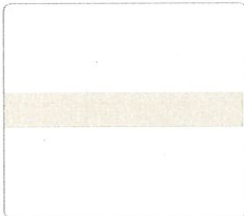

Grout Color:
TEC Power Grout - #949 Silverado
Id: TTECPG/949

Area Subtotal(s)

Bath 3: \$114.99

• Owners Bath Opt Shower Floor w/Opt Slide-In Tub

Floor Tile Level 4



Tile Color:
Titus Hills 12x24 - TH01 Calcatta
Id: 6TTH/TH01

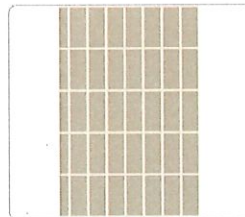

Pattern:
Straight Lay Rectangle Front to Back
Id: 737

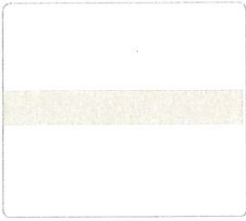

Grout Color:
 TEC Power Grout - #949 Silverado
 Id: TTECPG/949

Owners Bath Opt Shwer Floor w/Opt Slide-In Tub

↳ cut down to a 4x4

Area Subtotal(s)

Owners Bath Opt Shwer Floor w/Opt Slide-In Tub: **\$48.46**

TILE SUBTOTAL: **\$10,096.69**

Flooring Total: \$11,254.36

Paint

INTERIOR PAINT



Interior Standard Wall

Price: **\$0.00** (x) 1

Extended Price: **\$0.00**

↳ First Star



Standard Wall / Ceiling Colors

Price: **\$0.00** (x) 1

Extended Price: **\$0.00**

↳ first star



Standard Trim / House Color

Price: **\$0.00** (x) 1

Extended Price: **\$0.00**

↳ Extra White

INTERIOR PAINT SUBTOTAL: **\$0.00**

Paint Total: \$0.00

Walls

TILE

- Bath 2 Tub Splash
- Opt Owners Bath Garden Tub Splash
- Opt Owners Bath Shwr Stall w/Seat w/Slide-In Tub

Wall Tile Level 4

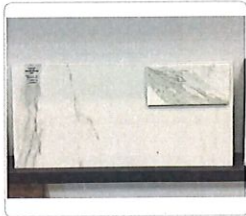

Tile Color:
Titus Hills 12x24 - TH01 Calcatta
 Id: 6TTH/TH01



Pattern:
S 67 Rectangular Staggered (Horizontal)
 Id: 715

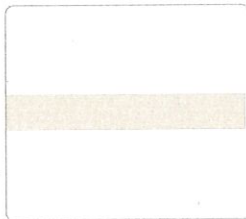

Grout Color:
TEC Power Grout - #949 Silverado
 Id: TTECPG/949

Area Subtotal(s)

Bath 2 Tub Splash: **\$345.00**
 Opt Owners Bath Garden Tub Splash: **\$75.00**
 Opt Owners Bath Shwr Stall w/Seat w/Slide-In Tub: **\$370.00**

- Bath 3 Tub Splash

Wall Tile Level 4



Tile Color:
Avondale 12x12 - AD03 Castle Rock
 Id: 6AV12/AD03

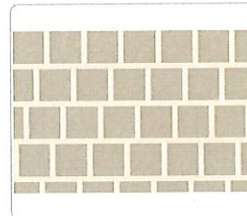

Pattern:
Square Staggered (Horizontal)
 Id: 724

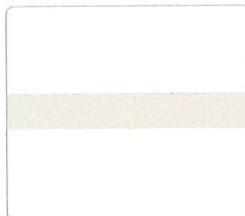

Grout Color:
TEC Power Grout - #949 Silverado
 Id: TTECPG/949

Area Subtotal(s)

Bath 3 Tub Splash: **\$345.00**

• Opt Gourmet Kitchen 1 Back Splash

Wall Tile Level 16



Tile Color:
Uptown Glass Hexagon Mosaic (12x12 Mesh) 1x1 - UP23 Carrara
 Id: 6UPG/UP23



Pattern:
Full Mosaic Horizontal
 Id: 780

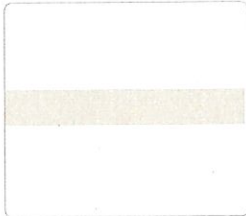

Grout Color:
TEC Power Grout - #949 Silverado
 Id: TTECPG/949

Area Subtotal(s)

Opt Gourmet Kitchen 1 Back Splash: **\$1,162.50**

TILE SUBTOTAL: **\$2,297.50**

Walls Total: \$2,297.50

Window Coverings

BLINDS & SHUTTERS

- Front Elevation D
- Owner Bath
- Sides & Rear

Cordless Capri

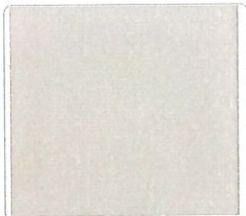

Blind Color:
Cordless 2" Capri - Designer White
 Id: BCordless02/DW

Area Subtotal(s)

Front Elevation D: **\$85.50**

Owner Bath: **\$47.50**

Sides & Rear: **\$1,002.25**

BLINDS & SHUTTERS SUBTOTAL: **\$1,135.25**

Window Coverings Total: \$1,135.25

ADDRESS: 10342 Aldrin Dr
BUYER: 10342 Aldrin Dr spec

INITIAL:

INITIAL:

EFFECTIVE DATE: 7/1/2019

PAGE: 7 of 7



Flooring

TILE

- Bath 2
- Dining
- Ext Foyer
- Foyer -A,B,C
- Gathering
- Hall off Bdrms
- Laundry
- Master Hall
- Opt Gourmet Kitchen 1/Casual Dining
- Owners Bath w/Opt Slide-In Tub
- Owners Entry

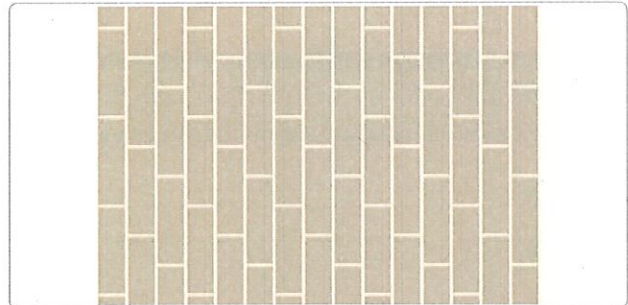

Tile Color: Titus Hills 12x24 - TH01 Calcatta

Id: 6TTH/TH01

Pattern: Rectangular Vertical Staggered (Front to Back)

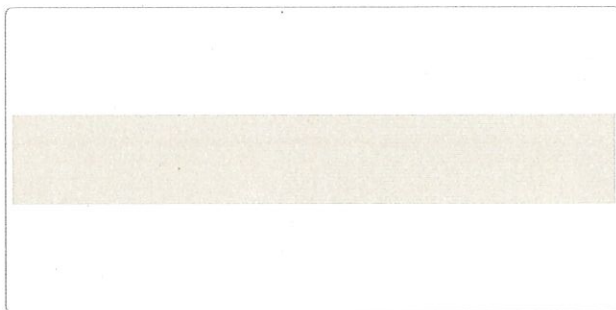

Grout Color: TEC Power Grout - #949 Silverado

Id: TTECPG/949

• Bath 3

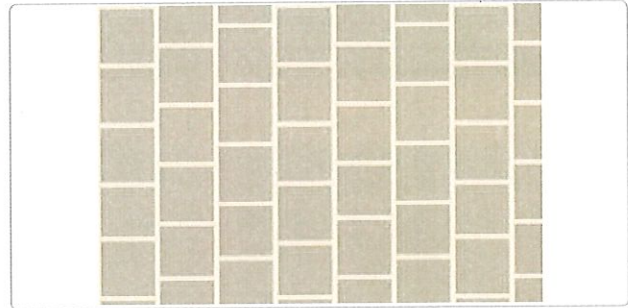

Tile Color: Avondale 12x12 - AD03 Castle Rock
Id: 6AV12/AD03

Pattern: FL 43 Square Staggered Vertical (Front to Back)

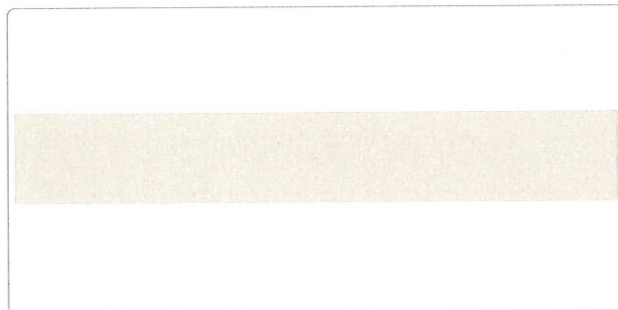

Grout Color: TEC Power Grout - #949 Silverado
Id: TTECPG/949

• Owners Bath Opt Shower Floor w/Opt Slide-In Tub

↳  cut down to a 4x4

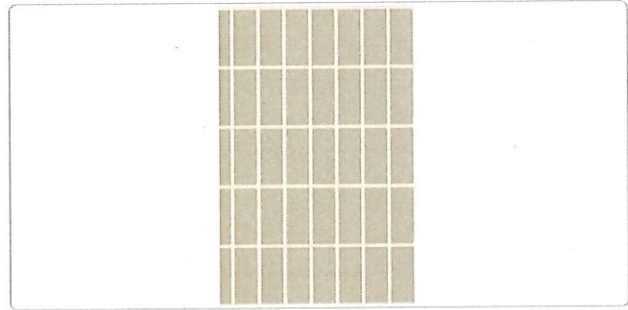

Tile Color: Titus Hills 12x24 - TH01 Calcatta
Id: 6TTH/TH01

Pattern: Straight Lay Rectangle Front to Back

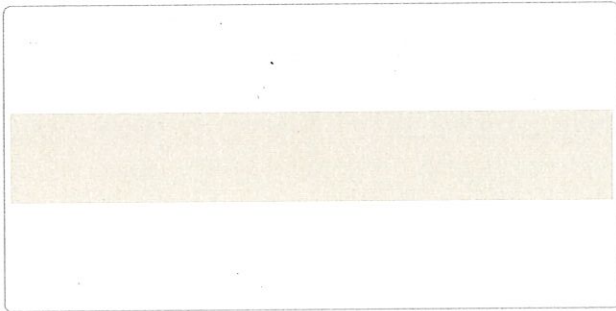

Grout Color: TEC Power Grout - #949 Silverado
Id: TTECPG/949

Walls

TILE

- Bath 2 Tub Splash
- Opt Owners Bath Garden Tub Splash
- Opt Owners Bath Shwr Stall w/Seat w/Slide-In Tub



Tile Color: Titus Hills 12x24 - TH01 Calcatta

Id: 6TTH/TH01

Pattern: S 67 Rectangular Staggered (Horizontal)

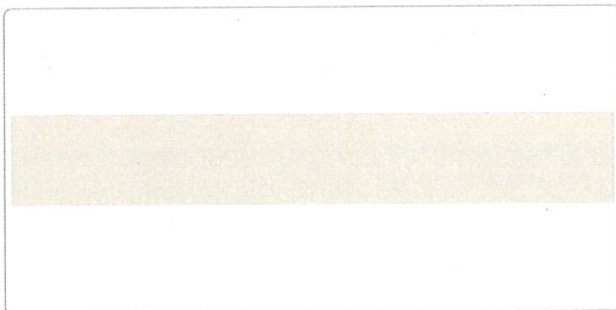

Grout Color: TEC Power Grout - #949 Silverado

Id: TTECPG/949

• Bath 3 Tub Splash



Tile Color: Avondale 12x12 - AD03 Castle Rock
Id: 6AV12/AD03

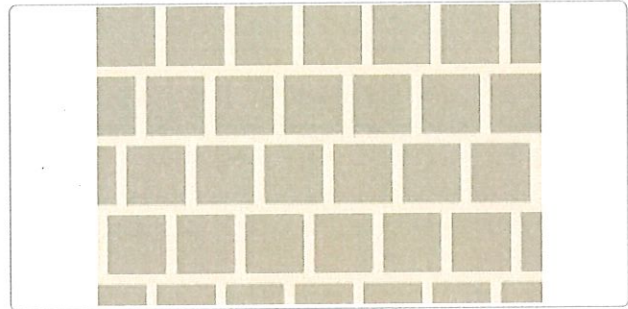

Pattern: Square Staggered (Horizontal)

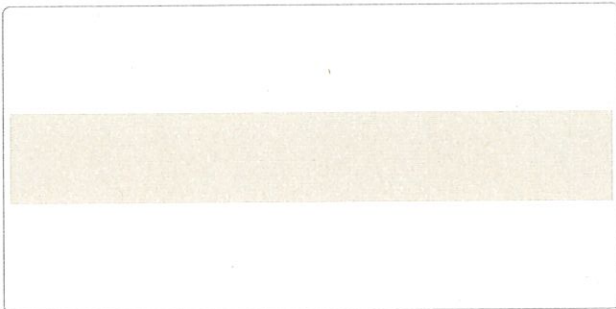

Grout Color: TEC Power Grout - #949 Silverado
Id: TTECPG/949

• Opt Gourmet Kitchen 1 Back Splash

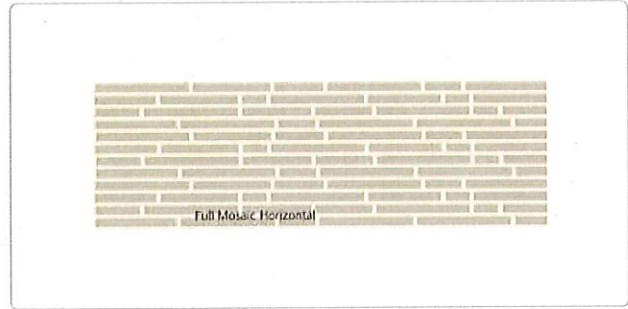

Tile Color: Uptown Glass Hexagon Mosaic (12x12 Mesh) 1x1 -
UP23 Carrara
Id: 6UPG/UP23

Pattern: Full Mosaic Horizontal



Grout Color: TEC Power Grout - #949 Silverado
Id: TTECPG/949



Buyer Selections Summary

Taylor Morrison - Houston - 7/9/2019 2:37:10 PM

BUYER: 10342 Aldrin Dr spec	DESIGNER: Laura Tyler	SALES COUNSELOR: Other/Unknown	CATALOG DATE: 7/9/2019 12:15:28 PM	JOB NUMBER: Q#28602
---------------------------------------	---------------------------------	--	--	-------------------------------

ADDRESS: 10342 Aldrin Dr	LOT / BLOCK:	COMMUNITY: Meridiana 50	SERIES: Series 5 (2)	PLAN: Chambray	ELEV: NA
------------------------------------	---------------------	-----------------------------------	--------------------------------	--------------------------	--------------------

SELECTIONS SUMMARY

TOTAL: \$19,003.77

Countertops	\$4,316.66
Flooring	
↳ Carpet	\$1,157.67
↳ Tile	\$10,096.69
Paint	\$0.00
Walls	\$2,297.50
Window Coverings	\$1,135.25

Printed Name: _____ Signature: _____ Date: _____

Printed Name: _____ Signature: _____ Date: _____

Flooring Redline Report
 TAYLOR MORRISON HOU

Plan: Chambray
 Revision: 09/19/18 (01/31/18)

Q# 28602 / Meridian 50 / Series 5
 (2)
 10342 Aldrin Dr. / ELEV D

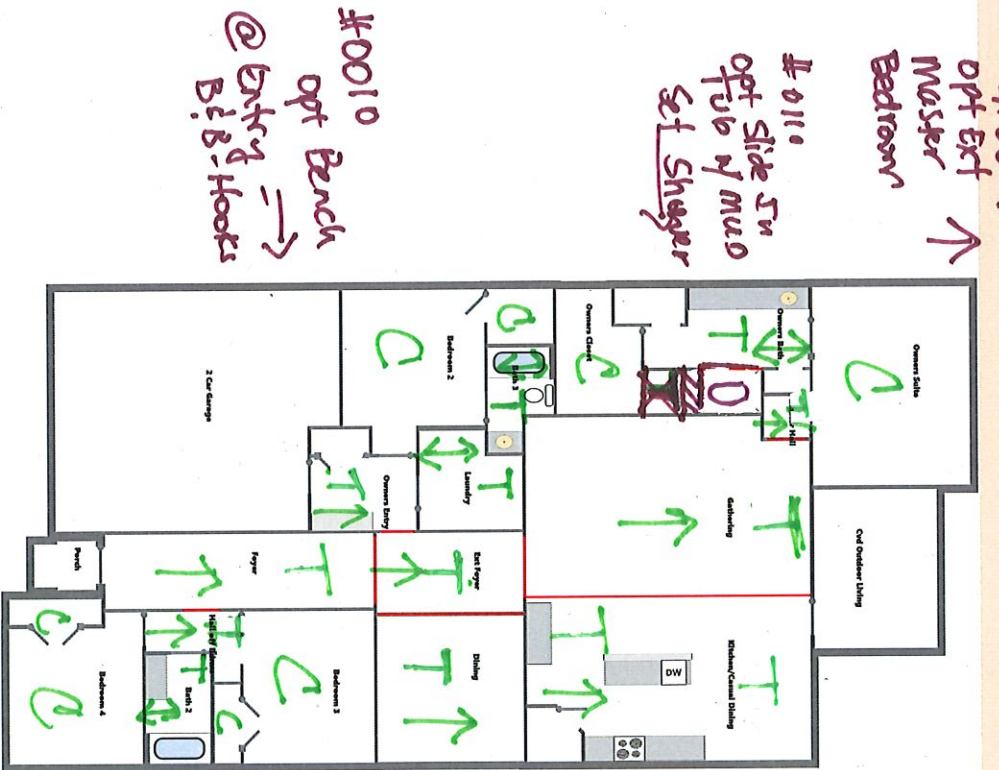

#0010
 Opt Bench
 @ Entry
 B & B Hooks

#0110
 Opt Slide TV
 Opt of mud
 Set Shager

#0012
 Opt Ext
 Master
 Bedroom

→ GK-1

C = Carpet
 T = Tile

Accepted By: _____ Date: _____

FAX:
PHONE:

ADDRESS: 10342 Aldrin Dr.
BUILDER: Taylor Morrison

Builder Signature: _____

Put an "X" in each hole you DO NOT want.



Mirado 209

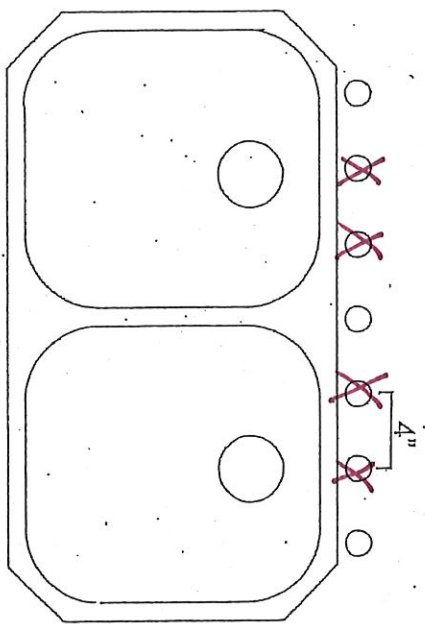

All Faucet Holes are drilled to 4" centers, unless otherwise specified.



GE APPLIANCES
a Haier company

OTR

GEAP-0301

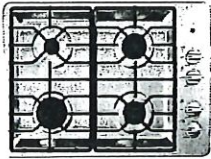

Model#: JGP3530SLSS
GE® 30" Built-In Gas Cooktop

Approx Dimensions (HxDxW):
4 3/4 in X 21 in X 30 in

- Fit Guarantee - Replacing a similar cooktop from GE or another brand? GE cooktops are guaranteed for an exact fit to make replacement easy.
- 18,000 BTU Power Boil burner - Boil water fast with intense heat from this 18,000 BTU burner
- Precise Simmer burner - Delicate foods don't burn with low, even heat
- Sealed cooktop burners - Contains spills and make cleaning quick and easy

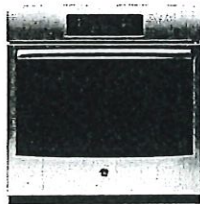

Model#: JT3000SFSS
GE® 30" Built-In Single Wall Oven

Approx Dimensions (HxDxW):
28 5/8 in X 26 3/4 in X 29 3/4 in

- Fit Guarantee - Replacing a similar wall oven from GE or another brand? GE wall ovens are guaranteed for an exact fit to make replacement easy.
- Self-clean with Steam Clean option - Clean your oven the way you want
- Self-clean, heavy-duty oven racks - Conveniently clean your oven and racks together
- Ten-pass bake element - Even baking is assured with heat that covers more surface area



Model#: GDF520PSJSS
GE® Dishwasher with Front Controls

Approx Dimensions (HxDxW):
34 in X 24 in X 23 3/4 in

- Piranha™ hard food disposer with removable filter - To ensure consistently clean items, this stainless steel blade rotates at 3,600 RPM to pulverize food particles and helps to prevent large particles from clogging the wash arms
- Steam PreWash - Loosens tough soils before any cycle, virtually eliminating the need for soaking or pre-rinsing dishes
- Sanitize option (NSF Certified) - High-temperature rinse sanitizes and reduces by 99.999% the bacteria found on dishes



Model#: JVM3162RJSS
GE® 1.6 Cu. Ft. Over-the-Range Microwave Oven

Approx Dimensions (HxDxW):
16 7/16 in X 15 7/8 in X 29 7/8 in

- 1.6 cu. ft. capacity - 950 Watts (IEC-705 test procedure)
- Convenience cooking controls - Operating made quick and easy
- Auto and time defrost - Defrosting times and power levels are programmed automatically or manually for optimal results
- Turntable On/Off - Controls turntable operation

JGP3530DL/SL

GE® 30" Built-In Gas Cooktop

DIMENSIONS AND INSTALLATION INFORMATION

AGA REQUIREMENT: All gas cooktop models require 7/16" free area below cooktop height to combustible material. Requires 18" minimum from countertop to adjacent overhead cabinets.

NOTE: If installing with a GE Profile™ Telescopic Downdraft System, consult both cooktop and downdraft installation instructions packed with product before installing. Cooktop gas/electric supply may need to be re-routed to install downdraft.

ELECTRICAL RATING: 120V, 60Hz, 5A

INSTALLATION WITH SINGLE WALL OVEN INFORMATION:

30" Gas Cooktops are approved for use over select GE 27" and 30" Wall Ovens and Warming Drawers. 30" and 36" Gas cooktops are approved for use over select 30" Wall Ovens and Warming Drawers. Refer to cooktop and wall oven/warming drawer installation instructions packed with product for current dimensional data.

INSTALLATION INFORMATION: Before installing, consult installation instructions, packed with product, for current dimensional data.

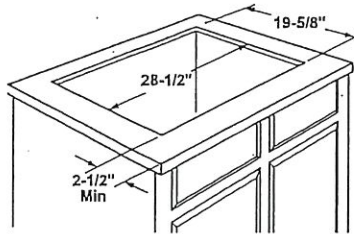
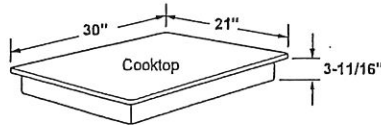

Gas Connection

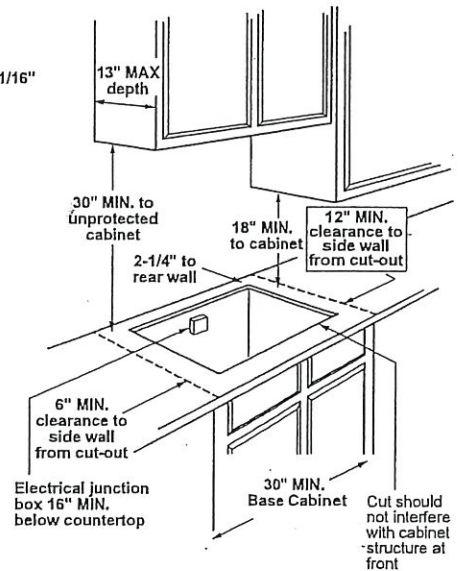
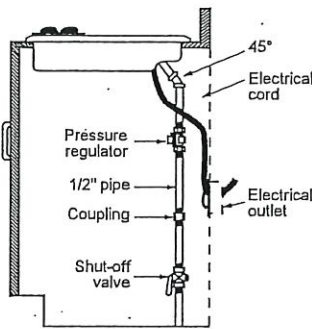

Dimension and installation information are shown in inches.
*Allow 5-3/4" depth at rear for electrical and gas connections



For answers to your Monogram, GE Café™ Series, GE Profile™ Series or GE Appliances product questions, visit our website at geappliances.com or call GE Answer Center® Service, 800.626.2000.



Specification Revised 10/17

TAYLOR MORRISON - HOUSTON
 SERIES 5 - PLAN CHAMBRAY
 G39105006 (2019-01)
 KITCHEN GOURMET #1 - 42 BI
 - 30" CKTOP
 - U/C OVEN

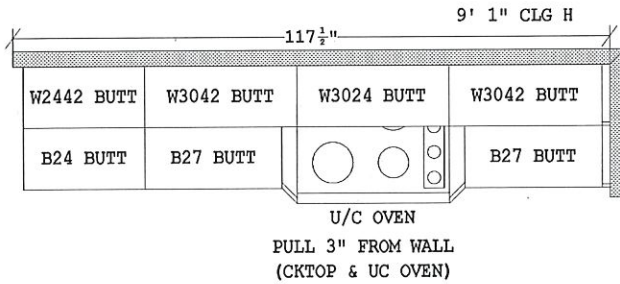

FILL ALL VOIDS
 & GAPS

AS / REV
 G - L

DOOR STYLE: _____

- PARTS:
- 2-UF3
 - 1-UF342
 - 1-UF642 (HORIZ)
 - 3-TCCM8 WD
 - 3-HWC 1X2X96
 - 5-SM8 BLD
 - 2-BTK8 PRT
 - 3-SHM8 BLD
 - 1-COVER CAP TAN
 - 2-FBF E3 (OVEN)
 - 1-FL36 (OVEN)
 - 2-UF642 (OVEN)
 - 1-SFRL (OVEN)
 - 1 SFRR (OVEN)
 - 1-FL24 (VOIDS)
 - 33-KNOBS (FOL)

PANTRY

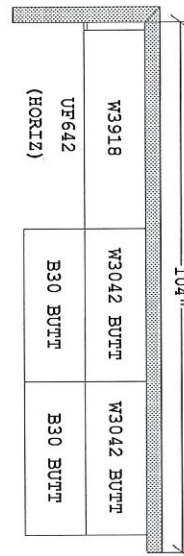

ISLAND
 DOOR STYLE: _____

- PARTS:
- 1-DWR3
 - 1-SM8 BLD
 - 1-BTK8 PRT
 - 2-SHM8 BLD
 - 1-UF3 (IF REQ'D)
 - 1-DDF FASTENER (SB36)
 - 4-KNOBS (FOL)

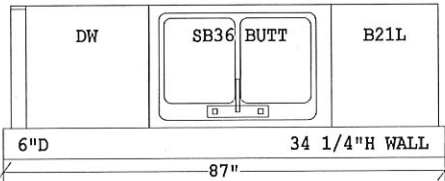

**IF GLAZE FINISH ADD
 (EXCEPT PAINTED MAPLE)
 2-BEP34 WD

**IF GLAZE FINISH ADD
 (EXCEPT PAINTED MAPLE)
 3-BEP34 WD
 4-WEP42 WD

This is an original design and must not be released or copied unless job order placed. FSR: _____ DATE: _____ Page _____ of _____		All dimensions .size designations given are subject to verification on job site and adjustment to fit job conditions. Designer: AZ CABS # _____	Designed: 01/07/19 Printed: 01/07/19
			REV 2
KIT GOURMET #1 - 42 BI WITH 30 CKTOP - UC OVEN		FLOORPLAN	Drawing #: 1
			Scale : 0 7/16" = 1'

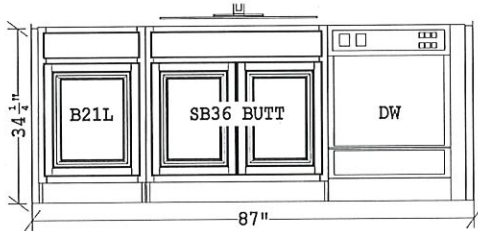
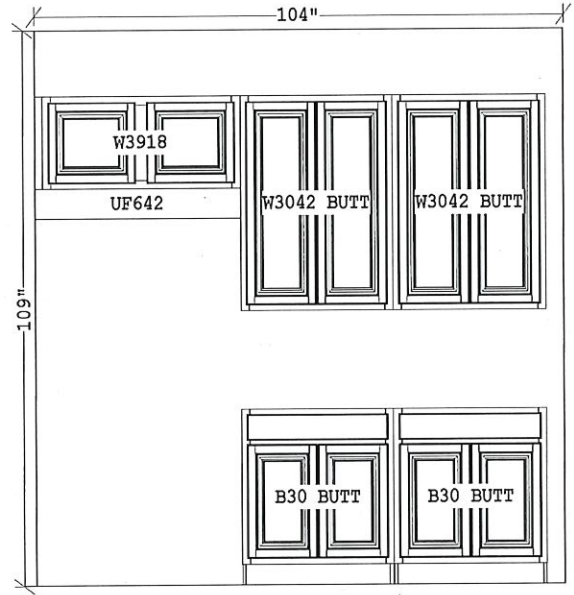
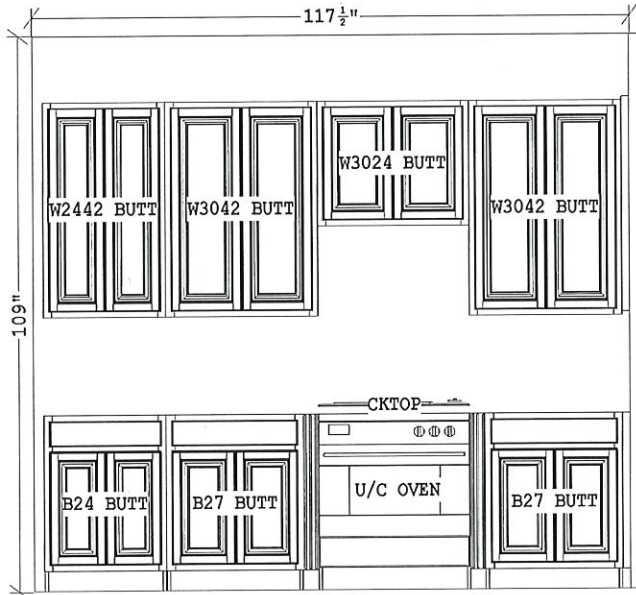

This is an original design and must not be released or copied unless job order placed. FSR: _____ DATE: _____ Page ____ of ____	TIMBERLAKE <small>CABINERY</small>	All dimensions .size designations given are subject to verification on job site and adjustment to fit job conditions. Designer: AZ CABS # _____	Designed: 01/07/19 Printed: 01/07/19
			REV 2
KIT GOURMET #1 - 42 BI WITH 30 CKTOP - UC OVEN		ELEVATION	Drawing #: 1 Scale : 0 7/16" = 1'

TAYLOR MORRISON - HOUSTON
 SERIES 5 - PLAN CHAMBRAY
 G39105006 (2019-01)
 OWNER'S BATH

AS / REV
 G - L

DOOR STYLE: _____
 PARTS:
 2-UF3
 2-SM8 BLD
 1-BTK8 PRT
 2-SHM8 BLD
 1-HWC 1X2X96 (IF REQ'D)
 6-KNOBS (FOL)

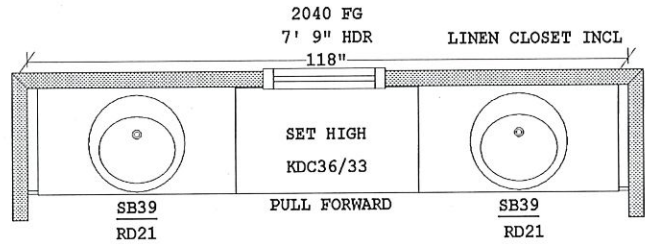
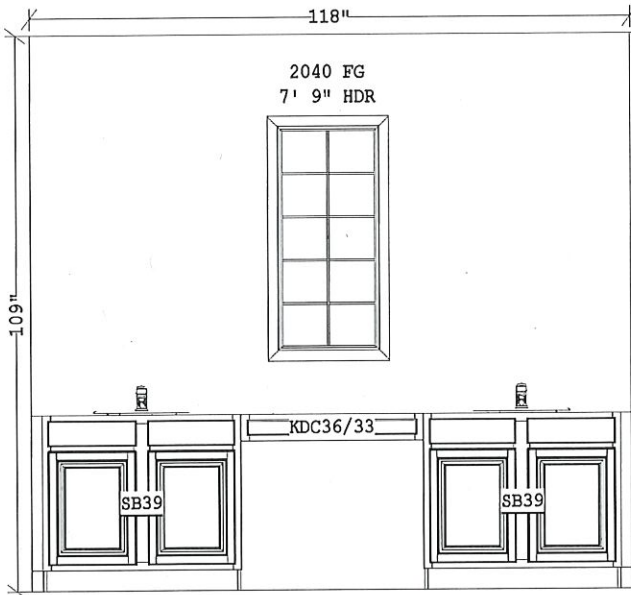

↑ High Knee space

OWNER'S BATH
~~OWNER'S BATH OPT - SHOWER 1~~
OWNER'S BATH OPT - SLIDE IN TUB
~~OWNER'S BATH OPT - WALK IN SHOWER~~

This is an original design and must not be released or copied unless job order placed. FSR: _____ DATE: _____ Page _____ of _____	TIMBERLAKE <small>CABINETS</small>	All dimensions size designations given are subject to verification on job site and adjustment to fit job conditions. Designer: AZ CABS # _____	Designed: 01/08/19 Printed: 01/08/19
			REV 2
OWNER'S BATH	FLOORPLAN	Drawing #: 1	Scale : 0 7/16" = 1'

TAYLOR MORRISON - HOUSTON
 SERIES 5 - PLAN CHAMBRAY
 G39105006 (2019-01)
 SECONDARY BATHS

AS / REV
 G - I

-BATH 2
 -BATH 2 OPT - SHOWER
 DOOR STYLE: _____
 PARTS:
 1-UF3
 1-BTK8 PRT
 1-SHM8 BLD
 1-SM8 BLD
 5-KNOBS (FOL)

-BATH 3
 -BATH 3 OPT - SHOWER
 DOOR STYLE: _____
 PARTS:
 2-UF3
 1-BTK8 PRT
 1-SHM8 BLD
 1-SM8 BLD
 2-KNOBS (FOL)

-BATH 4 OPT - 2ND FLOOR
 -BATH 4 OPT - SHOWER
 DOOR STYLE: _____
 PARTS:
 1-UF3
 1-BTK8 PRT
 1-SHM8 BLD
 1-SM8 BLD
 2-KNOBS (FOL)

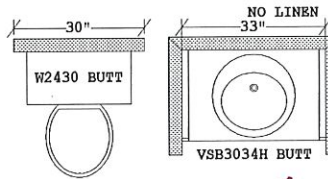
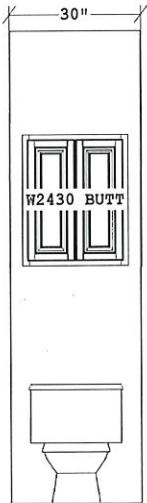
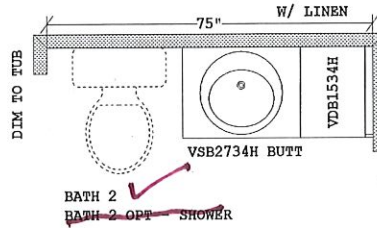
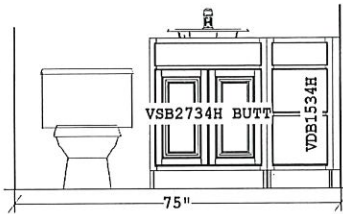

LINEN PARTS:
 1-SM8 BLD
 1-TCCMB WD
 1-HWC 1X2X96
 2-KNOBS (FOL)

BATH 3 ✓
~~BATH 3 OPT - SHOWER~~

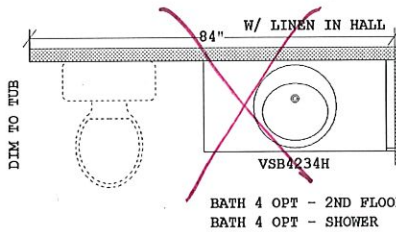
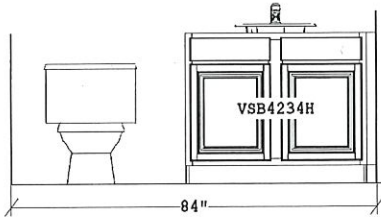
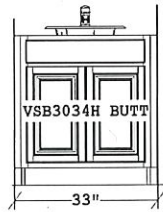

This is an original design and must not be released or copied unless job order placed.

FSR: _____ DATE: _____

Page _____ of _____

TIMBERLAKE
 CABINETS

All dimensions size designations given are subject to verification on job site and adjustment to fit job conditions.

Designer: AZ CABS # _____

Designed: 01/08/19
 Printed: 01/08/19

REV 2

SECONDARY BATHS

FLOORPLAN

Drawing #: 1

Scale : 0 3/8" = 1'

TAYLOR MORRISON - HOUSTON
 SERIES 5 - PLAN CHAMBRAY
 G39105006 (2019-01)
 LAUNDRY

AS / REV
 G - L

LAUNDRY
 - WALL CABS
 DR STYLE: _____
 PARTS:
 2-UF342
 1-SM8 BLD
 1-TCCM8 WD
 1-HWC 1X2X96
 4-KNOBS (FOL)

- BASE CABS
 DOOR STYLE: _____
 PARTS:
 3-UF3
 1-BTK8 PRT
 2-SHM8 BLD
 1-SM8 BLD
 9-KNOBS (FOL)

LAUNDRY OPT - 2ND FL
 -WALL CABS
 DR STYLE: _____
 PARTS:
 2-UF342
 1-SM8 BLD
 1-TCCM8 WD
 1-HWC 1X2X96
 4-KNOBS (FOL)

-BASE CABS
 DOOR STYLE: _____
 PARTS:
 2-UF3
 1-BTK8 PRT
 2-SHM8 BLD
 1-SM8 BLD
 7-KNOBS (FOL)

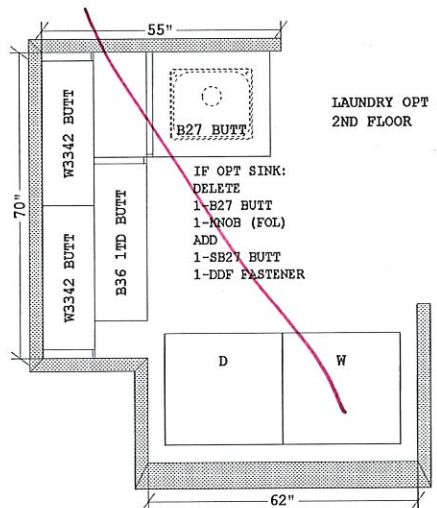
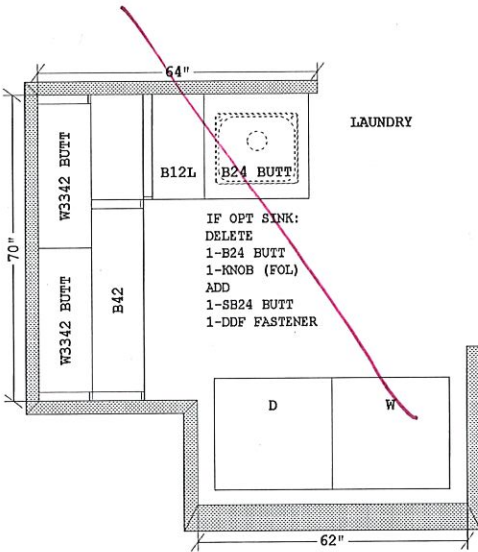

This is an original design and must not be released or copied unless job order placed.

FSR: _____ DATE: _____

Page _____ of _____

TIMBERLAKE
 CABINETS

All dimensions size designations given are subject to verification on job site and adjustment to fit job conditions.

Designer: AZ CABS # _____

Designed: 01/08/19
 Printed: 01/08/19

REV 2

LAUNDRY

FLOORPLAN

Drawing #: 1

Scale : 0 3/8" = 1'

TAYLOR MORRISON - HOUSTON
 SERIES 5 - PLAN CHAMBRAY
 G39105006 (2019-01)
 OWNER'S ENTRY
 AS / REV
 G - L

OWNER'S ENTRY OPT - BENCH
 - BENCH
 DOOR STYLE _____
 PARTS
 2-UF3
 1-UF680 (HORIZ)
 1-S3S696 (HOOK MOUNT)
 2-FP4896 GROOVED
 2-S3S396
 1-SHM8 BLD
 1-WTEP84 (BENCH)
 1-CTM8 WD (BENCH CAP)
 3-BM8 BLD (TRIM VDO)
 1-FL72 (PEDESTAL)
 2-HWC 2X4X96 (PEDESTAL)
 1-FL36 (VOIDS)
 2-SM8 BLD
 1-TCCM8 WD
 1-HWC 1X2X96
 5-HOOK (SN, CP OR VB)
 **IF GLAZE FINISH ADD
 (EXCEPT PAINTED MAPLE)
 2-BEP34 WD

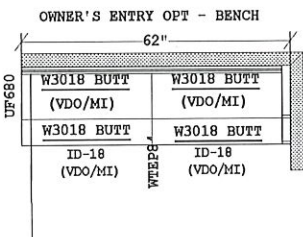

S3S696
 VERTICAL APPLICATION
 FOR HOOK MOUNT
 SPECIFY HOOK FINISH:
 SN, CP, OR VB

INSTALLATION NOTE:
 WTEP84
 BENCH SEAT
 BUILD UP W/
 HWC 2X4X96
 CAP W/
 CTM8 WD (1-5/8")

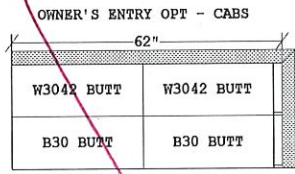

OPT - BUILT IN CABS
 -WALL CABS ONLY
 DOOR STYLE: _____
 PARTS:
 1-SM8 BLD
 1-UF342
 1-TCCM8 WD
 1-HWC 1X2X96
 4-KNOBS (FOL)
 **IF GLAZE FINISH ADD
 (EXCEPT PAINTED MAPLE)
 1-WEP42 WD
 -BASE CABS ONLY
 DOOR STYLE: _____
 PARTS:
 1-SM8 BLD
 1-UF3
 1-SHM8 BLD
 1-BTK8 PRT
 8-KNOBS (FOL)
 **IF GLAZE FINISH ADD
 (EXCEPT PAINTED MAPLE)
 1-BEP34 WD

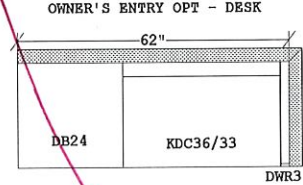

- OPT DESK
 DOORSTYLE _____
 PARTS
 1-DWR3
 2-UF3
 1-BTK8
 1-SHM8 BLD
 1-SM8 BLD
 1-HWC 1X2X96 (KDC CLEAR)
 6-KNOBS
 **IF GLAZE FINISH ADD
 (EXCEPT PAINTED MAPLE)
 3-BEP34 WD

This is an original design and must not be released or copied unless job order placed. FSR: _____ DATE: _____ Page _____ of _____		All dimensions size designations given are subject to verification on job site and adjustment to fit job conditions. Designer: AZ CABS # _____	Designed: 01/08/19 Printed: 01/08/19
			REV 2
OWNER'S ENTRY	FLOORPLAN	Drawing #: 1	Scale : 0 3/8" = 1'



OWNER'S ENTRY OPT - BENCH

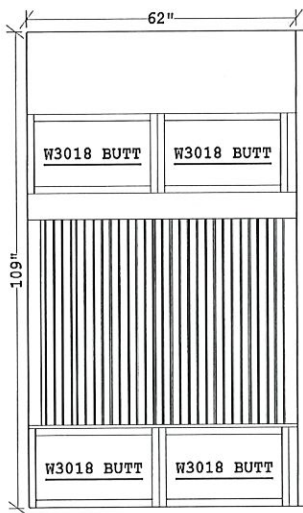

OWNER'S ENTRY OPT - CABS

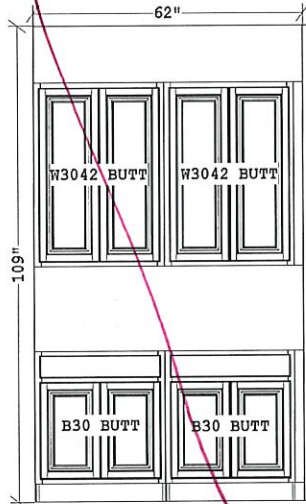

OWNER'S ENTRY OPT - DESK

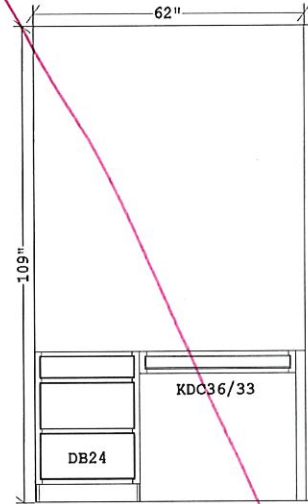

This is an original design and must not be released or copied unless job order placed.

FSR: _____ DATE: _____

Page _____ of _____

TIMBERLAKE
CABINETRY

All dimensions size designations given are subject to verification on job site and adjustment to fit job conditions.

Designer: AZ CABS # _____

Designed: 01/08/19

Printed: 01/08/19

REV 2

OWNER'S ENTRY

ELEVATION

Drawing #: 1

Scale : 0 3/8" = 1'

Paint Selections
No choice needed

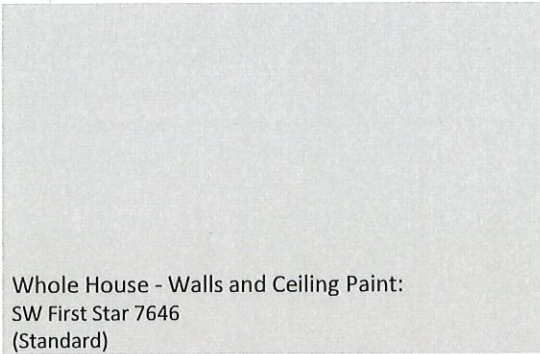

Whole House - Walls and Ceiling Paint:
SW First Star 7646
(Standard)

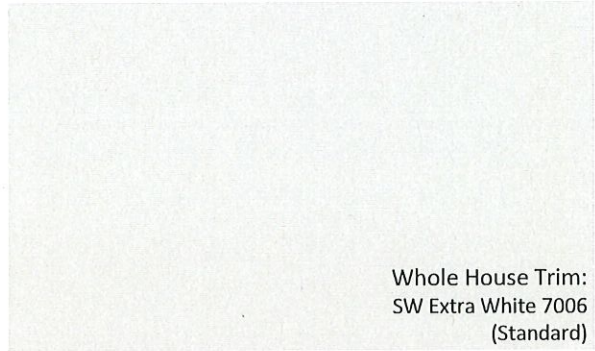

Whole House Trim:
SW Extra White 7006
(Standard)

Main Flooring
Choose Option 1, 2 or 3



Wood Floor Option 1
Engineered: Staffington
Stain: Iron Birch
(group 3 upgrade)



Rigid Core LVP Floor Option 3
Style: Radcliff
Color: Gray Waters
(group 3 upgrade)



Pattern: Laid Straight
(Standard)



Tile Floor Option 2
Style: Titus Hills
Color: Calacatta
Size: 12x24
(group 5 upgrade)
Grout 949 Silverado

Carpet Selections
No choice needed



Whole House Carpet:
Challenger - 936 Silver Splendor
(group 2 upgrade)

Cushion: Vegas (upgrade)

Interior Doors
No choice needed

Spec 1 Matrix

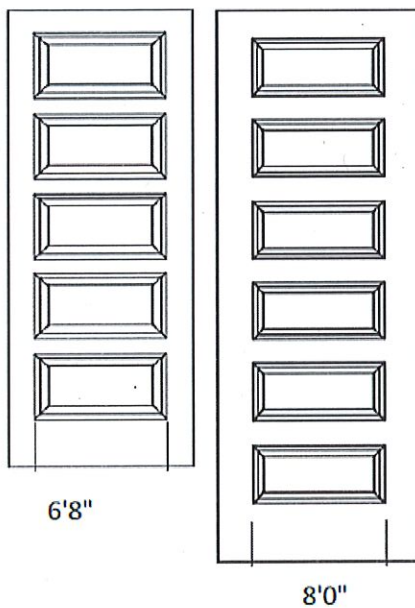

Door Hardware
No choice needed



Barcelona Handleset
Satin Nickel (Upgrade)



Stratus Knob
Satin (standard)

Kitchen Appliance Package
Choose Option 1, 2, or 3

- Option 1 (upgrade)
GEAP – 0201 – 0208
Slide-In Stainless Steel
4 Burner Range



Model#: JGB635REKSS
GE® 30" Free-Standing Gas
Range

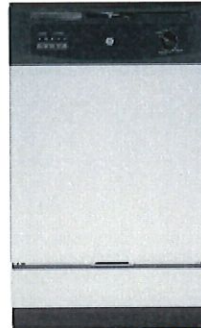

Model#: GSD3360KSS
GE® Built-In Dishwasher



Model#: JVM3162RJSS
GE® 1.6 Cu. Ft. Over-the-Range
Microwave Oven

- Option 2 (upgrade)
GEAP – 0301
Stainless Steel - 4 Burner Cooktop
With oven below cooktop & microwave above cooktop



Model#: JGP3530SLSS
GE® 30" Built-In Gas Cooktop



Model#: JT3000SFSS
GE® 30" Built-In Single Wall Oven

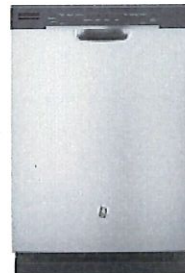

Model#: GDF520PSJSS
GE® Dishwasher with Front
Controls



Model#: JVM3162RJSS
GE® 1.6 Cu. Ft. Over-the-Range
Microwave Oven

- Option 3 (upgrade)
GEAP – 0401 – 0203
Stainless Steel - 4 Burner Cooktop

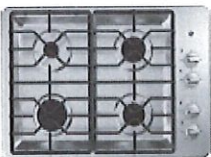

Model#: JGP3530SLSS
GE® 30" Built-In Gas Cooktop



Model#: JT3000SFSS
GE® 30" Built-In Single Wall Oven



Model#: GDF520PSJSS
GE® Dishwasher with Front
Controls

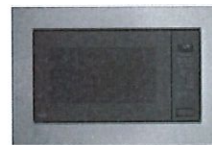

Model#: PEB7227SLSS
GE Profile™ Series 2.2 Cu. Ft.
Built-In Sensor Microwave Oven



Model#: J VX3300SJSS
GE® 30" Under The Cabinet Hood

Stair Selections
No choice needed

Newel Post: 3" Chamfered Top "V-Groove"
Newel and Handrail Stain: Sherwood Ebony SW #3232
Species: Red Oak
Caps & Risers: MDF Paint Grade

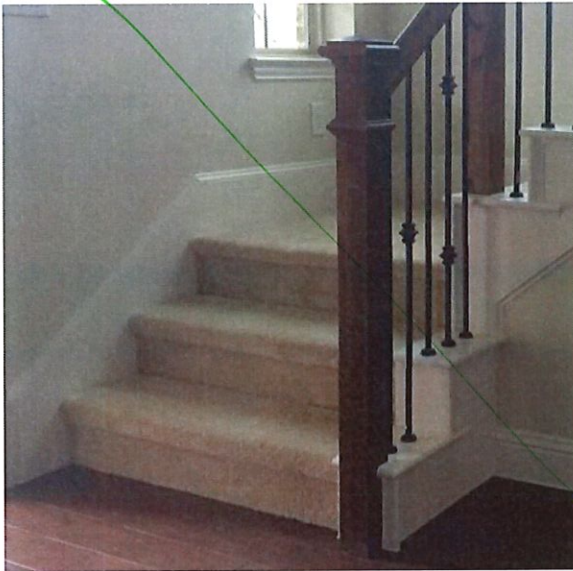
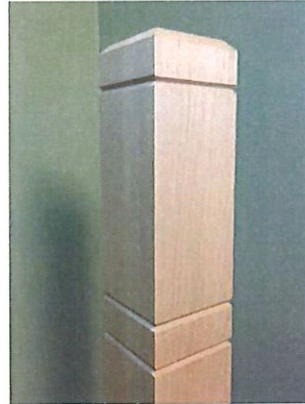

Staircase Flooring: Carpet (standard)
Challenger - 936 Silver Splendor (group 2 upgrade)

Cushion: Vegas

N/A



P-10A

Iron Balusters – P-10A (standard)
Finish: Satin Black

Lighting Package for Whole House
No choice needed

Jolie Lighting Collection
Nickel (Standard)



43639 NI
2-Story Entry (As Per Plan)
9-Light, 2-Tier, 100-W
W. 28", Hgt. 28",
Ovrll. 66"



43638 NI
Dining (As Per Plan)
5-Light, 100-W
W. 22", Hgt. 18.5",
Ovrll. 57"



9033 RZ
Coach Light (As Per Plan)
1-Light, 150-W
W. 8.25", H. 17.75", Ext. 11"



Bath Vanity(As Per Plan)
2-light, 3-Light, or 4-light 100-W



LED Low-Profile Downlight
Closets, Pantry, Hallway,
Bedrooms, Entry, Dining, etc.
(As Per Plan)
15-W, 850Lm, 90 CRI, 3000K
W. 7.5", H. 1.25"

Additional LED Disks
Choose only if option should be added

- (4) LED disks to Family Room
- (1) Switch to LED disks at Family Room (upgrade)

Ceiling Fans
Choose additional rooms for pre-wires and/or fans

Additional Ceiling Fan Selection
(Standard in Family)

- Master Bedroom
- Other (List): _____
- Other (List): _____



Additional Ceiling Fan Pre-Wire
(Standard in Family & Master Bedroom)

- Other (List): _____
- Other (List): _____
- Other (List): _____

Kitchen Countertops
Choose option 1 or 2



Option 1
Granite
Cipollino
(group 5 upgrade)



Option 2
Omega Stone
Zebrino
(group 1 upgrade)

Kitchen Backsplash
Choose option 1 or 2

Option 1
Style: Specialty Belmont Diamond Blend Mesh
Niveous
(group 23 upgrade)
Grout 949 Silverado

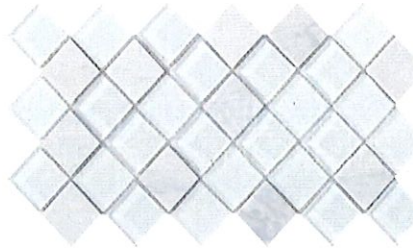

Full Mosaic Horizontal

Option 2
Style: Uptown Glass Hexagon Mosaic (12x12 mesh)
Color: UP23 Carrera
Size: 1x1
(group 19 upgrade)
Grout 949 Silverado



Full Mosaic Horizontal

Plumbing
Choose option 1 or 2

Sink
No Choice needed



Option 1
Camerist Spot Resist Finish
(upgrade)

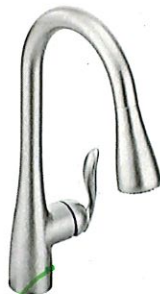

Option 2
Arbor Spot Resist Finish
(upgrade)

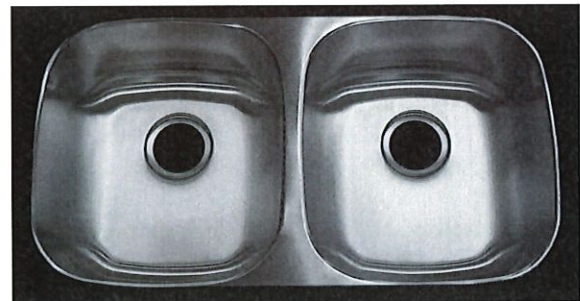

Mirado 209 50/50 Stainless Steel Finish
Undermount
(upgrade)

Cabinet Door Style
Choose option 1 or 2



- Option1
Alpine Flat Panel
Smoke
(upgrade)

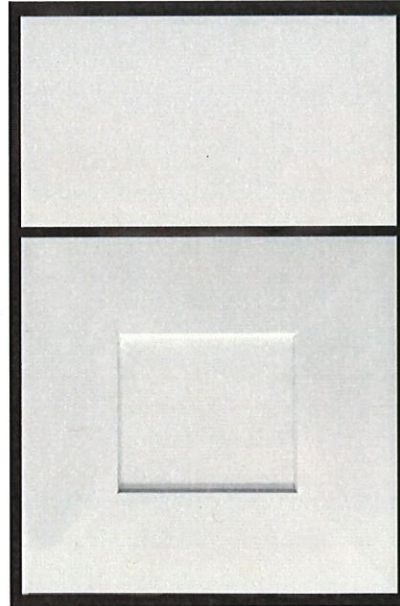

- Option 2
Alvarado Flat Panel
Linen
(upgrade)

Cabinet Accessory
Only choose if the option should be added

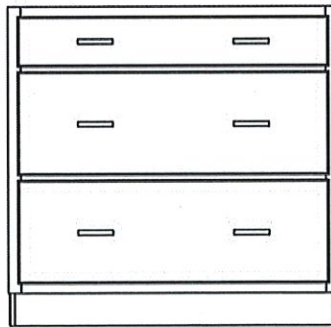

- Pot and Pan Drawers – Below Cooktop
(not available with range or gourmet kitchen #1 appliance packages)
(upgrade)

Cabinet Door Style
Choose option 1 or 2

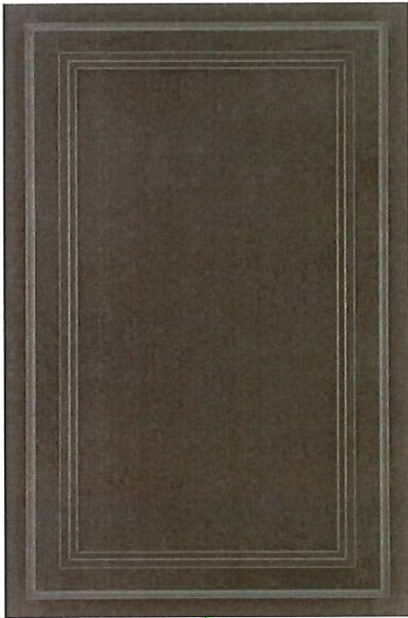

- Option 1
Tahoe Flat Panel
Cherry Slate
(upgrade)

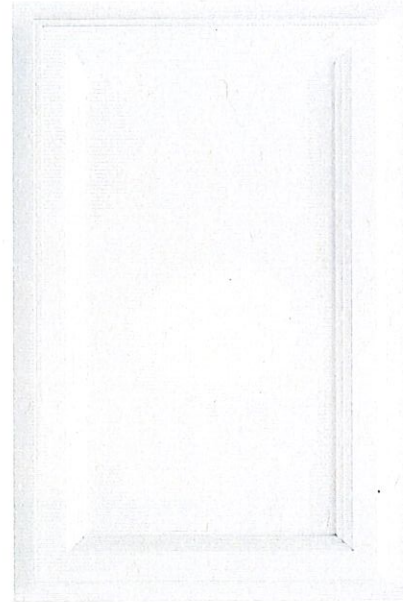

- Option 2
Tahoe Flat Panel
Linen
(upgrade)

Cabinet Accessory
Only choose if the option should be added

N/A

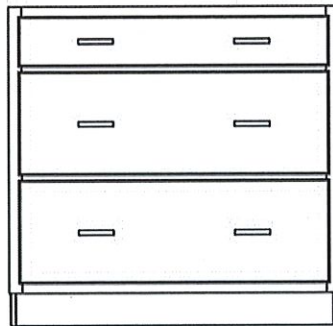

- Pot and Pan Drawers – Below Cooktop
(not available with range or gourmet kitchen #1 appliance packages)
(upgrade)

Countertops
No choice needed

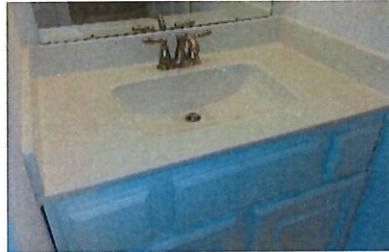

White Cultured Marble (standard)

Tile Flooring
Choose between layout options 1 or 2

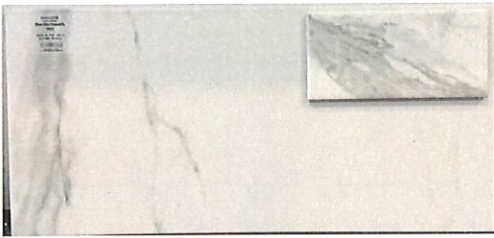

Style: Titus Hills
Color: Calacatta
Size: 12x24
(group 5 upgrade)
Grout 949 Silverado

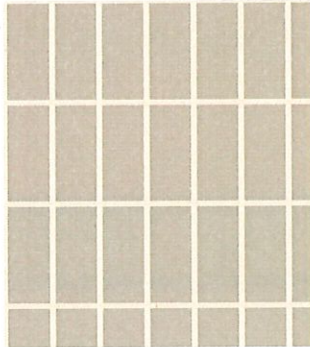

Tile Layout option 1
Straight Lay
(standard)



Tile Layout option 2
Flooring laid 33% offset
Upgrade

Shower Walls
Choose between layout options 1 or 2



Style: Titus Hills
Color: Calacatta
Size: 12x24
(group 5 upgrade)
Grout 949 Silverado
Shower Floor: Tile cut to 4x4
If optional mudset is added

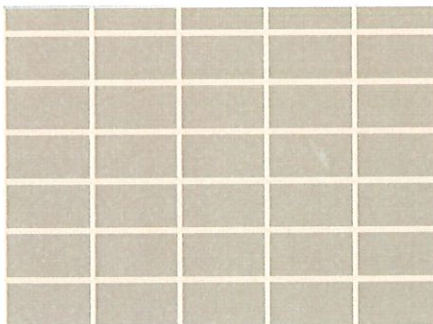

Tile Layout option 1
Straight Lay - no accent
(standard)



Tile Layout option 2
Staggered 33% horizontally
(upgrade)

Countertops
No choice needed



White Cultured Marble (standard)

Tile Flooring
Choose between layout options 1 or 2



Style: Avondale
Color: Castle Rock
Size: 12x12
(group 4 upgrade)
Grout 949 Silverado

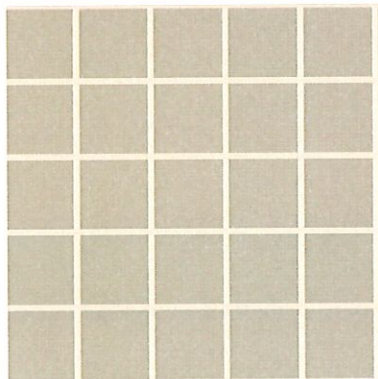

Tile Layout option 1
Straight Lay
(standard)

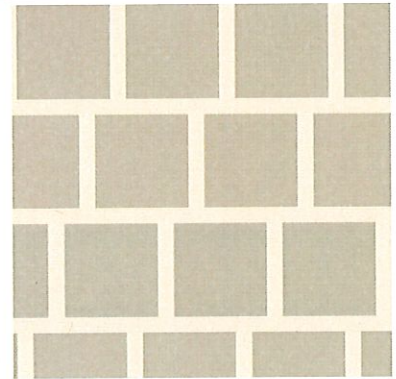

Tile Layout option 2
Flooring laid 33% offset
Upgrade

Shower Walls
Choose between layout options 1 or 2



Style: Avondale
Color: Castle Rock
Size: 12x12
(group 4 upgrade)
Grout 949 Silverado
Shower Floor: Tile cut to 4x4
If optional mudset is added

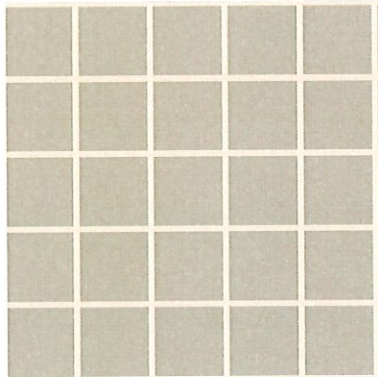

Tile Layout option 1
Straight Lay - no accent
(standard)

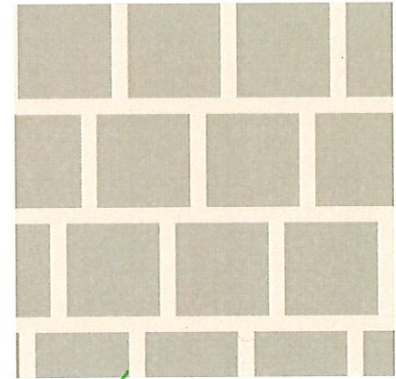

Tile Layout option 2
Staggered 33% horizontally
(upgrade)

Plumbing and Hardware
Choose option 1 or 2



- Option 1
Brantford Chrome 4" Faucet
With Brantford Chrome shower and tub fixtures
(standard)
Bath hardware chrome
With chrome shower enclosure
(standard)



- Option 2
Brantford Brushed Nickel 4" Faucet
With Brantford Brushed Nickel Shower and tub fixtures
(upgrade)
Bath hardware nickel
With nickel shower enclosure
(upgrade)

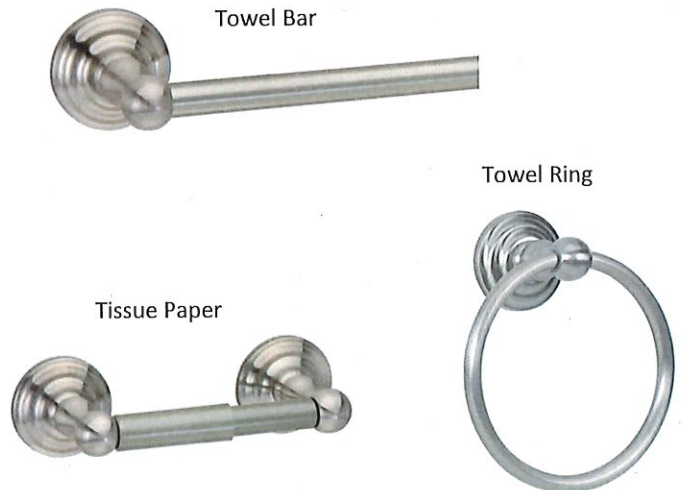
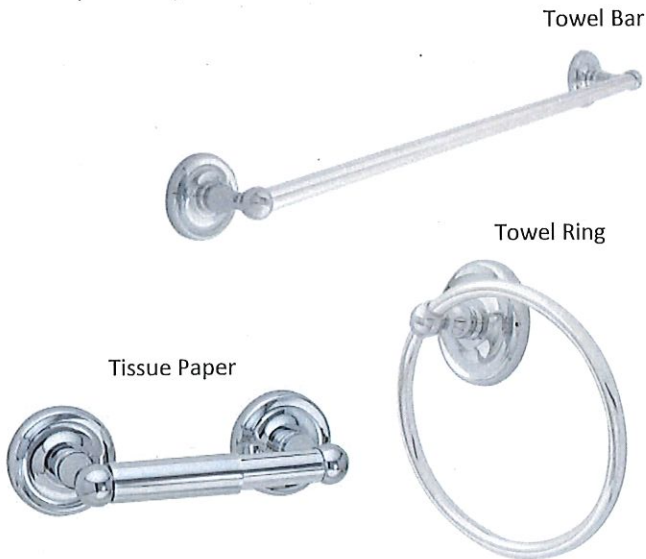

NIA

Pedestal Sink Style
No choice needed



Square pedestal sink (standard)

Powder Plumbing and Accessories
Choose option 1 or 2



Towel Ring



Towel Ring



Option 1
Brantford Chrome 4" Faucet
Chrome Towel Ring
(standard)

Option 2
Brantford Brushed Nickel 4" Faucet
Nickel Towel Ring
(upgrade)

Powder Flooring
Choose option 1, 2 or 3



Wood Floor Option 1
Engineered:
Staffington
Stain: Iron Birch
(group 3 upgrade)

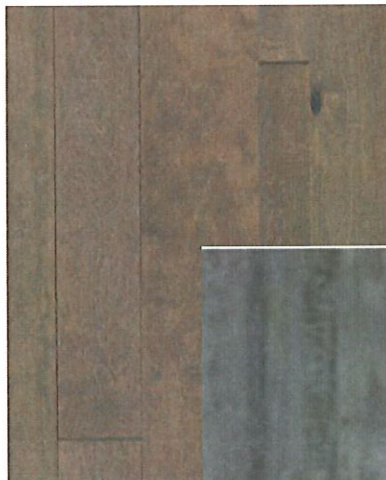

Rigid Core Floor Option 3
Style: Radcliff
Color: Gray Waters
(group 3 upgrade)

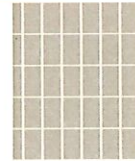

Pattern: Laid Straight
(Standard)



Tile Floor Option 2
Style: Titus Hills
Color: Calacatta
Size: 12x24
(group 5 upgrade)
Grout 949 Silverado

Tile Flooring
No Choice Needed



Tile Floor
Style: Titus Hills
Color: Calacatta
Size: 12x24
(group 5 upgrade)
Grout 949 Silverado

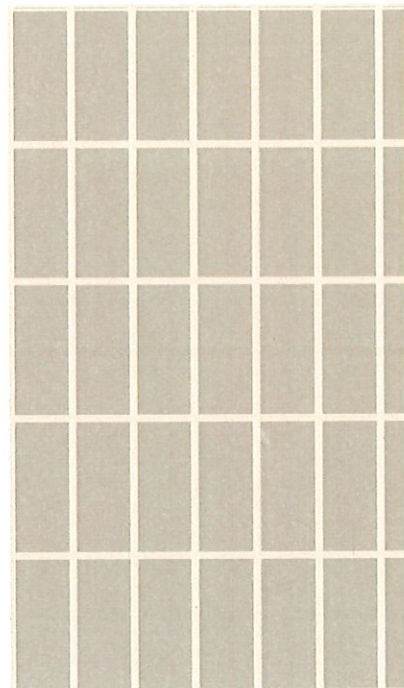

Flooring laid in a straight
pattern
(standard)

Fireplace
No selection needed



- Option 1 –
Standard Painted Mantle with tile surround
Tile: Skybridge
Color: SY98 Gray
Size: 12 x24
(group 8 upgrade)
Grout 949 Silverado

Note: Standard tile surround = Approx. 66" High
Approx. 60" Wide

Window Coverings
No Choice Needed

2" Capri-Designer
White

Showcase Home Request Form

Community Name:	Meridiana 50's
Community Sales Manager:	Allan Whitaker and Becky Bishop
Target Consumer:	Baby Maybe
Current # of Started Showcase Homes:	0
Current # of Unstarted Showcase Homes:	0
Home Site Number:	10169
Address:	10346 Aldrin Dr
Floor Plan:	Chambray
Elevation:	D
Exterior Color Request:	Exterior Color Scheme #5 w/eastern buff stone
Garage Swing	Right
# of Plan Sales in Last 12 Months:	2
% of Plan Sales in Last 12 Months:	20%
Proposed Plan Square Footage	2300
Base Price:	\$278,990
Lot Premium:	\$6,250
Structural Option / FRO Target:	\$23,353
DC Option Target:	\$16,000
Target Gross Sales Price:	\$324,593
Current MPL Incentive (add as negative)	(\$35,000)
Estimated Net Sales Price:	\$289,593



BONTERRA™

Proposed Price per SF
\$125.91

Options as % of Base Sales Price	
Structural:	8.4%
DC:	5.7%
Total:	14.1%

Structural Options	Price
tub and shower in master	2,925
extended owner suite	5,995
8' interiors	2,150
gourmet kitchen 1	200
option bench	2,175
tray ceiling foyer	550
12' popup ceiling in gathering	1,295

Design Center Palette Name Matrix 2: Cool	
Matrix 2 cool	

Proposed Marketing Strategy (please be specific):

we are targeting baby maybe and empty nesters. We feel the options chosen make the Chambray feel bigger. More user friendly and the best bang for buck in Meridiana pricepoint.

**** Upon completion, please submit form to Area Sales Manager for approval ****

VPSM / ASM Approval (Date)

Cabinet Door Style
Choose option 1 or 2

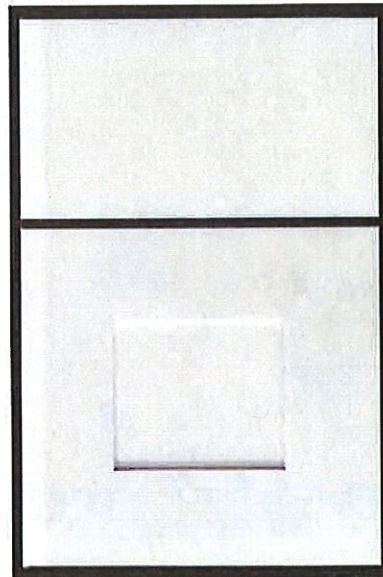
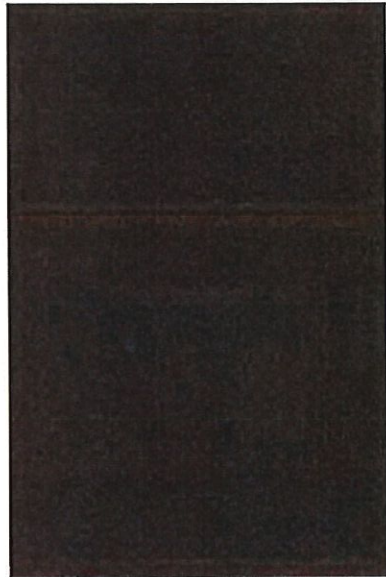

Option1
Alpine Flat Panel
Smoke
(upgrade)

Option 2
Alvarado Flat Panel
Linen
(upgrade)

Cabinet Accessory
Only choose if the option should be added

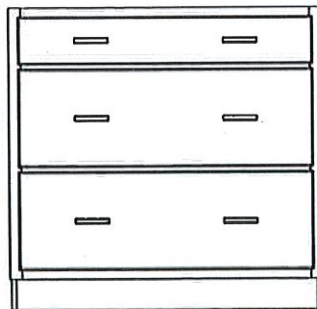

Pot and Pan Drawers – Below Cooktop
(not available with range or gourmet kitchen #1 appliance packages)
(upgrade)

Pedestal Sink Style
No choice needed



Square pedestal sink (standard)

Powder Plumbing and Accessories
Choose option 1 or 2



Option 1
Brantford Chrome 4" Faucet
Chrome Towel Ring
(standard)

Towel Ring



Option 2
Brantford Brushed Nickel 4" Faucet
Nickel Towel Ring
(upgrade)

Towel Ring



Powder Flooring
Choose option 1, 2 or 3

N/A.



Wood Floor Option 1
Engineered:
Staffington
Stain: Iron Birch
(group 3 upgrade)



Rigid Core Floor Option 3
Style: Radcliff
Color: Gray Waters
(group 3 upgrade)

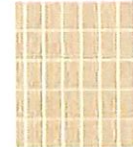

Pattern: Laid Straight
(Standard)



Tile Floor Option 2
Style: Titus Hills
Color: Calacatta
Size: 12x24
(group 5 upgrade)
Grout 949 Silverado

Stair Selections
No choice needed

Newel Post: 3" Chamfered Top "V-Groove"
Newel and Handrail Stain: Sherwood Ebony SW #3232
Species: Red Oak
Caps & Risers: MDF Paint Grade

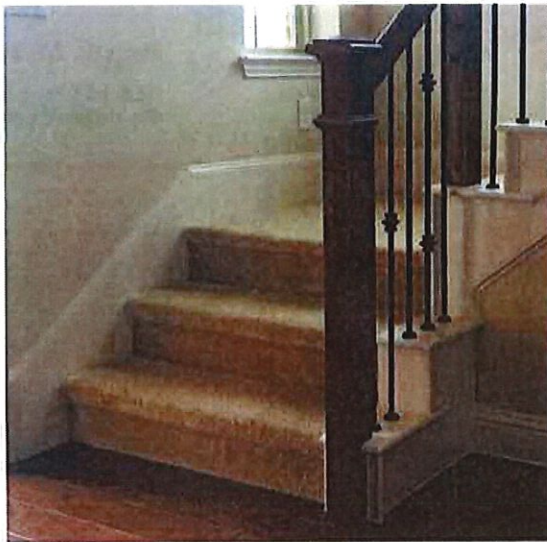
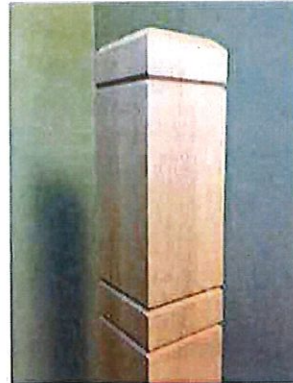

Staircase Flooring: Carpet (standard)
Challenger - 936 Silver Splendor (group 2 upgrade)

Cushion: Vegas

N/A

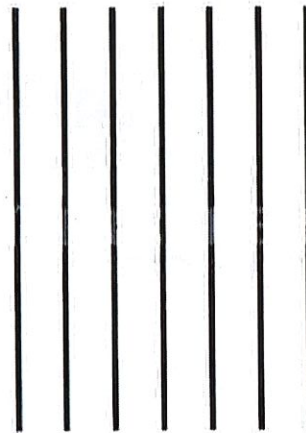

P-10A

Iron Balusters – P-10A (standard)
Finish: Satin Black

Interior Doors
No choice needed

Spec 1 Matrix

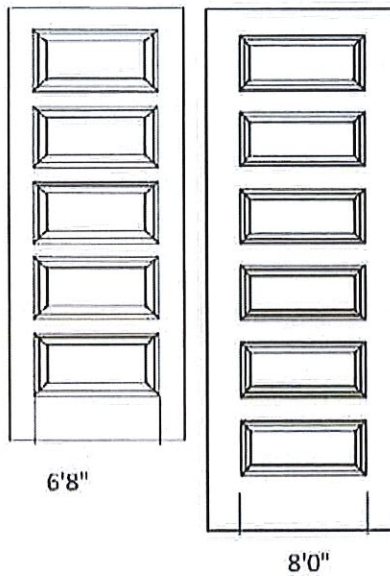

Door Hardware
No choice needed



Barcelona Handleset
Satin Nickel (Upgrade)



Stratus Knob
Satin (standard)



Fireplace
No selection needed



- Option 1 –
Standard Painted Mantle with tile surround
Tile: Skybridge
Color: SY98 Gray
Size: 12 x24
(group 8 upgrade)
Grout 949 Silverado

Note: Standard tile surround = Approx. 66" High
Approx. 60" Wide

N/A

Base
299,448



Division: Texas Houston - Homebuilding

Community: Meridiana 50

Lot Number: Lot 2 (690102)

Quote Number: Q-28602

Model: Chambray (Elevation: D)

Buyer:

Address: 10342 Aldrin Drive, Iowa Colony, TX, 77583

Swing: Right

Generated Date: 07/09/2019

Product Code	Name	Qty	List Unit Price	Total Price
(Order #: 1)				
<i>Category: Bathroom Options</i>				
*OWNB0110	Opt Slide-in Tub with Tile Mud-set Shower Floor @ Owner's Bath	1.00	\$2,925.00	\$2,925.00
<i>Category: Bedroom Options</i>				
*OWNS0012	Opt. Extended Owner's Suite	1.00	\$5,995.00	\$5,995.00
<i>Category: Color Scheme</i>				
CLSS0005	Stucco Exterior Color Scheme #5 - Trim & Garage-SW 7022 Alpaca, Stucco-SW 9166 Drift of Mist, Shutters-SW 9164 Illusive Green	1.00	\$0.00	\$0.00
<i>Category: Custom</i>				
ENGY0001	Energy Seal (Phase 2)	1.00	\$0.00	\$0.00
<i>Category: Door Options (Structural)</i>				
TRIM0015	8' Interior Doors Upgrade Including Back Door & only on 1st floor - Level 3 Specs (MUST SELECT WITH UPGRADE TO LEVEL 3 TRIM - TRIM0013)	1.00	\$2,150.00	\$2,150.00
<i>Category: Electrical</i>				

GDOR0001	Garage Door Opener (per door)	1.00	\$395.00	\$395.00
----------	-------------------------------	------	----------	----------

Category: Exterior Options (Structural)

FDOP0001	8 Foot Single Front Door Option	1.00	\$850.00	\$850.00
----------	---------------------------------	------	----------	----------

Category: Front Doors

FRDW3620	**REQUIRES STRUCTURAL OPTION FDOP0001** 8' SQ. TOP 3/4 LITE (6 LITE) 36" WIDE	1.00	\$230.00	\$230.00
	MATERIAL - FINISH - MAHOGANY - WINTER WHITE	1		
	GLASS - DESIGN STYLE - CLEAR BEVELED			

Category: Garage Door

GDHW0002	Garage Door Decorative Hardware	1.00	\$65.00	\$65.00
----------	---------------------------------	------	---------	---------

Category: General Room Options

WDTK0001	Window Package Turnkey	1.00	\$0.00	\$0.00
----------	------------------------	------	--------	--------

 GRMT1000	Gourmet Kitchen 1 - Cooktop with Vented Microwave with Oven Below- Must select and pay for corresponding appliance and cabinet options (GEAP0301, GEAP0302)	1.00	\$200.00	\$200.00
---	---	------	----------	----------

 OWNE0010	Opt Bench at Owner's Entry - B&B / Hooks	1.00	\$2,175.00	\$2,175.00
--	--	------	------------	------------

Category: Interior Door Trim & Hardware

DRHW1209PKGG	Upgrade to Stratus Satin Nickel Knobs	1.00	\$0.00	\$0.00
--------------	---------------------------------------	------	--------	--------

Keep ✓

Category: Interior Options (Structural)

TRAY5000	Opt Tray Ceiling @ Foyer	1.00	\$550.00	\$550.00
RSRC0001	Rounded Sheetrock Corners	1.00	\$570.00	\$570.00
TRAY7000	Opt 12" Pop-up Ceiling @ Gathering Room	1.00	\$1,295.00	\$1,295.00

Category: Interior Paint

PNTH0010	Paint - Base -Whole House Interior Walls & Ceiling	1.00	\$0.00	\$0.00
	Color - SW 7646 - First Star	1		
	Ceiling Color - Same as wall color			

Keep ✓

Category: Kitchen Sinks

SINK0007	Sink - 8" - SS - 50/50 Top Mount	1.00	\$0.00	\$0.00
----------	----------------------------------	------	--------	--------

Remove

Category: LVL 1 Fix - Master Bath

PFMB0101	Master Bath - Brantford - 4" - Chrome	1.00	\$0.00	\$0.00
----------	---------------------------------------	------	--------	--------

✓ keep

Category: LVL 1 Fix - Powder Bath

FFPB0101	Powder Bath - Brantford - 4" - Chrome	1.00	\$0.00	\$0.00
----------	---------------------------------------	------	--------	--------

Remove

Category: LVL 1 Fix - Sec. Bath

FFSB0106	Sec. Bath - 1 Sink - Brantford - 4" - Chrome	2.00	\$0.00	\$0.00
----------	--	------	--------	--------

✓ keep

Category: Light Fixture Packages - Lvl 1

LTPK0101	Light Pkg - Jolie Finish - Brushed Nickel	1.00 1	\$0.00	\$0.00
----------	--	-----------	--------	--------

✓ keep

Category: Multiple Mechanicals

QUCK0001	Quick Flash Products	1.00	\$0.00	\$0.00
----------	----------------------	------	--------	--------

Category: Plumbing Accessories - Ground

PGAS0001	Gas Stub Out	1.00	\$375.00	\$375.00
----------	--------------	------	----------	----------

Category: Special Custom

PRST0001	Pre-Start Tasks	1.00	\$0.00	\$0.00
CMAD0000	Community Requirements	1.00	\$0.00	\$0.00

Category: Stone

EFST0004	Stone Level 4 (must select with stone front option)	1.00	\$1,183.00	\$1,183.00
	Color - Eastern Buff	1		
	Mortar - Khaki			

Category: Stucco Options

✓ VNSC0010	Stucco ilo Siding @ Sides - First Floor Only	1.00	\$0.00	\$0.00
VNSC0020	Stucco ilo Siding @ Rear - First Floor Only	1.00	\$0.00	\$0.00

Category: Trim Color

PNTT0010	Paint - Base - Trim - Whole House	1.00	\$0.00	\$0.00
	Color - SW 7006 - Extra White	1		

✓ keep

Category: Windstorm Requirements

WTDI0110	Windstorm Requirements - TDI - 110 MPH	1.00	\$0.00	\$0.00
----------	--	------	--------	--------

(Order #: Cancelled)

Category: Landscape

IRIG0000	Irrigation Sprinkler System - Includes Front and Back Yard	1.00	\$3,300.00	\$3,300.00
SODB0001	Backyard Sod	1.00	\$1,095.00	\$1,095.00

Sub Total	\$18,958.00
Lot Premium	\$1,500.00
Base Price	\$278,990.00
Option Total	\$18,958.00
Incentive Given	\$0.00
Total Purchase Price	\$299,448.00

This system-generated *Proposal* is provided to a prospective buyer and/or its Broker/Agent outside of and not made a part of the Purchase Agreement: (1) all information as of the date indicated remains subject to change at any time without notice or obligation; and (2) is for illustrative and informational purposes only for preliminary discussions for prospective buyer's convenience. No guarantee or representation is made or implied as to availability, manufacturer, style, size, color, number, pricing and other factors installed in the completed home and/or subject to applicable incentives (if any) affecting pricing, all of which Seller reserves the right to modify. Refer to the final executed Purchase Agreement and its attached Addenda (inclusive of any post-purchase amendments thereto) and the specific Community's Standard Features List for complete details. Equal Housing Builder.

	FLATWORK	B.L. BUILDING LINE	CONC. CONCRETE	B.L.D.G. BUILDING	⊕ LIGHT POLE	⊗ MANHOLE
	PROPERTY LINE	U.E. UTILITY EASEMENT	S.S.E. SANITARY SEWER EASEMENT	D.E. DRAINAGE EASEMENT	⊞ ELECTRIC BOX	⊞ GRATE DRAIN
BUILDING LINE	W.L.E. WATER LINE EASEMENT	ST.M.S.R. STORM SEWER EASEMENT	E.E.L. ELECTRIC EASEMENT	⊞ WATER VALVE	⊞ FIBER OPTIC	⊞ FIRE HYDRANT
EASEMENT	ELEV. ELEVATION	(B.G.) BUILDER GUIDELINES	⊙ PROPERTY CORNER	⊞ GAS METER	⊞ TELEPHONE PEDESTAL	⊞ CABLE PEDESTAL
WOODEN FENCE	T.O.F. TOP OF FORM	FND. FOUND	⊙ POWER POLE	⊞ WATER METER	⊞ WATER METER	⊞ MANHOLE & INLET
WROUGHT IRON FENCE	FF. FINISHED FLOOR	I.R. IRON ROD	⊞ PAD MOUNTED TRANSFORMER	⊞ GUY ANCHOR		
CHAIN LINK FENCE	EXT. EXTENDED	I.P. IRON PIPE				
OVERHEAD ELECTRIC	PVT. PRIVATE	R.O.W. RIGHT-OF-WAY				

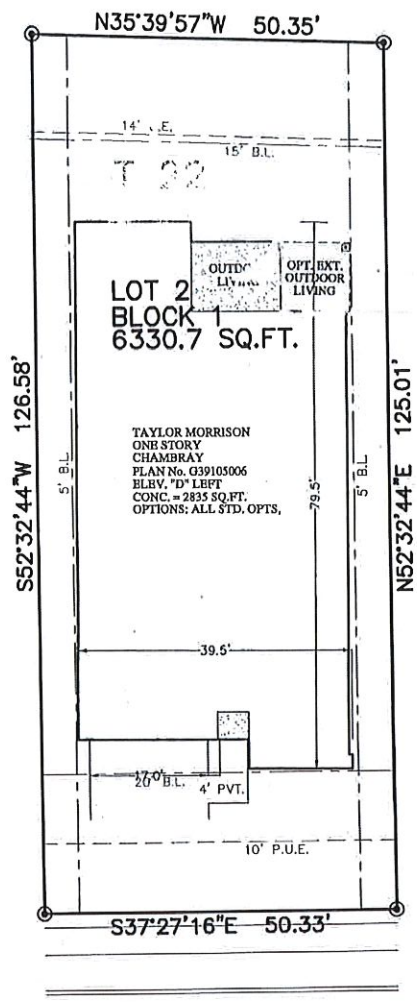

ALDRIN DRIVE
(50' R.O.W.)

LOT DRAWING
SCALE: 1 = 20'

NOTES:
 1. ALL BEARINGS SHOWN HEREON ARE BASED ON THE RECORDED PLAT.
 2. SURVEYOR HAS NOT ABSTRACTED THE SUBJECT PROPERTY. ABSTRACTING BY TITLE COMPANY ONLY. ALL EASEMENTS, RESTRICTIONS AND OTHER MATTERS OF RECORD KNOWN TO SURVEYOR ARE SHOWN AND ARE BASED ON THE RECORDED PLAT AND/OR TITLE REPORT. ALLPOINTS LAND SURVEY, INC. IS NOT LIABLE FOR ANY DAMAGES DUE TO INFORMATION NOT PROVIDED TO SURVEYOR OR BUILDER PLACING ANY IMPROVEMENTS WITHIN A BUILDING LINE OR EASEMENT.
 FLATWORK AND FENCING ARE FOR ILLUSTRATION PURPOSES ONLY. REFER TO MUNICIPALITY, HOA, POA, BUILDER GUIDELINES, DEED RESTRICTIONS OR LOCAL CODE FOR REQUIREMENTS. SPECIFIC INSTALLATION REQUIREMENTS TO BE VERIFIED BY BUILDER.

FOR: TAYLOR MORRISON HOMES	
ADDRESS: ALDRIN DRIVE	
ALLPOINTS JOB#: TM	BY: SC
G.F.:	
JOB:	
FLOOD ZONE: X SHADED/AE	
COMMUNITY PANEL: 48039C0120H	
EFFECTIVE DATE: 6/5/1989	
LOMR: 18-06-0251A	DATE: 12-5-2017
THIS INFORMATION IS BASED ON GRAPHIC PLOTTING, WE DO NOT ASSUME RESPONSIBILITY FOR EXACT DETERMINATION	

LOT 2, BLOCK 1,
MERIDIANA, SECTION 69,
DOC. No. 2017059292, OFFICIAL RECORDS,
BRAZORIA COUNTY, TEXAS



©2017, ALLPOINTS LAND SURVEY, INC.
All Rights Reserved.

Production Manager:
OAK
Review Set Date: 03-19-2017
Bid Set Date: 07-06-2017
Permit Set Date: N/A
Final Set Date: N/A
Production Set Release Date: 08-18-2017

Rev. #	Description/Date
1	REVISION SET #1 01-31-2018
2	REVISION SET #2 10-15-2018

taylor morrison
Interior Architects & Designers

BUILDER: TAYLOR MORRISON
COMMUNITY: BLOCK
LOT: GLOBAL PLAN
ADDRESS: CITY
CITY: PROJECT TYPE: Single Family Detached
PLAN: CHAMBRAY CSE 025008

SCALE: 12" = 1'-0"
DRN: CES-FR
CODE: WIND

A10.01

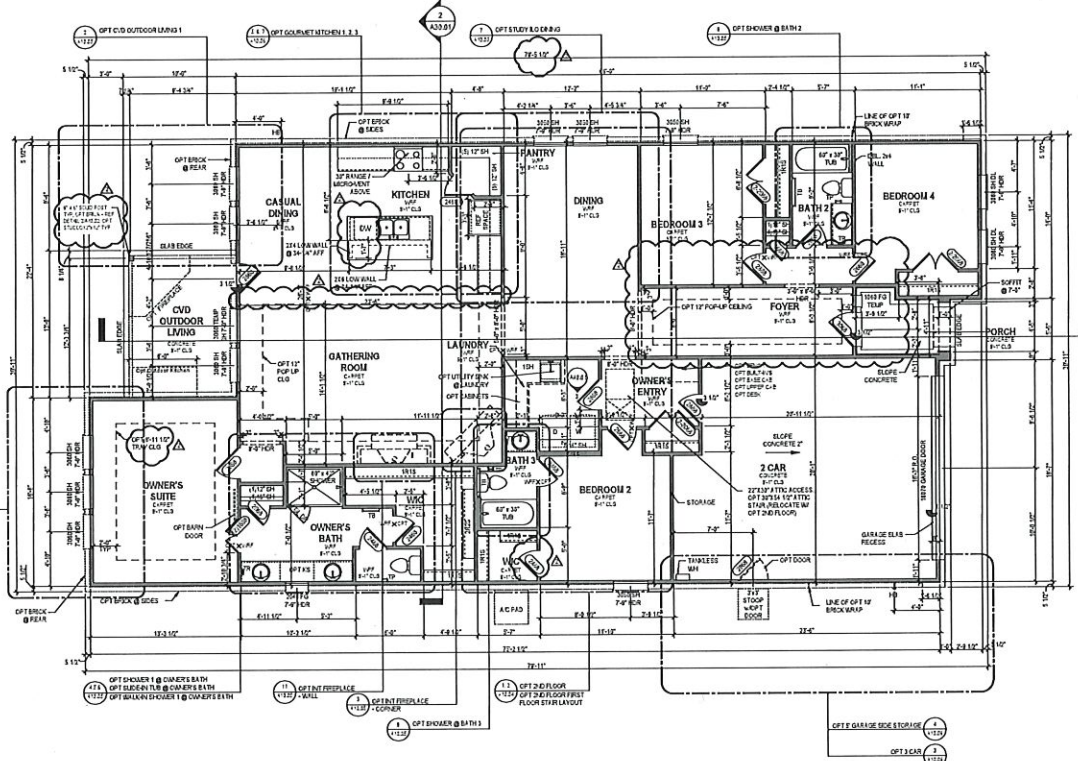

1 ELEVATION A - FIRST FLOOR
1/8" = 1'-0"

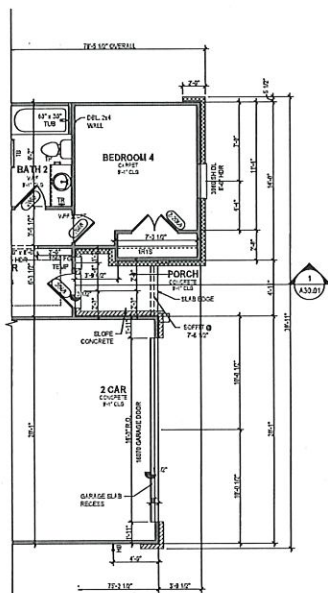

3 ELEVATION D - FIRST FLOOR
1/8" = 1'-0"

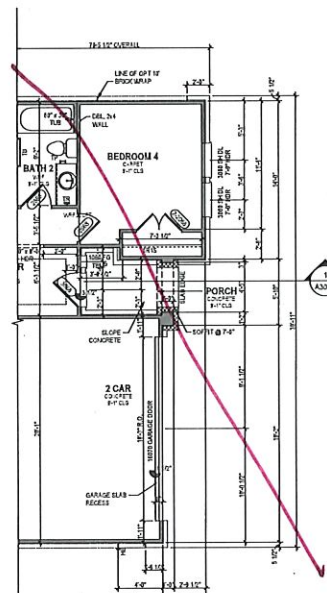

2 ELEVATION C - FIRST FLOOR
1/8" = 1'-0"

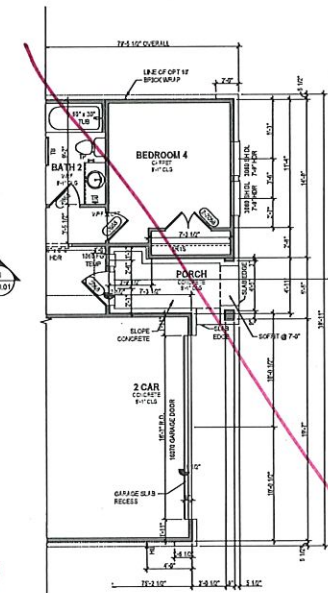

1 ELEVATION B - FIRST FLOOR
1/8" = 1'-0"

CHILDRISSEN ARCHITECTURAL GROUP
 1010 S. 10th St., Suite 100
 Lincoln, NE 68502
 Phone: (402) 441-1111
 Fax: (402) 441-1112
 Website: www.childrisse.com

Production Manager:
 GUY
 Review Set Date: 03-19-2017
 Bid Set Date: 07-06-2017
 Permit Set Date: N/A
 Prequal Set Date: N/A
 Production Set Release Date: 09-18-2017

Rev. #	Description/Date
REVISION SET #1	01-31-2018
REVISION SET #2	10-15-2018

taylor morrison
Home's Inspired by You

BUILDER: TAYLOR MORRISON
 COMMUNITY: BLOCK
 LOT: ADDRESS GLOBAL PLAN
 CITY: PROJECT TYPE Single Family Detached
 PLAN: CHAMBRAY CS1 020008

SCALE: 12" = 1'-0"
 DRN: CES-FE
 CODE: WND

A10.02

This set of plans and specifications shall be construed by the architect as intended to be used in accordance with the building code of the jurisdiction in which the project is located. The architect shall be responsible for obtaining all necessary permits and for obtaining all applicable code requirements. The architect shall be responsible for obtaining all necessary permits and for obtaining all applicable code requirements.

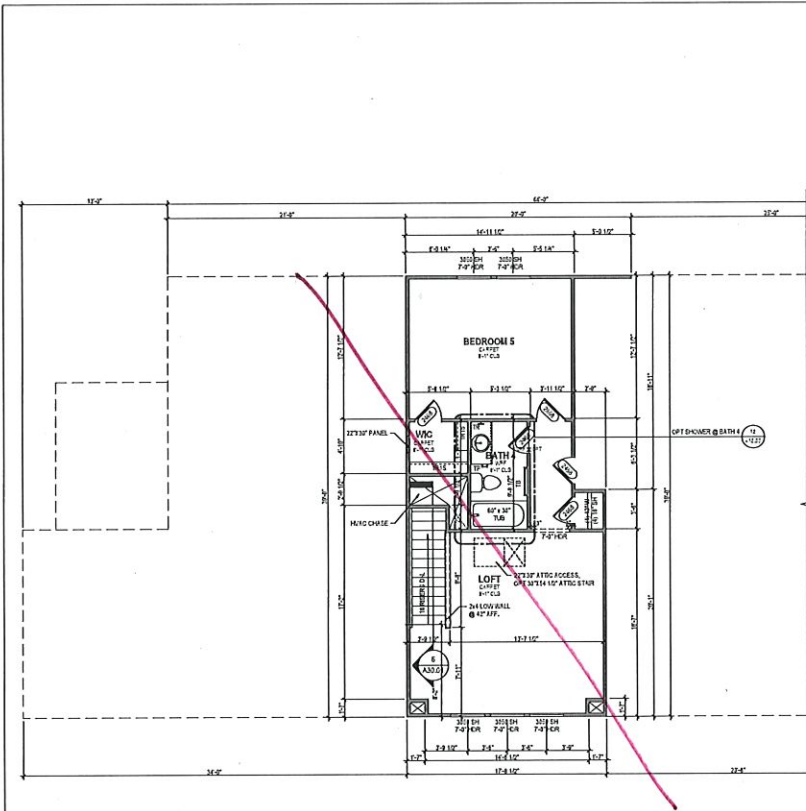

② OPT 2ND FLOOR - SECOND FLOOR
1/8" = 1'-0" (SCND0001)

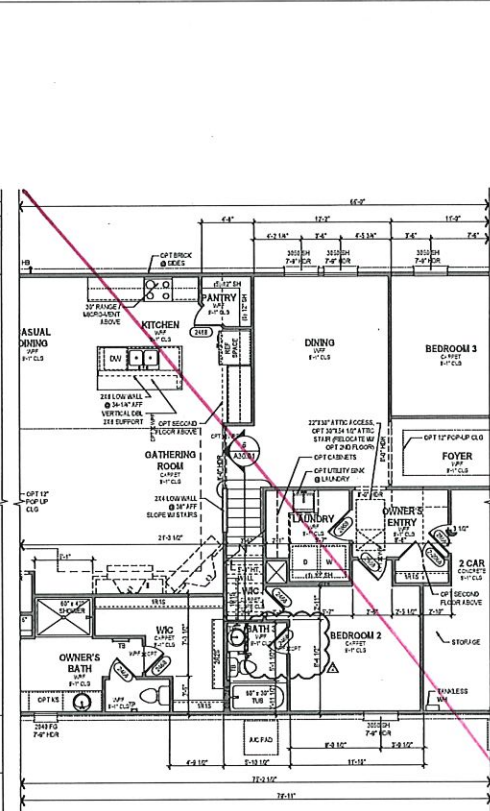

① OPT 2ND FLOOR - FIRST FLOOR
1/8" = 1'-0" (SCND0001)

CHILDFRESS
ARCHITECTURAL GROUP

Production Manager:
OLY

Revision Set:
03-10-2017

Revision Set:
07-06-2017

Revision Set:
08-18-2017

REVISIONS

Rev. #	Description/Date
Δ	REVISION SET #1 01-31-2018
Δ	REVISION SET #2 10-15-2018
Δ	
Δ	
Δ	
Δ	
Δ	

taylor morrison
Homes Inspired by You

BUILDER: TAYLOR MORRISON
COMMUNITY: [REDACTED]
LOT: [REDACTED] BLOCK: [REDACTED]
ADDRESS: GLOBAL PLAN
CITY: [REDACTED]
PROJECT TYPE: Single Family Detached
PLAN: CHAMBRAY CS# 105005

SCALE: 1/8" = 1'-0"
DRN: CES-FE
CODE: WWD

A10.04

Production Manager:
 GJK
 Review Set Date: 03-10-2017
 Bid Set Date: 07-06-2017
 Permit Set Date: N/A
 Preparer Set Date: N/A
 Production Set Release Date: 08-18-2017

Rev. #	Description/Date
Δ	REVISION SET #1 01-31-2018
Δ	REVISION SET #2 10-15-2018
Δ	
Δ	
Δ	
Δ	
Δ	

taylor morrison
 Home's Inspired By You

BUILDER: TAYLOR MORRISON
 COMMUNITY: BLOCK
 LOT: ADDRESS GLOBAL PLAN
 CITY: PROJECT TYPE Single Family Detached
 PLAN: CHAMBRAY CSE105005

SCALE: 12" = 1'-0"
 DRN: CES-FE
 CODE: W/ND

A10.05

This set of drawings was prepared by the architect under contract with the owner. It is the responsibility of the architect to ensure that the drawings are complete and correct. The architect does not warrant the accuracy of the information provided on these drawings. The architect is not responsible for any errors or omissions on these drawings. The architect is not responsible for any construction methods or materials used in the construction of the project. The architect is not responsible for any construction methods or materials used in the construction of the project.

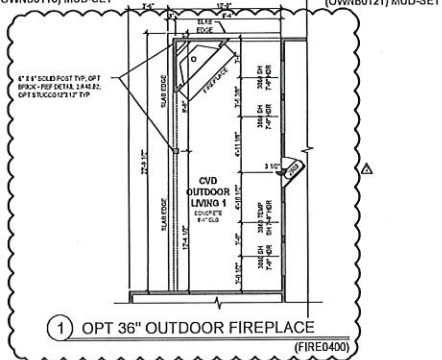
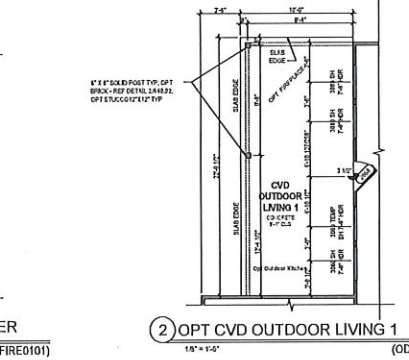
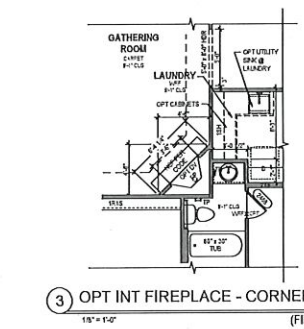
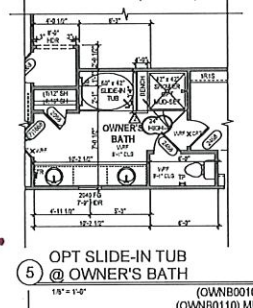
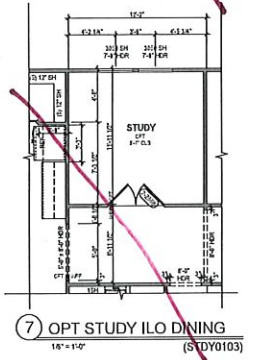
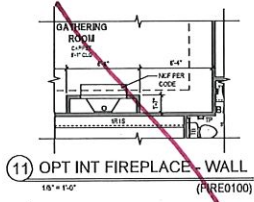

Production Manager
 OUY
 Review Set 03-10-2017
 Bid Set 07-06-2017
 Permit Set N/A
 Prequal Set N/A
 Production Set 08-19-2017

REVISIONS

Rev. #	Description/Date
Δ	REVISION SET #1 01-31-2018
Δ	REVISION SET #2 10-15-2018
Δ	
Δ	
Δ	
Δ	
Δ	

taylor morrison
 Homes Inspired by You

BUILDER TAYLOR MORRISON
 COMMUNITY BLOCK
 LOT ADDRESS GLOBAL PLAN
 CITY PROJECT TYPE Single Family / Detached
 PLAN CHAMBRAY CSE 050505

SCALE 1/2" = 1'-0"
 DRN CES-FE
 CODE WWD

A10.06

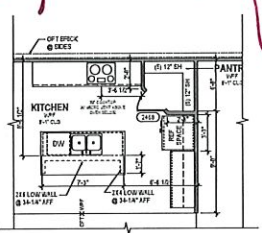

7 OPT GOURMET KITCHEN 1
 18" x 1'-0" (GRMT1000)

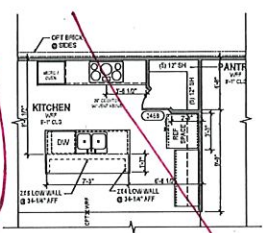

6 OPT GOURMET KITCHEN 2
 18" x 1'-0" (GRMT2000)

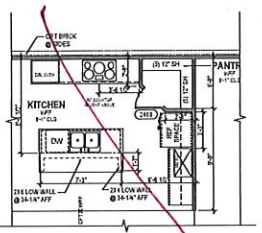

5 OPT GOURMET KITCHEN 3
 18" x 1'-0" (GRMT3000)

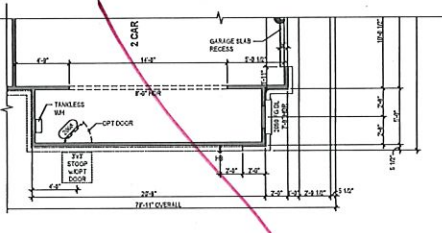

4 OPT 5' GARAGE SIDE STORAGE
 18" x 1'-0" (GARA0005)

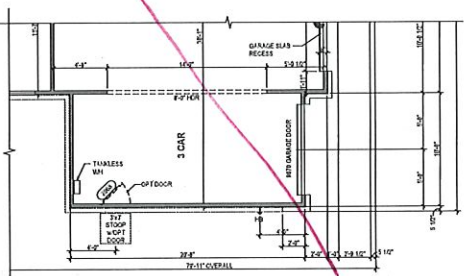

3 OPT 3 CAR
 18" x 1'-0" (GARAD003)

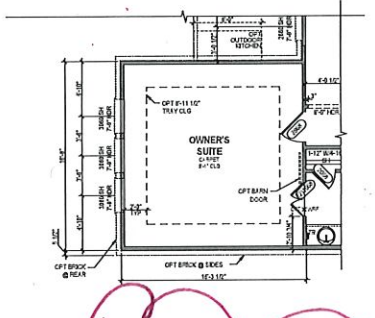

2 OPT EXT OWNER'S SUITE
 18" x 1'-0" (OWNS0012)

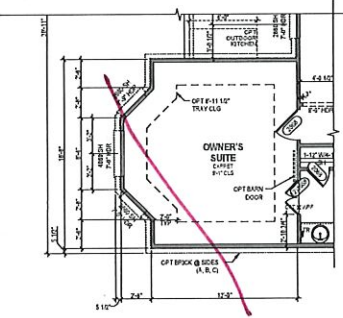

1 OPT BAY WINDOW @ OWNER'S SUITE
 18" x 1'-0" (BAYW0001)



Kitchen Countertops
Choose option 1 or 2



Option 1
Granite
Cipollino
(group 5 upgrade)

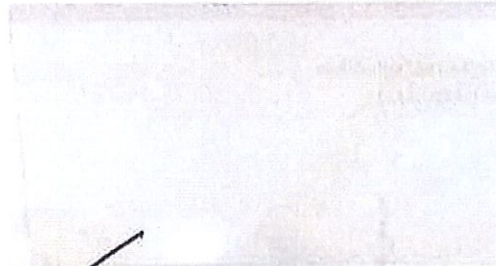

Option 2
Omega Stone
Zebrino
(group 1 upgrade)

Kitchen Backsplash
Choose option 1 or 2

Option 1
Style: Specialty Belmont Diamond Blend Mesh
Niveous
(group 23 upgrade)
Grout 949 Silverado



Full Mosaic Horizontal

Option 2
Style: Uptown Glass Hexagon Mosaic (12x12 mesh)
Color: UP23 Carrera
Size: 1x1
(group 19 upgrade)
Grout 949 Silverado



Full Mosaic Horizontal

Plumbing
Choose option 1 or 2



Option 1
Camerist Spot Resist Finish
(upgrade)



Option 2
Arbor Spot Resist Finish
(upgrade)

Sink
No Choice needed

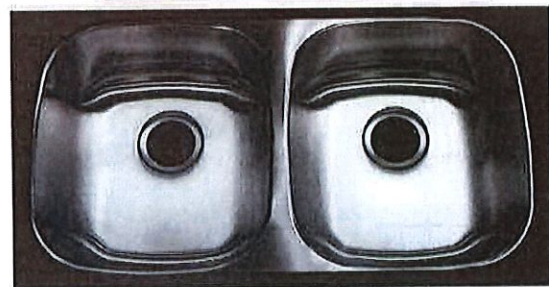

Mirado 209 50/50 Stainless Steel Finish
Undermount
(upgrade)

Countertops
No choice needed

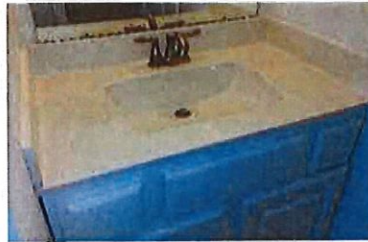

White Cultured Marble (standard)

Tile Flooring
Choose between layout options 1 or 2

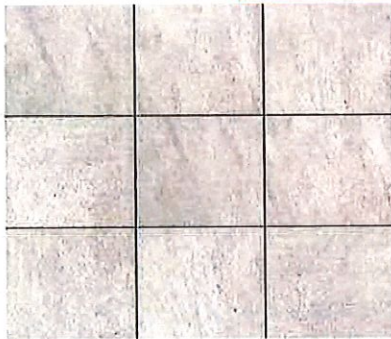

Style: Avondale
Color: Castle Rock
Size: 12x12
(group 4 upgrade)
Grout 949 Silverado

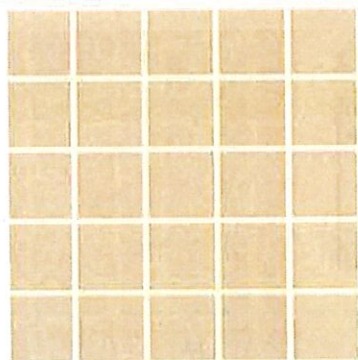

Tile Layout option 1
Straight Lay
(standard)



Tile Layout option 2
Flooring laid 33% offset
Upgrade

Shower Walls
Choose between layout options 1 or 2



Style: Avondale
Color: Castle Rock
Size: 12x12
(group 4 upgrade)
Grout 949 Silverado
Shower Floor: Tile cut to 4x4
If optional mudset is added

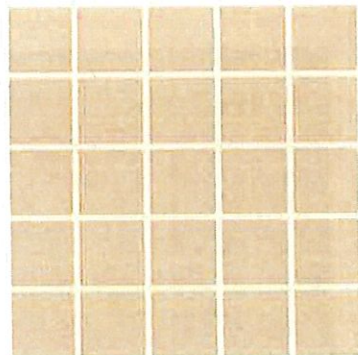

Tile Layout option 1
Straight Lay – no accent
(standard)

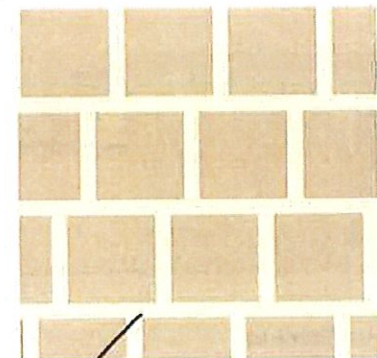

Tile Layout option 2
Staggered 33% horizontally
(upgrade)