

N. C. KILLOUGH SURVEY A-460

set 1/2" SR o/s
(D W FREE RPLS 4010)
S 09°38'12" W 128.20'

Richard J. Tullis
"106.99 acres"
V. 1123 P. 363

Roger Allen
"50.00 acres"
V. V. 1081 P. 910

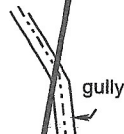

N 09°38'12" E 1046.79'
S 06°14'29" E 639.20'
County Road 318

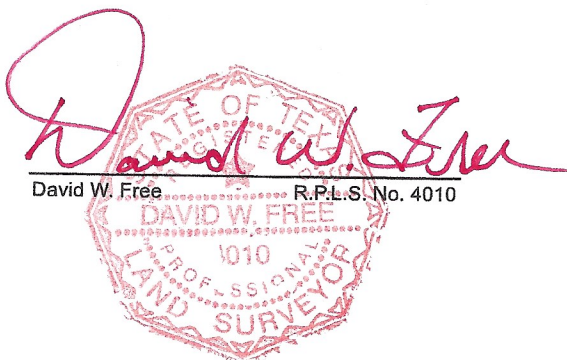

David W. Free R.P.L.S. No. 4010

2.86 ACRES

David Free
"2.88 acres"
V. 1750 P. 531

found 3/8" SR (no cap) @ F.C.
found 3/8" SR (no cap) @ F.C.
S10-16'-35" E 1190.57'

N 80°23'06" W 318.57' set 1/2" SR (D W FREE RPLS 4010)

fence remnants



Lois Gillam
"13.339 acres"
V. 1117 P. 73

N 80°11'38" W 238.14'

set 1/2" SR b/s (D W FREE RPLS 4010)

set 1/2" SR o/s (D W FREE RPLS 4010)
N 80°11'38" W 27.60'

S 02°25'53" W 182.14'

**SURVEY PLAT OF 2.86 ACRES IN THE
N. C. KILLOUGH SURVEY, A-460
LEON COUNTY, TEXAS**

SCALE: 1" = 100'

APRIL 8, 2019

FREE & ASSOCIATES, P.C.

Firm No. 10013400

P. O. BOX 317

CENTERVILLE, TEXAS

(903) 536-2554

STATE OF TEXAS

COUNTY OF LEON

APRIL 8, 2019

2.86 ACRES

These notes describe that certain 2.86 acres in the N. C. KILLOUGH SURVEY, Abstract 460, located in Leon County, Texas; being all of "Tract One – 2.855 acres" contained in a General Warranty Deed dated February 13, 2019 from John Bankhead et al to David W. Free and recorded in Volume 1750 Page 531 Leon County Official Records; this 2.86 acre tract is described more particularly as follows:

BEGINNING at the Southwest corner of the "2.855 acres", same being for the upper Southeast corner of that "106.99 acres" (recorded in Volume 1123 Page 363 LCOR), same being; set a 1/2" steel rod (with yellow cap marked D W FREE RPLS 4010) at same; found a 3/8" steel rod (no cap) bearing North 80°-26'-06" West 318.57 feet from which another 3/8" steel rod (no cap) was found bearing South 10°-16'-35" East 1,190.57 feet;

THENCE with the West line of the "2.855 acres", same being the East line of the "106.99 acres", partially along old fence remnants, North 09°-38'-12" East a distance of 1,046.79 feet to the North corner of the "2.855 acres" in County Road 318 (but not the centerline of same); set a 1/2" steel rod (with yellow cap marked D W FREE RPLS 4010) offset South 09°-38'-12" West 128.20 feet;

THENCE with line of the "2.855 acres" in County Road 318 (but not the centerline of same), as follows:

- | | |
|------------------------|--|
| South 00°-31'-30" West | 255.20 feet to a 1/2" steel rod (with yellow cap marked D W FREE RPLS 4010) set below surface; |
| South 06°-14'-29" East | 639.20 feet to a 1/2" steel rod (with yellow cap marked D W FREE RPLS 4010) set below surface; |
| South 02°-25'-53" West | 182.14 feet to the Southeast corner of the "2.855 acres"; set a 1/2" steel rod (with yellow cap marked D W FREE RPLS 4010) offset North 80°-11'-38" West 27.60 feet; |

THENCE with the South line of the "2.855 acres", North 80°-11'-38" West a distance of 238.14 feet to the PLACE OF BEGINNING.

Containing, according to the dimensions herein stated, an area of 2.86 acres of land.

SURVEYOR'S NOTE: Bearings are Grid (Lambert). Access is by frontage on County Road 318. See plat.

David W. Free

David W. Free

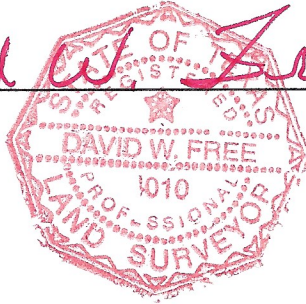

R.P.L.S. No. 4010