

Scale: 1" = 20.0'

Lot 14

Lot 13

S.29°14'15"E. 104.59'

Fnd. 5/8" I.R. w/cap

7' U.E.

Fnd. 5/8" I.R. w/cap

5' CenterPoint Energy asmt. CFN 2005004988, O.R.F.B.C.

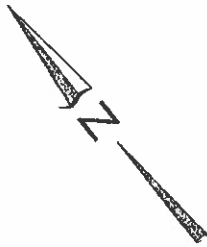

18.92'

40.2'

10.3'

17.1'

11.3'

Reserve "A"

N.62°31'33"E. 147.34'

8303

2 Story Residence

S.57°07'10"W. 152.0'

Lot 11

42.75'

24.6'

12.6'

6.4'

13.6'

4.1'

9.0'

6.2'

19.4'

45.6'

20' B/L

21.22'

25' B/L

L = 88.89'

R = 50.0'

Ch = 77.64'

Buffalo Creek Drive (60.0' R.O.W.)

L = 22.06'

R = 25.0'

Ch = 21.35'

Fnd. 5/8" I.R. w/cap

L = 21.64'

R = 692.0'

Ch = 21.63'

Fnd. 5/8" I.R. w/cap

- Note:
- B.L. - Building Line
 - San.S.E. - Sanitary Sewer easement
 - Strn.S.E. - Storm Sewer easement
 - U.E. - Utility easement
 - R.O.W. - Right of Way
 - I.R. - Iron Rod
 - I.R. w/cap - Iron rod with plastic cap
 - Wood fence
 - Iron fence
 - Chain link fence
 - Curves:
 - L = Length
 - R = Radius
 - Ch = Chord length

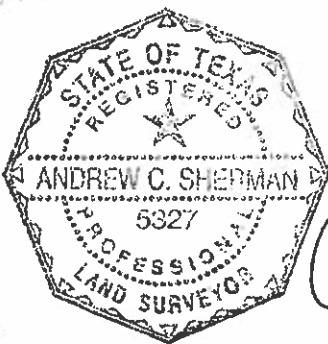

I hereby state that this survey was made on the ground under my supervision on August 21, 2008 and that this plat represents the circumstances at the time of the survey.

Andrew C. Sherman 8-22-08

Andrew C. Sherman, R.P.L.S. No. 5327

Date

- Bearings based on recorded plat
- Surveyor did not abstract property
- Property subject to all building lines (front, side & rear) and all utility and aerial easements, and any other building restrictions, if any, that are not shown on this plat.
- H.L.&P./Reliant Energy agreement CFN 2004141045, O.R.F.B.C.
- Property subject to all deed restrictions and restrictive covenants recorded or unrecorded including those stated in Schedule B Title Report
- indicates controlling monument

This property lies within Zone "X" & Zone "X" shaded as per flood insurance rate maps, map # 48157C0115-J dated 1-3-1997. (Per recorded plat) Inherent inaccuracies of FEMA or flood control maps preclude a surveyor from certifying to the accuracy of potential flooding locations based on such maps. Surveyor is not liable for any flooding that may ever occur on this property.

LOT: 10	BLOCK: 1	SUBDIVISION: Long Meadow Farms		SECTION: 6
RECORDATION: Plat # 20040122 of the Plat Records				
ADDRESS: 8303 Buffalo Creek Drive		CITY: Richmond, 77406	COUNTY: Fort Bend	STATE: Texas
PURCHASER: David Nguyen & Linh Nguyen			TITLE COMPANY:	G.F. #
SSC		SOUTHWEST SURVEYING CO.		
11847 MEADOW TRAIL LANE MEADOWS PLACE, TEXAS 77477 (281) 568-3969 FAX (281) 564-3062				
DRAWN BY: <i>lgs</i>				DRAWING NO.: 08220800