



LOT 34

FND. 1/2"
I.R. @ 0.53'
N 39°34' W

FND. 1/2"
I.R. & 0.33'
N 66°42' E

N 03°03'15" W 60.00'

8' U.E.

LOT 41

LOT 40
BLOCK 5

LOT 39

S 86°56'45" W 115.00'

N 86°56'45" E 115.00'

3' D.E.

3' D.E.

TWO STORY
BRICK & FRAME

A/C PAD

9.0

45.0

42.5

25' B.L.

13.7

9.1

8.0

19.7

8.5

10' W.S.E.

FND. 1/2"
I.R. (DCM)

S 03°03'15" E 60.00'

FND. 1/2"
I.R. (DCM)

PLUM FALLS LANE

SURVEY EXAMINED AND
ACCEPTED BY PURCHASERS

DATE 09-23-08

DCM=Directional Control Monument
Bearings based on subdivision plat.
Easements and Building Lines (B.L.) as provided by Title Company.

FLOOD PLAIN INFORMATION:

ZONE: "X"
PANEL: 48039C-0035I
DATE 9-22-99
G.F. NO.: 08-9209
JOB NO.: 08076109
SCALE: 1" = 20'

Purchaser EMILIO FLORES LORCA
Address 1908 PLUM FALLS LANE PEARLAND, TEXAS 77581
Lot 40 Block 5 Sec. 1
Survey _____
Area _____
Subd VILLAGE GROVE
Vol. 23 Pg. 225 P.R. BRAZORIA COUNTY, TEXAS

To LSI TITLE AGENCY, INC. & PATRIOT BANK MORTGAGE, INC.

The undersigned does hereby certify that this survey was this day made, on the ground of the property, legally described hereon and correct; and that there are no discrepancies, conflicts, shortages in area, boundary line conflicts, visible encroachments, overlapping of improvements, easements or apparent rights-of-way, except as shown hereon, and said property has access to and from dedicated roadway, except as shown hereon.
This document is copyright protected with a production date as delineated below.
This survey is valid only with impression seal signed in red ink.

Dated this 9th day of SEPTEMBER 2008 ROBERT A. LAPLANT JR.
RPLS 5234

LaPLANT SURVEYORS, INC.

1503 BIG HORN DRIVE HOUSTON, TEXAS 77090
(281) 440-8890 FAX 281-440-8510





LOT 34

FND. 1/2"
I.R. @ 0.53'
N 39°34' W

FND. 1/2"
I.R. & 0.33'
N 66°42' E

N 03°03'15" W 60.00'

8' U.E.

LOT 41

LOT 40
BLOCK 5

LOT 39

S 86°56'45" W 115.00'

N 86°56'45" E 115.00'

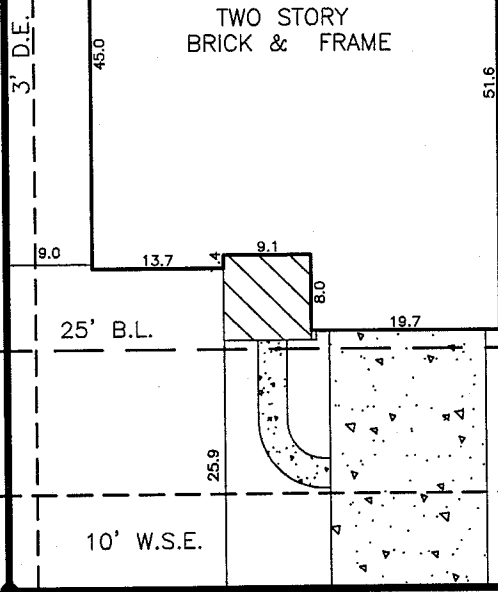

FND. 1/2"
I.R. (DCM)

S 03°03'15" E 60.00'

FND. 1/2"
I.R. (DCM)

PLUM FALLS LANE

**SURVEY EXAMINED AND
ACCEPTED BY PURCHASERS**

DATE 09.23.08

DCM=Directional Control Monument
Bearings based on subdivision plat.
Easements and Building Lines (B.L.)

as provided by Title Company.

FLOOD PLAIN INFORMATION:

ZONE: "X"
 PANEL: 48039C-0035I
 DATE: 9-22-99
 G.F. NO.: 08-9209
 JOB NO.: 08076109
 SCALE: 1" = 20'

Purchaser EMILIO FLORES LORCA
 Address 1908 PLUM FALLS LANE PEARLAND, TEXAS 77581
 Lot 40 Block 5 Sec. 1
 Survey _____
 Area _____
 Subd VILLAGE GROVE
 Vol. 23 Pg. 225 P.R. BRAZORIA COUNTY, TEXAS

To LSI TITLE AGENCY, INC. & PATRIOT BANK MORTGAGE, INC.

The undersigned does hereby certify that this survey was this day made, on the ground of the property, legally described hereon and correct; and that there are no discrepancies, conflicts, shortages in area, boundary line conflicts, visible encroachments, overlapping of improvements, easements or apparent rights-of-way, except as shown hereon, and said property has access to and from dedicated roadway, except as shown hereon.

This document is copyright protected with a production date as delineated below.
This survey is valid only with impression seal signed in red ink.

Dated this 9th day of SEPTEMBER 2008

ROBERT A. LAPLANT JR.
RPLS 5234

Laplant Surveyors, Inc.

1503 BIG HORN DRIVE HOUSTON, TEXAS 77090
(281) 440-8890 FAX 281-440-8510

