

KENNESAW MOUNTAIN LANE
(50' R.O.W.)

SURVEY WAS REVISED TO ADD PURCHASERS NAMES AND NOT FIELD UPDATED 10/24/06

FLOOD INSURANCE NOTE: By graphics plotting only, this property is in ZONE X of the Flood Insurance Rate Map, Community Panel No. 42801C0510J effective date of 11/6/1996

CENTERPOINT ENERGY AGREEMENT FOR ELECTRIC SERVICE AS RECORDED IN H.C.C.F. NO. X-659337

**PLAT of SURVEY
LOT 51 BLOCK 2
AMENDING PLAT NO. 1
EAGLE SPRINGS
SECTION 20
HARRIS COUNTY, TEXAS
H.C.C.F. NO. Y-716454;
FILM CODE NO. 589017 H.C.M.R.**

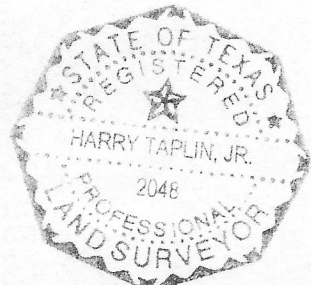

PURCHASER: KATHERINE A. HARRIS	UNIVERSAL AMERICAN MORTGAGE, LLC.
ADDRESS: 17606 KENNESAW MOUNTAIN LANE	NORTH AMERICAN TITLE CO GF NO TX066281910
LENNAR HOMES	TE TAPLIN ENGINEERING, INC. ENGINEERS - SURVEYORS 1011 HIGHWAY 6 SOUTH / SUITE 101 HOUSTON, TEXAS 77077
I HEREBY CERTIFY THAT THIS SURVEY WAS MADE ON THE	