

GALVESTON COUNTY HEALTH DISTRICT  
PRIVATE WASTEWATER DISPOSAL SYSTEM INSPECTION REPORT

HEALTH DISTRICT PERMIT # LC 7925  
CITY/COUNTY BUILDING PERMIT # \_\_\_\_\_  
WATER WELL PERMIT # \_\_\_\_\_

Wilson Hertenberger Moody Existing  
Name of Property Owner Septic Tank Installer Well Driller  
P.O. Box 656 3809 Elm 4616W  
Current Address Current Address  
Southside Trk 77510 Southside Trk 77570  
City State Zip City State Zip City State Zip  
925-3626 925-7709  
Telephone Telephone Telephone

DESCRIPTION OF PROPERTY: City: Southside Trk Subdivision: \_\_\_\_\_  
Lot Size: Width: 153 ft. Depth: 104 ft. Block: \_\_\_\_\_ Lot: \_\_\_\_\_  
Is the construction: new \_\_\_\_\_ existing  renovation \_\_\_\_\_ transfer \_\_\_\_\_ mobile home \_\_\_\_\_  
Number of persons \_\_\_\_\_ Bedrooms 2 Is this a ? business \_\_\_\_\_ residence

SEPTIC TANK(S): Number of tanks 2 Concrete  Other \_\_\_\_\_  
Clean-out: inlet line between house and tank  discharge line between last tank & field 55  
Tank 1: Number compartments 1 Thickness: wall 3" in. lid 3" in. reinforced? no  
Inlet below top of tank 4" in. Outlet below top of tank 7 in. Liquid capacity 300 gal.  
Tank 2: Number compartments 1 Thickness: wall 3" in. lid 3" in. reinforced? no  
Inlet below top of tank 4 in. Outlet below top of tank 7' in. Liquid capacity 300 gal.

GREASE TRAP: Number of compartments \_\_\_\_\_ liquid capacity \_\_\_\_\_ gal. Concrete \_\_\_\_\_ Other \_\_\_\_\_  
Clean-out: inlet between house and trap  /discharge line between trap and septic tank \_\_\_\_\_  
Inlet below top of tank \_\_\_\_\_ in. Outlet extension above bottom of tank \_\_\_\_\_

DRAINFIELD: Pipe material: Plastic Pipe size: 4" in  
Trench: Width 36 in. Depth 18 in. Total length 170 ft. Total square feet 510  
Distance between trenches 5' ft. Grade 0 Aggregate type 1 1/2  
Aggregate under pipe 6" in. Aggregate over top of pipe 2 in. Total cu. yds. 180

| DISTANCES FROM YOUR: | Foundation     | Property line  | Open Water     | Water Well     | Nearest Well    |
|----------------------|----------------|----------------|----------------|----------------|-----------------|
| Septic Tank:         | <u>5'</u> ft.  | <u>32'</u> ft. | <u>N/A</u> ft. | <u>50'</u> ft. | <u>100'</u> ft. |
| Drainfield:          | <u>40'</u> ft. | <u>10'</u> ft. | <u>N/A</u> ft. | <u>105</u> ft. | <u>100'</u> ft. |

HEALTH DEPARTMENT USE ONLY

Inspection requested by: \_\_\_\_\_ Date: \_\_\_\_\_  
Date inspection requested for: \_\_\_\_\_ Time: \_\_\_\_\_ am/pm  
Date inspection made: \_\_\_\_\_ Time: \_\_\_\_\_ am/pm  
Plot Plan: Approved/Disapproved John F. Benson R.S. Date: 3-13-91  
Construction: Septic Tank - Approved/Disapproved John F. Benson R.S. Date: 3-14-91  
Disapproval notice given to: \_\_\_\_\_ Date: \_\_\_\_\_

REMARKS: Repair to Malfunction of existing system add additional 300 gal Tank and 170' field line

PLOT PLAN OF PROPOSED CONSTRUCTION--show lotsize, house placement, wells, septic tanks, etc

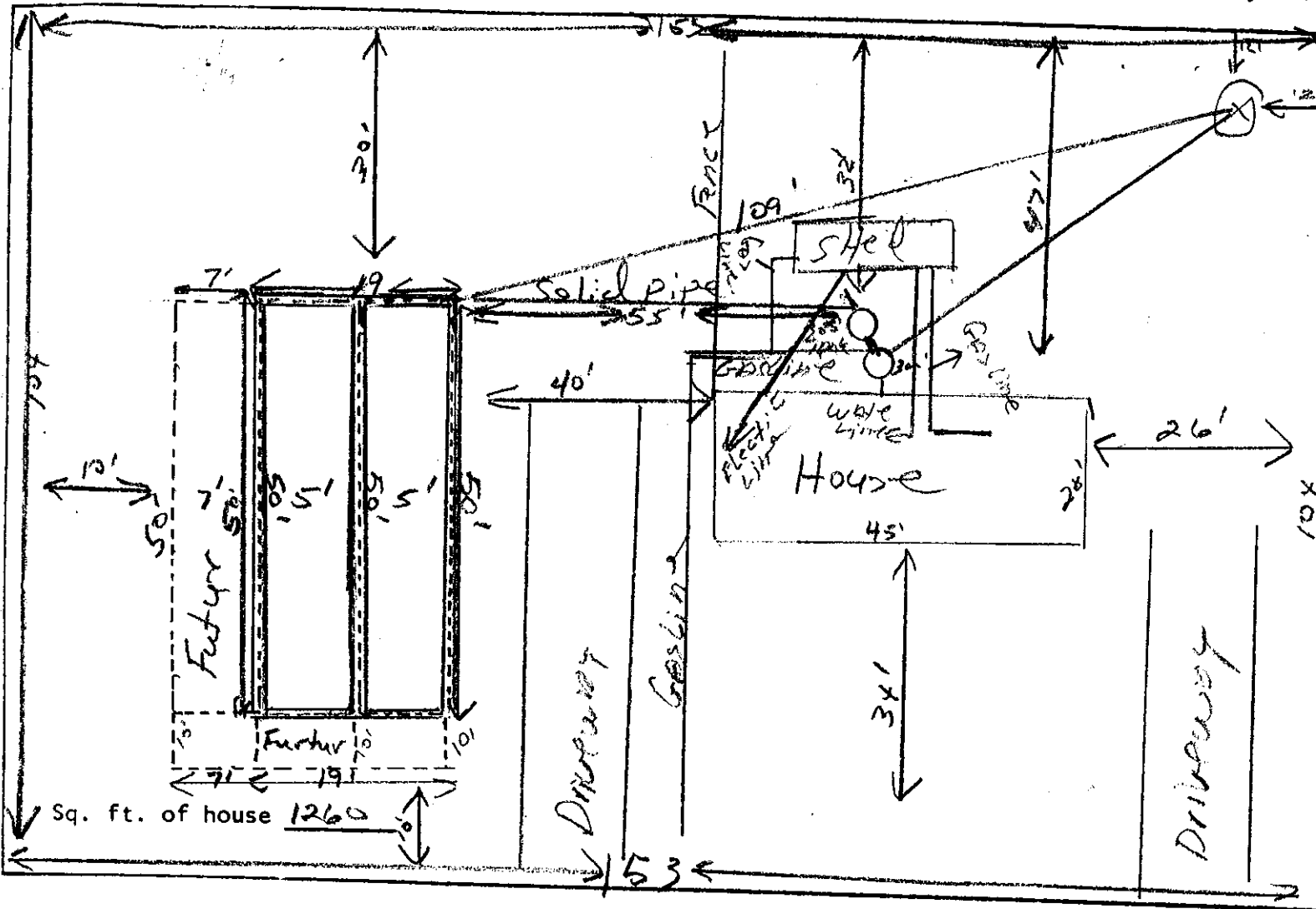

PLEASE SKETCH DIRECTIONS TO PROPOSED CONSTRUCTION SITE IN THIS SPACE

Give street address 4403 Scott Sparta Dr

Adjacent property address \_\_\_\_\_

Percolation Rate: \_\_\_\_\_ Zone/Lot: \_\_\_\_\_

This is a Class III property. Please read and sign the Galveston County Private Wastewater Land Suitability Notice. This notice must be read and signed before these construction plans will be approved.

The final inspection is to assure the system has been constructed according to the submitted plan and is consistent with good public health engineering practices. The acceptance of this plan and the approval of the final inspection, however, should not be construed to mean that the Galveston County Health District recommends, approves, certifies, or guarantees septic tank systems or their satisfactory performance. In the Galveston County area due to the high water table, variation of water usage, soil and climatic conditions, septic tank systems cannot be expected to function properly at all times.

x [Signature]  
Property Owner