

**SKETCH ADDENDUM**

Borrower or Owner **Brittany Nicole & Christopher Scheefer**  
 Property Address **20607 Ruston Ridge Crt**  
 City **Richmond** County **Fort Bend** State **TX** Zip Code **77406**  
 Client **Hometrust Mortgage Company**

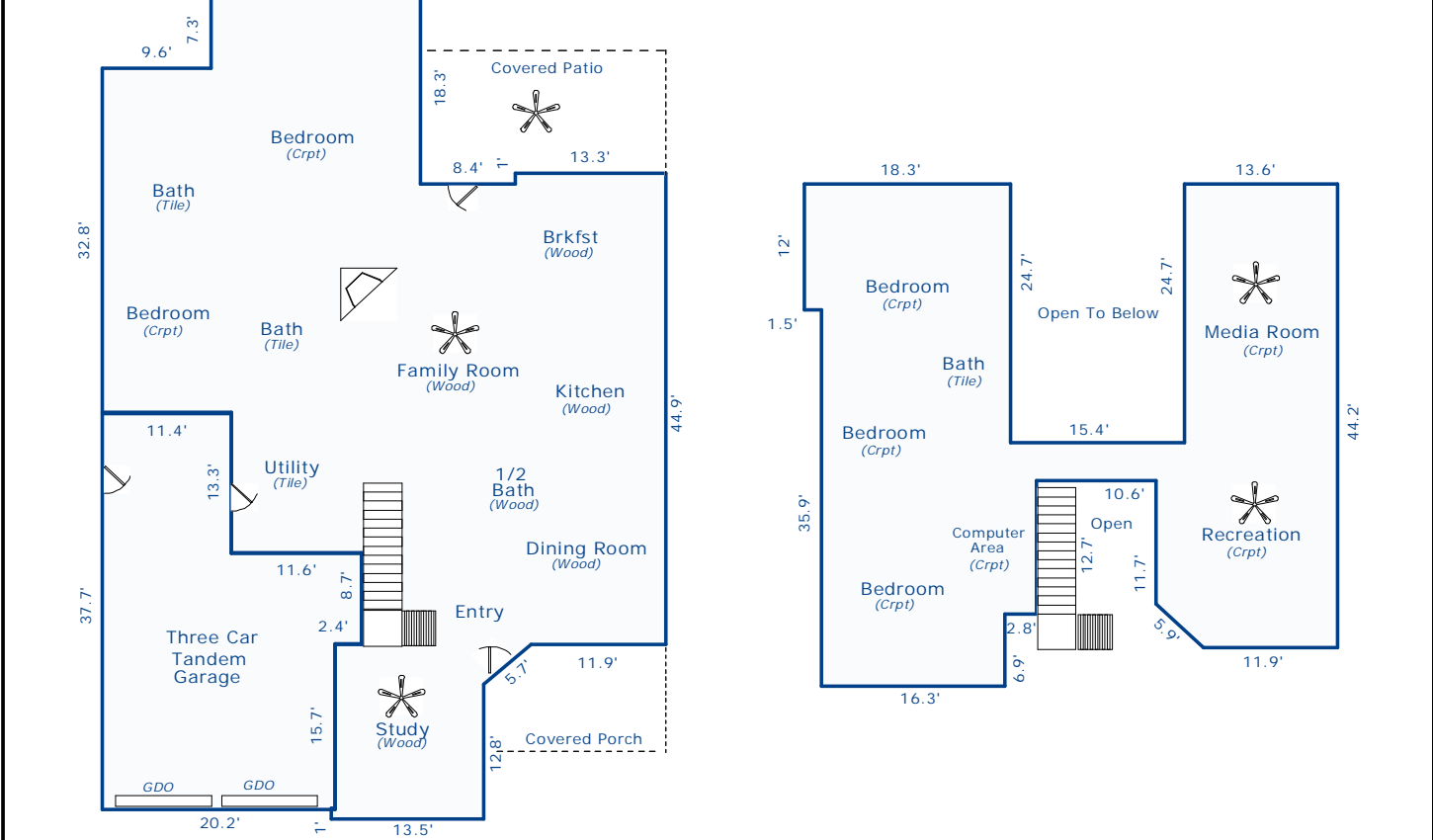

Sketch by Apex Sketch v5 Standard™

Comments:

AREA CALCULATIONS SUMMARY			
Code	Description	Net Size	Net Totals
GLA1	First Floor	2523.51	2523.51
GLA2	Second Floor	1535.97	1535.97
GAR	Garage	675.14	675.14
<b>Net LIVABLE Area</b>		<b>(rounded)</b>	<b>4059</b>

LIVING AREA BREAKDOWN			
Breakdown			Subtotals
<b>First Floor</b>			
0.5 x	4.2 x	3.8	7.98
	8.7 x	26.9	234.03
	0.1 x	29.3	2.93
	15.6 x	13.2	205.92
	1.0 x	13.5	13.50
	38.5 x	13.3	512.05
	49.9 x	21.8	1087.82
	7.3 x	18.6	135.78
	11.0 x	28.2	310.20
	1.0 x	13.3	13.30
<b>Second Floor</b>			
	16.3 x	6.9	112.47
	19.1 x	12.7	242.57
	45.8 x	3.6	164.88
	11.7 x	16.1	188.37
	24.7 x	13.6	335.92
	12.7 x	16.8	213.36
0.5 x	4.2 x	4.2	8.82
	12.0 x	18.3	219.60
	11.9 x	4.2	49.98
<b>19 Items</b>	<b>(rounded)</b>		<b>4059</b>