

NOTES:
 NO RECORDS SEARCH CONTRACTED. RECORD EASEMENTS, RESTRICTIONS, ROADWAYS, RIGHTS-OF-WAY, BUILDING LINES, ENCUMBRANCES, ETC. BY COMMON KNOWLEDGE ONLY.
 CLIENT HOLDS TLTS, INC. HARMLESS FROM RESPONSIBILITY FOR SAME

- SURVEY NOT INTENDED AS BOUNDARY DELINEATION SURVEY
- Restrictions as per recorded plat unless otherwise noted
- True ground distances shown
- Bearings assumed as platted
- Survey monuments reconciled w/numerous previous surveys

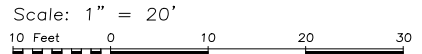

LAND TITLE SURVEY OF A TRACT OF LAND being Lot 1, Block 1, of "Re-plat of Lots 259, 260 and 261, EVIA PHASE TWO, SECTIONS ONE & TWO, a subdivision in Galveston County, Texas according to the plat recorded in Plat Record 2007A, Page 70, in the Office of the County Clerk of Galveston County, Texas.

Subject property: 113 Island Passage
 Galveston County, Texas

This survey is certified for this transaction only and may only be relied on by Gary Joachim and Nancy Toy. This survey is only valid if print has original seal and signature of surveyor.

I hereby certify that this survey was made on the ground under my direct supervision and that this plat correctly represents the facts found at the time of the survey.

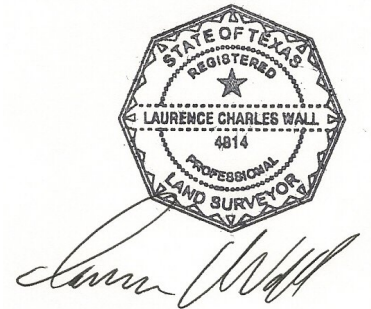

Laurence C. Wall
 RPLS #4814
 October 31, 2019

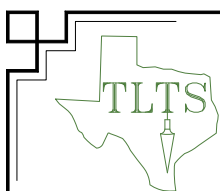

TLTS, Inc.
 TEXAS LAND TITLE SURVEYORS
 1801 Moody Avenue
 Galveston, Texas 77550
 (409) 765-8883