

Latitude: 29°16'47.9" N
Longitude 94°48'28.2" W

- SURVEY MONUMENTS FOUND**
- 1/2" IR @ NWC L6/NW 183
N:13414.11
E:14441.69
 - 3/4" IP @ SWC NE 158
N:13847.83
E:14462.07
 - 1" IP in SL Ave S-1/2
N:1379.37
E:14533.80

Lot 9

4102 Ave T
two story frame
residence
(piers)

Subject residence 0.5'
inside property line

- NOTES:**
- RECORD EASEMENTS, RESTRICTIONS, ROADWAYS, RIGHTS-OF-WAY, ETC. PROVIDED BY TITLE COMPANY ONLY
 - Distances are true ground distances
 - Coordinates and bearings based on NAD 83, TxSC
 - Location of improvements utilized in boundary construction
 - 20' building line along front line as per Vol 599, Pg 350, DRGC

N: 73238.66
E: 124598.31
fnd 1" IP

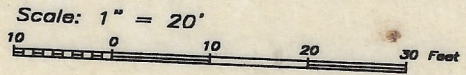

LAND TITLE SURVEY OF A TRACT OF LAND being Lot 8 in the Walter E. Grover Subdivision of the Southeast 1/4 of Outlot 158 in the City and County of Galveston, Texas, according to the map or plat thereof recorded in Volume 421, Page 231 of the Deed Records of Galveston County, Texas.

Subject property: 4102 Avenue T
Galveston County, Texas
To Alfred Heber Taylor, Dale Marie Taylor, Wells Fargo Bank and Chicago Title Co., GF #248038;
I hereby certify that this survey was made on the ground under my direct supervision and that this plat correctly represents the facts found at the time of the survey.

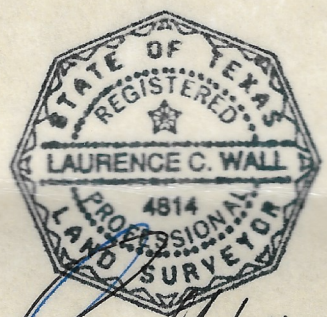

Laurence C. Wall

Laurence C. Wall
RPLS #4814
November 30, 1999