

TRACT 25-B

PINE RIDGE ACRES SUBDIVISION

D.W. BROWN SURVEY
W.C.R.R. SECTION NUMBER 376
ABSTRACT NUMBER 707
HARDIN COUNTY, TEXAS
PLAT RECORDED IN VOL. 3, PG. 181-A
PLAT RECORDS OF HARDIN Co., TX.

TRACT 25-A

CHRISTOPHER B. MOORE
14.00 AC. TR.
1695/568

7.598 AC. OF
REMAINDER AC.
OF
CHRISTOPHER B. MOORE
& ANITA D. MOORE
24.980 AC. TR.
INST. No. 2010-15839
1792/137

FOUND 1/2 1/4 W/CAP
STAMPED SESCO
SE CORNER
14 NE CORNER
24.980 AC. TR.

FOUND 1/2 1/4
NE CORNER
TRACT 25-A
NE CORNER
TRACT 23

500'21'00"E 184.38'

N89°38'54"E 1675.40'

TRACT 23

18.000 ACRES

PURCHASERS:
JAMES ERIC LOVE &
VANESSA CHARLENE LOVE
STEMART TITLE GUARANTY CO.
FILE NO. 16199030349

N86°34'35"W 1469.86'

FOUND 1/2 1/4 W/CAP
STAMPED SESCO
SE CORNER
24.980 AC. TR.
NE CORNER
23.286 AC. TR.

500'21'00"E 564.68'

128.75'
N00°21'06"W
BEVIL BOULEVARD

S89°38'54"W
208.71'

FOUND 1/2 1/4 W/CAP
STAMPED SESCO
NW CORNER
1.593 AC. TR.

FOUND 1/2 1/4 W/CAP
STAMPED SESCO
SE CORNER
MOST SOUTHERLY SW CORNER
24.980 AC. TR.

TRACT 8
FOUND 1/2 1/4 W/CAP
STAMPED SESCO
SW CORNER
1.593 AC. TR.
23.286 AC. TR.

TRACT 18
FOUND 1/2 1/4 W/CAP
STAMPED SESCO
NW CORNER
1.593 AC. TR.
SW CORNER
1.59 AC. TR.

TRACT 19
FOUND 1/2 1/4 W/CAP
STAMPED SESCO
SW CORNER
1.593 AC. TR.
NW CORNER
TRACT 23
NW CORNER
1.50 AC. TR.

FOUND 1/2 1/4 W/CAP
STAMPED SESCO
SW CORNER
14.00 AC. TR.
NW CORNER
24.98 AC. TR.

CHRISTOPHER B. MOORE
& ANITA D. MOORE
REMAINDER AC.
OF
TRACT 23
INST. No. 2010-15786
1791/809

CHRIS L. SPRINGFIELD
1.593 AC. TR.
INST. No. 2013-40750
1907/1734

● SET 1/2" IRON ROD WITH CAP
STAMPED SESCO FOR CORNER
0 200 400

TRACT 24

CHRIS A. KERODEAUX &
MARY L. KERODEAUX
23.286 AC. TR.
INST. No. 2011-18965
1809/566

FOUND 1/2 1/4
SE CORNER
TRACT 23
NE CORNER
TRACT 24

PINE RIDGE LAND COMPANY, L.L.C.
154,238 AC. TR.
TRACT 5
1589/807

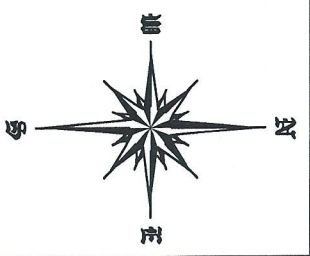

SURVEYORS CERTIFICATE
PLAT OF AN 18,000 ACRE TRACT OF LAND, MORE OR LESS,
IN THE D. W. BROWN SURVEY, W.C.R.R. SECTION NUMBER
376, ABSTRACT NUMBER 707 IN HARDIN COUNTY, TEXAS AND
BEING OUT OF TRACT 23 OF THE PINE RIDGE ACRES
SUBDIVISION, PLAT OF WHICH IS RECORDED IN VOLUME 3,
PAGE 181-A OF THE PLAT RECORDS OF HARDIN COUNTY,
TEXAS, WITH SAID 18,000 ACRE TRACT HAVING 0.616 ACRE
OUT OF THAT 1.50 ACRE TRACT CONVEYED FROM WILLIAM C.
JORDAN AND MARY A. JORDAN TO CHRISTOPHER B. MOORE
AND ANITA D. MOORE IN DEED DATED OCTOBER 5, 2010 AND
RECORDED UNDER CLERK'S INSTRUMENT NUMBER
2010-15786 IN VOLUME 1791, PAGE 809 OF THE OFFICIAL
PUBLIC RECORDS OF HARDIN COUNTY, TEXAS AND 17,384
ACRES OUT OF THAT 24,980 ACRE TRACT CONVEYED FROM
JENNIFER CUCANIC ROSS AND JOHN DANIEL ROSS TO
CHRISTOPHER B. MOORE AND ANITA MOORE IN DEED DATED
OCTOBER 15, 2010 AND RECORDED UNDER CLERK'S
INSTRUMENT NUMBER 2010-15839 IN VOLUME 1792, PAGE
137 OF THE OFFICAL PUBLIC RECORDS OF HARDIN COUNTY,
TEXAS, AS SURVEYED UNDER MY DIRECTION AND SUPERVISION
ON MARCH 14, 2016.

WILLIAM J. MESSNER
R.P.L.S. No. 6089

DATE: **MAR 17, 2016**

IF THIS SEAL AND/OR SIGNATURE ARE NOT IN RED,
THIS PLAT MAY HAVE BEEN ALTERED OR FRAUDULENT.

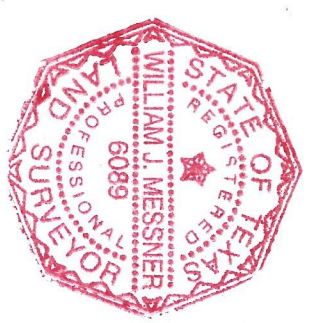

PREPARED BY
SKINNER ENGINEERING
SERVICES COMPANY
P.O. BOX 67
SILSBEE, TEXAS 77656
SURVEYING FIRM NUMBER
10079900