

**ELEVATION CERTIFICATE, page 2**

<b>IMPORTANT: In these spaces, copy the corresponding information from Section A.</b>	<b>FOR INSURANCE COMPANY USE</b>
Building Street Address (including Apt., Unit, Suite, and/or Bldg. No.) or P.O. Route and Box No. 4315 Walden Terrace Lane	Policy Number:
City Humble State TX ZIP Code 77396	Company NAIC Number:

**SECTION D – SURVEYOR, ENGINEER, OR ARCHITECT CERTIFICATION (CONTINUED)**

Copy both sides of this Elevation Certificate for (1) community official, (2) insurance agent/company, and (3) building owner.

Comments 150470 BM Brass Disk, Elevation Called = 67.27', Found = 67.14'. TBM-1: PK nail set in Walden Terrace Lane in front of Lot 41, Block 1, Canyon Gate at Park Lakes Sec. 9.

Air conditioner pad elevation = 61.0'.

Signature Robert T. Penick Date 08/08/16

**SECTION E – BUILDING ELEVATION INFORMATION (SURVEY NOT REQUIRED) FOR ZONE AO AND ZONE A (WITHOUT BFE)**

For Zones AO and A (without BFE), complete Items E1–E5. If the Certificate is intended to support a LOMA or LOMR-F request, complete Sections A, B, and C. For Items E1–E4, use natural grade, if available. Check the measurement used. In Puerto Rico only, enter meters.

- E1. Provide elevation information for the following and check the appropriate boxes to show whether the elevation is above or below the highest adjacent grade (HAG) and the lowest adjacent grade (LAG).
  - a) Top of bottom floor (including basement, crawlspace, or enclosure) is \_\_\_\_\_  feet  meters  above or  below the HAG.
  - b) Top of bottom floor (including basement, crawlspace, or enclosure) is \_\_\_\_\_  feet  meters  above or  below the LAG.
- E2. For Building Diagrams 6–9 with permanent flood openings provided in Section A Items 8 and/or 9 (see pages 8–9 of Instructions), the next higher floor (elevation C2.b in the diagrams) of the building is \_\_\_\_\_  feet  meters  above or  below the HAG.
- E3. Attached garage (top of slab) is \_\_\_\_\_  feet  meters  above or  below the HAG.
- E4. Top of platform of machinery and/or equipment servicing the building is \_\_\_\_\_  feet  meters  above or  below the HAG.
- E5. Zone AO only: If no flood depth number is available, is the top of the bottom floor elevated in accordance with the community's floodplain management ordinance?  Yes  No  Unknown. The local official must certify this information in Section G.

**SECTION F – PROPERTY OWNER (OR OWNER'S REPRESENTATIVE) CERTIFICATION**

The property owner or owner's authorized representative who completes Sections A, B, and E for Zone A (without a FEMA-issued or community-issued BFE) or Zone AO must sign here. The statements in Sections A, B, and E are correct to the best of my knowledge.

Property Owner's or Owner's Authorized Representative's Name \_\_\_\_\_

Address _____	City _____	State _____	ZIP Code _____
Signature _____	Date _____	Telephone _____	

Comments \_\_\_\_\_

Check here if attachments.

**SECTION G – COMMUNITY INFORMATION (OPTIONAL)**

The local official who is authorized by law or ordinance to administer the community's floodplain management ordinance can complete Sections A, B, C (or E), and G of this Elevation Certificate. Complete the applicable item(s) and sign below. Check the measurement used in Items G8–G10. In Puerto Rico only, enter meters.

- G1.  The information in Section C was taken from other documentation that has been signed and sealed by a licensed surveyor, engineer, or architect who is authorized by law to certify elevation information. (Indicate the source and date of the elevation data in the Comments area below.)
- G2.  A community official completed Section E for a building located in Zone A (without a FEMA-issued or community-issued BFE) or Zone AO.
- G3.  The following information (Items G4–G10) is provided for community floodplain management purposes.

G4. Permit Number _____	G5. Date Permit Issued _____	G6. Date Certificate Of Compliance/Occupancy Issued _____
-------------------------	------------------------------	---

- G7. This permit has been issued for:  New Construction  Substantial Improvement
- G8. Elevation of as-built lowest floor (including basement) of the building: \_\_\_\_\_  feet  meters Datum \_\_\_\_\_
- G9. BFE or (in Zone AO) depth of flooding at the building site: \_\_\_\_\_  feet  meters Datum \_\_\_\_\_
- G10. Community's design flood elevation: \_\_\_\_\_  feet  meters Datum \_\_\_\_\_

Local Official's Name _____	Title _____
Community Name _____	Telephone _____
Signature _____	Date _____

Comments \_\_\_\_\_

Check here if attachments.

**T-47 RESIDENTIAL REAL PROPERTY AFFIDAVIT  
(MAY BE MODIFIED AS APPROPRIATE FOR COMMERCIAL TRANSACTIONS)**

Date: December 10, 2019

GF No. 1900012

Name of Affiant(s): David N. Brown III

Address of Affiant: 4315 Walden Terrace Ln, Humble, TX 77396-4413

Description of Property: LT 41 BLK I CANYON GATE AT PARK LAKES SEC 9, 4315 Walden Terrace Ln., Humble, TX 77396  
County Harris, Texas

"Title Company" as used herein is the Title Insurance Company whose policy of title insurance is issued in reliance upon the statements contained herein.

Before me, the undersigned notary for the State of Texas, personally appeared Affiant(s) who after by me being sworn, stated:

1. We are the owners of the Property. (Or state other basis for knowledge by Affiant(s) of the Property, such as lease, management, neighbor, etc. For example, "Affiant is the manager of the Property for the record title owners."): n/a

2. We are familiar with the property and the improvements located on the Property.

3. We are closing a transaction requiring title insurance and the proposed insured owner or lender has requested area and boundary coverage in the title insurance policy(ies) to be issued in this transaction. We understand that the Title Company may make exceptions to the coverage of the title insurance as Title Company may deem appropriate. We understand that the owner of the property, if the current transaction is a sale, may request a similar amendment to the area and boundary coverage in the Owner's Policy of Title Insurance upon payment of the promulgated premium.

4. To the best of our actual knowledge and belief, since January 9, 2015 there have been no:
- a. construction projects such as new structures, additional buildings, rooms, garages, swimming pools or other permanent improvements or fixtures;
  - b. changes in the location of boundary fences or boundary walls;
  - c. construction projects on immediately adjoining property(ies) which encroach on the Property;
  - d. conveyances, replattings, easement grants and/or easement dedications (such as a utility line) by any party affecting the Property.

EXCEPT for the following (If None, Insert "None" Below:) None

5. We understand that Title Company is relying on the truthfulness of the statements made in this affidavit to provide the area and boundary coverage and upon the evidence of the existing real property survey of the Property. This Affidavit is not made for the benefit of any other parties and this Affidavit does not constitute a warranty or guarantee of the location of improvements.

6. We understand that we have no liability to Title Company that will issue the policy(ies) should the information in this Affidavit be incorrect other than information that we personally know to be incorrect and which we do not disclose to the Title Company.

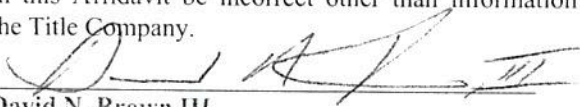
  
David N. Brown III

SWORN AND SUBSCRIBED this 10th day of December, 2019

  
Notary Public

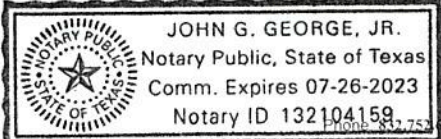

(TXR-1907) 02-01-2010

# ELEVATION CERTIFICATE

**Important: Read the instructions on pages 1-9.**

OMB No. 1660-0008  
 Expiration Date: July 31, 2015

SECTION A - PROPERTY INFORMATION		FOR INSURANCE COMPANY USE
A1. Building Owner's Name		Policy Number:
A2. Building Street Address (including Apt., Unit, Suite, and/or Bldg. No.) or P.O. Route and Box No. 4315 Walden Terrace Lane		Company NAIC Number:
City Humble	State TX	ZIP Code 77396
A3. Property Description (Lot and Block Numbers, Tax Parcel Number, Legal Description, etc.) Lot 41, Block 1, Canyon Gate at Park Lakes Sec. 9		
A4. Building Use (e.g., Residential, Non-Residential, Addition, Accessory, etc.) <u>Residential</u>		
A5. Latitude/Longitude: Lat. <u>29.944732 N</u> Long. <u>95.239036 W</u>		Horizontal Datum: <input type="checkbox"/> NAD 1927 <input checked="" type="checkbox"/> NAD 1983
A6. Attach at least 2 photographs of the building if the Certificate is being used to obtain flood insurance.		
A7. Building Diagram Number <u>1B</u>		
A8. For a building with a crawlspace or enclosure(s):		A9. For a building with an attached garage:
a) Square footage of crawlspace or enclosure(s) <u>N/A</u> sq ft		a) Square footage of attached garage <u>663</u> sq ft
b) Number of permanent flood openings in the crawlspace or enclosure(s) within 1.0 foot above adjacent grade <u>N/A</u>		b) Number of permanent flood openings in the attached garage within 1.0 foot above adjacent grade <u>N/A</u>
c) Total net area of flood openings in A8.b <u>N/A</u> sq in		c) Total net area of flood openings in A9.b <u>N/A</u> sq in
d) Engineered flood openings? <input type="checkbox"/> Yes <input checked="" type="checkbox"/> No		d) Engineered flood openings? <input type="checkbox"/> Yes <input checked="" type="checkbox"/> No

SECTION B - FLOOD INSURANCE RATE MAP (FIRM) INFORMATION					
B1. NFIP Community Name & Community Number City of Humble 480297		B2. County Name Harris		B3. State TX	
B4. Map/Panel Number 48201C0505	B5. Suffix M	B6. FIRM Index Date June 9, 2014	B7. FIRM Panel Effective/Revised Date June 9, 2014	B8. Flood Zone(s) AE	B9. Base Flood Elevation(s) (Zone AO, use base flood depth) 58'
B10. Indicate the source of the Base Flood Elevation (BFE) data or base flood depth entered in Item B9. <input type="checkbox"/> FIS Profile <input checked="" type="checkbox"/> FIRM <input type="checkbox"/> Community Determined <input type="checkbox"/> Other/Source: _____					
B11. Indicate elevation datum used for BFE in Item B9: <input type="checkbox"/> NGVD 1929 <input checked="" type="checkbox"/> NAVD 1988 <input type="checkbox"/> Other/Source: _____					
B12. Is the building located in a Coastal Barrier Resources System (CBRS) area or Otherwise Protected Area (OPA)? <input type="checkbox"/> Yes <input checked="" type="checkbox"/> No Designation Date: _____ <input type="checkbox"/> CBRS <input type="checkbox"/> OPA					

SECTION C - BUILDING ELEVATION INFORMATION (SURVEY REQUIRED)	
C1. Building elevations are based on: <input type="checkbox"/> Construction Drawings* <input type="checkbox"/> Building Under Construction* <input checked="" type="checkbox"/> Finished Construction *A new Elevation Certificate will be required when construction of the building is complete.	
C2. Elevations - Zones A1-A30, AE, AH, A (with BFE), VE, V1-V30, V (with BFE), AR, AR/A, AR/AE, AR/A1-A30, AR/AH, AR/AO. Complete Items C2.a-h below according to the building diagram specified in Item A7. In Puerto Rico only, enter meters. Benchmark Utilized: <u>150470 (see comments)</u> Vertical Datum: <u>NAVD 1988</u> Indicate elevation datum used for the elevations in items a) through h) below. <input type="checkbox"/> NGVD 1929 <input checked="" type="checkbox"/> NAVD 1988 <input type="checkbox"/> Other/Source: _____ Datum used for building elevations must be the same as that used for the BFE.	
Check the measurement used.	
a) Top of bottom floor (including basement, crawlspace, or enclosure floor)	<u>62.1</u> <input checked="" type="checkbox"/> feet <input type="checkbox"/> meters
b) Top of the next higher floor	<u>73.1</u> <input checked="" type="checkbox"/> feet <input type="checkbox"/> meters
c) Bottom of the lowest horizontal structural member (V Zones only)	<u>N/A</u> <input type="checkbox"/> feet <input type="checkbox"/> meters
d) Attached garage (top of slab)	<u>61.4</u> <input checked="" type="checkbox"/> feet <input type="checkbox"/> meters
e) Lowest elevation of machinery or equipment servicing the building (Describe type of equipment and location in Comments)	<u>61.0</u> <input checked="" type="checkbox"/> feet <input type="checkbox"/> meters
f) Lowest adjacent (finished) grade next to building (LAG)	<u>60.7</u> <input checked="" type="checkbox"/> feet <input type="checkbox"/> meters
g) Highest adjacent (finished) grade next to building (HAG)	<u>61.4</u> <input checked="" type="checkbox"/> feet <input type="checkbox"/> meters
h) Lowest adjacent grade at lowest elevation of deck or stairs, including structural support	<u>N/A</u> <input type="checkbox"/> feet <input type="checkbox"/> meters

SECTION D - SURVEYOR, ENGINEER, OR ARCHITECT CERTIFICATION	
This certification is to be signed and sealed by a land surveyor, engineer, or architect authorized by law to certify elevation information. I certify that the information on this Certificate represents my best efforts to interpret the data available. I understand that any false statement may be punishable by fine or imprisonment under 18 U.S. Code, Section 1001.	
<input checked="" type="checkbox"/> Check here if comments are provided on back of form. Were latitude and longitude in Section A provided by a licensed land surveyor? <input checked="" type="checkbox"/> Yes <input type="checkbox"/> No	
<input checked="" type="checkbox"/> Check here if attachments.	
Certifier's Name <u>Robert T. Paul, Jr.</u>	License Number <u>4984</u>
Title <u>RPLS</u>	Company Name <u>Premier Surveying, LLC</u>
Address <u>5700 W. Plano Parkway</u>	City <u>Plano</u> State <u>TX</u> ZIP Code <u>75093</u>
Signature <u>Robert T. Paul, Jr.</u>	Date <u>08/08/16</u> Telephone <u>972-612-3601</u>

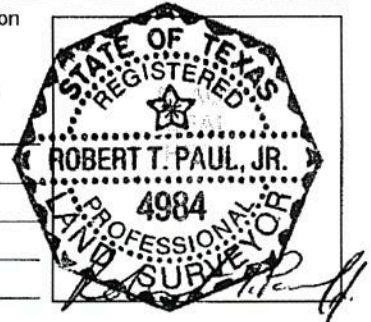

# Building Photographs

See Instructions for Item A6.

**IMPORTANT: In these spaces, copy the corresponding information from Section A.**

Building Street Address (including Apt., Unit, Suite, and/or Bldg. No.) or P.O. Route and Box No.  
4315 Walden Terrace Lane

City Humble

State TX

ZIP Code 77396

FOR INSURANCE COMPANY USE

Policy Number:

Company NAIC Number:

If using the Elevation Certificate to obtain NFIP flood insurance, affix at least 2 building photographs below according to the instructions for Item A6. Identify all photographs with date taken; "Front View" and "Rear View"; and, if required, "Right Side View" and "Left Side View." When applicable, photographs must show the foundation with representative examples of the flood openings or vents, as indicated in Section A8. If submitting more photographs than will fit on this page, use the Continuation Page.



FRONT VIEW



LEFT VIEW



RIGHT VIEW