

AVEBURY STONE CIRCLE
(50' R.O.W.)

TO STEPPING STONE LANE
(50' R.O.W.)

NOTES:

- 1.) SUBJECT TO APPLICABLE RESTRICTIVE COVENANTS LISTED IN SCHEDULE "B" OF TITLE COMMITMENT ISSUED BY COMMONWEALTH LAND TITLE COMPANY UNDER GF No. 2618002909.
- 2.) SURVEYOR HAS NOT ABSTRACTED SUBJECT PROPERTY, ABSTRACTING BY TITLE COMPANY ONLY.
- 3.) SUBJECT TO CENTERPOINT ENERGY AGREEMENT FOR ELECTRIC SERVICE PER F.B.C.C.F. NO. 2003044266.

- IF CONSTRUCTION UPON OR A DIVISION OF SUBJECT TRACT IS PROPOSED AND IF TRACT LIES IN THE CITY OF HOUSTON OR ITS EXTRATERRITORIAL JURISDICTION, PLATTING AND OTHER REQUIREMENTS MAY APPLY PER CITY OF HOUSTON ORDINANCES.
- ALL BEARINGS SHOWN ARE BASED ON THE RECORDED PLAT.

SCALE: 1" = 30'

SUBJECT PROPERTY IS NOT LOCATED IN A FEDERAL INSURANCE ADMINISTRATION DESIGNATED FLOOD HAZARD AREA. LOCATED IN ZONE "X500", AS PER MAP 480228, PANEL 0425J, DATED: 1-3-97. THIS INFORMATION IS BASED ON GRAPHIC PLOTTING ONLY. WE DO NOT ASSUME RESPONSIBILITY FOR EXACT DETERMINATION.

LOT 20		SUBDIVISION SIENNA VILLAGE OF WATERS LAKE	
BLOCK 4	SECTION NINE-A	RECORDATION SLIDE NO. 2376A & 2376B, F.B.C.P.R.	
COUNTY FORT BEND	STATE TEXAS	I HEREBY CERTIFY THAT THIS PLAT REPRESENTS THE RESULTS OF A SURVEY MADE ON THE GROUND ON THE 20th DAY OF DECEMBER, 2007.	

LENDER Co.	USAA FEDERAL SAVINGS BANK
TITLE Co.	COMMONWEALTH LAND TITLE COMPANY
PURCHASER	GEOFFREY CAMPBELL
	GINA CAMPBELL
ADDRESS	9007 AVEBURY STONE CIRCLE
	MISSOURI CITY, TEXAS

MERIDIAN
SURVEYING & MAPPING
1080 W. SAM HOUSTON PKWY. N., STE. 113
HOUSTON, TEXAS 77043
©COPYRIGHT 2007 MERIDIAN SURVEYING & MAPPING, ALL RIGHTS RESERVED.

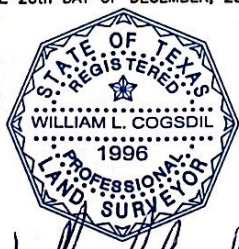

William L. Cogsdil



TEL. (713) 722-7541 FAX (713) 722-7613

JOB No.	07-18533	
G.F. No.	2618002909	
FIELD WORK	12-20-07	MV
DRAFTED BY	12-21-07	WJ
CHECKED BY	12-21-07	RG
KEY MAP	650J	
REVISION	-	