

FLOORPLAN SKETCH

Client: Geroge E & D Ann Hinkle
 Property Address: 12308 Oak Bend Cir
 City: Conroe

File No.: 2020-069
 Case No.:
 State: TX Zip: 77304

Sketch

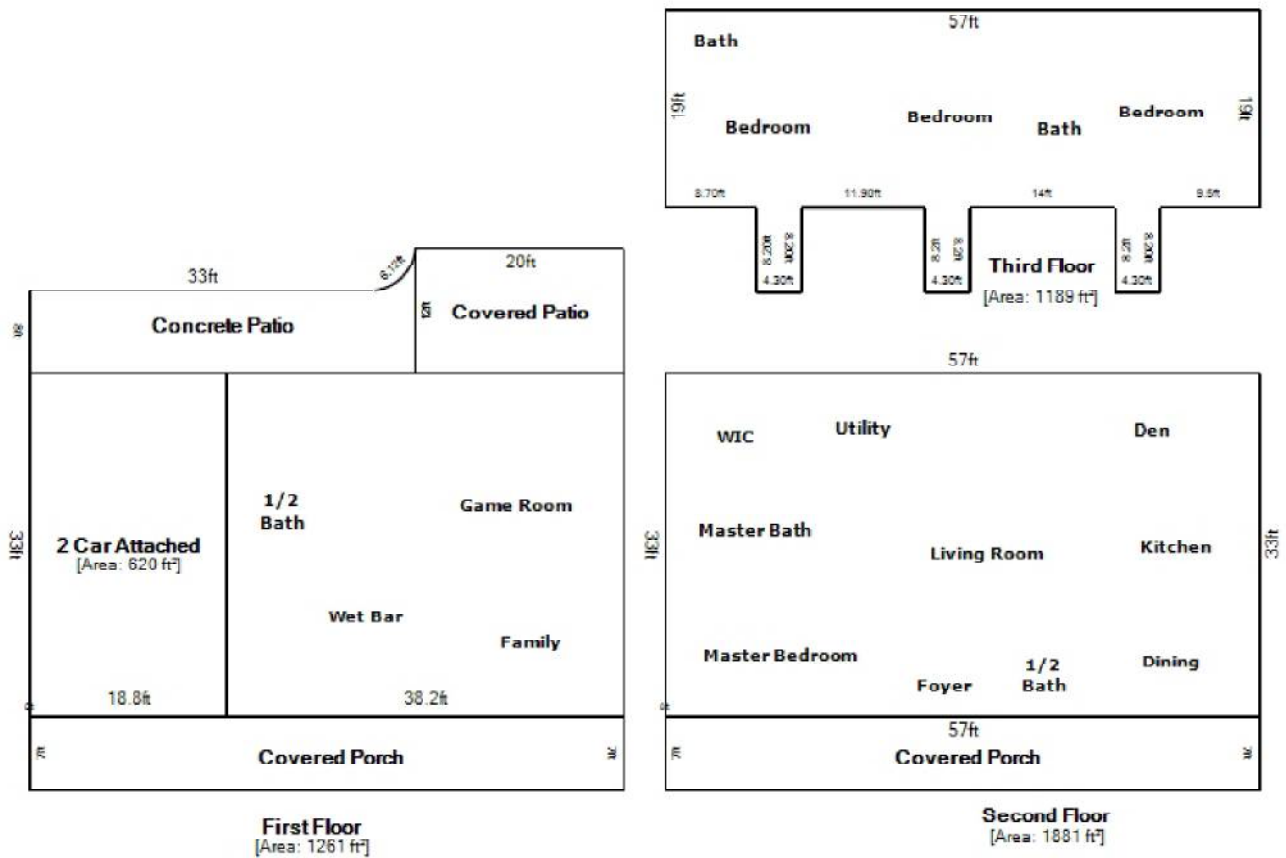

16 ft

Living Area		Area Calculation			
First Floor	1260.6 ft²	First Floor	33ft x 38.2ft x 1.00 =	1260.6 ft²	
Second Floor	1881 ft²	Second Floor	33ft x 57ft x 1.00 =	1881 ft²	
Third Floor	1188.78 ft²	Third Floor	9.5ft x 19ft x 1.00 =	180.5 ft²	
Nonliving Area			8.70ft x 19ft x 1.00 =	165.3 ft²	
2 Car Attached	620.4 ft²		8.2ft x 4.30ft x 1.00 =	35.28 ft²	
Covered Patio	240 ft²		8.2ft x 4.30ft x 1.00 =	35.26 ft²	
Concrete Patio	300.14 ft²		38.8ft x 19ft x 1.00 =	737.2 ft²	
Covered Porch	399 ft²		11.90ft x 16.20ft x 0.00 =	0.00 ft²	
Covered Porch	399 ft²		8.2ft x 4.30ft x 0.50 =	17.63 ft²	
Total Living Area (rounded):		4330 ft²	8.20ft x 4.30ft x 0.50 =	17.63 ft²	