

BEARINGS ARE BASED ON THE RECORDED SUBDIVISION PLAT.
 ELEVATIONS ARE BASED ON T.R.A. LAKE LEVEL 03/09/17 - 131.70' M.S.L.

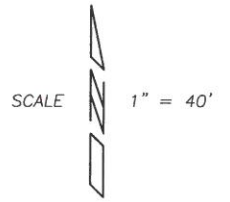

- CM DENOTES CONTROLLING MONUMENT.
- o- DENOTES POINT, EXCEPT WHERE NOTED.
- EM- DENOTES ELECTRIC METER.
- UE- DENOTES UNDERGROUND ELECTRIC LINE.
- SS C/O DENOTES SANITARY SEWER CLEAN-OUT.
- W- DENOTES WATER METER.

OWNERS:
 RH BUILDERS

• SURVEY SHOWING •

LOT TWENTY-FOUR OF LAKE OAKS LANDING, A SUBDIVISION IN THE WILLIAM MORRIS SURVEY, A- 38, SAN JACINTO COUNTY, TEXAS, ACCORDING TO THE MAP OR PLAT THEREOF RECORDED IN VOLUME 8, PAGE 24 AND REPLAT RECORDED IN VOLUME 8, PAGE 25 OF THE PLAT RECORDS OF SAID SAN JACINTO COUNTY, TEXAS.

I, GERALD L. WRIGHT, REGISTERED PROFESSIONAL LAND SURVEYOR No. 5334, DO HEREBY CERTIFY THAT THIS SURVEY WAS MADE ON THE GROUND OF THE PROPERTY LEGALLY SHOWN HEREON AND IS TRUE AND CORRECT.

SURVEYED: MARCH 09, 2017; JUNE 27, 2018

BY: *Gerald L. Wright*
 GERALD L. WRIGHT, R.P.L.S. No. 5334
 TEXAS FIRM REGISTRATION No. 10128800

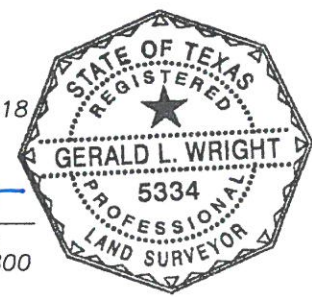

COPYRIGHT 2018 LIVINGSTON SURVEYING & MAPPING CORPORATION. THIS SURVEY IS BEING PROVIDED SOLELY FOR THE USE OF THE CURRENT PARTIES AND IT IS NOT TO BE REPRODUCED, ALTERED OR REUSED FOR ANY SUBSEQUENT TRANSACTION.

LIVINGSTON SURVEYING & MAPPING

P.O. BOX 900, LIVINGSTON, TEXAS 77351 409/327-3816